

Contract for the sale and purchase of land 2018 edition

TERM	MEANING OF TERM	eCOS ID: 49579441	NSW Duty:
vendor's agent	JIM AITKEN PENRITH 429 HIGH STREET, PENRITH NSW 2750		Phone: 4722 5000 Fax: 4722 5200 Ref:
co-agent			
vendor	LEE LEE SUN 23 79-81 UNION ROAD PENRITH NSW 2750		
vendor's solicitor	Zhang Shijing Lawyers Suit 13 L1 301 Castlereagh Street Sydney NSW 2000		Phone: (02) 9212 6936 Fax: (02) 9212 3650 Ref: 180812L
date for completion	42 days after the contract date	(clause 15)	Email: info@zhanglawyers.com.au
land	23/79-81 UNION RD PENRITH 2750		
(Address, plan details and title reference)	LOT 23 IN SP 79328 23/sp79328		
improvements	<input checked="" type="checkbox"/> VACANT POSSESSION <input type="checkbox"/> Subject to existing tenancies <input type="checkbox"/> HOUSE <input type="checkbox"/> garage <input type="checkbox"/> carport <input checked="" type="checkbox"/> home unit <input checked="" type="checkbox"/> carspace <input type="checkbox"/> storage space <input type="checkbox"/> none <input type="checkbox"/> other:		
attached copies	<input type="checkbox"/> documents in the List of Documents as marked or as numbered: <input type="checkbox"/> other documents:		

A real estate agent is permitted by legislation to fill up the items in this box in a sale of residential property.

inclusions	<input checked="" type="checkbox"/> blinds	<input checked="" type="checkbox"/> dishwasher	<input checked="" type="checkbox"/> light fittings	<input checked="" type="checkbox"/> stove
	<input checked="" type="checkbox"/> built-in wardrobes	<input checked="" type="checkbox"/> fixed floor coverings	<input checked="" type="checkbox"/> range hood	<input type="checkbox"/> pool equipment
	<input type="checkbox"/> clothes line	<input checked="" type="checkbox"/> insect screens	<input type="checkbox"/> solar panels	<input checked="" type="checkbox"/> TV antenna
	<input type="checkbox"/> curtains	<input type="checkbox"/> other:		
exclusions				
purchaser				
purchaser's solicitor			Phone:	
			Fax:	
			Ref:	
			Email:	
price	\$			
deposit	\$			(10% of the price, unless otherwise stated)
balance	\$			
contract date				(if not stated, the date this contract was made)

buyer's agent

vendor

witness

GST AMOUNT (optional)
 The price includes
 GST of: \$

purchaser

☐ JOINT TENANTS

☐ tenants in common

☐ in unequal shares

witness

BREACH OF COPYRIGHT MAY RESULT IN LEGAL ACTION

180812L

49579441

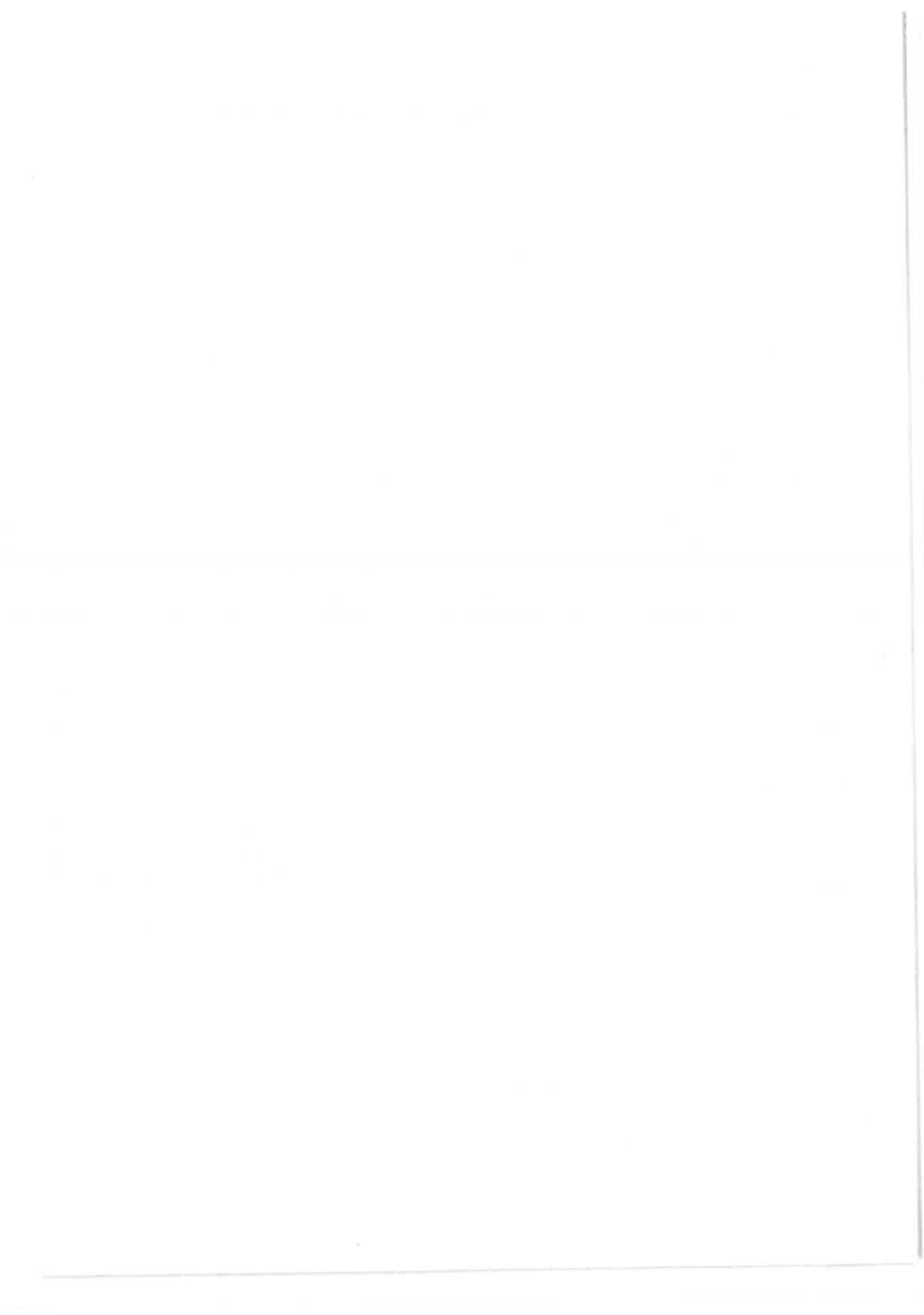

vendor agrees to accept a *deposit-bond* (clause 3)☐ NO ☐ yesproposed *electronic transaction* (clause 30)☐ no ☐ YES

Tax Information (the parties promise this is correct as far as each party is aware)

land tax is adjustable

☐ NO ☐ yes

GST: Taxable supply

☐ NO ☐ yes in full☐ yes to an extent

Margin scheme will be used in making the taxable supply

☐ NO ☐ yes

This sale is not a taxable supply because (one or more of the following may apply) the sale is:

- ☐ not made in the course or furtherance of an enterprise that the vendor carries on (section 9-5(b))
- ☐ by a vendor who is neither registered nor required to be registered for GST (section 9-5(d))
- ☐ GST-free because the sale is the supply of a going concern under section 38-325
- ☐ GST-free because the sale is subdivided farm land or farm land supplied for farming under Subdivision 38-O
- ☐ input taxed because the sale is of eligible residential premises (sections 40-65, 40-75(2) and 195-1)

Purchaser must make an *RW payment*
(residential withholding payment)☐ NO ☐ yes (if yes, vendor must provide
further details)

If the further details below are not fully completed at the contract date, the vendor must provide all these details in a separate notice within 14 days of the contract date.

RW payment (residential withholding payment) – further details

Frequently the supplier will be the vendor. However, sometimes further information will be required as to which entity is liable for GST, for example, if the vendor is part of a GST group or a participant in a GST joint venture.

Supplier's name:

Supplier's ABN:

Supplier's business address:

Supplier's email address:

Supplier's phone number:

Supplier's proportion of *RW payment*: \$

If more than one supplier, provide the above details for each supplier.

Amount purchaser must pay – price multiplied by the *RW rate* (residential withholding rate): \$Amount must be paid: ☐ AT COMPLETION ☐ at another time (specify):Is any of the consideration not expressed as an amount in money? ☐ NO ☐ yes

If "yes", the GST inclusive market value of the non-monetary consideration: \$

Other details (including those required by regulation or the ATO forms):

List of Documents

General

- ☐ 1 property certificate for the land
- ☐ 2 plan of the land
- ☐ 3 unregistered plan of the land
- ☐ 4 plan of land to be subdivided
- ☐ 5 document that is to be lodged with a relevant plan
- ☐ 6 section 10.7(2) planning certificate under Environmental Planning and Assessment Act 1979
- ☐ 7 additional information included in that certificate under section 10.7(5)
- ☐ 8 sewerage infrastructure location diagram (service location diagram)
- ☐ 9 sewer lines location diagram (sewerage service diagram)
- ☐ 10 document that created or may have created an easement, profit à prendre, restriction on use or positive covenant disclosed in this contract
- ☐ 11 *planning agreement*
- ☐ 12 section 88G certificate (positive covenant)
- ☐ 13 survey report
- ☐ 14 building information certificate or building certificate given under *legislation*
- ☐ 15 lease (with every relevant memorandum or variation)
- ☐ 16 other document relevant to tenancies
- ☐ 17 licence benefiting the land
- ☐ 18 old system document
- ☐ 19 Crown purchase statement of account
- ☐ 20 building management statement
- ☐ 21 form of requisitions
- ☐ 22 *clearance certificate*
- ☐ 23 land tax certificate

Home Building Act 1989

- ☐ 24 insurance certificate
- ☐ 25 brochure or warning
- ☐ 26 evidence of alternative indemnity cover

Swimming Pools Act 1992

- ☐ 27 certificate of compliance
- ☐ 28 evidence of registration
- ☐ 29 relevant occupation certificate
- ☐ 30 certificate of non-compliance
- ☐ 31 detailed reasons of non-compliance

Strata or community title (clause 23 of the contract)

- ☐ 32 property certificate for strata common property
- ☐ 33 plan creating strata common property
- ☐ 34 strata by-laws
- ☐ 35 strata development contract or statement
- ☐ 36 strata management statement
- ☐ 37 strata renewal proposal
- ☐ 38 strata renewal plan
- ☐ 39 leasehold strata - lease of lot and common property
- ☐ 40 property certificate for neighbourhood property
- ☐ 41 plan creating neighbourhood property
- ☐ 42 neighbourhood development contract
- ☐ 43 neighbourhood management statement
- ☐ 44 property certificate for precinct property
- ☐ 45 plan creating precinct property
- ☐ 46 precinct development contract
- ☐ 47 precinct management statement
- ☐ 48 property certificate for community property
- ☐ 49 plan creating community property
- ☐ 50 community development contract
- ☐ 51 community management statement
- ☐ 52 document disclosing a change of by-laws
- ☐ 53 document disclosing a change in a development or management contract or statement
- ☐ 54 document disclosing a change in boundaries
- ☐ 55 information certificate under Strata Schemes Management Act 2015
- ☐ 56 information certificate under Community Land Management Act 1989
- ☐ 57 document relevant to off-the-plan sale

Other

- ☐ 58

HOLDER OF STRATA OR COMMUNITY TITLE RECORDS – Name, address, email address and telephone number

STANTON & TAYLOR STRATA MANAGEMENT
(02) 4721 2444 /Level 1, 314 High Street, Penrith NSW 2750

IMPORTANT NOTICE TO VENDORS AND PURCHASERS

Before signing this contract you should ensure that you understand your rights and obligations, some of which are not written in this contract but are implied by law.

WARNING—SMOKE ALARMS

The owners of certain types of buildings and strata lots must have smoke alarms (or in certain cases heat alarms) installed in the building or lot in accordance with regulations under the *Environmental Planning and Assessment Act 1979*. It is an offence not to comply. It is also an offence to remove or interfere with a smoke alarm or heat alarm. Penalties apply.

WARNING—LOOSE-FILL ASBESTOS INSULATION

Before purchasing land that includes any residential premises (within the meaning of Division 1A of Part 8 of the *Home Building Act 1989*) built before 1985, a purchaser is strongly advised to consider the possibility that the premises may contain loose-fill asbestos insulation (within the meaning of Division 1A of Part 8 of the *Home Building Act 1989*). In particular, a purchaser should:

- (a) search the Register required to be maintained under Division 1A of Part 8 of the *Home Building Act 1989*, and
- (b) ask the relevant local council whether it holds any records showing that the residential premises contain loose-fill asbestos insulation.

For further information about loose-fill asbestos insulation (including areas in which residential premises have been identified as containing loose-fill asbestos insulation), contact NSW Fair Trading.

23/79-81

COOLING OFF PERIOD (PURCHASER'S RIGHTS)

1. This is the statement required by section 66X of the *Conveyancing Act 1919* and applies to a contract for the sale of residential property.
2. The purchaser may rescind the contract at any time before 5 p.m. on the fifth business day after the day on which the contract was made, **EXCEPT** in the circumstances listed in paragraph 3.
3. There is **NO COOLING OFF PERIOD**:
 - (a) if, at or before the time the contract is made, the purchaser gives to the vendor (or the vendor's solicitor or agent) a certificate that complies with section 66W of the Act, or
 - (b) if the property is sold by public auction, or
 - (c) if the contract is made on the same day as the property was offered for sale by public auction but passed in, or
 - (d) if the contract is made in consequence of the exercise of an option to purchase the property, other than an option that is void under section 66ZG of the Act.
4. A purchaser exercising the right to cool off by rescinding the contract will forfeit to the vendor 0.25% of the purchase price of the property. The vendor is entitled to recover the amount forfeited from any amount paid by the purchaser as a deposit under the contract and the purchaser is entitled to a refund of any balance.

DISPUTES

If you get into a dispute with the other party, the Law Society and Real Estate Institute encourage you to use informal procedures such as negotiation, independent expert appraisal, the Law Society Conveyancing Dispute Resolution Scheme or mediation (for example mediation under the Law Society Mediation Program).

AUCTIONS

Regulations made under the Property, Stock and Business Agents Act 2002 prescribe a number of conditions applying to sales by auction.

WARNINGS

1. Various Acts of Parliament and other matters can affect the rights of the parties to this contract. Some important matters are actions, claims, decisions, licences, notices, orders, proposals or rights of way involving:

Australian Taxation Office
Council
County Council
Department of Planning and Environment
Department of Primary Industries
East Australian Pipeline Limited
Electricity and gas
Land & Housing Corporation
Local Land Services
NSW Department of Education

NSW Fair Trading
NSW Public Works Advisory
Office of Environment and Heritage
Owner of adjoining land
Privacy
Roads and Maritime Services
Subsidence Advisory NSW
Telecommunications
Transport for NSW
Water, sewerage or drainage authority

If you think that any of these matters affects the property, tell your solicitor.

2. A lease may be affected by the Agricultural Tenancies Act 1990, the Residential Tenancies Act 2010 or the Retail Leases Act 1994.
3. If any purchase money is owing to the Crown, it will become payable before obtaining consent, or if no consent is needed, when the transfer is registered.
4. If a consent to transfer is required under legislation, see clause 27 as to the obligations of the parties.
5. The vendor should continue the vendor's insurance until completion. If the vendor wants to give the purchaser possession before completion, the vendor should first ask the insurer to confirm this will not affect the insurance.
6. The purchaser will usually have to pay stamp duty (and sometimes surcharge purchaser duty) on this contract. If duty is not paid on time, a purchaser may incur penalties.
7. If the purchaser agrees to the release of deposit, the purchaser's right to recover the deposit may stand behind the rights of others (for example the vendor's mortgagee).
8. The purchaser should arrange insurance as appropriate.
9. Some transactions involving personal property may be affected by the Personal Property Securities Act 2009.
10. A purchaser should be satisfied that finance will be available at the time of completing the purchase.
11. Where the market value of the property is at or above a legislated amount, the purchaser may have to comply with a foreign resident capital gains withholding payment obligation (even if the vendor is not a foreign resident). If so, this will affect the amount available to the vendor on completion.
12. Purchasers of some residential properties may have to withhold part of the purchase price to be credited towards the GST liability of the vendor. If so, this will also affect the amount available to the vendor.

The vendor sells and the purchaser buys the *property* for the price under these provisions instead of Schedule 3 Conveyancing Act 1919, subject to any *legislation* that cannot be excluded.

1 Definitions (a term in *italics* is a defined term)

In this contract, these terms (in any form) mean –

<i>adjustment date</i>	the earlier of the giving of possession to the purchaser or completion;
<i>bank</i>	the Reserve Bank of Australia or an authorised deposit-taking institution which is a bank, a building society or a credit union;
<i>business day</i>	any day except a bank or public holiday throughout NSW or a Saturday or Sunday;
<i>cheque</i>	a cheque that is not postdated or stale;
<i>clearance certificate</i>	a certificate within the meaning of s14-220 of Schedule 1 to the TA Act, that covers one or more days falling within the period from and including the contract date to completion;
<i>deposit-bond</i>	a deposit bond or guarantee from an issuer, with an expiry date and for an amount each approved by the vendor;
<i>depositholder</i>	vendor's agent (or if no vendor's agent is named in this contract, the vendor's <i>solicitor</i> , or if no vendor's <i>solicitor</i> is named in this contract, the buyer's agent);
<i>document of title</i>	document relevant to the title or the passing of title;
<i>FRCGW percentage</i>	the percentage mentioned in s14-200(3)(a) of Schedule 1 to the TA Act (12.5% as at 1 July 2017);
<i>GST Act</i>	A New Tax System (Goods and Services Tax) Act 1999;
<i>GST rate</i>	the rate mentioned in s4 of A New Tax System (Goods and Services Tax Imposition - General) Act 1999 (10% as at 1 July 2000);
<i>legislation</i>	an Act or a by-law, ordinance, regulation or rule made under an Act;
<i>normally</i>	subject to any other provision of this contract;
<i>party</i>	each of the vendor and the purchaser;
<i>property</i>	the land, the improvements, all fixtures and the inclusions, but not the exclusions;
<i>planning agreement</i>	a valid voluntary agreement within the meaning of s7.4 of the Environmental Planning and Assessment Act 1979 entered into in relation to the <i>property</i> ;
<i>requisition</i>	an objection, question or requisition (but the term does not include a claim);
<i>remittance amount</i>	the lesser of the <i>FRCGW percentage</i> of the price (inclusive of GST, if any) and the amount specified in a <i>variation served</i> by a <i>party</i> ;
<i>rescind</i>	rescind this contract from the beginning;
<i>RW payment</i>	a payment which the purchaser must make under s14-250 of Schedule 1 to the TA Act (the price multiplied by the <i>RW rate</i>);
<i>RW rate</i>	the rate determined under ss14-250(6), (8) or (9) of Schedule 1 to the TA Act (as at 1 July 2018, usually 7% of the price if the margin scheme applies, 1/11 th if not);
<i>serve</i>	serve in writing on the other <i>party</i> ;
<i>settlement cheque</i>	an unendorsed <i>cheque</i> made payable to the person to be paid and – <ul style="list-style-type: none"> • issued by a <i>bank</i> and drawn on itself; or • if authorised in writing by the vendor or the vendor's <i>solicitor</i>, some other <i>cheque</i>;
<i>solicitor</i>	in relation to a <i>party</i> , the <i>party's</i> <i>solicitor</i> or licensed conveyancer named in this contract or in a notice <i>served</i> by the <i>party</i> ;
<i>TA Act</i>	Taxation Administration Act 1953;
<i>terminate</i>	terminate this contract for breach;
<i>variation</i>	a variation made under s14-235 of Schedule 1 to the TA Act;
<i>within</i>	in relation to a period, at any time before or during the period; and
<i>work order</i>	a valid direction, notice or order that requires work to be done or money to be spent on or in relation to the <i>property</i> or any adjoining footpath or road (but the term does not include a notice under s22E of the Swimming Pools Act 1992 or clause 18B of the Swimming Pools Regulation 2008).

2 Deposit and other payments before completion

- 2.1 The purchaser must pay the deposit to the *depositholder* as stakeholder.
- 2.2 *Normally*, the purchaser must pay the deposit on the making of this contract, and this time is essential.
- 2.3 If this contract requires the purchaser to pay any of the deposit by a later time, that time is also essential.
- 2.4 The purchaser can pay any of the deposit by giving cash (up to \$2,000) or by unconditionally giving a *cheque* to the *depositholder* or to the vendor, vendor's agent or vendor's *solicitor* for sending to the *depositholder*.
- 2.5 If any of the deposit is not paid on time or a *cheque* for any of the deposit is not honoured on presentation, the vendor can *terminate*. This right to *terminate* is lost as soon as the deposit is paid in full.
- 2.6 If the vendor accepts a bond or guarantee for the deposit, clauses 2.1 to 2.5 do not apply.
- 2.7 If the vendor accepts a bond or guarantee for part of the deposit, clauses 2.1 to 2.5 apply only to the balance.

- 2.8 If any of the deposit or of the balance of the price is paid before completion to the vendor or as the vendor directs, it is a charge on the land in favour of the purchaser until *termination* by the vendor or completion, subject to any existing right.
- 2.9 If each *party* tells the *depositholder* that the deposit is to be invested, the *depositholder* is to invest the deposit (at the risk of the *party* who becomes entitled to it) with a *bank*, in an interest-bearing account in NSW, payable at call, with interest to be reinvested, and pay the interest to the *parties* equally, after deduction of all proper government taxes and financial institution charges and other charges.
- 3 Deposit-bond**
- 3.1 This clause applies only if this contract says the vendor has agreed to accept a *deposit-bond* for the deposit (or part of it).
- 3.2 The purchaser must provide the original *deposit-bond* to the vendor's *solicitor* (or if no *solicitor* the *depositholder*) at or before the making of this contract and this time is essential.
- 3.3 If the *deposit-bond* has an expiry date and completion does not occur by the date which is 14 days before the expiry date, the purchaser must *serve* a replacement *deposit-bond* at least 7 days before the expiry date. The time for service is essential.
- 3.4 The vendor must approve a replacement *deposit-bond* if –
- 3.4.1 it is from the same issuer and for the same amount as the earlier *deposit-bond*; and
- 3.4.2 it has an expiry date at least three months after its date of issue.
- 3.5 A breach of clauses 3.2 or 3.3 entitles the vendor to *terminate*. The right to *terminate* is lost as soon as –
- 3.5.1 the purchaser *serves* a replacement *deposit-bond*; or
- 3.5.2 the deposit is paid in full under clause 2.
- 3.6 Clauses 3.3 and 3.4 can operate more than once.
- 3.7 If the purchaser *serves* a replacement *deposit-bond*, the vendor must *serve* the earlier *deposit-bond*.
- 3.8 The amount of any *deposit-bond* does not form part of the price for the purposes of clause 16.7.
- 3.9 The vendor must give the purchaser the *deposit-bond* –
- 3.9.1 on completion; or
- 3.9.2 if this contract is *rescinded*.
- 3.10 If this contract is *terminated* by the vendor –
- 3.10.1 *normally*, the vendor can immediately demand payment from the issuer of the *deposit-bond*; or
- 3.10.2 if the purchaser *serves* prior to *termination* a notice disputing the vendor's right to *terminate*, the vendor must forward the *deposit-bond* (or its proceeds if called up) to the *depositholder* as stakeholder.
- 3.11 If this contract is *terminated* by the purchaser –
- 3.11.1 *normally*, the vendor must give the purchaser the *deposit-bond*; or
- 3.11.2 if the vendor *serves* prior to *termination* a notice disputing the purchaser's right to *terminate*, the vendor must forward the *deposit-bond* (or its proceeds if called up) to the *depositholder* as stakeholder.
- 4 Transfer**
- 4.1 *Normally*, the purchaser must *serve* at least 14 days before the date for completion –
- 4.1.1 the form of transfer; and
- 4.1.2 particulars required to register any mortgage or other dealing to be lodged with the transfer by the purchaser or the purchaser's mortgagee.
- 4.2 If any information needed for the form of transfer is not disclosed in this contract, the vendor must *serve* it.
- 4.3 If the purchaser *serves* a form of transfer and the transferee is not the purchaser, the purchaser must give the vendor a direction signed by the purchaser personally for this form of transfer.
- 4.4 The vendor can require the purchaser to include a form of covenant or easement in the transfer only if this contract contains the wording of the proposed covenant or easement, and a description of the land benefited.
- 5 Requisitions**
- 5.1 If a form of *requisitions* is attached to this contract, the purchaser is taken to have made those *requisitions*.
- 5.2 If the purchaser is or becomes entitled to make any other *requisition*, the purchaser can make it only by *serving* it –
- 5.2.1 if it arises out of this contract or it is a general question about the *property* or title - *within* 21 days after the contract date;
- 5.2.2 if it arises out of anything *served* by the vendor - *within* 21 days after the later of the contract date and that *service*; and
- 5.2.3 in any other case - *within* a reasonable time.
- 6 Error or misdescription**
- 6.1 The purchaser can (but only before completion) claim compensation for an error or misdescription in this contract (as to the *property*, the title or anything else and whether substantial or not).
- 6.2 This clause applies even if the purchaser did not take notice of or rely on anything in this contract containing or giving rise to the error or misdescription.
- 6.3 However, this clause does not apply to the extent the purchaser knows the true position.

7 Claims by purchaser

The purchaser can make a claim (including a claim under clause 6) before completion only by *serving* it with a statement of the amount claimed, and if the purchaser makes one or more claims before completion –

7.1 the vendor can *rescind* if in the case of claims that are not claims for delay –

7.1.1 the total amount claimed exceeds 5% of the price;

7.1.2 the vendor *serves* notice of intention to *rescind*; and

7.1.3 the purchaser does not *serve* notice waiving the claims *within* 14 days after that *service*; and

7.2 if the vendor does not *rescind*, the *parties* must complete and if this contract is completed –

7.2.1 the lesser of the total amount claimed and 10% of the price must be paid out of the price to and held by the *depositholder* until the claims are finalised or lapse;

7.2.2 the amount held is to be invested in accordance with clause 2.9;

7.2.3 the claims must be finalised by an arbitrator appointed by the *parties* or, if an appointment is not made *within* 1 month of completion, by an arbitrator appointed by the President of the Law Society at the request of a *party* (in the latter case the *parties* are bound by the terms of the Conveyancing Arbitration Rules approved by the Law Society as at the date of the appointment);

7.2.4 the purchaser is not entitled, in respect of the claims, to more than the total amount claimed and the costs of the purchaser;

7.2.5 net interest on the amount held must be paid to the *parties* in the same proportion as the amount held is paid; and

7.2.6 if the *parties* do not appoint an arbitrator and neither *party* requests the President to appoint an arbitrator *within* 3 months after completion, the claims lapse and the amount belongs to the vendor.

8 Vendor's rights and obligations

8.1 The vendor can *rescind* if –

8.1.1 the vendor is, on reasonable grounds, unable or unwilling to comply with a *requisition*;

8.1.2 the vendor *serves* a notice of intention to *rescind* that specifies the *requisition* and those grounds; and

8.1.3 the purchaser does not *serve* a notice waiving the *requisition within* 14 days after that *service*.

8.2 If the vendor does not comply with this contract (or a notice under or relating to it) in an essential respect, the purchaser can *terminate* by *serving* a notice. After the *termination* –

8.2.1 the purchaser can recover the deposit and any other money paid by the purchaser under this contract;

8.2.2 the purchaser can sue the vendor to recover damages for breach of contract; and

8.2.3 if the purchaser has been in possession a *party* can claim for a reasonable adjustment.

9 Purchaser's default

If the purchaser does not comply with this contract (or a notice under or relating to it) in an essential respect, the vendor can *terminate* by *serving* a notice. After the *termination* the vendor can –

9.1 keep or recover the deposit (to a maximum of 10% of the price);

9.2 hold any other money paid by the purchaser under this contract as security for anything recoverable under this clause –

9.2.1 for 12 months after the *termination*; or

9.2.2 if the vendor commences proceedings under this clause *within* 12 months, until those proceedings are concluded; and

9.3 sue the purchaser either –

9.3.1 where the vendor has resold the *property* under a contract made *within* 12 months after the *termination*, to recover –

- the deficiency on resale (with credit for any of the deposit kept or recovered and after allowance for any capital gains tax or goods and services tax payable on anything recovered under this clause); and
- the reasonable costs and expenses arising out of the purchaser's non-compliance with this contract or the notice of resale and any attempted resale; or

9.3.2 to recover damages for breach of contract.

10 Restrictions on rights of purchaser

10.1 The purchaser cannot make a claim or *requisition* or *rescind* or *terminate* in respect of –

10.1.1 the ownership or location of any fence as defined in the Dividing Fences Act 1991;

10.1.2 a service for the *property* being a joint service or passing through another property, or any service for another property passing through the *property* ('service' includes air, communication, drainage, electricity, garbage, gas, oil, radio, sewerage, telephone, television or water service);

10.1.3 a wall being or not being a party wall in any sense of that term or the *property* being affected by an easement for support or not having the benefit of an easement for support;

10.1.4 any change in the *property* due to fair wear and tear before completion;

- 10.1.5 a promise, representation or statement about this contract, the *property* or the title, not set out or referred to in this contract;
- 10.1.6 a condition, exception, reservation or restriction in a Crown grant;
- 10.1.7 the existence of any authority or licence to explore or prospect for gas, minerals or petroleum;
- 10.1.8 any easement or restriction on use the substance of either of which is disclosed in this contract or any non-compliance with the easement or restriction on use; or
- 10.1.9 anything the substance of which is disclosed in this contract (except a caveat, charge, mortgage, priority notice or writ).
- 10.2 The purchaser cannot *rescind* or *terminate* only because of a defect in title to or quality of the inclusions.
- 10.3 *Normally*, the purchaser cannot make a claim or *requisition* or *rescind* or *terminate* or require the vendor to change the nature of the title disclosed in this contract (for example, to remove a caution evidencing qualified title, or to lodge a plan of survey as regards limited title).
- 11 Compliance with work orders**
- 11.1 *Normally*, the vendor must by completion comply with a *work order* made on or before the contract date and if this contract is completed the purchaser must comply with any other *work order*.
- 11.2 If the purchaser complies with a *work order*, and this contract is *rescinded* or *terminated*, the vendor must pay the expense of compliance to the purchaser.
- 12 Certificates and inspections**
- The vendor must do everything reasonable to enable the purchaser, subject to the rights of any tenant –
- 12.1 to have the *property* inspected to obtain any certificate or report reasonably required;
- 12.2 to apply (if necessary in the name of the vendor) for –
- 12.2.1 any certificate that can be given in respect of the *property* under legislation; or
- 12.2.2 a copy of any approval, certificate, consent, direction, notice or order in respect of the *property* given under legislation, even if given after the contract date; and
- 12.3 to make 1 inspection of the *property* in the 3 days before a time appointed for completion.
- 13 Goods and services tax (GST)**
- 13.1 Terms used in this clause which are not defined elsewhere in this contract and have a defined meaning in the *GST Act* have the same meaning in this clause.
- 13.2 *Normally*, if a party must pay the price or any other amount to the other party under this contract, GST is not to be added to the price or amount.
- 13.3 If under this contract a party must make an adjustment or payment for an expense of another party or pay an expense payable by or to a third party (for example, under clauses 14 or 20.7) –
- 13.3.1 the party must adjust or pay on completion any GST added to or included in the expense; but
- 13.3.2 the amount of the expense must be reduced to the extent the party receiving the adjustment or payment (or the representative member of a GST group of which that party is a member) is entitled to an input tax credit for the expense; and
- 13.3.3 if the adjustment or payment under this contract is consideration for a taxable supply, an amount for GST must be added at the GST rate.
- 13.4 If this contract says this sale is the supply of a going concern –
- 13.4.1 the parties agree the supply of the *property* is a supply of a going concern;
- 13.4.2 the vendor must, between the contract date and completion, carry on the enterprise conducted on the land in a proper and business-like way;
- 13.4.3 if the purchaser is not registered by the date for completion, the parties must complete and the purchaser must pay on completion, in addition to the price, an amount being the price multiplied by the GST rate ("the retention sum"). The retention sum is to be held by the *depositholder* and dealt with as follows –
- if within 3 months of completion the purchaser serves a letter from the Australian Taxation Office stating the purchaser is registered with a date of effect of registration on or before completion, the *depositholder* is to pay the retention sum to the purchaser; but
 - if the purchaser does not serve that letter within 3 months of completion, the *depositholder* is to pay the retention sum to the vendor; and
- 13.4.4 if the vendor, despite clause 13.4.1, serves a letter from the Australian Taxation Office stating the vendor has to pay GST on the supply, the purchaser must pay to the vendor on demand the amount of GST assessed.
- 13.5 *Normally*, the vendor promises the margin scheme will not apply to the supply of the *property*.
- 13.6 If this contract says the margin scheme is to apply in making the taxable supply, the parties agree that the margin scheme is to apply to the sale of the *property*.
- 13.7 If this contract says the sale is not a taxable supply –
- 13.7.1 the purchaser promises that the *property* will not be used and represents that the purchaser does not intend the *property* (or any part of the *property*) to be used in a way that could make the sale a taxable supply to any extent; and

- 13.7.2 the purchaser must pay the vendor on completion in addition to the price, an amount calculated by multiplying the price by the GST rate if this sale is a taxable supply to any extent because of –
- a breach of clause 13.7.1; or
 - something else known to the purchaser but not the vendor.
- 13.8 If this contract says this sale is a taxable supply in full and does not say the margin scheme applies to the *property*, the vendor must pay the purchaser on completion an amount of one-eleventh of the price if –
- 13.8.1 this sale is not a taxable supply in full; or
- 13.8.2 the margin scheme applies to the *property* (or any part of the *property*).
- 13.9 If this contract says this sale is a taxable supply to an extent –
- 13.9.1 clause 13.7.1 does not apply to any part of the *property* which is identified as being a taxable supply; and
- 13.9.2 the payments mentioned in clauses 13.7 and 13.8 are to be recalculated by multiplying the relevant payment by the proportion of the price which represents the value of that part of the *property* to which the clause applies (the proportion to be expressed as a number between 0 and 1). Any evidence of value must be obtained at the expense of the vendor.
- 13.10 Normally, on completion the vendor must give the recipient of the supply a tax invoice for any taxable supply by the vendor by or under this contract.
- 13.11 The vendor does not have to give the purchaser a tax invoice if the margin scheme applies to a taxable supply.
- 13.12 If the vendor is liable for GST on rents or profits due to issuing an invoice or receiving consideration before completion, any adjustment of those amounts must exclude an amount equal to the vendor's GST liability.
- 13.13 If the purchaser must make an *RW payment* the purchaser must –
- 13.13.1 at least 5 days before the date for completion, serve evidence of submission of an *RW payment* notification form to the Australian Taxation Office by the purchaser or, if a direction under clause 4.3 has been served, by the transferee named in the transfer served with that direction;
- 13.13.2 produce on completion a *settlement cheque* for the *RW payment* payable to the Deputy Commissioner of Taxation;
- 13.13.3 forward the *settlement cheque* to the payee immediately after completion; and
- 13.13.4 serve evidence of receipt of payment of the *RW payment*.
- 14 Adjustments**
- 14.1 Normally, the vendor is entitled to the rents and profits and will be liable for all rates, water, sewerage and drainage service and usage charges, land tax, levies and all other periodic outgoings up to and including the *adjustment date* after which the purchaser will be entitled and liable.
- 14.2 The *parties* must make any necessary adjustment on completion.
- 14.3 If an amount that is adjustable under this contract has been reduced under *legislation*, the *parties* must on completion adjust the reduced amount.
- 14.4 The *parties* must not adjust surcharge land tax (as defined in the Land Tax Act 1956) but must adjust any other land tax for the year current at the *adjustment date* –
- 14.4.1 only if land tax has been paid or is payable for the year (whether by the vendor or by a predecessor in title) and this contract says that land tax is adjustable;
- 14.4.2 by adjusting the amount that would have been payable if at the start of the year –
- the person who owned the land owned no other land;
 - the land was not subject to a special trust or owned by a non-concessional company; and
 - if the land (or part of it) had no separate taxable value, by calculating its separate taxable value on a proportional area basis.
- 14.5 If any other amount that is adjustable under this contract relates partly to the land and partly to other land, the *parties* must adjust it on a proportional area basis.
- 14.6 Normally, the vendor can direct the purchaser to produce a *settlement cheque* on completion to pay an amount adjustable under this contract and if so –
- 14.6.1 the amount is to be treated as if it were paid; and
- 14.6.2 the *cheque* must be forwarded to the payee immediately after completion (by the purchaser if the *cheque* relates only to the *property* or by the vendor in any other case).
- 14.7 If on completion the last bill for a water, sewerage or drainage usage charge is for a period ending before the *adjustment date*, the vendor is liable for an amount calculated by dividing the bill by the number of days in the period then multiplying by the number of unbilled days up to and including the *adjustment date*.
- 14.8 The vendor is liable for any amount recoverable for work started on or before the contract date on the *property* or any adjoining footpath or road.
- 15 Date for completion**
- The *parties* must complete by the date for completion and, if they do not, a *party* can serve a notice to complete if that *party* is otherwise entitled to do so.

16 Completion**• Vendor**

- 16.1 On completion the vendor must give the purchaser any *document of title* that relates only to the *property*.
- 16.2 If on completion the vendor has possession or control of a *document of title* that relates also to other property, the vendor must produce it as and where necessary.
- 16.3 *Normally*, on completion the vendor must cause the legal title to the *property* (being an estate in fee simple) to pass to the purchaser free of any mortgage or other interest, subject to any necessary registration.
- 16.4 The legal title to the *property* does not pass before completion.
- 16.5 If the vendor gives the purchaser a document (other than the transfer) that needs to be lodged for registration, the vendor must pay the lodgement fee to the purchaser, plus another 20% of that fee.
- 16.6 If a *party serves* a land tax certificate showing a charge on any of the land, on completion the vendor must give the purchaser a land tax certificate showing the charge is no longer effective against the land.

• Purchaser

- 16.7 On completion the purchaser must pay to the vendor, by cash (up to \$2,000) or *settlement cheque* –
- 16.7.1 the price less any:
- deposit paid;
 - remittance amount payable;
 - *RW payment*; and
 - amount payable by the vendor to the purchaser under this contract; and
- 16.7.2 any other amount payable by the purchaser under this contract.
- 16.8 If the vendor requires more than 5 *settlement cheques*, the vendor must pay \$10 for each extra *cheque*.
- 16.9 If any of the deposit is not covered by a bond or guarantee, on completion the purchaser must give the vendor an order signed by the purchaser authorising the *depositholder* to account to the vendor for the deposit.
- 16.10 On completion the deposit belongs to the vendor.
- Place for completion**
- 16.11 *Normally*, the *parties* must complete at the completion address, which is –
- 16.11.1 if a special completion address is stated in this contract - that address; or
- 16.11.2 if none is stated, but a first mortgagee is disclosed in this contract and the mortgagee would usually discharge the mortgage at a particular place - that place; or
- 16.11.3 in any other case - the vendor's *solicitor's* address stated in this contract.
- 16.12 The vendor by reasonable notice can require completion at another place, if it is in NSW, but the vendor must pay the purchaser's additional expenses, including any agency or mortgagee fee.
- 16.13 If the purchaser requests completion at a place that is not the completion address, and the vendor agrees, the purchaser must pay the vendor's additional expenses, including any agency or mortgagee fee.

17 Possession

- 17.1 *Normally*, the vendor must give the purchaser vacant possession of the *property* on completion.
- 17.2 The vendor does not have to give vacant possession if –
- 17.2.1 this contract says that the sale is subject to existing tenancies; and
- 17.2.2 the contract discloses the provisions of the tenancy (for example, by attaching a copy of the lease and any relevant memorandum or variation).
- 17.3 *Normally*, the purchaser can claim compensation (before or after completion) or *rescind* if any of the land is affected by a protected tenancy (a tenancy affected by Part 2, 3, 4 or 5 Landlord and Tenant (Amendment) Act 1948).

18 Possession before completion

- 18.1 This clause applies only if the vendor gives the purchaser possession of the *property* before completion.
- 18.2 The purchaser must not before completion –
- 18.2.1 let or part with possession of any of the *property*;
- 18.2.2 make any change or structural alteration or addition to the *property*; or
- 18.2.3 contravene any agreement between the *parties* or any direction, document, *legislation*, notice or order affecting the *property*.
- 18.3 The purchaser must until completion –
- 18.3.1 keep the *property* in good condition and repair having regard to its condition at the giving of possession; and
- 18.3.2 allow the vendor or the vendor's authorised representative to enter and inspect it at all reasonable times.
- 18.4 The risk as to damage to the *property* passes to the purchaser immediately after the purchaser enters into possession.
- 18.5 If the purchaser does not comply with this clause, then without affecting any other right of the vendor –
- 18.5.1 the vendor can before completion, without notice, remedy the non-compliance; and

- 18.5.2 if the vendor pays the expense of doing this, the purchaser must pay it to the vendor with interest at the rate prescribed under s101 Civil Procedure Act 2005.
- 18.6 If this contract is *rescinded* or *terminated* the purchaser must immediately vacate the *property*.
- 18.7 If the *parties* or their *solicitors* on their behalf do not agree in writing to a fee or rent, none is payable.
- 19 Rescission of contract**
- 19.1 If this contract expressly gives a *party* a right to *rescind*, the *party* can exercise the right –
- 19.1.1 only by *serving* a notice before completion; and
- 19.1.2 in spite of any making of a claim or *requisition*, any attempt to satisfy a claim or *requisition*, any arbitration, litigation, mediation or negotiation or any giving or taking of possession.
- 19.2 *Normally*, if a *party* exercises a right to *rescind* expressly given by this contract or any *legislation* –
- 19.2.1 the deposit and any other money paid by the purchaser under this contract must be refunded;
- 19.2.2 a *party* can claim for a reasonable adjustment if the purchaser has been in possession;
- 19.2.3 a *party* can claim for damages, costs or expenses arising out of a breach of this contract; and
- 19.2.4 a *party* will not otherwise be liable to pay the other *party* any damages, costs or expenses.
- 20 Miscellaneous**
- 20.1 The *parties* acknowledge that anything stated in this contract to be attached was attached to this contract by the vendor before the purchaser signed it and is part of this contract.
- 20.2 Anything attached to this contract is part of this contract.
- 20.3 An area, bearing or dimension in this contract is only approximate.
- 20.4 If a *party* consists of 2 or more persons, this contract benefits and binds them separately and together.
- 20.5 A *party's solicitor* can receive any amount payable to the *party* under this contract or direct in writing that it is to be paid to another person.
- 20.6 A document under or relating to this contract is –
- 20.6.1 signed by a *party* if it is signed by the *party* or the *party's solicitor* (apart from a direction under clause 4.3);
- 20.6.2 served if it is served by the *party* or the *party's solicitor*;
- 20.6.3 served if it is served on the *party's solicitor*, even if the *party* has died or any of them has died;
- 20.6.4 served if it is served in any manner provided in s170 of the Conveyancing Act 1919;
- 20.6.5 served if it is sent by email or fax to the *party's solicitor*, unless in either case it is not received;
- 20.6.6 served on a person if it (or a copy of it) comes into the possession of the person; and
- 20.6.7 served at the earliest time it is served, if it is served more than once.
- 20.7 An obligation to pay an expense of another *party* of doing something is an obligation to pay –
- 20.7.1 if the *party* does the thing personally, the reasonable cost of getting someone else to do it; or
- 20.7.2 if the *party* pays someone else to do the thing - the amount paid, to the extent it is reasonable.
- 20.8 Rights under clauses 11, 13, 14, 17, 24, 30 and 31 continue after completion, whether or not other rights continue.
- 20.9 The vendor does not promise, represent or state that the purchaser has any cooling off rights.
- 20.10 The vendor does not promise, represent or state that any attached survey report is accurate or current.
- 20.11 A reference to any *legislation* (including any percentage or rate specified in *legislation*) is also a reference to any corresponding later *legislation*.
- 20.12 Each *party* must do whatever is necessary after completion to carry out the *party's* obligations under this contract.
- 20.13 Neither taking possession nor serving a transfer of itself implies acceptance of the *property* or the title.
- 20.14 The details and information provided in this contract (for example, on pages 1 - 3) are, to the extent of each *party's* knowledge, true, and are part of this contract.
- 20.15 Where this contract provides for choices, a choice in BLOCK CAPITALS applies unless a different choice is marked.
- 21 Time limits in these provisions**
- 21.1 If the time for something to be done or to happen is not stated in these provisions, it is a reasonable time.
- 21.2 If there are conflicting times for something to be done or to happen, the latest of those times applies.
- 21.3 The time for one thing to be done or to happen does not extend the time for another thing to be done or to happen.
- 21.4 If the time for something to be done or to happen is the 29th, 30th or 31st day of a month, and the day does not exist, the time is instead the last day of the month.
- 21.5 If the time for something to be done or to happen is a day that is not a *business day*, the time is extended to the next *business day*, except in the case of clauses 2 and 3.2.
- 21.6 *Normally*, the time by which something must be done is fixed but not essential.
- 22 Foreign Acquisitions and Takeovers Act 1975**
- 22.1 The purchaser promises that the Commonwealth Treasurer cannot prohibit and has not prohibited the transfer under the Foreign Acquisitions and Takeovers Act 1975.
- 22.2 This promise is essential and a breach of it entitles the vendor to *terminate*.

- 23 Strata or community title**
- **Definitions and modifications**
- 23.1 This clause applies only if the land (or part of it) is a lot in a strata, neighbourhood, precinct or community scheme (or on completion is to be a lot in a scheme of that kind).
- 23.2 In this contract –
- 23.2.1 'change', in relation to a scheme, means –
- a registered or registrable change from by-laws set out in this contract;
 - a change from a development or management contract or statement set out in this contract; or
 - a change in the boundaries of common property;
- 23.2.2 'common property' includes association property for the scheme or any higher scheme;
- 23.2.3 'contribution' includes an amount payable under a by-law;
- 23.2.4 'information certificate' includes a certificate under s184 Strata Schemes Management Act 2015 and s26 Community Land Management Act 1989;
- 23.2.5 'information notice' includes a strata information notice under s22 Strata Schemes Management Act 2015 and a notice under s47 Community Land Management Act 1989;
- 23.2.6 'normal expenses', in relation to an owners corporation for a scheme, means normal operating expenses usually payable from the administrative fund of an owners corporation for a scheme of the same kind;
- 23.2.7 'owners corporation' means the owners corporation or the association for the scheme or any higher scheme;
- 23.2.8 'the property' includes any interest in common property for the scheme associated with the lot; and
- 23.2.9 'special expenses', in relation to an owners corporation, means its actual, contingent or expected expenses, except to the extent they are –
- normal expenses;
 - due to fair wear and tear;
 - disclosed in this contract; or
 - covered by moneys held in the capital works fund.
- 23.3 Clauses 11, 14.8 and 18.4 do not apply to an obligation of the owners corporation, or to property insurable by it.
- 23.4 Clauses 14.4.2 and 14.5 apply but on a unit entitlement basis instead of an area basis.
- **Adjustments and liability for expenses**
- 23.5 The parties must adjust under clause 14.1 –
- 23.5.1 a regular periodic contribution;
- 23.5.2 a contribution which is not a regular periodic contribution but is disclosed in this contract; and
- 23.5.3 on a unit entitlement basis, any amount paid by the vendor for a normal expense of the owners corporation to the extent the owners corporation has not paid the amount to the vendor.
- 23.6 If a contribution is not a regular periodic contribution and is not disclosed in this contract –
- 23.6.1 the vendor is liable for it if it was determined on or before the contract date, even if it is payable by instalments; and
- 23.6.2 the purchaser is liable for all contributions determined after the contract date.
- 23.7 The vendor must pay or allow to the purchaser on completion the amount of any unpaid contributions for which the vendor is liable under clause 23.6.1.
- 23.8 Normally, the purchaser cannot make a claim or *requisition* or *rescind* or *terminate* in respect of –
- 23.8.1 an existing or future actual, contingent or expected expense of the owners corporation;
- 23.8.2 a proportional unit entitlement of the lot or a relevant lot or former lot, apart from a claim under clause 6; or
- 23.8.3 a past or future change in the scheme or a higher scheme.
- 23.9 However, the purchaser can *rescind* if –
- 23.9.1 the special expenses of the owners corporation at the later of the contract date and the creation of the owners corporation when calculated on a unit entitlement basis (and, if more than one lot or a higher scheme is involved, added together), less any contribution paid by the vendor, are more than 1% of the price;
- 23.9.2 in the case of the lot or a relevant lot or former lot in a higher scheme –
- a proportional unit entitlement for the lot is not disclosed in this contract; or
 - a proportional unit entitlement for the lot is disclosed in this contract but the lot has a different proportional unit entitlement at the contract date or at any time before completion;
- 23.9.3 a change before the contract date or before completion in the scheme or a higher scheme substantially disadvantages the purchaser and is not disclosed in this contract; or

- 23.9.4 a resolution is passed by the owners corporation before the contract date or before completion to give a strata renewal plan to the owners in the scheme for their consideration and there is not attached to this contract a strata renewal proposal or the strata renewal plan.

• **Notices, certificates and inspections**

- 23.10 The purchaser must give the vendor 2 copies of an information notice addressed to the owners corporation and signed by the purchaser.
- 23.11 The vendor must complete and sign 1 copy of the notice and give it to the purchaser on completion.
- 23.12 Each party can sign and give the notice as agent for the other.
- 23.13 The vendor must serve an information certificate issued after the contract date in relation to the lot, the scheme or any higher scheme at least 7 days before the date for completion.
- 23.14 The purchaser does not have to complete earlier than 7 days after service of the certificate and clause 21.3 does not apply to this provision. On completion the purchaser must pay the vendor the prescribed fee for the certificate.
- 23.15 The vendor authorises the purchaser to apply for the purchaser's own certificate.
- 23.16 The vendor authorises the purchaser to apply for and make an inspection of any record or other document in the custody or control of the owners corporation or relating to the scheme or any higher scheme.
- **Meetings of the owners corporation**
- 23.17 If a general meeting of the owners corporation is convened before completion –
- 23.17.1 if the vendor receives notice of it, the vendor must immediately notify the purchaser of it; and
- 23.17.2 after the expiry of any cooling off period, the purchaser can require the vendor to appoint the purchaser (or the purchaser's nominee) to exercise any voting rights of the vendor in respect of the lot at the meeting.

24 Tenancies

- 24.1 If a tenant has not made a payment for a period preceding or current at the *adjustment date* –
- 24.1.1 for the purposes of clause 14.2, the amount is to be treated as if it were paid; and
- 24.1.2 the purchaser assigns the debt to the vendor on completion and will if required give a further assignment at the vendor's expense.
- 24.2 If a tenant has paid in advance of the *adjustment date* any periodic payment in addition to rent, it must be adjusted as if it were rent for the period to which it relates.
- 24.3 If the *property* is to be subject to a tenancy on completion or is subject to a tenancy on completion –
- 24.3.1 the vendor authorises the purchaser to have any accounting records relating to the tenancy inspected and audited and to have any other document relating to the tenancy inspected;
- 24.3.2 the vendor must serve any information about the tenancy reasonably requested by the purchaser before or after completion; and
- 24.3.3 normally, the purchaser can claim compensation (before or after completion) if –
- a disclosure statement required by the Retail Leases Act 1994 was not given when required;
 - such a statement contained information that was materially false or misleading;
 - a provision of the lease is not enforceable because of a non-disclosure in such a statement; or
 - the lease was entered into in contravention of the Retail Leases Act 1994.
- 24.4 If the *property* is subject to a tenancy on completion –
- 24.4.1 the vendor must allow or transfer –
- any remaining bond money or any other security against the tenant's default (to the extent the security is transferable);
 - any money in a fund established under the lease for a purpose and compensation for any money in the fund or interest earned by the fund that has been applied for any other purpose; and
 - any money paid by the tenant for a purpose that has not been applied for that purpose and compensation for any of the money that has been applied for any other purpose;
- 24.4.2 if the security is not transferable, each party must do everything reasonable to cause a replacement security to issue for the benefit of the purchaser and the vendor must hold the original security on trust for the benefit of the purchaser until the replacement security issues;
- 24.4.3 the vendor must give to the purchaser –
- a proper notice of the transfer (an attornment notice) addressed to the tenant;
 - any certificate given under the Retail Leases Act 1994 in relation to the tenancy;
 - a copy of any disclosure statement given under the Retail Leases Act 1994;
 - a copy of any document served on the tenant under the lease and written details of its service, if the document concerns the rights of the landlord or the tenant after completion; and
 - any document served by the tenant under the lease and written details of its service, if the document concerns the rights of the landlord or the tenant after completion;
- 24.4.4 the vendor must comply with any obligation to the tenant under the lease, to the extent it is to be complied with by completion; and

- 24.4.5 the purchaser must comply with any obligation to the tenant under the lease, to the extent that the obligation is disclosed in this contract and is to be complied with after completion.
- 25 Qualified title, limited title and old system title**
- 25.1 This clause applies only if the land (or part of it) –
- 25.1.1 is under qualified, limited or old system title; or
- 25.1.2 on completion is to be under one of those titles.
- 25.2 The vendor must serve a proper abstract of title *within 7 days* after the contract date.
- 25.3 If an abstract of title or part of an abstract of title is attached to this contract or has been lent by the vendor to the purchaser before the contract date, the abstract or part is *served* on the contract date.
- 25.4 An abstract of title can be or include a list of documents, events and facts arranged (apart from a will or codicil) in date order, if the list in respect of each document –
- 25.4.1 shows its date, general nature, names of parties and any registration number; and
- 25.4.2 has attached a legible photocopy of it or of an official or registration copy of it.
- 25.5 An abstract of title –
- 25.5.1 must start with a good root of title (if the good root of title must be at least 30 years old, this means 30 years old at the contract date);
- 25.5.2 in the case of a leasehold interest, must include an abstract of the lease and any higher lease;
- 25.5.3 *normally*, need not include a Crown grant; and
- 25.5.4 need not include anything evidenced by the Register kept under the Real Property Act 1900.
- 25.6 In the case of land under old system title –
- 25.6.1 in this contract 'transfer' means conveyance;
- 25.6.2 the purchaser does not have to serve the form of transfer until after the vendor has served a proper abstract of title; and
- 25.6.3 each vendor must give proper covenants for title as regards that vendor's interest.
- 25.7 In the case of land under limited title but not under qualified title
- 25.7.1 *normally*, the abstract of title need not include any document which does not show the location, area or dimensions of the land (for example, by including a metes and bounds description or a plan of the land);
- 25.7.2 clause 25.7.1 does not apply to a document which is the good root of title; and
- 25.7.3 the vendor does not have to provide an abstract if this contract contains a delimitation plan (whether in registrable form or not).
- 25.8 The vendor must give a proper covenant to produce where relevant.
- 25.9 The vendor does not have to produce or covenant to produce a document that is not in the possession of the vendor or a mortgagee.
- 25.10 If the vendor is unable to produce an original document in the chain of title, the purchaser will accept a photocopy from the Registrar-General of the registration copy of that document.
- 26 Crown purchase money**
- 26.1 This clause applies only if purchase money is payable to the Crown, whether or not due for payment.
- 26.2 The vendor is liable for the money, except to the extent this contract says the purchaser is liable for it.
- 26.3 To the extent the vendor is liable for it, the vendor is liable for any interest until completion.
- 26.4 To the extent the purchaser is liable for it, the *parties* must adjust any interest under clause 14.1.
- 27 Consent to transfer**
- 27.1 This clause applies only if the land (or part of it) cannot be transferred without consent under *legislation* or a *planning agreement*.
- 27.2 The purchaser must properly complete and then serve the purchaser's part of an application for consent to transfer of the land (or part of it) *within 7 days* after the contract date.
- 27.3 The vendor must apply for consent *within 7 days* after *service* of the purchaser's part.
- 27.4 If consent is refused, *either party can rescind*.
- 27.5 If consent is given subject to one or more conditions that will substantially disadvantage a *party*, then that *party can rescind within 7 days* after receipt by or *service* upon the *party* of written notice of the conditions.
- 27.6 If consent is not given or refused –
- 27.6.1 *within 42 days* after the purchaser serves the purchaser's part of the application, the purchaser can *rescind*; or
- 27.6.2 *within 30 days* after the application is made, *either party can rescind*.
- 27.7 Each period in clause 27.6 becomes 90 days if the land (or part of it) is –
- 27.7.1 under a *planning agreement*; or
- 27.7.2 in the Western Division.
- 27.8 If the land (or part of it) is described as a lot in an unregistered plan, each time in clause 27.6 becomes the later of the time and 35 days after creation of a separate folio for the lot.
- 27.9 The date for completion becomes the later of the date for completion and 14 days after *service* of the notice granting consent to transfer.

28 Unregistered plan

- 28.1 This clause applies only if some of the land is described as a lot in an unregistered plan.
- 28.2 The vendor must do everything reasonable to have the plan registered *within* 6 months after the contract date, with or without any minor alteration to the plan or any document to be lodged with the plan validly required or made under *legislation*.
- 28.3 If the plan is not registered *within* that time and in that manner –
- 28.3.1 the purchaser can *rescind*; and
- 28.3.2 the vendor can *rescind*, but only if the vendor has complied with clause 28.2 and with any *legislation* governing the rescission.
- 28.4 Either *party* can serve notice of the registration of the plan and every relevant lot and plan number.
- 28.5 The date for completion becomes the later of the date for completion and 21 days after *service* of the notice.
- 28.6 Clauses 28.2 and 28.3 apply to another plan that is to be registered before the plan is registered.

29 Conditional contract

- 29.1 This clause applies only if a provision says this contract or completion is conditional on an event.
- 29.2 If the time for the event to happen is not stated, the time is 42 days after the contract date.
- 29.3 If this contract says the provision is for the benefit of a *party*, then it benefits only that *party*.
- 29.4 if anything is necessary to make the event happen, each *party* must do whatever is reasonably necessary to cause the event to happen.
- 29.5 A *party* can *rescind* under this clause only if the *party* has substantially complied with clause 29.4.
- 29.6 If the event involves an approval and the approval is given subject to a condition that will substantially disadvantage a *party* who has the benefit of the provision, the *party* can *rescind* *within* 7 days after either *party* serves notice of the condition.
- 29.7 If the *parties* can lawfully complete without the event happening
- 29.7.1 if the event does not happen *within* the time for it to happen, a *party* who has the benefit of the provision can *rescind* *within* 7 days after the end of that time;
- 29.7.2 if the event involves an approval and an application for the approval is refused, a *party* who has the benefit of the provision can *rescind* *within* 7 days after either *party* serves notice of the refusal; and
- 29.7.3 the date for completion becomes the later of the date for completion and 21 days after the earliest of –
- either *party* serving notice of the event happening;
 - every *party* who has the benefit of the provision serving notice waiving the provision; or
 - the end of the time for the event to happen.
- 29.8 If the *parties* cannot lawfully complete without the event happening –
- 29.8.1 if the event does not happen *within* the time for it to happen, either *party* can *rescind*;
- 29.8.2 if the event involves an approval and an application for the approval is refused, either *party* can *rescind*;
- 29.8.3 the date for completion becomes the later of the date for completion and 21 days after either *party* serves notice of the event happening.
- 29.9 A *party* cannot *rescind* under clauses 29.7 or 29.8 after the event happens.

30 Electronic transaction

- 30.1 This *Conveyancing Transaction* is to be conducted as an *electronic transaction* if –
- 30.1.1 this contract says that it is a proposed *electronic transaction*;
- 30.1.2 the parties otherwise agree that it is to be conducted as an *electronic transaction*; or
- 30.1.3 the *conveyancing rules* require it to be conducted as an *electronic transaction*.
- 30.2 However, this *Conveyancing Transaction* is not to be conducted as an *electronic transaction* –
- 30.2.1 if the land is not *electronically tradeable* or the transfer is not eligible to be lodged electronically; or
- 30.2.2 if, at any time after it has been agreed that it will be conducted as an *electronic transaction*, a *party* serves a notice that it will not be conducted as an *electronic transaction*.
- 30.3 If, because of clause 30.2.2, this *Conveyancing Transaction* is not to be conducted as an *electronic transaction* –
- 30.3.1 each *party* must –
- bear equally any disbursements or fees; and
 - otherwise bear that *party's* own costs; incurred because this *Conveyancing Transaction* was to be conducted as an *electronic transaction*; and
- 30.3.2 if a *party* has paid all of a disbursement or fee which, by reason of this clause, is to be borne equally by the *parties*, that amount must be adjusted under clause 14.2.

- 30.4 If this *Conveyancing Transaction* is to be conducted as an *electronic transaction* –
- 30.4.1 to the extent, but only to the extent, that any other provision of this contract is inconsistent with this clause, the provisions of this clause prevail;
- 30.4.2 normally, words and phrases used in this clause 30 (italicised and in Title Case, such as *Electronic Workspace* and *Lodgement Case*) have the same meaning which they have in the *participation rules*;
- 30.4.3 the parties must conduct the *electronic transaction* in accordance with the *participation rules* and the *ECNL*;
- 30.4.4 a party must pay the fees and charges payable by that party to the *ELNO* and the *Land Registry* as a result of this transaction being an *electronic transaction*;
- 30.4.5 any communication from one party to another party in the *Electronic Workspace* made –
- after the *effective date*; and
 - before the receipt of a notice given under clause 30.2.2;
- is taken to have been received by that party at the time determined by s13A of the *Electronic Transactions Act 2000*; and
- 30.4.6 a document which is an *electronic document* is served as soon as it is first *Digitally Signed* in the *Electronic Workspace* on behalf of the party required to serve it.
- 30.5 Normally, the vendor must within 7 days of the *effective date* –
- 30.5.1 create an *Electronic Workspace*;
- 30.5.2 populate the *Electronic Workspace* with *title data*, the date for completion and, if applicable, *mortgagee details*; and
- 30.5.3 invite the purchaser and any *discharging mortgagee* to the *Electronic Workspace*.
- 30.6 If the vendor has not created an *Electronic Workspace* in accordance with clause 30.5, the purchaser may create an *Electronic Workspace*. If the purchaser creates the *Electronic Workspace* the purchaser must –
- 30.6.1 populate the *Electronic Workspace* with *title data*;
- 30.6.2 create and populate an *electronic transfer*;
- 30.6.3 populate the *Electronic Workspace* with the date for completion and a nominated *completion time*; and
- 30.6.4 invite the vendor and any *incoming mortgagee* to join the *Electronic Workspace*.
- 30.7 Normally, within 7 days of receiving an invitation from the vendor to join the *Electronic Workspace*, the purchaser must –
- 30.7.1 join the *Electronic Workspace*;
- 30.7.2 create and populate an *electronic transfer*;
- 30.7.3 invite any *incoming mortgagee* to join the *Electronic Workspace*; and
- 30.7.4 populate the *Electronic Workspace* with a nominated *completion time*.
- 30.8 If the purchaser has created the *Electronic Workspace* the vendor must within 7 days of being invited to the *Electronic Workspace* –
- 30.8.1 join the *Electronic Workspace*;
- 30.8.2 populate the *Electronic Workspace* with *mortgagee details*, if applicable; and
- 30.8.3 invite any *discharging mortgagee* to join the *Electronic Workspace*.
- 30.9 To complete the financial settlement schedule in the *Electronic Workspace* –
- 30.9.1 the purchaser must provide the vendor with *adjustment figures* at least 2 *business days* before the date for completion; and
- 30.9.2 the vendor must populate the *Electronic Workspace* with payment details at least 1 *business day* before the date for completion.
- 30.10 At least 1 *business day* before the date for completion, the parties must ensure that –
- 30.10.1 all *electronic documents* which a party must *Digitally Sign* to complete the *electronic transaction* are populated and *Digitally Signed*;
- 30.10.2 all certifications required by the *ECNL* are properly given; and
- 30.10.3 they do everything else in the *Electronic Workspace* which that party must do to enable the *electronic transaction* to proceed to completion.
- 30.11 If completion takes place in the *Electronic Workspace* –
- 30.11.1 payment electronically on completion of the price in accordance with clause 16.7 is taken to be payment by a single *settlement cheque*;
- 30.11.2 the completion address in clause 16.11 is the *Electronic Workspace*; and
- 30.11.3 clauses 13.13.2 to 13.13.4, 16.8, 16.12, 16.13 and 31.2.2 to 31.2.4 do not apply.
- 30.12 If the computer systems of any of the *Land Registry*, the *ELNO* or the Reserve Bank of Australia are inoperative for any reason at the *completion time* agreed by the parties, a failure to complete this contract for that reason is not a default under this contract on the part of either party.
- 30.13 If the *Electronic Workspace* allows the parties to choose whether financial settlement is to occur despite the computer systems of the *Land Registry* being inoperative for any reason at the *completion time* agreed by the parties –
- 30.13.1 normally, the parties must choose that financial settlement not occur; however

30.13.2 if both *parties* choose that financial settlement is to occur despite such failure and financial settlement occurs –

- all *electronic documents Digitally Signed* by the vendor, the *certificate of title* and any discharge of mortgage, withdrawal of caveat or other *electronic document* forming part of the *Lodgement Case* for the *electronic transaction* shall be taken to have been unconditionally and irrevocably delivered to the purchaser or the purchaser's mortgagee at the time of financial settlement together with the right to deal with the land comprised in the *certificate of title*; and
- the vendor shall be taken to have no legal or equitable interest in the *property*.

30.14 A party who holds a *certificate of title* must act in accordance with any *Prescribed Requirement* in relation to the *certificate of title* but if there is no *Prescribed Requirement*, the vendor must serve the *certificate of title* after completion.

30.15 If the *parties* do not agree about the delivery before completion of one or more documents or things that cannot be delivered through the *Electronic Workspace*, the party required to deliver the documents or things –

30.15.1 holds them on completion in escrow for the benefit of; and

30.15.2 must immediately after completion deliver the documents or things to, or as directed by; the party entitled to them.

30.16 In this clause 30, these terms (in any form) mean –

adjustment figures
certificate of title

details of the adjustments to be made to the price under clause 14;
the paper duplicate of the folio of the register for the land which exists immediately prior to completion and, if more than one, refers to each such paper duplicate;

completion time

the time of day on the date for completion when the *electronic transaction* is to be settled;

conveyancing rules

the rules made under s12E of the Real Property Act 1900;

discharging mortgagee

any discharging mortgagee, chargee, covenant chargee or caveator whose provision of a *Digitally Signed* discharge of mortgage, discharge of charge or withdrawal of caveat is required in order for unencumbered title to the *property* to be transferred to the purchaser;

ECNL

effective date

the Electronic Conveyancing National Law (NSW);
the date on which the *Conveyancing Transaction* is agreed to be an *electronic transaction* under clause 30.1.2 or, if clauses 30.1.1 or 30.1.3 apply, the contract date;

electronic document

a dealing as defined in the Real Property Act 1900 which may be created and *Digitally Signed* in an *Electronic Workspace*;

electronic transfer

a transfer of land under the Real Property Act 1900 for the *property* to be prepared and *Digitally Signed* in the *Electronic Workspace* established for the purposes of the *parties' Conveyancing Transaction*;

electronic transaction

a *Conveyancing Transaction* to be conducted for the *parties* by their legal representatives as *Subscribers* using an *ELN* and in accordance with the *ECNL* and the *participation rules*;

electronically tradeable

a land title that is Electronically Tradeable as that term is defined in the *conveyancing rules*;

incoming mortgagee

any mortgagee who is to provide finance to the purchaser on the security of the *property* and to enable the purchaser to pay the whole or part of the price;

mortgagee details

the details which a party to the *electronic transaction* must provide about any *discharging mortgagee* of the *property* as at completion;

participation rules

the participation rules as determined by the *ENCL*;

populate

title data

to complete data fields in the *Electronic Workspace*; and
the details of the title to the *property* made available to the *Electronic Workspace* by the *Land Registry*.

31 Foreign Resident Capital Gains Withholding

31.1 This clause applies only if –

31.1.1 the sale is not an excluded transaction within the meaning of s14-215 of Schedule 1 to the *TA Act*; and

31.1.2 a *clearance certificate* in respect of every vendor is not attached to this contract.

31.2 The purchaser must –

31.2.1 at least 5 days before the date for completion, serve evidence of submission of a purchaser payment notification to the Australian Taxation Office by the purchaser or, if a direction under clause 4.3 has been served, by the transferee named in the transfer served with that direction;

31.2.2 produce on completion a *settlement cheque* for the *remittance amount* payable to the Deputy Commissioner of Taxation;

31.2.3 forward the *settlement cheque* to the payee immediately after completion; and

- 31.2.4 *serve* evidence of receipt of payment of the *remittance amount*.
- 31.3 The vendor cannot refuse to complete if the purchaser complies with clauses 31.2.1 and 31.2.2.
- 31.4 If the vendor *serves* any *clearance certificate* or *variation*, the purchaser does not have to complete earlier than 7 days after that *service* and clause 21.3 does not apply to this provision.
- 31.5 If the vendor *serves* in respect of every vendor either a *clearance certificate* or a *variation* to 0.00 percent, clauses 31.2 and 31.3 do not apply.

23/79-87 UNION RD PENRITH 2750

SECTION 66W CERTIFICATE

I,
of , , certify as follows:

1. I am a _____ currently admitted to practise in New South Wales;
2. I am giving this certificate in accordance with section 66W of the Conveyancing Act 1919 with reference to a contract for the sale of property at **23/79-81 UNION RD PENRITH 2750** from **LEE LEE SUN** to in order that there is no cooling off period in relation to that contract;
3. I do not act for **LEE LEE SUN** and am not employed in the legal practice of a solicitor acting for **LEE LEE SUN** nor am I a member or employee of a firm of which a solicitor acting for **LEE LEE SUN** is a member or employee; and
4. I have explained to :
 - (a) The effect of the contract for the purchase of that property;
 - (b) The nature of this certificate; and
 - (c) The effect of giving this certificate to the vendor, i.e. that there is no cooling off period in relation to the contract.

Date:

SPECIAL CONDITIONS TO AGREEMENT FOR SALE OF LAND BETWEEN
(VENDOR) **(PURCHASER)**

and

1. Amendment to the standard clauses of the contract:

- Clause 7.1.1 to be deleted;
- Clause 7.2.1: "10%" is to be reduced to "1%";
- Clause 8.1: the words "on reasonable grounds" to be deleted;
- Clause 10.1.8 & 10.1.9: replace the word "substance" with "existence";
- Clause 16.5: delete the words "plus another 20% of that fee";
- Clause 16.7: delete the words "cash (up to \$2000.00) or"; replace the word "settlement" with "bank";
- Clause 16.8: replace the word "settlement" with "bank" and replace "\$10" with "\$5";
- Clause 23.14 to be deleted;
- Clause 24.1 & 24.4.1 to be deleted;

2. Finance

The Purchaser warrants to the Vendor that either the Purchaser does not require credit in order to pay for the property, or, if the Purchaser requires credit in order to pay for the property, the Purchaser has already obtained such credit under his own terms. The Purchaser cannot terminate this contract by virtue of any non-availability of credit as at the date of the completion.

3. Foreign Persons

3.1 The purchaser warrants and represents to the vendor that at the time of entering into this Contract the purchaser is a resident of Australia or the purchaser has been granted with FIRB approval for the purchase of the property under the contract if the purchaser is a non-resident of Australia.

3.2 In the event of a breach of the warranty contained in this special condition the Purchaser indemnified and compensate the Vendor in respect of any loss, damage, penalty, fine or legal costs which may be incurred by the Vendor as a consequences thereof. This warranty and indemnity shall not merge on completion.

4. Inconsistency

These special conditions shall prevail over the standard provision of the contract in the event of inconsistency.

5. Present Condition

5.1 The Purchaser acknowledges the property is being purchased in its present condition and state of repair with all faults latent and patent or with any defects as regards a construction or repair of any improvements thereon, and subject to any infestation and dilapidation.

5.2 The Purchaser acknowledges that he is purchasing the same in reliance upon his own inspection, enquiries and knowledge and no promises, representation, warranty or undertaking has been given by or on behalf of the Vendor in respect of the suitability of the property or the provision for services and amenities therein for any business or

other purposes and whether or not any of the improvements upon the property are subject to or insured under the provisions of the Builders Licensing Act 1971, the Home Building Act 1989, or the Building Services Corporation Act 1980 and that he shall make no objection, requisition or claim for compensation and shall not be entitled to rescind, delay completion or terminate this Agreement in respect of any or any of the matters referred to in or arising from this Clause.

6. Deposit

Notwithstanding any other provision of this contract, if

- The deposit agreed to be paid by the purchaser on exchange of contracts is less than ten per cent (10%) of the purchase price; and
- The vendor becomes entitled to forfeit the deposit due to default of the purchaser, the purchaser will immediately upon demand pay to the vendor the difference between ten (10%) percent of the purchase price and the amount actually paid on exchange of contracts.

7. Release of Deposit

7.1 Notwithstanding anything elsewhere contained in this Contract, should the Purchaser enter possession of the subject property the Depositholder shall forthwith and without further authority account to the Vendor for the deposit.

7.2 The Purchaser agrees to release to the Vendor so much of the deposit as may be required for use by the Vendor as a deposit to purchaser another property, the payment of stamp duty and disbursements associated with such purchase. No further authority or consent shall be required from the Purchaser other than as contained in this special condition.

8. Agency Commission

The Purchaser warrants to the Vendor that the Purchaser has not been introduced to the property by any estate agent or agency other than the agent or agency (if any) nominated on the front page of the Contract, and hereby agrees to indemnify the Vendor against any claim by any estate agent or agency due to the Purchaser's breach or alleged breach of this warranty to the intent that all damages costs and expenses on a solicitor and client basis which may be incurred by the Vendor in respect of any such claim or alleged claim shall be paid by the Purchaser to the Vendor. This special condition of this agreement and warranty shall ensure and remain in full force and effect notwithstanding completion hereof and shall not be deemed to merge on completion of this agreement.

9. Purchaser's Objections and Requisitions

The Purchaser shall make no objection requisition or claim for compensation in respect of the fact that there may be any outstanding Orders from any Governmental, semi-governmental, or local Governmental bodies requiring the carrying out of any work to any building presently erected on the subject land.

Notwithstanding the provisions of Clause 7(1) of the Agreement, the parties expressly agree that any claims for compensation shall be deemed to be an objection or requisition for the purposes of Clause 8 of the Agreement.

10. Representations

The Purchaser acknowledges that the provisions of this Agreement constitute the full and complete understanding between the parties and that there is no other

understanding, agreement, warranty or representation whether express or implied in any way extending, defining or otherwise relating to the provisions of this Agreement or binding on the parties hereto with respect to any of the matters to which this Agreement relates.

11. Death, Illness etc.

Notwithstanding any rule of law or equity to the contrary should either party prior to completion:

- (a) die or become mentally ill then the other party may by notice served on the first party rescind this agreement such rescission shall be a rescission pursuant to Clause 19 hereof or,
- (b) be declared bankrupt or enter into any scheme or make any assignment for the benefit of creditors or being a company resolve to go into liquidation or have a petition for its winding up presented or enter into a scheme of arrangement with its creditors, or should a liquidator, receiver or official manager be appointed in respect thereof then the party shall be deemed to be in default hereunder and the other party shall be at liberty to exercise all or any of its rights conferred under the contract.

12. Mortgage, Caveat etc.

On completion the Purchaser shall accept a registrable form of discharge of any mortgage or withdrawal of any caveat or surrender of any expired lease then on the title together with either any documents necessary to procure registration thereof or any evidence of production thereof to the Land Titles Office and together with the registration fee payable in respect thereof.

13. Late completion

In the event that this Agreement is not completed within the time prescribed in this agreement, then from that date (or if the Vendor is not ready and willing to complete on that date from such later date on which the Vendor is ready and willing to complete) and up to and including the date of completion the Purchaser shall pay to the Vendor interest, on or before settlement, on the balance of the purchase price at the rate of 10% per annum. The purchaser acknowledges that payment of interest in accordance with this condition is an essential term of this contract. The parties acknowledge that such interest is a genuine pre-estimate of the damage which the Vendor may suffer by delay in completion. In addition the Purchaser shall pay the sum of \$275.00 to cover legal costs and expenses incurred by the Vendor as a consequence of the delay, as a genuine pre estimate of these additional expenses, to be allowed by the Purchaser as an additional adjustment on completion.

14. Notice to Complete

In addition to the rights set out in Special Condition 9 above the Purchaser agrees that in the event that this Agreement is not completed within the time prescribed in this agreement, then at any time thereafter either party shall be entitled to give the other party a Notice to Complete requiring completion of this Agreement within a period of not less than fourteen (14) days after the service of such Notice (being fourteen days exclusive of day of service but inclusive of the last day prescribed by the Notice for completion) and making time of the essence of this Agreement in 5

such regard and such period of fourteen days for all purposes shall be deemed a reasonable time and provided either shall be entitled to withdraw any Notice to Complete issued pursuant to this Clause and subsequently issue a further Notice in lieu thereof.

15. Payment of deposit

Notwithstanding any other provisions in this agreement the purchaser authorises the Depositholder to pay all or part of the deposit herein, as required, to the vendor's solicitors or as they may direct to be applied at the vendor's sole discretion.

16. Tenancy

If the property is sold subject to any tenancy, the vendor does not warrant that the tenant will continue to remain in the property after completion. If the lease has expired and the purchaser requires vacant possession at settlement, the purchaser must advise the vendor in writing, within 3 days after the contract exchange date. If the purchaser does not serve written notice to vendor in accordance with this cause, the purchaser must accept the tenancy on settlement.

17. Adjustments on outgoings

The parties agree to adjust all usual outgoings and all amounts under the contract on settlement, however, if any amount is incorrectly calculated, overlooked or an error is made in such calculations the parties agree to correct such error to reimburse each other accordingly after settlement. This clause shall not merge on completion.

18. Section 184 and section 26 certificates

The vendor is not obliged to give the purchaser a certificate under section 184 of the Strata Management Act or section 26 of the Community Land Management Act. The vendor authorises the purchaser to apply for the said certificates.

19. Guarantee and Indemnity

If the purchaser is a company and in consideration of the vendor entering into this contract with the purchaser, it is an essential clause of this contract that the directors of the Purchaser jointly and severally guarantee to the Vendor the due and punctual performance and observance by the Purchaser of its obligation under this contract and indemnify and must keep indemnified the Vendor against all losses, damages, liabilities, costs and expenses accruing to the Vendor, resulting or arising from any failure by the Purchaser to perform or observe any of the obligations on its part to be performed or observed. This guarantee and indemnity is a continuing obligation and cannot be abrogated, prejudiced or discharged by any waiver by the vendor or by any matter including in the event of termination or rescission of contract. This guarantee and indemnity is deemed to constitute a principal obligation between the Guarantor and the Vendor



LAND
REGISTRY
SERVICES

Order number: 52679791
Your Reference: 1808121
15/08/18 15:43



NSW LRS - Title Search

NEW SOUTH WALES LAND REGISTRY SERVICES - TITLE SEARCH

FOLIO: 23/SP79328

SEARCH DATE	TIME	EDITION NO	DATE
15/8/2018	3:43 PM	4	11/12/2014

LAND

LOT 23 IN STRATA PLAN 79328
AT PENRITH
LOCAL GOVERNMENT AREA PENRITH

FIRST SCHEDULE

LEE LEE SUN

(T AJ110344)

SECOND SCHEDULE (2 NOTIFICATIONS)

- 1 INTERESTS RECORDED ON REGISTER FOLIO CP/SP79328
- 2 AJ110345 MORTGAGE TO BANK OF CHINA (AUSTRALIA) LIMITED

NOTATIONS

UNREGISTERED DEALINGS: NIL

*** END OF SEARCH ***

PRINTED ON 15/8/2018

* Any entries preceded by an asterisk do not appear on the current edition of the Certificate of Title. Warning: the information appearing under notations has not been formally recorded in the Register.

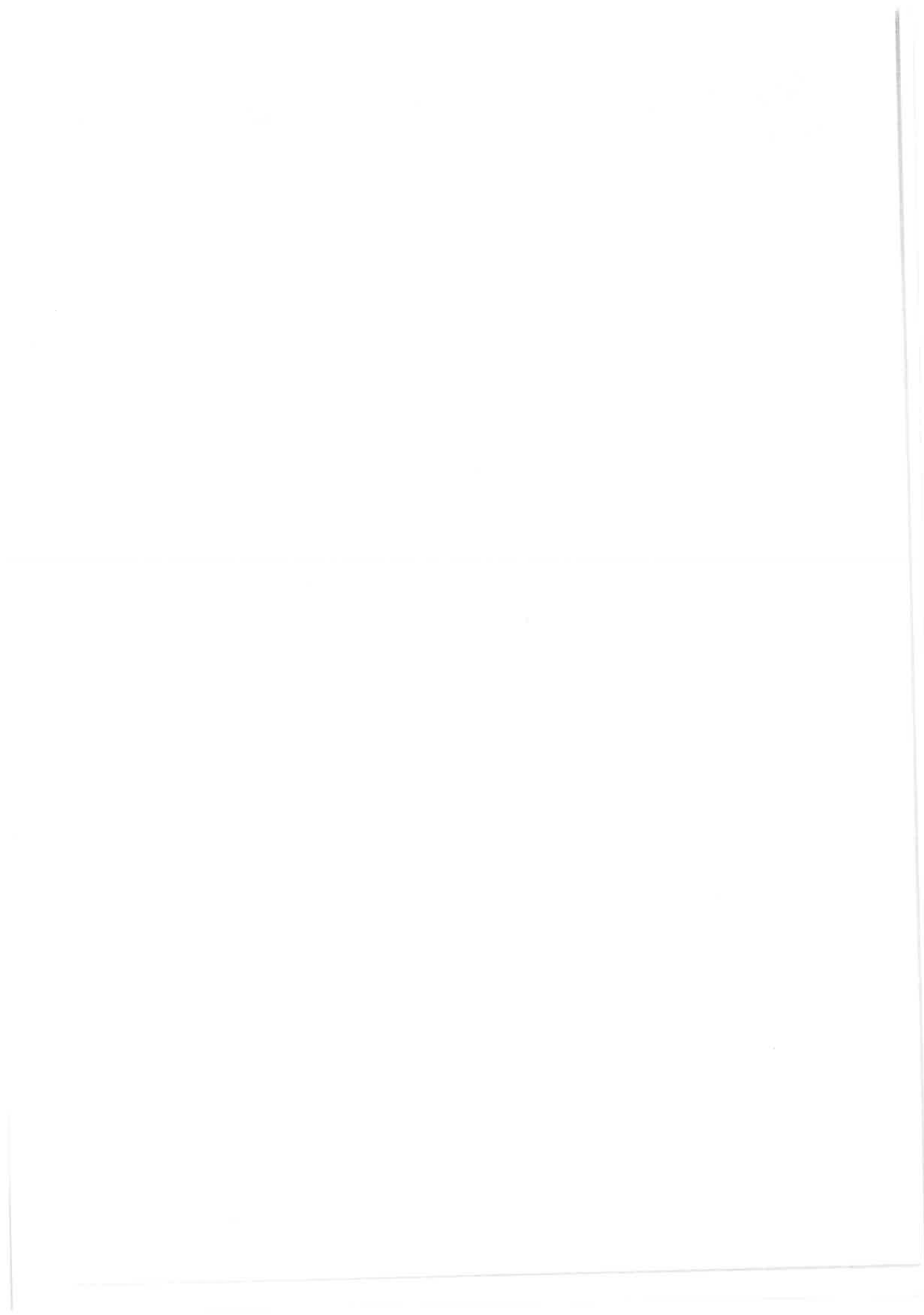



NSW LRS - Title Search

NEW SOUTH WALES LAND REGISTRY SERVICES - TITLE SEARCH

FOLIO: CP/SP79328

SEARCH DATE	TIME	EDITION NO	DATE
-----	----	-----	----
15/8/2018	3:52 PM	1	8/8/2007

LAND

THE COMMON PROPERTY IN THE STRATA SCHEME BASED ON STRATA PLAN 79328
WITHIN THE PARCEL SHOWN IN THE TITLE DIAGRAM

AT PENRITH
LOCAL GOVERNMENT AREA PENRITH
PARISH OF MULGOA COUNTY OF CUMBERLAND
TITLE DIAGRAM SP79328

FIRST SCHEDULE

THE OWNERS - STRATA PLAN NO. 79328
ADDRESS FOR SERVICE OF DOCUMENTS:
79 - 81 UNION ROAD
PENRITH
N.S.W 2750

SECOND SCHEDULE (6 NOTIFICATIONS)

- 1 RESERVATIONS AND CONDITIONS IN THE CROWN GRANT(S)
- 2 ATTENTION IS DIRECTED TO THE MIXED USE SCHEMES MODEL BY-LAWS
CONTAINED IN THE STRATA SCHEMES MANAGEMENT REGULATION APPLICABLE
AT THE DATE OF REGISTRATION OF THE SCHEME
KEEPING OF ANIMALS - OPTION A HAS BEEN ADOPTED
- 3 AD296262 POSITIVE COVENANT
- 4 DP1116003 EASEMENT FOR PADMOUNT SUBSTATION 2.79 METRE(S) WIDE
AFFECTING THE PART(S) SHOWN SO BURDENED IN THE TITLE
DIAGRAM
- 5 DP1116003 RESTRICTION(S) ON THE USE OF LAND REFERRED TO AND
NUMBERED (2) IN THE S. 88B INSTRUMENT
- 6 DP1116003 RESTRICTION(S) ON THE USE OF LAND REFERRED TO AND
NUMBERED (3) IN THE S. 88B INSTRUMENT

SCHEDULE OF UNIT ENTITLEMENT (AGGREGATE: 10000)

STRATA PLAN 79328

LOT	ENT	LOT	ENT	LOT	ENT	LOT	ENT
1 - 248		2 - 248		3 - 265		4 - 295	
5 - 261		6 - 286		7 - 316		8 - 244	
9 - 240		10 - 253		11 - 248		12 - 257	
13 - 257		14 - 358		15 - 349		16 - 328	
17 - 358		18 - 358		19 - 328		20 - 366	

END OF PAGE 1 - CONTINUED OVER

PRINTED ON 15/8/2018

NEW SOUTH WALES LAND REGISTRY SERVICES - TITLE SEARCH

FOLIO: CP/SP79328

PAGE 2

SCHEDULE OF UNIT ENTITLEMENT (AGGREGATE: 10000) (CONTINUED)

STRATA PLAN 79328

LOT	ENT	LOT	ENT	LOT	ENT	LOT	ENT
21 -	383	22 -	404	23 -	366	24 -	244
25 -	223	26 -	248	27 -	295	28 -	269
29 -	261	30 -	316	31 -	286	32 -	404
33 -	438						

NOTATIONS

UNREGISTERED DEALINGS: NIL

*** END OF SEARCH ***

PRINTED ON 15/8/2018

* Any entries preceded by an asterisk do not appear on the current edition of the Certificate of Title. Warning: the information appearing under notations has not been formally recorded in the Register.
© Office of the Registrar-General 2018

SAI Global Property Division an approved NSW Information Broker hereby certifies that the information contained in this document has been provided electronically by the Registrar General in accordance with section 96B(2) of the Real Property Act 1900.

SP79328

M.G.A.

Reduction Ratio ≥ 250

Lengths are in metres

Registered Surveyor
James F. Brock

Arak
Sales/Marketing Director / Regional Manager / Accredited Partner

LOWER BASEMENT CARPARKING

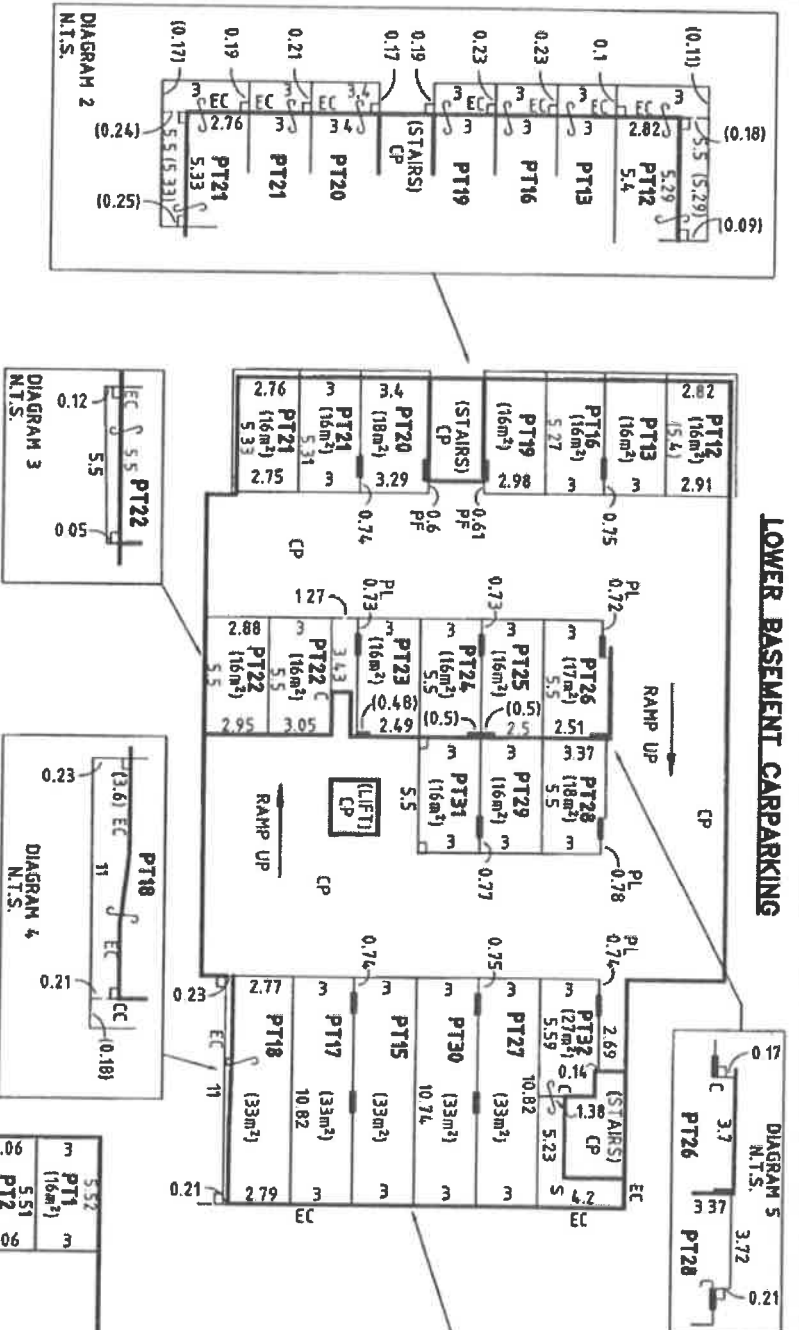

SP79328

UPPER BASEMENT CARPARKING

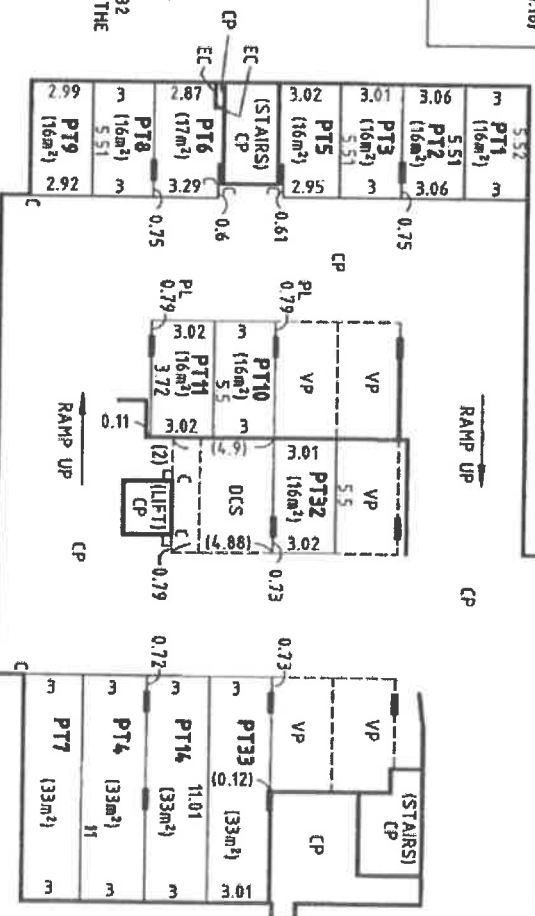

PF PROLONGATION OF FACE OF COLUMN
 PL PROLONGATION OF CENTRE OF COLUMN
 CC CORNER CONCRETE SLAB
 C CORNER OF WALL
 EC EDGE OF CONCRETE SLAB
 CP COMMON PROPERTY
 DCS DISABLED CARSPACE (COMMON PROPERTY)
 S STORAGE
 VP VISITOR PARKING (COMMON PROPERTY)

90° ANGLE

PARTS OF THE STRUCTURE OF THE IRREGULAR BASEMENT WALLS WHICH PARTLY PROTRUDE INTO THE CARSPACES ADJACENT TO THE EDGE OF CONCRETE SLAB AS SHOWN ARE COMMON PROPERTY.

THE AIR CONDITIONING UNITS ADJACENT TO PT 1 AND PT 9 IN THE UPPER BASEMENT CARPARK SERVING UNITS 32 AND 33 RESPECTIVELY FORM PART OF THE LOT AND ARE NOT COMMON PROPERTY.

AREAS ARE APPROXIMATE ONLY AND ARE SHOWN FOR THE PURPOSES OF THE STRATA SCHEMES (FREEHOLD DEVELOPMENT) ACT 1973, ONLY.

DENOTES CENTRE OF COLUMN AT FACE

Reduction Ratio 250

Lengths are in metres

Registered Surveyor

Authorised Person/Manager/Notarised Certifier

S
SP79328

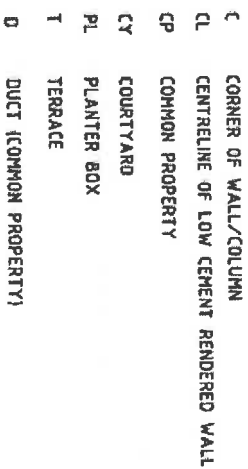

AREAS ARE APPROXIMATE ONLY AND ARE SHOWN FOR THE PURPOSES OF THE STRATA SCHEMES (FREEHOLD DEVELOPMENT) ACT 1973, ONLY.

Lengths are in metres

[Signature]
 -Authorized Person/Personal Manager/ Accredited Certifier

SP79328

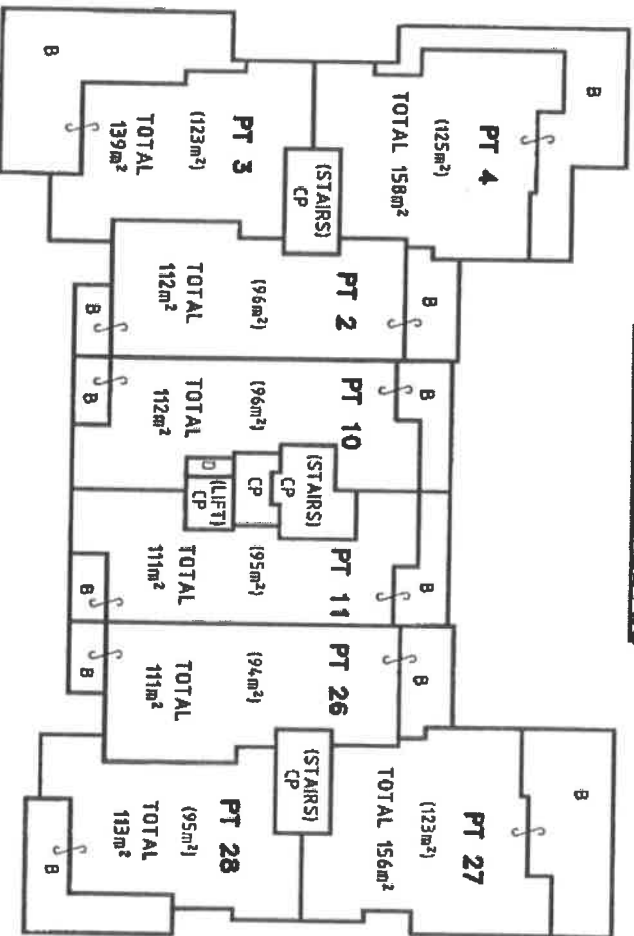
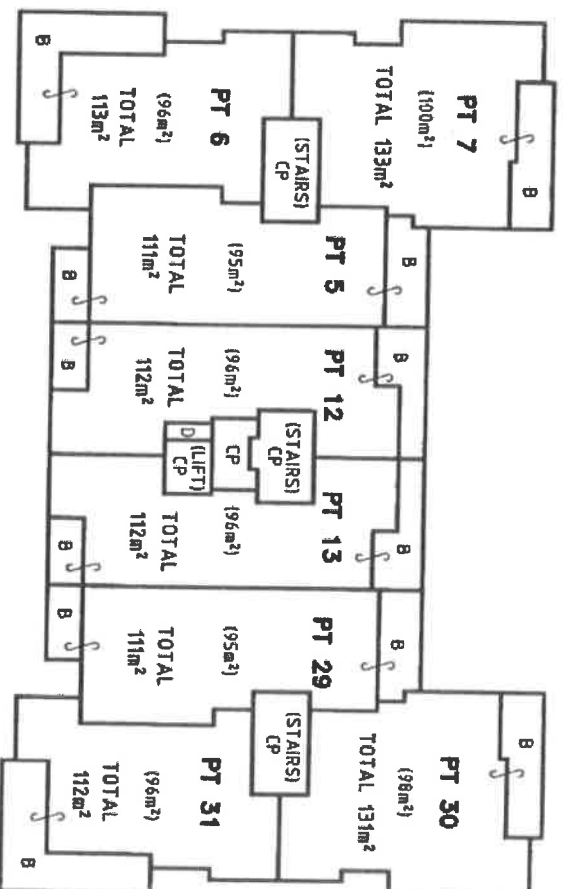
FIRST FLOOR LEVEL**SECOND FLOOR LEVEL**

THE SLIDING METAL LOUVER SCREENS WITHIN THE BALCONIES OF LOTS 12 AND 13 FORM PART OF THE LOT AND ARE NOT COMMON PROPERTY.

THE TIMBER PERGOLAS SITUATED WITHIN THE BALCONIES OF LOTS 3, 4, 27 & 28 FORM PART OF THE LOT AND ARE NOT COMMON PROPERTY.

THE STRUTTING OF THE BALCONIES IS LIMITED IN HEIGHT TO 3 METRES ABOVE THE UPPER SURFACE OF THEIR RESPECTIVE TILED BASE, EXCEPT WHERE COVERED.

B BALCONY
D DUCT (COMMON PROPERTY)
CP COMMON PROPERTY

AREAS ARE APPROXIMATE ONLY AND ARE SHOWN FOR THE PURPOSES OF THE STRATA SCHEMES (FREEHOLD DEVELOPMENT) ACT 1973, ONLY.

Reduction Ratio 1/250

Robert T. Brock
Registered Surveyor

Lengths are in metres

Archie R.
Authorised Person/Manager/Accredited Officer

THIRD FLOOR LEVEL

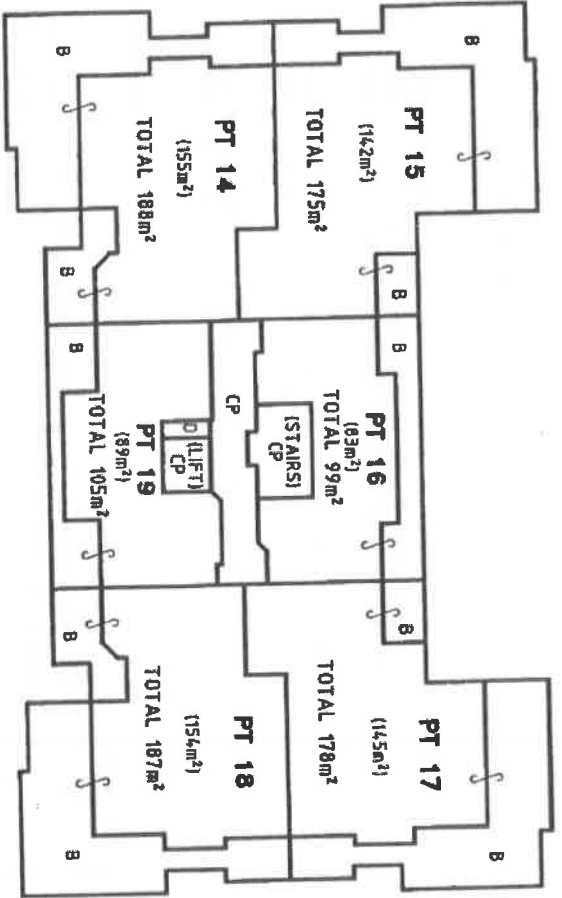

FOURTH FLOOR LEVEL

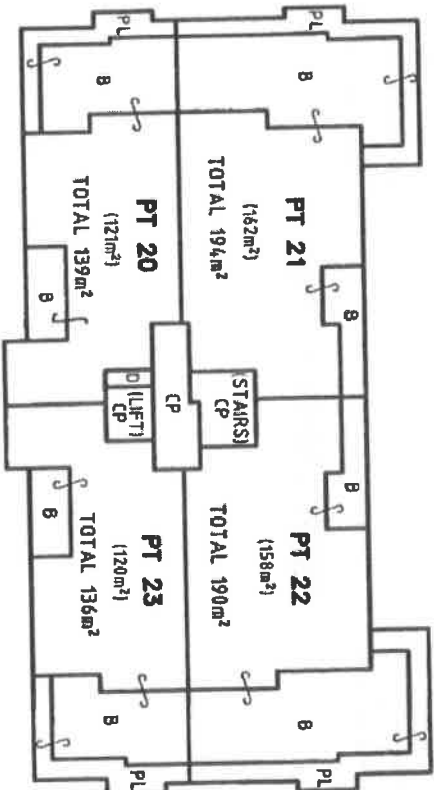

THE SLIDING METAL LOUVER SCREEN WITHIN THE BALCONY OF LOT 16 FORMS PART OF THE LOT AND IS NOT COMMON PROPERTY.

THE AIR CONDITIONING UNITS LOCATED ON THE ROOF OF THE BUILDING SERVICING LOTS 20, 21, 22 & 23 FORM PART OF THE LOT AND ARE NOT COMMON PROPERTY.

THE TIMBER PERGOLAS SITUATED WITHIN THE BALCONIES OF LOTS 14, 15, 17 & 18 FORM PART OF THE LOT AND ARE NOT COMMON PROPERTY.

THE STRUTUM OF THE BALCONIES IS LIMITED IN HEIGHT TO 3 METRES ABOVE THE UPPER SURFACE OF THEIR RESPECTIVE TILED BASE, EXCEPT WHERE COVERED.

THE STRUTUM OF THE PLANTER BOXES IS LIMITED IN HEIGHT TO 3 METRES ABOVE THE UPPER SURFACE OF THEIR RESPECTIVE CONCRETE BASE, EXCEPT WHERE COVERED.

- B BALCONY
- CP COMMON PROPERTY
- D DUCT (COMMON PROPERTY)
- PL PLANTER BOX

AREAS ARE APPROXIMATE ONLY AND ARE SHOWN FOR THE PURPOSES OF THE STRATA SCHEMES (FREEDHOLD DEVELOPMENT) ACT 1973, ONLY.

Reduction Ratio & 250

Lengths are in metres

Robert J. Brock
Registered Surveyor

John A. D. D.
Registered Surveyor / Licensed Valuer / Licensed Certifier

**INSTRUMENT SETTING OUT TERMS OF EASEMENT AND RESTRICTIONS ON
THE USE OF LAND INTENDED TO BE CREATED PURSUANT TO SECTION 88B
OF THE CONVEYANCING ACT, 1919**

(Sheet 1 of 5 sheets)

Pl:

DP1116003

Plan of Easement and Restrictions over
Lot 30 in Deposited Plan 1095096 covered
by Council Clerk's Certificate No 02/2426 of
17.10.2005

**Full Name and Address of the Registered
Proprietor of the Land:**

*Sunlit International Pty Ltd (ACN 064 811 623)
Level 6, 20 Smith St, Parramatta NSW 2150*

PART 1 (Creation)

Number of item shown in the intention panel on the plan	Identity of easement, profit à prendre, restriction or positive covenant to be created and referred to in the plan	Burdened lot(s) or parcel(s):	Benefited lot(s), road(s), bodies or Prescribed Authorities
1.	Easement for Padmount Substation 2.79 wide	LOT 30 IN DP 1095096	Integral Energy Australia
2.	Restriction on the Use of Land ('R')	LOT 30 IN DP 1095096	Integral Energy Australia
3.	Restriction on the Use of Land ('S')	LOT 30 IN DP 1095096	Integral Energy Australia

PART 2 (Terms)

**Terms of Easement for Padmount Substation 2.79 wide Firstly referred to in the
abovementioned plan**

LPI Memorandum No 9262886

1. The authority benefited may;
 - 1.1 install electrical equipment within the easement site,
 - 1.2 excavate the easement site to install the electrical equipment,
 - 1.3 use the electrical equipment for the transmission of electricity,
 - 1.4 enter the lot burdened using the most practical rout (with or without vehicles, machinery or materials) at all reasonable times (and at any time in the event of an emergency) and remain there for any reasonable time,
 - 1.5 trim of remove any vegetation from the lot burdened that interferes with or prevents reasonable access to the easement site or the electrical equipment and,
 - 1.6 remove any encroachments from the easement site and recover costs of carrying out the removal work and repairing any damage done to the electrical equipment by the encroachment.

R. Wehbe

[Signature]

INSTRUMENT SETTING OUT TERMS OF EASEMENT AND RESTRICTIONS ON
THE USE OF LAND INTENDED TO BE CREATED PURSUANT TO SECTION 88B
OF THE CONVEYANCING ACT, 1919

(Sheet 2 of 5 sheets)

DP1116003

Plan of Easement and Restrictions over
Lot 30 in Deposited Plan 1095096 covered
by Council Clerk's Certificate No 02/2426 of
17.10.2005

2. In exercising its rights under this easement the authority benefited will take reasonable precautions to minimise disturbance to the lot burdened and will restore the lot burdened as nearly as practicable to its original condition.
3. The owner agrees that it will not:
 - 3.1 install or permit to be installed any services or structure within the easement site, or
 - 3.2 alter the surface level of the easement site, or
 - 3.3 do or permit to be done anything that restricts access to the easement site by the authority benefited without the written permission of the authority benefited and in accordance with such conditions as the authority benefited may reasonably impose.
4. The authority benefited will not be responsible if the electrical equipment causes magnetic interference to computer equipment or electronic equipment operated within the lot burdened.
5.
 - 5.1 **authority benefited** means Integral Energy Australia and its successors (who may exercise its right by any persons authorised by it)
 - 5.2 **easement site** means that part of the lot burdened that is affected by this easement
 - 5.3 **electrical equipment** includes electrical transformer, electrical switchgear, protective housing, concrete plinth, underground electrical cable, duct, underground earthing system and ancillary equipment
 - 5.4 **install** includes construct, repair, replace, maintain, modify, use and remove.
 - 5.5 **Owner** means the registered proprietor of the lot burdened and its successors (including those claiming under or through the registered proprietor)
 - 5.6 **services** includes overhead and underground gas, telephone, communications, water sewerage and drainage services.
 - 5.7 **structure** includes building, wall, retaining wall, carport, driveway, fence and swimming pool; but excludes garden furniture and garden ornament

The terms implied by s. 88A(2A) and Schedule 4A Part 8 of the Conveyancing Act 1919 are excluded.



INSTRUMENT SETTING OUT TERMS OF EASEMENT AND RESTRICTIONS ON
THE USE OF LAND INTENDED TO BE CREATED PURSUANT TO SECTION 88B
OF THE CONVEYANCING ACT, 1919

(Sheet 3 of 5 sheets)

Pla

DP1116003

Plan of Easement and Restrictions over
Lot 30 in Deposited Plan 1095096 covered
by Council Clerk's Certificate No 02/2426 of
17.10.2005

Terms of Restriction on the Use of Land ('R') secondly referred to in the
abovementioned plan

- 1.0 No building shall be erected or permitted to remain within the restriction site unless:
- 1.1 the external surface of the building erected within 1.5 metres from the substation footing has a 120/120/120 fire rating and
 - 1.2 the external surface of the building erected more than 1.5 metres from the substation footing has a 60/60/60 fire rating
- and the owner provides the authority benefited with an engineer's certificate to this effect.
- 2.0 The fire ratings mentioned in clause 1 must be achieved without the use of fire fighting systems such as automatic sprinklers.
- 3.0 Definitions:
- 3.1 "120/120/120 fire rating" and "60/60/60 fire rating" means the fire resistance level of a building expressed as a grading period in minutes for structural adequacy / integrity failure / insulation failure calculated in accordance with Australian Standard 1530.
 - 3.2 "building" means a substantial structure with a roof and walls and includes any projections from the external walls.
 - 3.3 "erect" includes construct, install, build and maintain.
 - 3.4 "restriction site" means that part of the lot burdened affected by the restriction on the use of land as shown on the plan up to a maximum height of 6 metres from the level of the substation footing.

Terms of Restriction on the Use of Land ('S') Thirdly referred to in the
abovementioned plan

- 1.0 No swimming pool or spa shall be erected or permitted to remain within the restriction site.
- 2.0 Definitions:
- 2.1 "erect" includes construct, install, build and maintain.



INSTRUMENT SETTING OUT TERMS OF EASEMENT AND RESTRICTIONS ON
THE USE OF LAND INTENDED TO BE CREATED PURSUANT TO SECTION 88B
OF THE CONVEYANCING ACT, 1919

(Sheet 4 of 5 sheets)

Plan:

DP1116003

Plan of Easement and Restrictions over
Lot 30 in Deposited Plan 1095096 covered
by Council Clerk's Certificate No 02/2426 of
17.10.2005

- 2.2 **"restriction site"** means that part of the lot burdened affected by the
restriction on the use of land as shown on the plan.

Name of Authority whose consent is required to release vary or modify the Easement
numbered 1 and the Restrictions numbered 2 and 3 in the plan: Integral Energy
Australia

EXECUTED on behalf of the
Registered Proprietor Corporation
SUNLIT INTERNATIONAL PTY LTD
ACN 064 811 623 by its Authorised
Persons whose signatures appear
pursuant to Section 127 of the
Corporations Act.



Secretary



Director



INSTRUMENT SETTING OUT TERMS OF EASEMENT AND RESTRICTIONS ON
THE USE OF LAND INTENDED TO BE CREATED PURSUANT TO SECTION 88B
OF THE CONVEYANCING ACT, 1919

(Sheet 5 of 5 sheets)

Plan:

DP1116003

Plan of Easement and Restrictions over
Lot 30 in Deposited Plan 1095096 covered
by Council Clerk's Certificate No 02/2426 of
17.10.2005

SIGNED on behalf of INTEGRAL
ENERGY AUSTRALIA by its
Attorney pursuant to Power of
Attorney Book 4509 No 838 in the
presence of:

L. Fabrella
Signature of Witness

Louise Fabrella
Name of Witness
C/- Integral Energy
51 Huntingwood Drive
HUNTINGWOOD NSW 2148

G. Riethmuller
Signature of Attorney

Name: Geoffrey Riethmuller
Position: Network Property Mgr
Date of execution: 13 June 2007
Reference:

UML 3897

MORTGAGEE'S CONSENT

GEORGE ONG AND CHING-LEUNG
acted on behalf of ARAB BANK
AUSTRALIA LIMITED by
Geokong, Ching-Leung
and duly constituted Attorneys who are
personally known to me: R. M. M. R. M.

ARAB BANK AUSTRALIA LTD
BY ITS ATTORNEY who hereby
states he has no notice of
revocation of the Power of
Attorney registered in the office of
the Registrar General No. 565
Book 441 under the authority of
which he has executed this
instrument

Geokong Ching-Leung
GEOK ONG CHING-LEUNG

REGISTERED 8.8.2007

Form: 13PC
Release: 2.1
www.lands.nsw.gov.au

POSITIVE COVENA

New South Wales

Section 88E(3) Conveyancing Act

PRIVACYNOTE: Section 31B of the Real Property Act 1900 (RP Act) authorises the use of this form for the establishment and maintenance of the Real Property Register. The Register is made available to any person for search upon payment of a fee, if any.

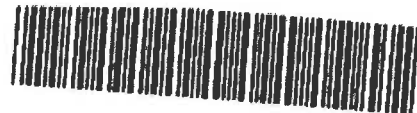

AD296262K

(A) TORRENS TITLE

Folio: 30/1095096

(B) LODGED BY

Document Collection Box	Name, Address or DX, Telephone, and LLPN if any RAY WENBE & CO SOLICITORS DX 8221 PARRAMATTA 4635 0600 Reference:	CODE PC
-------------------------	---	----------------

(C) REGISTERED PROPRIETOR

SUNLIT INTERNATIONAL PTY LTD (ACN 064 811 623)

(D) LESSEE MORTGAGEE or CHARGE

Of the above land agreeing to be bound by this positive covenant		
Nature of Interest	Number of Instrument	Name
Mortgage	AA799792	ARAB BANK AUSTRALIA LTD

(E) PRESCRIBED AUTHORITY

PENRITH CITY COUNCIL

(F) The prescribed authority having imposed on the above land a positive covenant in the terms set out in annexure A hereto applies to have it recorded in the Register and certifies this application correct for the purposes of the Real Property Act 1900.

DATE

(G) Execution by the prescribed authority

I certify that an authorised officer of the prescribed authority who is personally known to me or as to whose identity I am otherwise satisfied signed this application in my presence.

Signature of witness: A. Pearson

Signature of authorised officer: [Signature]

Name of witness: Alison Pearson

Name of authorised officer: WARWICK SIMMONS

Address of witness: 601 High St Penrith NSW 2150

Position of authorised officer: DEVELOPMENT ASSESSMENT COORDINATOR

(G) Execution by the registered proprietor

Certified correct for the purposes of the Real Property Act 1900 and executed on behalf of the corporation named below by the authorised person(s) whose signature(s) appear(s) below pursuant to the authority specified.

Corporation: SUNLIT INTERNATIONAL PTY LTD (ACN 064 811 623)

Authority: s127 OF THE CORPORATIONS ACT

Signature of authorised person: R. Walle

Signature of authorised person: [Signature]

Name of authorised person: RAY WENBE

Name of authorised person: JOSEPH RYMAN

Office held: DIRECTOR

Office held: DIRECTOR

(H) Consent of the mortgagee

The mortgagee under mortgage

No. AA799792

, agrees to be bound by this positive covenant.

I certify that the above mortgagee signed this application in my presence.

who is personally known to me or as to whose identity I am otherwise satisfied

Signature of witness:

Signature of mortgagee: see Page 2

Name of witness:

Address of witness:

ALL HANDWRITING MUST BE IN BLOCK CAPITALS.

0612

Page 1 of 2

CT 985X 24/1

ARAB BANK AUSTRALIA LTD
BY ITS ATTORNEY, WARWICK SIMMONS
states he has no notice of
revocation of the Power of
Attorney registered in the office of
the Registrar General No. 565
Book 4418 under the authority of
which he has executed this
instrument.

**INSTRUMENT SETTING OUT TERMS OF POSITIVE COVENANT
INTENDED TO BE CREATED PURSUANT TO s88E(3) OF
THE CONVEYANCING ACT 1919**

Sheet 2 of 2 sheets

The registered proprietor covenants as follows with Penrith City Council (Council) in respect to granting the Council access to the garbage bay area for the purpose of allowing the manoeuvrability of the Council's domestic waste collection vehicles:

- (i) The registered proprietor covenants to allow the Council or its authorised agents to enter upon the land with all necessary equipment for the purpose of collection of waste from the garbage bay area and to allow rights of ingress and egress over the land of the Council's waste collection vehicles.

.....
Signature of authorised person

WARWICK STIMSON
.....
Name of authorised person

A. Pearson
.....
Signature of witness

Alison Pearson
.....
Name of witness

DEVELOPMENT ASSESSMENT COORDINATOR
.....
Position of authorised officer

601 High St. Penrith NSW 2750
.....
Address of witness

SIGNED SEALED AND DELIVERED)
for and on behalf of ARAB BANK)
AUSTRALIA LIMITED by)
GEORGE CHING LEONG)
its duly constituted Attorneys who are)
personally known to me:)

R. MOORLI

ARAB BANK AUSTRALIA LTD
BY ITS ATTORNEY who hereby
states he has no notice of
revocation of the Power of
Attorney registered in the office of
the Registrar General No. 565
Book 4418 under the authority of
which he has executed this
instrument.

GEORGE ONG

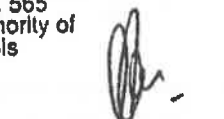
CHING-LEONG

SYDNEY WATER SEWERAGE SERVICE DIAGRAM

MUNICIPALITY OF PENRITH

SUBURB OF PENRITH

SSD 3098420

INDICATES - DRAINAGE FITTINGS

■	Manhole	⊠ P	P. Trap
□ Chr	Chamber	⊠ R	Relief Valve
⊙	Lampole	⊠	Cleaning Eye
⊗	Boundary Trap	⊠ Vert	Vertical Pipe
⊙	Inspection Shaft	⊠ IP	Induct Pipe
⊠ PN	PN	⊠ MF	Miss Flap
⊠ C	Grease Interceptor	⊠ RP	Rodding Point
⊠	Gully	⊠	Seped Junction
⊙ TMS	Tennish Malt Shot	⊠	Vertical Junction
⊙ MS	Maintenance Shot	⊠	On back Junction

SYMBOLS AND ABBREVIATIONS

INDICATES - PLUMBING FIXTURES & OR FITTINGS

CO	Clean out	BD	Blot
OV	Vent Pipe	S	Shower
T	Tubs	DW	Dishwasher
K	Kitchen Sink	F	Floor Waste
W	Water Closet	M	Washing Machine
B	Bath Waste	BS	Bar Sink
H	Handbasin	LS	Lob Sink

INDICATES - PLUMBING ON MORE THAN ONE LEVEL

○ SVP	Soil Vent Pipe	○ MS	Waste Stack
-------	----------------	------	-------------

---	ELEC.
⊠	Pump Unit
⊠	Boundary Valve
⊠	Boundary Valve with PTO
⊠	Alarm Control Panel
⊠	LP Stop Valve
⊠	LP Air Valve
⊠	LP Reducer
⊠	HSV Flow Monitor
⊠	Vacuum Chamber
⊠	Fleeting Point

Scale: Approx 1:500 Distances/depths in metres Pipe diameters in millimetres Boundary Trap NOT REQUIRED

SEWER AVAILABLE

Where the sewer is not available and a special inspection is involved the Board accepts no responsibility for the suitability of the drainage in relation to the eventual position of the Board's sewer. The existence and position of the Board's sewers, stormwater channels, pipes, mains and structures should be ascertained by inspection of records available at Board's Business Offices. (Section 33 of Board's Act). Position of structures, boundaries, sewers and sewerage service shown herein are approximate only and in general the outlines of building may have been drawn from initial building plans submitted to the Board. Discrepancies in outline can occur from amendment to these plans. Discrepancies in position and type of drainage lines and fittings can be due to unrefined work. Before building work is commenced location of drainage lines is recommended. Licensee is required to submit to the Board a Certificate Of Compliance as not all work may have been supervised.

NOTE: This diagram only indicates availability of a sewer and any sewerage service as existing in the Board's records (By-Law 8, Clause 3).

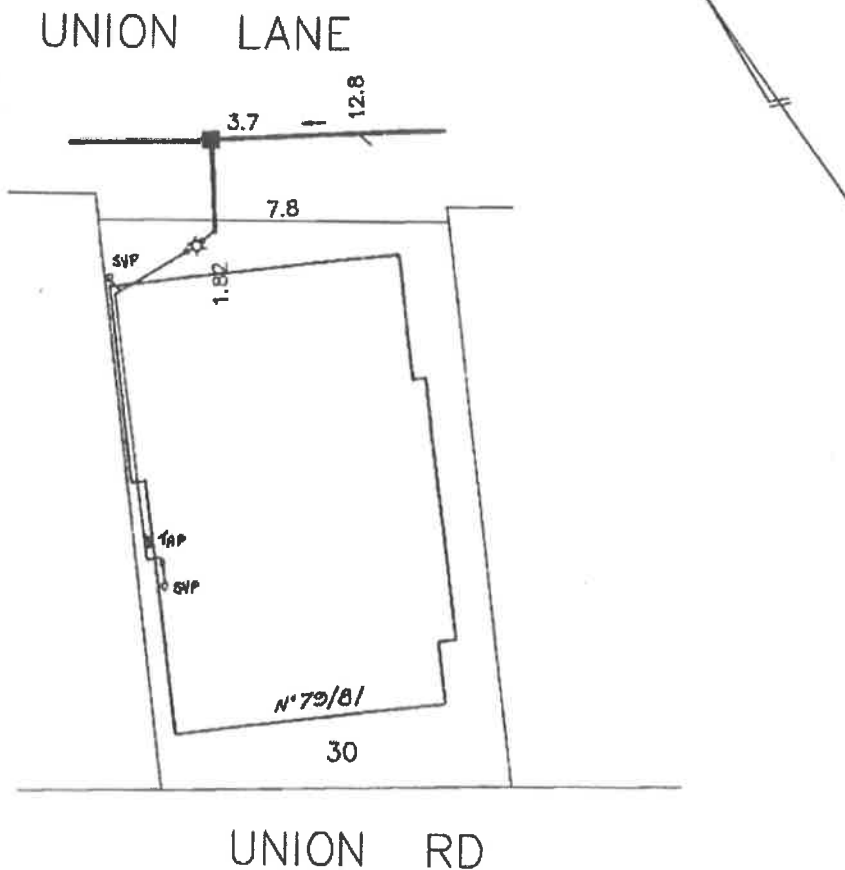

Connection Date:
Claimer

The information in this diagram shows the private wastewater pipes on this property. It may not be accurate or to scale and may not show our pipes, structures or all property boundaries. If you'd like to see these, please buy a Service location print.

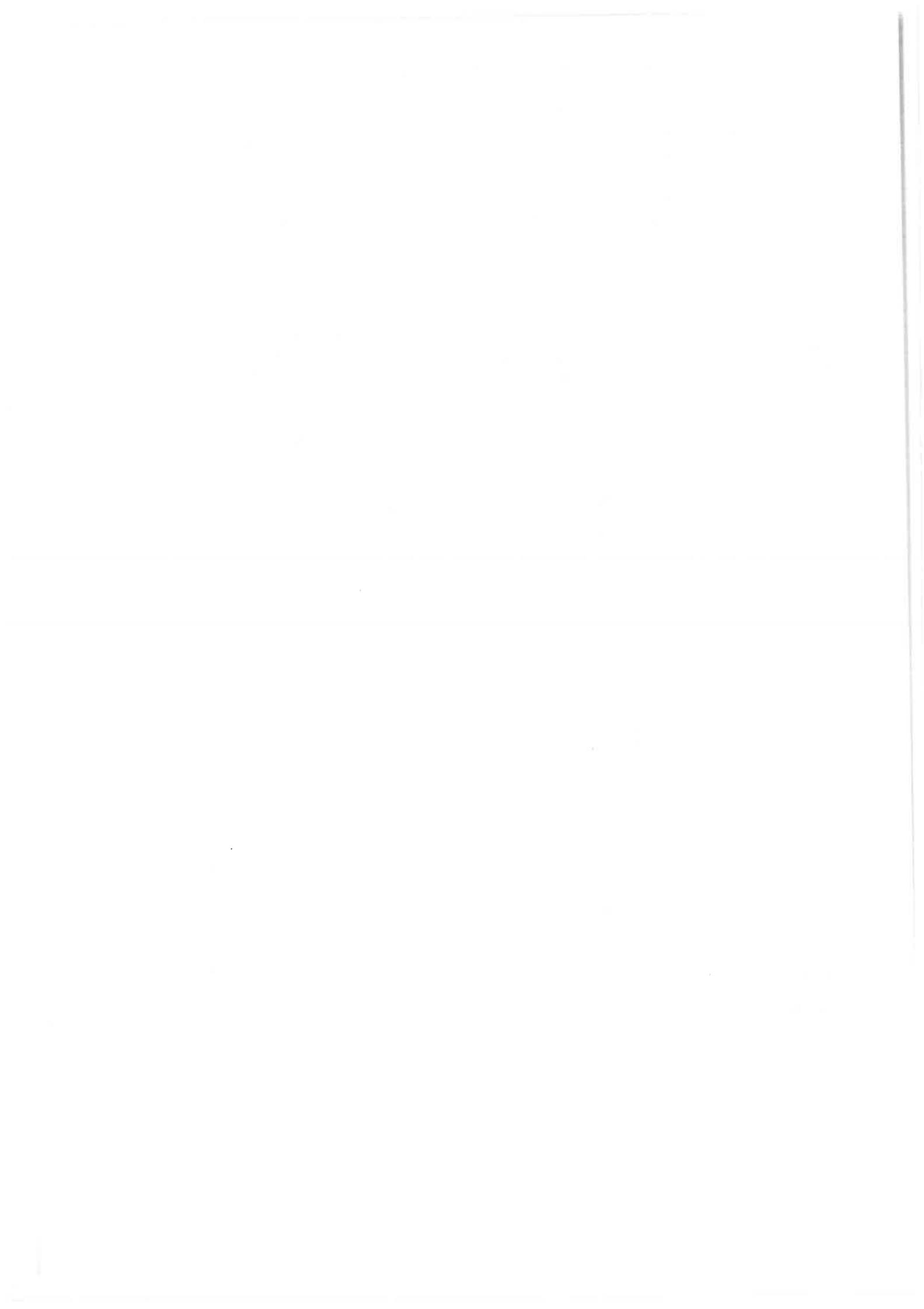



Revenue

Enquiry ID
Agent ID
Issue Date
Correspondence ID
Your reference

2946071
112176669
15 Aug 2018
1676675315
1808121

SAI GLOBAL PROPERTY DIVISION PTY LTD
GPO Box 5420
SYDNEY NSW 2001

Land Tax Certificate under section 47 of the *Land Tax Management Act, 1956*.

This information is based on data held by Revenue NSW.

Land ID	Land address	Taxable land value
S79328/23	Unit 23, 79-81 UNION RD PENRITH 2750	\$74 786

There is **no land tax** (including surcharge land tax) charged on the land up to and including the 2018 tax year.

Yours sincerely,

Stephen R Brady

Chief Commissioner of State Revenue

Revenue NSW contact details



For more information and services on land tax
www.revenue.nsw.gov.au/taxes/land



1300 139 816*



Phone enquiries
8:30 am - 5:00pm, Mon. - Fri.

- * Interstate customers call 1800 061 163
Overseas customers call +61 2 9761 4956
Help in community languages is available.

Important information

Who is protected by a clearance certificate?

A clearance certificate states whether there is any land tax (including surcharge land tax) owing on a property.

The clearance certificate protects a purchaser from any outstanding land tax liability by a previous owner. It does not provide any protection to the owner of the land.

Why is the certificate clear from land tax?

The certificate may be issued as 'clear' if:

- the land is not liable or is exempt from land tax
- the tax has been paid
- the Chief Commissioner is satisfied payment of the tax is not at risk, or
- the owner of the land failed to lodge a land tax return when it was due and the liability had not been detected when the certificate was issued.

Note: A clear certificate does not mean that land tax was not payable or that there is no land tax adjustment to be made on settlement, if the contract for sale allows for it.

Why is the certificate not clear from land tax?

Under section 47 of the *Land Tax Management Act 1956*, land tax is a charge on land owned in NSW at midnight on 31 December of each year. The charge applies from the taxing date and does not depend on the issue of a land tax assessment notice. Land tax is an annual tax so a new charge may occur on the taxing date each year.

How do I clear a certificate?

To remove a charge from a clearance certificate the outstanding tax must be paid. To do this the owner should follow the steps shown on the certificate or contact Revenue NSW if no instructions are shown.

You should allow 10 working days to process a request.

How do I get an updated certificate?

A certificate can be updated by using our online clearance certificate update service at www.revenue.nsw.gov.au/taxes/land/clearance or reprocess the certificate through your Client Service Provider (CSP).

Please ensure you have allowed sufficient time for any payment to be processed prior to requesting a new version of the clearance certificate.

Land value, tax rates and threshold

The taxable land value shown on the clearance certificate is the value that is used by Revenue NSW when assessing land tax.

Details on land tax threshold and rates, as well as the land tax calculator and examples are available at www.revenue.nsw.gov.au/taxes/land

PLANNING CERTIFICATE UNDER SECTION 10.7
Environmental Planning and Assessment Act, 1979

Property No: 783785
Your Reference:
Contact No.

Issue Date: 20 August 2018
Certificate No: 18/04412

Issued to: Zhang Shijing Lawyers
Suite 13 Level 1
301 Castlereagh St
SYDNEY NSW 2000

PRECINCT 2010

DESCRIPTION OF LAND

County: CUMBERLAND

Parish: MULGOA

Location: 23/79-81 Union Road PENRITH NSW 2750

Land Description: Lot 23 SP 79328

- PART 1 PRESCRIBED MATTERS -

In accordance with the provisions of Section 10.7 of the Act the following information is furnished in respect of the abovementioned land:

1 NAMES OF RELEVANT PLANNING INSTRUMENTS AND DCPs

1(1) The name of each environmental planning instrument that applies to the carrying out of development on the land:

Penrith Local Environmental Plan 2010, published 22nd September 2010, as amended, applies to the land.

Sydney Regional Environmental Plan No.9 - Extractive Industry (No.2), gazetted 15 September 1995, as amended, applies to the local government area of Penrith.

Sydney Regional Environmental Plan No. 20 - Hawkesbury-Nepean River (No. 2 - 1997), gazetted 7 November 1997, as amended, applies to the local government area of Penrith (except land to which State Environmental Planning Policy (Penrith Lakes Scheme) 1989 applies).

The following State environmental planning policies apply to the land (subject to the exclusions noted below):

State Environmental Planning Policy No.1 - Development Standards. (Note: This policy does not apply to the land to which Penrith Local Environmental Plan 2010 or State Environmental Planning Policy (Western Sydney Employment Area) 2009 apply.)

State Environmental Planning Policy No.19 - Bushland in Urban Areas. (Note: This policy does not apply to certain land referred to in the National Parks and Wildlife Act 1974 and the Forestry Act 1916.)

State Environmental Planning Policy No.21 - Caravan Parks.

State Environmental Planning Policy No.30 - Intensive Agriculture.

State Environmental Planning Policy No.33 - Hazardous and Offensive Development.

PLANNING CERTIFICATE UNDER SECTION 10.7
Environmental Planning and Assessment Act, 1979

State Environmental Planning Policy No.50 - Canal Estate Development. (Note: This policy does not apply to the land to which State Environmental Planning Policy (Penrith Lakes Scheme) 1989 applies.

State Environmental Planning Policy No.55 - Remediation of Land.

State Environmental Planning Policy No.62 - Sustainable Aquaculture.

State Environmental Planning Policy No.64 - Advertising and Signage.

State Environmental Planning Policy No.65 - Design Quality of Residential Apartment Development.

State Environmental Planning Policy No.70 - Affordable Housing (Revised Schemes).

State Environmental Planning Policy (Housing for Seniors or People with a Disability) 2004 (Note: This policy applies to land within New South Wales that is land zoned primarily for urban purposes or land that adjoins land zoned primarily for urban purposes, but only as detailed in clause 4 of the policy.)

State Environmental Planning Policy (Building Sustainability Index: BASIX) 2004.

State Environmental Planning Policy (State Significant Precincts) 2005.

State Environmental Planning Policy (Mining, Petroleum Production and Extractive Industries) 2007.

State Environmental Planning Policy (Miscellaneous Consent Provisions) 2007.

State Environmental Planning Policy (Infrastructure) 2007.

State Environmental Planning Policy (Exempt and Complying Development Codes) 2008.

State Environmental Planning Policy (Affordable Rental Housing) 2009.

State Environmental Planning Policy (State and Regional Development) 2011.

State Environmental Planning Policy (Vegetation in Non-Rural Areas) 2017.

State Environmental Planning Policy (Education Establishments and Child Care Centre Facilities) 2017.

1(2) The name of each proposed environmental planning instrument that will apply to the carrying out of development on the land and that is or has been the subject of community consultation or on public exhibition under the Act:

(Information is provided in this section only if a proposed environmental planning instrument that is or has been the subject of community consultation or on public exhibition under the Act will apply to the carrying out of development on the land.)

Draft amendments to Penrith Development Control Plan 2014 for Multi-Dwelling Housing and Boarding Houses is currently on exhibition. (See www.penrithcity.nsw.gov.au for details).

Draft State Environmental Planning Policy (Western Sydney Corridors) may apply to the land. Further information is available here: <https://www.transport.nsw.gov.au/corridors>.

On 22 June 2018, the NSW Government announced changes to the recommended alignments for the Western Sydney corridors, including continuing with the previously gazetted 1951 corridor for the Bells Line of Road Castlereagh Connection.

Draft State Environmental Planning Policy (Infrastructure) Amendment (Shooting Ranges) 2013 applies to the land.

State Environmental Planning Policy (Infrastructure) Amendment (Review) 2016 applies to the land.

Draft State Environmental Planning Policy (Primary Production & Rural Development) applies to the land.

Draft State Environmental Planning Policy (Environment) applies to the land.

PLANNING CERTIFICATE UNDER SECTION 10.7

Environmental Planning and Assessment Act, 1979

Draft State Environmental Planning Policy (Remediation of Land) applies to the land.

1(3) The name of each development control plan that applies to the carrying out of development on the land:

Penrith Development Control Plan 2014 applies to the land.

2 ZONING AND LAND USE UNDER RELEVANT LEPs

For each environmental planning instrument or proposed instrument referred to in clause 1 (other than a SEPP or proposed SEPP) that includes the land in any zone (however described):

2(a)-(d) the identity of the zone; the purposes that may be carried out without development consent; the purposes that may not be carried out except with development consent; and the purposes that are prohibited within the zone. Any zone(s) applying to the land is/are listed below and/or in annexures.

(Note: If no zoning appears in this section see section 1(1) for zoning and land use details (under the Sydney Regional Environmental Plan or State Environmental Planning Policy that zones this property).)

Zone B4 Mixed Use

(Penrith Local Environmental Plan 2010)

1 Objectives of zone

- To provide a mixture of compatible land uses.
- To integrate suitable business, office, residential, retail and other development in accessible locations so as to maximise public transport patronage and encourage walking and cycling.
- To minimise conflict between land uses within the zone and land uses within adjoining zones.
- To create opportunities to improve public amenity.
- To provide a wide range of retail, business, office, residential, community and other suitable land uses.

2 Permitted without consent

Home occupations

3 Permitted with consent

Amusement centres; Boarding houses; Car parks; Centre-based child care facilities; Commercial premises; Community facilities; Educational establishments; Entertainment facilities; Environmental facilities; Environmental protection works; Flood mitigation works; Function centres; Home-based child care; Home businesses; Hostels; Hotel or motel accommodation; Information and education facilities; Medical centres; Mortuaries; Multi dwelling housing; Passenger transport facilities; Places of public worship; Public administration buildings; Recreation areas; Recreation facilities (indoor); Recreation facilities (outdoor); Registered clubs; Residential accommodation; Residential flat buildings; Respite day care centres; Restricted premises; Roads; Seniors housing; Serviced apartments; Sex services premises; Shop top housing; Signage; Veterinary hospitals.

4 Prohibited

Rural workers' dwellings; Any development not specified in item 2 or 3

PLANNING CERTIFICATE UNDER SECTION 10.7
Environmental Planning and Assessment Act, 1979

Flood planning

All or part of the subject land is identified in Penrith Local Environmental Plan 2010 (PLEP 2010) Clause 7.2 Flood Planning. Development consent is required for any development on land to which Clause 7.2 of PLEP 2010 applies.

Additional information relating to Penrith Local Environmental Plan 2010

Note 1: Under the terms of Clause 2.4 of Penrith Local Environmental Plan 2010 development may be carried out on unzoned land only with development consent.

Note 2: Under the terms of Clause 2.6 of Penrith Local Environmental Plan 2010 land may be subdivided but only with development consent, except for the exclusions detailed in the clause.

Note 3: Under the terms of Clause 2.7 of Penrith Local Environmental Plan 2010 the demolition of a building or work may be carried out only with development consent.

Note 4: A temporary use may be permitted with development consent subject to the requirements of Clause 2.8 of Penrith Local Environmental Plan 2010.

Note 5: Under the terms of Clause 4.1A of Penrith Local Environmental Plan 2010, despite any other provision of this plan, development consent must not be granted for dual occupancy on an internal lot in Zone R2 Low Density Residential.

Note 6: Under the terms of Clause 5.1 of Penrith Local Environmental Plan 2010 development on land acquired by an authority of the State under the owner-initiated acquisition provisions may, before it is used for the purpose for which it is reserved, be carried out, with development consent, for any purpose.

Note 7: Under the terms of Clause 5.3 of Penrith Local Environmental Plan 2010 development consent may be granted to development of certain land for any purpose that may be carried out in an adjoining zone.

Note 8: Clause 5.10 of Penrith Local Environmental Plan 2010 details when development consent is required/not required in relation to heritage conservation.

Note 9: Under the terms of Clause 5.11 of Penrith Local Environmental Plan 2010 bush fire hazard reduction work authorised by the *Rural Fires Act 1997* may be carried out on any land without development consent.

Note 10: Under the terms of Clause 7.1 of Penrith Local Environmental Plan 2010 (PLEP 2010) development consent is required for earthworks unless the work is exempt development under PLEP 2010 or another applicable environmental planning instrument, or the work is ancillary to other development for which development consent has been given.

Note 11: Sex services premises and restricted premises may only be permitted subject to the requirements of Clause 7.23 of Penrith Local Environmental Plan 2010.

PLANNING CERTIFICATE UNDER SECTION 10.7
Environmental Planning and Assessment Act, 1979

2(e) whether any development standards applying to the land fix minimum land dimensions for the erection of a dwelling-house on the land and, if so, the minimum land dimensions so fixed:

(Information is provided in this section only if any development standards applying to the land fix minimum land dimensions for the erection of a dwelling-house on the land and, if so, the minimum land dimensions so fixed.)

2(f) whether the land includes or comprises critical habitat:

(Information is provided in this section only if the land includes or comprises critical habitat.)

2(g) whether the land is in a conservation area (however described):

(Information is provided in this section only if the land is in a conservation area (however described).)

2(h) whether an item of environmental heritage (however described) is situated on the land:

(Information is provided in this section only if an item of environmental heritage (however described) is situated on the land.)

***2A ZONING AND LAND USE UNDER STATE ENVIRONMENTAL PLANNING POLICY
(SYDNEY REGION GROWTH CENTRES) 2006***

(Information is provided in this section only if the land is within any zone under State Environmental Planning Policy (Sydney Region Growth Centres) 2006.)

3 COMPLYING DEVELOPMENT

HOUSING CODE

(The Housing Code only applies if the land is within Zones R1, R2, R3, R4 or RU5 under Penrith Local Environmental Plan 2010 or an equivalent zone in a non standard template planning instrument.)

Complying development under the Housing Code may be carried out on the land if the land is within one of the abovementioned zones.

RURAL HOUSING CODE

(The Rural Housing Code only applies if the land is within Zones RU1, RU2, RU3, RU4, RU6 or R5 under Penrith Local Environmental Plan 2010 or an equivalent zone in a non standard template planning instrument.)

Complying development under the Rural Housing Code may be carried out on the land if the land is within one of the abovementioned zones.

PLANNING CERTIFICATE UNDER SECTION 10.7
Environmental Planning and Assessment Act, 1979

LOW RISE MEDIUM DENSITY HOUSING CODE

(The Low Rise Medium Density Housing Code only applies if the land is within Zones R1, R2, R3 or RU5 under Penrith Local Environmental Plan 2010 or an equivalent zone in a non standard template planning instrument.)

Complying development under the Low Rise Medium Density Housing Code may be carried out on the land if the land is within one of the abovementioned zones.

Please note that Council has been deferred from the application of Part 3B of the Low Rise Medium Density Housing Code until 1 July 2019. That Part will not apply to Penrith Local Government Area during this time.

GREENFIELD HOUSING CODE

(The Greenfield Housing Code only applies if the land is within Zones R1, R2, R3, R4 or RU5 under Penrith Local Environmental Plan 2010 or an equivalent zone in a non standard template planning instrument, and if the land is identified as a Greenfield Housing Code Area by the Greenfield Housing Code Area Map.)

Complying development under the Greenfield Housing Code may be carried out on the land if the land is within one of the abovementioned zones, and if the land is identified as a Greenfield Housing Code Area by the Greenfield Housing Code Area Map.

HOUSING ALTERATIONS CODE

Complying development under the Housing Alterations Code may be carried out on the land.

GENERAL DEVELOPMENT CODE

Complying development under the General Development Code may be carried out on the land.

COMMERCIAL AND INDUSTRIAL ALTERATIONS CODE

Complying development under the Commercial and Industrial Alterations Code may be carried out on the land.

SUBDIVISIONS CODE

Complying development under the Subdivisions Code may be carried out on the land.

DEMOLITION CODE

Complying development under the Demolition Code may be carried out on the land.

PLANNING CERTIFICATE UNDER SECTION 10.7
Environmental Planning and Assessment Act, 1979

COMMERCIAL AND INDUSTRIAL (NEW BUILDINGS AND ADDITIONS) CODE

(The Commercial and Industrial (New Buildings and Additions) Code only applies if the land is within Zones B1, B2, B3, B4, B5, B6, B7, B8, IN1, IN2, IN3, IN4 or SP3 under Penrith Local Environmental Plan 2010 or an equivalent zone in a non standard template planning instrument.)

Complying development under the Commercial and Industrial (New Buildings and Alterations) Code may be carried out on the land if the land is within one of the abovementioned zones.

FIRE SAFETY CODE

Complying development under the Fire Safety Code may be carried out on the land.

(NOTE: (1) Council has relied on Planning and Infrastructure Circulars and Fact Sheets in the preparation of this information. Applicants should seek their own legal advice in relation to this matter with particular reference to State Environmental Planning Policy (Exempt and Complying Development Codes) 2008.

(2) Penrith Local Environmental Plan 2010 (if it applies to the land) contains additional complying development not specified in State Environmental Planning Policy (Exempt and Complying Development Codes) 2008.)

4 COASTAL PROTECTION

The land is not affected by the operation of sections 38 or 39 of the Coastal Protection Act 1979, to the extent that council has been so notified by the Department of Public Works.

5 MINE SUBSIDENCE

The land is not proclaimed to be a mine subsidence district within the meaning of section 15 of the Mine Subsidence Compensation Act 1961.

6 ROAD WIDENING AND ROAD REALIGNMENT

The land is not affected by any road widening or road realignment under:

- (a) Division 2 of Part 3 of the Roads Act 1993, or
- (b) an environmental planning instrument, or
- (c) a resolution of council.

7 COUNCIL AND OTHER PUBLIC AUTHORITY POLICIES ON HAZARD RISK RESTRICTIONS

(a) Council Policies

The land is affected by the Asbestos Policy adopted by Council.

The land is not affected by any other policy adopted by the council that restricts the development of the land because of the likelihood of land slip, bushfire, tidal inundation, subsidence, acid sulphate soils or any other risk (other than flooding).

(b) Other Public Authority Policies

The Bush Fire Co-ordinating Committee has adopted a Bush Fire Risk Management Plan that covers the local government area of Penrith City Council, and includes public, private and Commonwealth lands.

PLANNING CERTIFICATE UNDER SECTION 10.7

Environmental Planning and Assessment Act, 1979

The land is not affected by a policy adopted by any other public authority and notified to the council for the express purpose of its adoption by that authority being referred to in planning certificates issued by the council, that restricts the development of the land because of the likelihood of land slip, tidal inundation, subsidence, acid sulphate soils or any other risk (other than flooding).

7A FLOOD RELATED DEVELOPMENT CONTROLS INFORMATION

(1) Development on the land or part of the land for the purposes of dwelling houses, dual occupancies, multi dwelling housing or residential flat buildings (not including development for the purposes of group homes or seniors housing) (if such uses are permissible on the land) is subject to flood related development controls.

(2) Development on the land or part of the land for industrial or commercial purposes (if such uses are permissible on the land) is subject to flood related development controls.

Development on the land or part of the land for purposes other than industrial or commercial, or for purposes other than those referred to in (1) above, will be considered on a merits based approach and flood related development controls may apply.

Note: The land is subject to Penrith Development Control Plan 2014 Section C3.5 Flood Planning. On application and payment of the prescribed fee Council may be able to provide in writing a range of advice in regard to the extent of flooding affecting the property.

8 LAND RESERVED FOR ACQUISITION

No environmental planning instrument or proposed environmental planning instrument referred to in clause 1 makes provision in relation to the acquisition of the land by a public authority, as referred to in section 3.15 of the Act.

9 CONTRIBUTIONS PLANS

The Cultural Facilities Development Contributions Plan applies anywhere residential development is permitted within the City of Penrith.

The Penrith City Local Open Space Development Contributions Plan applies anywhere residential development is permitted within the City of Penrith, excluding industrial areas and the release areas identified in Appendix B of the Plan (Penrith Lakes, Cranebrook, Sydney Regional Environmental Plan No. 30 - St Marys, Waterside, Thornton, the WELL Precinct, Glenmore Park and Erskine Park).

The Penrith City District Open Space Facilities Development Contributions Plan applies anywhere residential development is permitted within the City of Penrith, with the exclusion of industrial lands and the Penrith Lakes development site.

The Penrith City Centre Civic Improvement Plan applies to the land.

9A BIODIVERSITY CERTIFIED LAND

(Information is provided in this section only if the land is biodiversity certified land under Part 8 of the *Biodiversity Conservation Act 2016*. (Note. biodiversity certified land includes land certified under

PLANNING CERTIFICATE UNDER SECTION 10.7
Environmental Planning and Assessment Act, 1979

Part 7AA of the *Threatened Species Conservation Act 1995* that is taken to be certified under Part 8 of the *Biodiversity Conservation Act 2016*.)

10 BIODIVERSITY STEWARDSHIP SITES

(Information is provided in this section only if Council has been notified by the Chief Executive of the Office of Environment and Heritage that the land is land to which a biobanking stewardship agreement under Part 5 of the *Biodiversity Conservation Act 2016* relates. Note. Biodiversity stewardship agreements include biobanking agreements under Part 7A of the *Threatened Species Conservation Act 1995* that are taken to be biodiversity stewardships agreements under Part 5 of the *Biodiversity Conservation Act 2016*)

11 BUSH FIRE PRONE LAND

The land is not identified as bush fire prone land according to Council records.

12 PROPERTY VEGETATION PLANS

(Information is provided in this section only if Council has been notified that the land is land to which a property vegetation plan approved under the *Native Vegetation Act 2003* applies and continues in force.)

13 ORDERS UNDER TREES (DISPUTES BETWEEN NEIGHBOURS) ACT 2006

(Information is provided in this section only if Council has been notified that an order has been made under the *Trees (Disputes Between Neighbours) Act 2006* to carry out work in relation to a tree on the land.)

14 DIRECTIONS UNDER PART 3A

(Information is provided in this section only if there is a direction by the Minister in force under section 75P(2)(c1) of the Act (repealed on 1st October 2011) that a provision of an environmental planning instrument prohibiting or restricting the carrying out of a project or a stage of a project on the land under Part 4 of the Act does not have effect.)

15 SITE COMPATIBILITY CERTIFICATES AND CONDITIONS AFFECTING SENIORS HOUSING

(Information is provided in this section only if:

- (a) there is a current site compatibility certificate (seniors housing), of which the council is aware, issued under State Environmental Planning Policy (Housing for Seniors or People with a Disability) 2004 in respect of proposed development on the land; and/or
- (b) any terms of a kind referred to in clause 18(2) of State Environmental Planning Policy (Housing for Seniors or People with a Disability) 2004 have been imposed as a condition of consent to a development application granted after 11 October 2007 in respect of the land.)

PLANNING CERTIFICATE UNDER SECTION 10.7
Environmental Planning and Assessment Act, 1979

16 SITE COMPATIBILITY CERTIFICATES FOR INFRASTRUCTURE

(Information is provided in this section only if there is a valid site compatibility certificate (infrastructure), of which council is aware, in respect of proposed development on the land.)

17 SITE COMPATIBILITY CERTIFICATES AND CONDITIONS FOR AFFORDABLE RENTAL HOUSING

(Information is provided in this section only if:

- (a) there is a current site compatibility certificate (affordable rental housing), of which the council is aware, in respect of proposed development on the land; and/or
- (b) any terms of a kind referred to in clause 17(1) or 37(1) of State Environmental Planning Policy (Affordable Rental Housing) 2009 have been imposed as a condition of consent to a development application in respect of the land.)

18 PAPER SUBDIVISION INFORMATION

(Information is provided in this section only if a development plan adopted by a relevant authority applies to the land or is proposed to be subject to a consent ballot, or a subdivision order applies to the land.)

19 SITE VERIFICATION CERTIFICATES

(Information is provided in this section only if there is a current site verification certificate, of which council is aware, in respect of the land.)

NOTE: The following matters are prescribed by section 59(2) of the Contaminated Land Management Act 1997 as additional matters to be specified in a planning certificate

- (a) (Information is provided in this section only if, as at the date of this certificate, the land (or part of the land) is significantly contaminated land within the meaning of the Contaminated Land Management Act 1997.)
- (b) (Information is provided in this section only if, as at the date of this certificate, the land is subject to a management order within the meaning of the Contaminated Land Management Act 1997.)
- (c) (Information is provided in this section only if, as at the date of this certificate, the land is the subject of an approved voluntary management proposal within the meaning of the Contaminated Land Management Act 1997.)
- (d) (Information is provided in this section only if, at the date of this certificate, the land subject to an ongoing maintenance order within the meaning of the Contaminated Land Management Act 1997.)
- (e) (Information is provided in this section only if the land is the subject of a site audit statement within the meaning of the Contaminated Land Management Act 1997 - a copy of which has been provided to Council.)

PLANNING CERTIFICATE UNDER SECTION 10.7
Environmental Planning and Assessment Act, 1979

Note: Section 10.7(5) information for this property may contain additional information regarding contamination issues.

20 LOOSE FILL ASBESTOS INSULATION

(Information is provided in this section only if there is a residential premises listed on the register of residential premises that contain or have contained loose-fill asbestos insulation (as required by Division 1A of Part 8 of the home Building Act 1989))

21 AFFECTED BUILDING NOTICES AND BUILDING PRODUCT RECTIFICATION ORDERS

(Information is provided in this section only if Council is aware of any "affected building notice" and/or a "building product rectification order" in force for the land).

Note: The Environmental Planning and Assessment Amendment Act 2017 commenced operation on the 1 March 2018. As a consequence of this Act the information contained in this certificate needs to be read in conjunction with the provisions of the Environmental Planning and Assessment (Savings, Transitional and Other Provisions) Regulation 2017, and Environmental Planning and Assessment Regulation 2000.

Information is provided only to the extent that Council has been notified by the relevant government departments.

Note: This is a certificate under section 10.7 of the Environmental Planning and Assessment Act, 1979 and is only provided in accordance with that section of the Act.

Further information relating to the subject property can be provided under section 10.7(5) of the Act. If such further information is required Council indicates that a full certificate under sections 10.7(2) and 10.7(5) should be applied for. Contact Council for details as to obtaining the additional information.

**Alan Stoneham
General Manager**

Per



Please note:

Certain amendments to the Environmental Planning and Assessment Act 1979 No 203 (Act) commenced on 1 March 2018.

The Environmental Planning and Assessment (Amendment) Act 2017 No 60 makes structural changes to the Act and, as a consequence, the Act has been renumbered in a decimal format. For example, Section 149 Planning Certificates have become Section 10.7 Certificates. Some of the information in this certificate may refer to the previous version of the Act.

Council is committed to updating all relevant documents in a timely manner. This will include planning instruments, applications, approvals, orders, certificates, forms and other associated documents in both printed and electronic versions. Council is required to implement these changes and regrets any inconvenience caused to the local business, industry and the community.

