

## Property report for 15 ALBION ROAD, BRIDGEWATER



**Property Identification Number**

5025979

**Locality**

BRIDGEWATER

**Planning Zones**

General Residential

**Total Area**

661 sqm

**Certificate of Title Reference (Volume/Folio)**

6707/649

**Municipality**

Brighton

**Planning Codes Overlay**

N/A

**Planning Scheme**

Tasmanian Planning Scheme

This property is in the **General Residential** planning zone under the Tasmanian Planning Scheme.

The Tasmanian Planning Scheme consists of state wide provisions to ensure consistency across Tasmania, and local provisions which spatially apply those through zoning maps along with specific provisions for unique places in each municipality to address local issues.

## Location Information

### Planning Zone

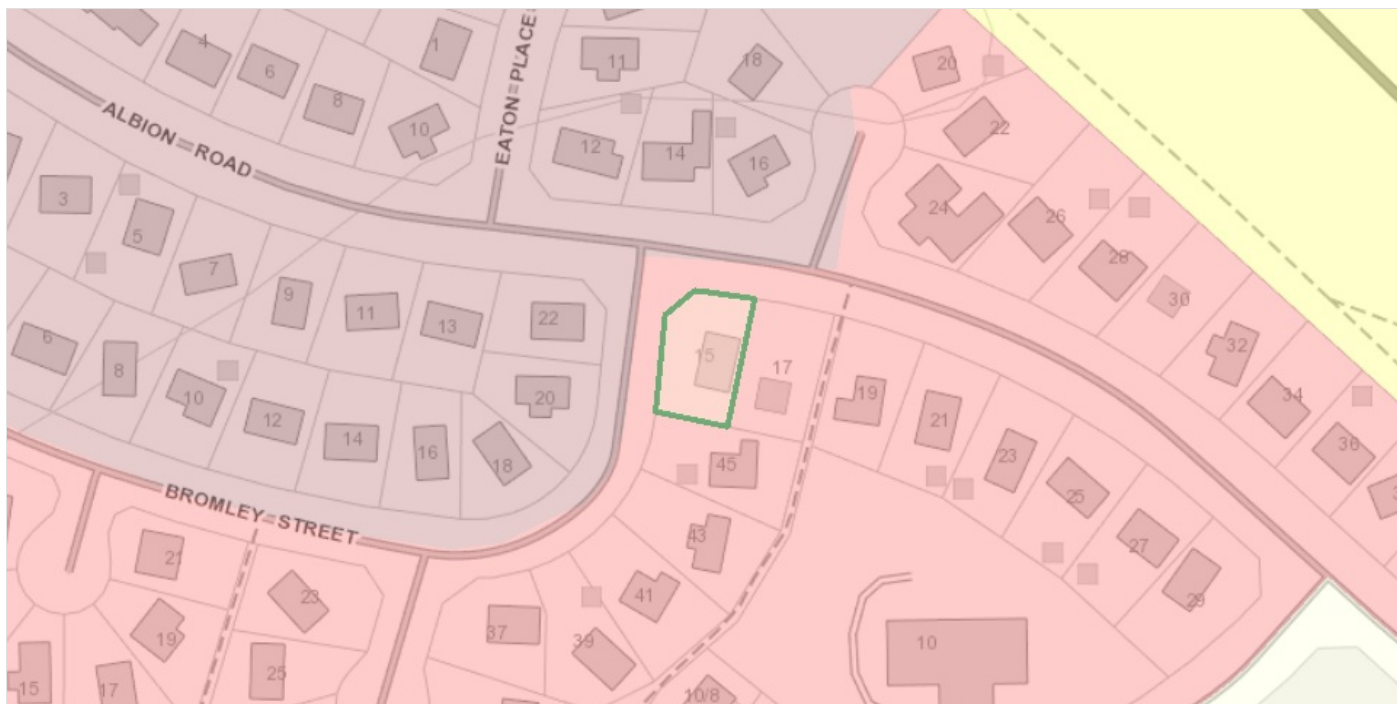

### Tasmanian Planning Zone

Zone Number	8
Zone	General Residential

### TasWater - Water Service

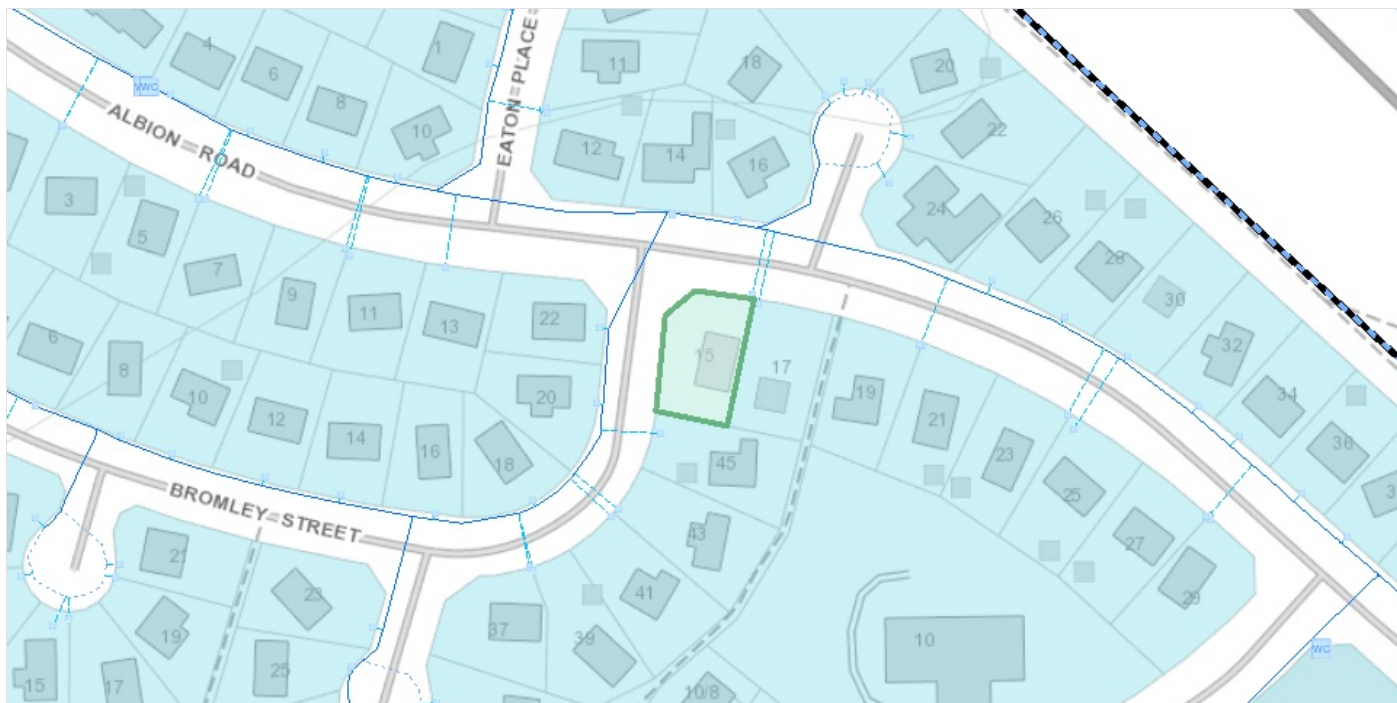

### TasWater - Water Serviced Land

Serviced Land is the land which TasWater will permit to be connected to its water and sewerage infrastructure. The blue shading on the map indicates water serviced properties. The property is connected to, or is able to connect (with a standard service connection) to the TasWater water supply network. Development assessments will be required to be undertaken prior to undertaking any work on TasWater Infrastructure. See <https://www.taswater.com.au/Customers/Serviced-Land> for further information.

Service Type	Full Service
--------------	--------------

TasWater - Sewer Service

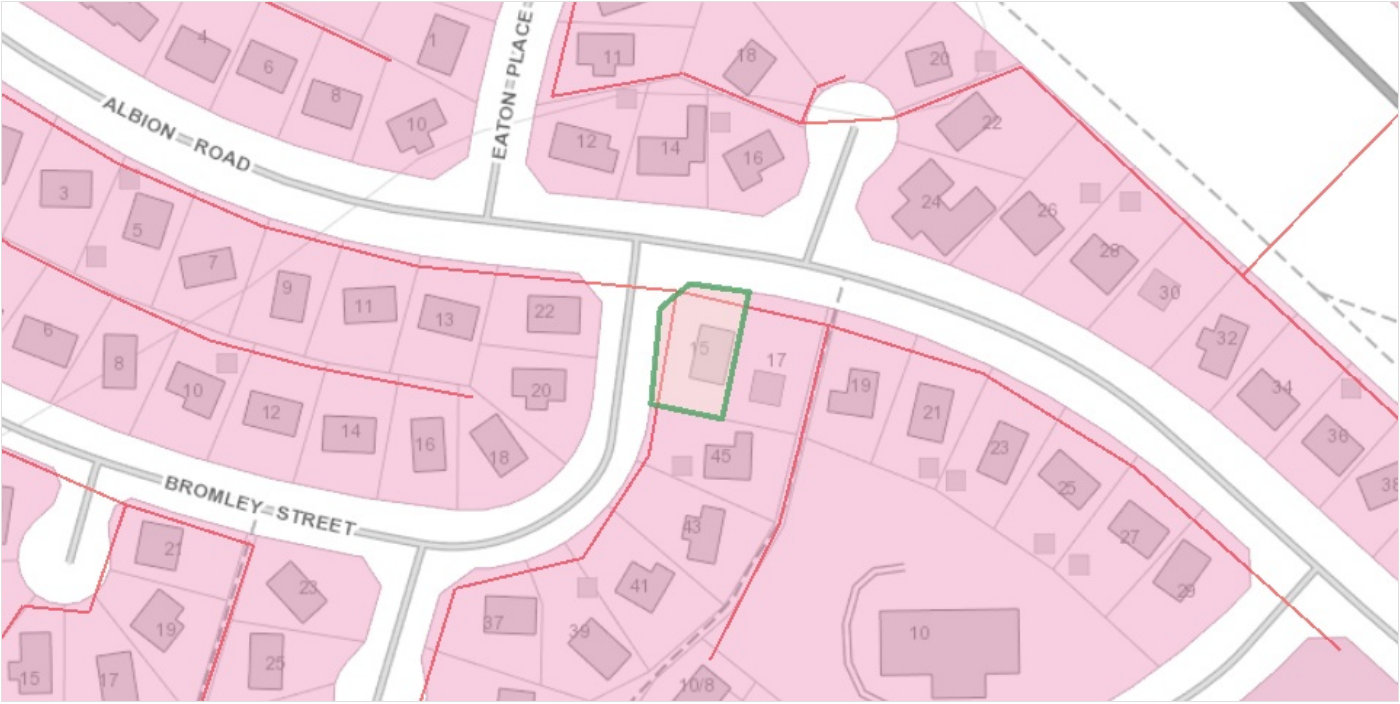

TasWater - Sewer Serviced Land

Serviced Land is the land which TasWater will permit to be connected to its water and sewerage infrastructure. The red shading on the map indicates sewerage serviced properties. The property is connected to, or is able to connect (with a standard service connection) to the TasWater sewerage reticulation network. Development assessments will be required to be undertaken prior to undertaking any work on TasWater Infrastructure. See <https://www.taswater.com.au/Customers/Serviced-Land> for further information.

Service Type	Full Service
--------------	--------------

TasWater - Sewer Main

Sewer mains transport sewage throughout the network (sewerage system). Work cannot be undertaken within 2 metres of any infrastructure without seeking approval from TasWater. The sewer main is displayed on the map as the thick red lines (some with arrows and varying in thickness).

## TasWater infrastructure

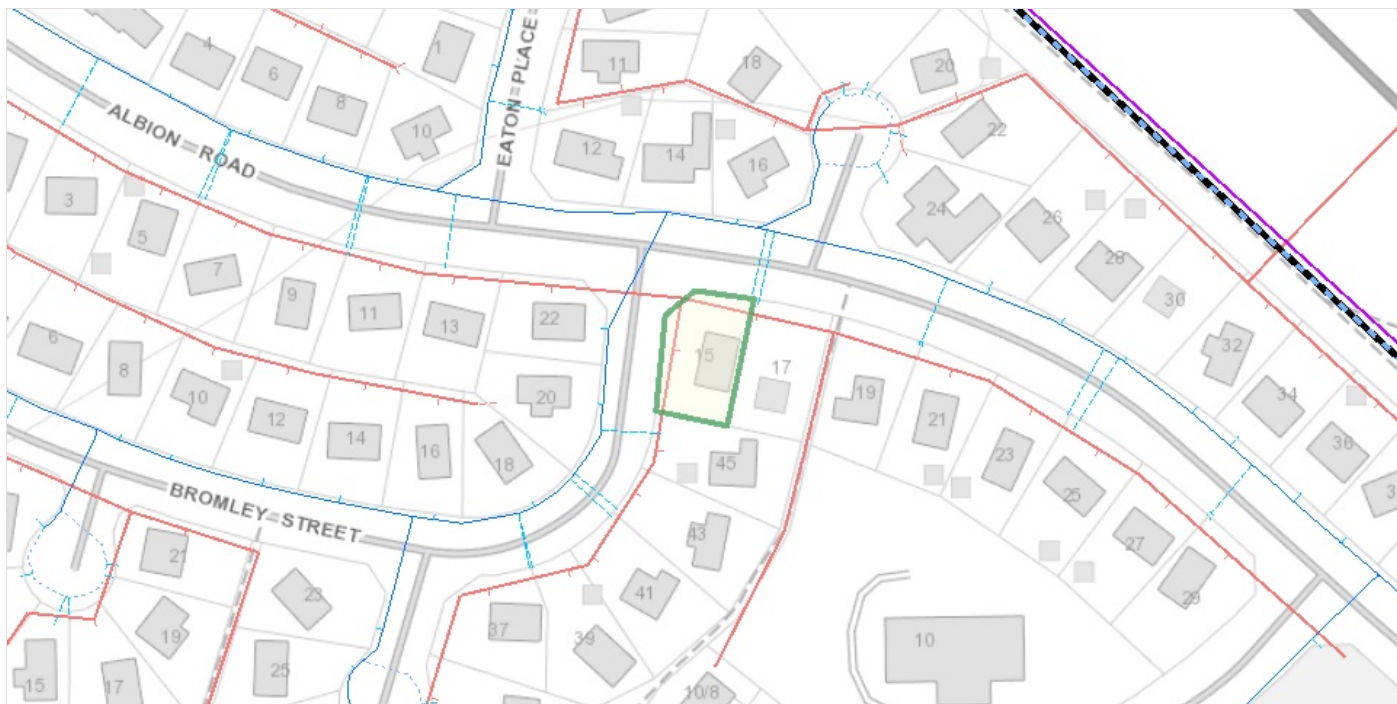

### TasWater - Sewer Main

Sewer mains transport sewage throughout the network (sewerage system). Work cannot be undertaken within 2 metres of any infrastructure without seeking approval from TasWater. The sewer main is displayed on the map as the thick red lines (some with arrows and varying in thickness).

### TasWater - Sewer Lateral Line

The lateral line indicates the property service pipe that begins at the sewer main and ends at the customer connection point. This is displayed on the map as a thin red line. Work cannot be undertaken within 2 metres of any infrastructure without seeking approval from TasWater.

## Council Details

The local council where your property is located can provide advice on a proposed project.

Consult

### Brighton Council

#### Mailing address

1 Tivoli Road  
Old Beach Tasmania 7017

**Work:** (03) 6268 7000

**Email:** [admin@brighton.tas.gov.au](mailto:admin@brighton.tas.gov.au)

### Disclaimer

This enquiry tool is a guide only and is not a substitute for professional advice.

This enquiry tool only provides information for common developments undertaken individually, for example, building a deck.

The Tasmanian Planning Commission, a court, council or other relevant authority may have an interpretation of the law that is different from the information provided as part of this enquiry tool.

You should always confirm that you are permitted to commence a development by contacting a relevant authority who may be:

- the local council; or
- an independent Licensed Professional