

## SEARCH OF TORRENS TITLE

VOLUME 56812	FOLIO 2
EDITION 8	DATE OF ISSUE 10-Aug-2009

SEARCH DATE : 20-Nov-2023

SEARCH TIME : 07.59 PM

DESCRIPTION OF LAND

City of HOBART

Lot 2 on Strata Plan 56812 (formerly being STR2761) and a  
general unit entitlement operating for all purposes of the  
Strata Scheme being a 1 undivided 1/3 interest

Derived from Strata Plan 56812

Derivation : Part of 10A-2R-30Ps. Gtd. to J. Spode

Prior CT 4605/42

SCHEDULE 1

M237455 TRANSFER to ALEXANDER CHARLES WOOD and DANIELLE  
MARGRIET WARFE Registered 10-Aug-2009 at 12.01 PM

SCHEDULE 2

Reservations and conditions in the Crown Grant if any  
The registered proprietor holds the lot and unit entitlement  
subject to any interest noted on common property  
Folio of the Register volume 56812 folio 0

C927415 MORTGAGE to National Australia Bank Limited  
Registered 10-Aug-2009 at 12.02 PM

UNREGISTERED DEALINGS AND NOTATIONS

No unregistered dealings or other notations



Conveyancing and Law of Property Act 1884

STRATUM PLAN

No. 2761

Sheet 1 of 4 Sheets

REGISTERED NUMBER

56812

City or Town HOBART

Locality NORTH HOBART

Reference to Title 4590-60

Site comprises the whole portion of Lot 1 on Plan - Diagram No. 40458 in the

Lands Titles Office

The name of the building is 302 PARK STREET, HOBART

N SITE PLAN  
SCALE 1: 300  
MEASUREMENTS IN METRES

External surface boundaries of the site and the location of the building in relation thereto to be delineated in this space

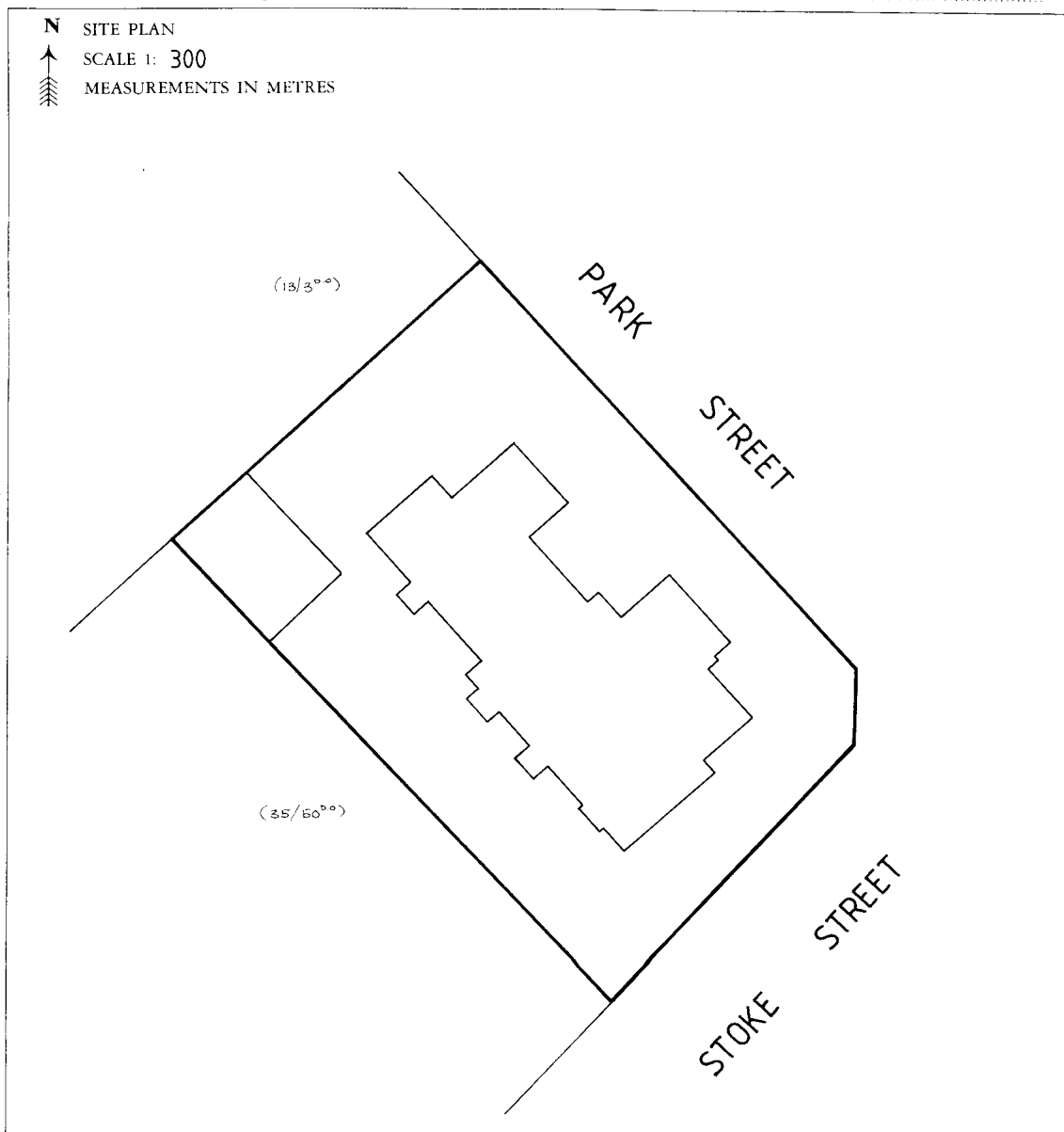

REGISTERED this 11<sup>th</sup> day of OCTOBER 1989, No. 2761

This plan is lodged for registration by  
BARKER & BARKER

*[Signature]*  
Recorder of Titles



If further sheets are required to illustrate the flats, the sheets should be pinned here.

Further sheets must be of paper supplied for the purpose by the Recorder of Titles and bearing his seal, and be numbered consecutively, commencing from sheet 4.

Sheet 3 of 4 Sheets

No. 2761

*M. J. Smith*  
Acting Town Clerk / Council Clerk

FIRST FLOOR  
Scale: 1:200

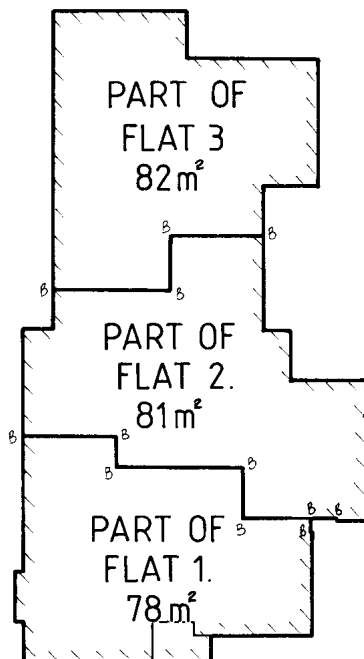

DESCRIPTION OF BOUNDARIES

HORIZONTAL BOUNDARIES OF THE FLATS ARE SHOWN BY HEAVY UNBROKEN LINES.  
THE BOUNDARIES OF EACH FLAT EXTEND -

- A. HORIZONTALLY ALONG THE FACE OF THE BRICK WALLS AND ALONG THE CENTRE OF WALLS MARKED BB.
- B. VERTICALLY FROM THE CENTRE OF THE CEILING BELOW TO THE PROLONGATION OF THE ROOF RIDGE.

Sheet 4 of 4 Sheets

No. 2761

The address for service of notices on the company is:—

302 PARK STREET  
NEW TOWN 7008

## UNIT ENTITLEMENTS

Flat	Unit Entitlement	FOR OFFICE USE ONLY
1	1	4605 41
2	1	" 42
3	1	" 43

## SURVEYOR'S CERTIFICATE

I, Rodney Arthur Connor  
of Lindisfarne  
a surveyor registered under the *Land Surveyor's Act 1909*, hereby certify that the building erected on the site described and delineated on sheet 1 of this plan is within the external boundaries of the title stated on sheet 1.

Dated this 13<sup>th</sup> day of June 1989

Registered Surveyor  
89088

### COUNCIL CLERK'S CERTIFICATE

I certify that the subdivision shown in this plan  
has been approved by the .....

HUBART City Council  
Dated this 21<sup>ST</sup> day of July 19 87

ACTING Town Clerk / ~~Council Clerk~~

FOR OFFICE USE ONLY

TOTAL ....	3
------------	---

3

## SEARCH OF TORRENS TITLE

VOLUME 56812	FOLIO 0
EDITION 3	DATE OF ISSUE 01-Nov-1999

SEARCH DATE : 20-Nov-2023

SEARCH TIME : 07.59 PM

DESCRIPTION OF LAND

City of HOBART

The Common Property for Strata Scheme 56812 (formerly being STR2761)

Derivation : Part of 10A-2R-30Ps. Gtd. to J. Spode

Prior CT 4590/60

SCHEDULE 1

STRATA CORPORATION NO. 56812, 302 PARK STREET, HOBART

SCHEDULE 2

Reservations and conditions in the Crown Grant if any

UNREGISTERED DEALINGS AND NOTATIONS

No unregistered dealings or other notations