

Caller Details

| | | | | | |
|-----------------|----------------------------------|-------------------|------------------------------------|---------------|----------------|
| Contact: | Image Property | Caller Id: | 3003158 | Phone: | (07) 3263 1811 |
| Company: | Image property | | | | |
| Address: | 57 Kirby Road Aspley QLD 4034 | Email: | sales.support@imageproperty.com.au | | |

Dig Site and Enquiry Details

WARNING: The map below only displays the location of the proposed dig site and does not display any asset owners' pipe or cables. The area highlighted has been used only to identify the participating asset owners, who will send information to you directly.

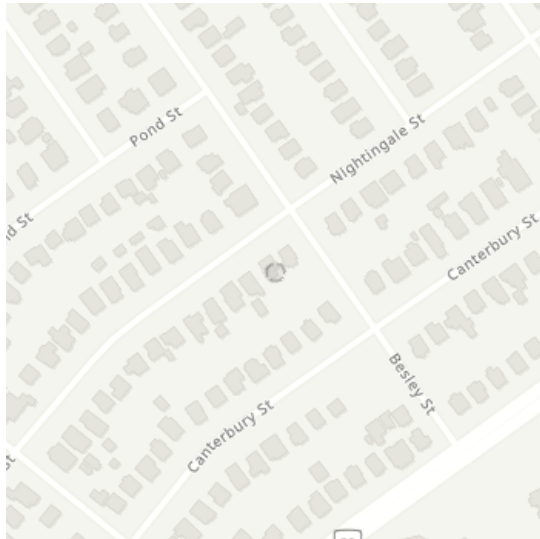

| | | | |
|------------------------------|-----------------------|------------------|--|
| User Reference: | 73 nightingale Street | | |
| Working on Behalf of: | Private | | |
| Enquiry Date: | Start Date: | End Date: | |
| 19/04/2022 | 26/04/2022 | 26/04/2022 | |

Address:
73 Nightingale Street
Mount Gravatt East QLD 4122

Job Purpose:

Design

Onsite Activities:

Planning & Design

Location of Workplace:

Both

Location in Road:

Road, Nature Strip, Footpath

- Check that the location of the dig site is correct. If not you must submit a new enquiry.
- Should the scope of works change, or plan validity dates expire, you must submit a new enquiry.
- Do NOT dig without plans. Safe excavation is your responsibility. If you do not understand the plans or how to proceed safely, please contact the relevant asset owners.

Notes/Description of Works:

Not supplied

Your Responsibilities and Duty of Care

- The lodgement of an enquiry does not authorise the project to commence. You must obtain all necessary information from any and all likely impacted asset owners prior to excavation.
- If plans are not received within 2 working days, contact the asset owners directly & quote their Sequence No.
- ALWAYS perform an onsite inspection for the presence of assets. Should you require an onsite location, contact the asset owners directly. Please remember, plans do not detail the exact location of assets.
- Pothole to establish the exact location of all underground assets using a hand shovel, before using heavy machinery.
- Ensure you adhere to any State legislative requirements regarding Duty of Care and safe digging requirements.
- If you damage an underground asset you MUST advise the asset owner immediately.
- By using this service, you agree to Privacy Policy and the terms and disclaimers set out at www.1100.com.au
- For more information on safe excavation practices, visit www.1100.com.au

Asset Owner Details

The assets owners listed below have been requested to contact you with information about their asset locations within 2 working days. Additional time should be allowed for information issued by post. It is **your responsibility** to identify the presence of any underground assets in and around your proposed dig site. Please be aware, that not all asset owners are registered with the Dial Before You Dig service, so it is **your responsibility** to identify and contact any asset owners not listed here directly.

** Asset owners highlighted by asterisks ** require that you visit their offices to collect plans.

Asset owners highlighted with a hash # require that you call them to discuss your enquiry or to obtain plans.

| Seq. No. | Authority Name | Phone | Status |
|-----------|----------------------------|----------------|----------|
| 210452946 | Brisbane City Council | (07) 3403 8888 | NOTIFIED |
| 210452948 | NBN Co Qld | 1800 687 626 | NOTIFIED |
| 210452949 | Queensland Urban Utilities | 13 23 64 | NOTIFIED |
| 210452947 | Telstra QLD FA | 1800 653 935 | NOTIFIED |

END OF UTILITIES LIST



Job # 31788892
Seq # 210452946
Provider: Brisbane City Council
Telephone: 07 3403 8888



Legend
 DBYD Enquiry

Disclaimer:
© Brisbane City Council [2020]
In consideration of Council, and the copyright owners listed below, permitting the use of this data, you acknowledge and agree that Council, and the copyright owners, give no warranty in relation to the data (including accuracy, reliability, completeness, currency or suitability) and accept no liability (including without limitation, liability in negligence) for any loss, damage or costs (including consequential damage), relating to any use of this data.
Data must not be used for direct marketing or be used in breach of the privacy laws.

Copyright of data is as follows:
Cadastre and Street Names © 2020 State of Queensland (Department of Natural Resources, Mines and Energy)

Caution: This map may contain the locations of abandoned underground asbestos pipes. Council gives no warranty to the completeness or accuracy of these records. Appropriate care needs to be taken in all cases.

In an emergency contact Brisbane City Council on 07 3403 8888

Index Sheet

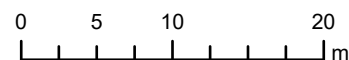

Scale 1:500



Plans generated by
SmarterWX™ Automate

Telstra DBYD Data Extraction

For non-ground breaking activities -

***Planning and design, conveyancing, tendering, educational or research, other data gathering**

Note - The supply of any Telstra data for non ground breaking activities is at Telstra's discretion. Data supply may be refused on commercial, privacy, security or other reasons.

*Planning and design requests submitted by identified utilities intending works on their own assets ***may** be exempt from the \$120 (GST inc) extraction fee for Standard Telstra Responses for non ground breaking activities. This is at Telstra's discretion and conditions may apply. Data extraction fees for all non standard responses however will still apply. Eg for large projects or non standard formats.

The supply of any data for non ground breaking activities is not subject to a 48hr response time; however Telstra will endeavour to respond within 48hrs for all standard responses. Please contact us directly for any urgent requests.

Standard Telstra Response - for non ground breaking activities \$120 (GST inc)

Criteria - Each request only requires a single delivery from Telstra (as in 1 request 1 Delivery).

A single delivery is either -

- **1 x Email with 1 x PDF map file** containing one or two A3 map pages (depending on network). Covers areas up to approx 500m in size.
- or-
- **1 x Email with 1 x DWF map file.** Covers areas up to approx 3km in size.
- or-
- **1 x *Posted delivery.-** (*only if email unavailable or at Telstra's discretion)

Posted is either -

- Posted softcopy of standard response on disk
- or-
- Posted printed hardcopy – maximum of 2 x A3 sheets only.

Non-Standard Response – for non ground breaking activities (fees apply)

Data Use Agreement (required for DXF format) **\$360** (GST inc)

Projects - If a response takes more than 30mins to extract data in any format will be at an hourly rate **(\$240** per hour GST inc).

- Projects that take 1 day or longer will be quoted individually.
- (All data will be provided in softcopy only - not printed).

Note - Multiple part requests through DBYD for one project will be amalgamated and considered a single project for data extraction charging purposes. Posted responses cannot be delivered within 48hrs, allow several days for delivery. Postage is by Australia Post standard delivery. Express delivery at additional cost. All prices and specifications are subject to change.

Telstra DBYD Data Extraction

For ground breaking activities -

***Manual or mechanical excavation, horizontal boring, vertical boring, blasting**

Standard Telstra Response – for ground breaking activities

cost to requestor - \$nil

Criteria - Each request only requires a single delivery from Telstra (as in 1 request 1 delivery).

A single delivery is defined as either -

- **1 x Email with 1 x PDF map file** containing one or two A3 map pages (depending on network). *Covers up to approx 500m.*

or-

- **1 x Email with 1 x DWF map file.** *Covers up to approx 3km.*

or-

- **1 x *Posted delivery** for customers requesting a response for their principal place of residence only, (and only when email delivery is unavailable or at Telstra's discretion).

Either -

- Posted printed hardcopy (A3 sheets only- at Telstra's discretion)

Non-Standard Telstra Response – for ground breaking activities (fees apply)

An extraction fee is incurred if the response exceeds a standard response i.e. -

- Use of data requires a data use agreement (for example DXF format)
- If an individual job or project requires more than a single delivery (as defined above)
- Specific printing and/or posting of requests that are not for the principle place of residence
- Any other response other than a Standard Telstra Response for ground breaking activities

Data extraction costs for ground breaking activities -

- Posted hardcopy of standard response i.e. when not principle place of residence – max of 2 x A3 sheets (at legible scale) - **\$120** GST inc. Note - large areas will not be printed and posted.
- Requires Data Use Agreement – i.e. requirement for DXF files - **\$360** (GST inc)
- Non standard response over 30 mins extraction time for softcopy will be at an hourly rate (**\$240 per hour** GST inc).
- Projects that take 1 day or longer will be quoted individually.

Note - Multiple part requests through DBYD for one project will be amalgamated and considered a single project for data extraction charging purposes. Printing/posting fee exemptions may be provided at Telstra's discretion. Postage is by Australia Post standard delivery. All posted plans will normally be extracted within 48 hrs; time in transit through post is additional and may take several days Express delivery at additional cost. All prices and specifications are subject to change. Data extraction fees are based on various criteria including the principal excavation activity selected by the customer on the DBYD website. Telstra reserves the right to vary its fees in circumstances where the principal excavation activity is varied or misrepresented by the customer.



Working near **nbn**TM cables

nbn has partnered with Dial Before You Dig to give you a single point of contact to get information about **nbn** underground services owned by **nbn** and other utility/service providers in your area including communications, electricity, gas and other services. Contact with underground power cables and gas services can result in serious injury to the worker, and damage and costly repairs. You must familiarise yourself with all of the Referral Conditions (meaning the referral conditions referred to in the DBYD Notice provided by **nbn**).

Practice safe work habits

Once the DBYD plans are reviewed, the Five P's of Excavation should be adopted in conjunction with your safe work practices (which must be compliant with the relevant state Electrical Safety Act and Safe Work Australia "Excavation Work Code of Practice", as a minimum) to ensure the risk of any contact with underground **nbn** assets are minimised.



Plan: Plan your job by ensuring the plans received are current and apply to the work to be performed. Also check for any visual cues that may indicate the presence of services not covered in the DBYD plans.



Prepare: Prepare for your job by engaging a DBYD Certified Plant Locator to help interpret plans and identify on-site assets. Contact **nbn** should you require further assistance.

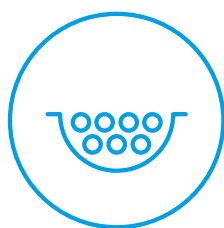

Pothole: Non-destructive potholing (i.e. hand digging or hydro excavation) should be used to positively locate **nbn** underground assets with minimal risk of contact and service damage.

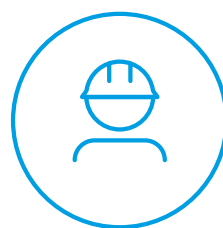

Protect: Protecting and supporting the exposed **nbn** underground asset is the responsibility of the worker. Exclusion zones for **nbn** assets are clearly stated in the plan and appropriate controls must be implemented to ensure that encroachment into the exclusion zone by machinery or activities with the potential to damage the asset is prevented.

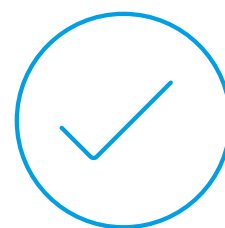

Proceed: Proceed only when the appropriate planning, preparation, potholing and protective measures are in place.

Working near **nbn**TM cables



Identify all electrical hazards, assess the risks and establish control measures.



When using excavators and other machinery, also check the location of overhead power lines.



Workers and equipment must maintain safety exclusion zones around power lines.

Once all work is completed, the excavation should be re-instated with the same type of excavated material unless specified by **nbn**. Please note:

- Construction Partners of **nbn** may require additional controls to be in place when performing excavation activities.
- The information contained within this pamphlet must be used in conjunction with other material supplied as part of this request for information to adequately control the risk of potential asset damage.

Contact

All **nbn**TM network facility damages must be reported online [here](#).
For enquiries related to your DBYD request please call 1800 626 329.

Disclaimer

This brochure is a guide only. It does not address all the matters you need to consider when working near our cables. You must familiarise yourself with other material provided (including the Referral Conditions) and make your own inquiries as appropriate.

nbn will not be liable or responsible for any loss, damage or costs incurred as a result of reliance on this brochure.

This document is provided for information purposes only. This document is subject to the information classification set out on this page. If no information classification has been included, this document must be treated as UNCLASSIFIED, SENSITIVE and must not be disclosed other than with the consent of nbn co. The recipient (including third parties) must make and rely on their own inquiries as to the currency, accuracy and completeness of the information contained herein and must not use this document other than with the consent of nbn co. Copyright © 2021 nbn co limited. All rights reserved.



To: Image Property
Phone: Not Supplied
Fax: Not Supplied
Email: sales.support@imageproperty.com.au

| | | |
|-----------------------------------|---|---|
| Dial before you dig Job #: | 31788892 |  |
| Sequence # | 210452948 | |
| Issue Date: | 19/04/2022 | |
| Location: | 73 Nightingale Street , Mount Gravatt East , QLD , 4122 | |

Information

The area of interest requested by you contains one or more assets.

| nbn™ Assets | Search Results |
|-----------------------|-----------------------|
| Communications | Asset identified |
| Electricity | No assets |

In this notice **nbn™ Facilities** means *underground fibre optic, telecommunications and/or power facilities, including but not limited to cables, owned and controlled by nbn™*

Location of nbn™ Underground Assets

We thank you for your enquiry. In relation to your enquiry at the above address:

- **nbn's** records indicate that there **ARE nbn™** Facilities in the vicinity of the location identified above ("Location").
- **nbn** indicative plan/s are attached with this notice ("Indicative Plans").
- The Indicative Plan/s show general depth and alignment information only and are not an exact, scale or accurate depiction of the location, depth and alignment of **nbn™** Facilities shown on the Plan/s.
- In particular, the fact that the Indicative Plans show that a facility is installed in a straight line, or at uniform depth along its length cannot be relied upon as evidence that the facility is, in fact, installed in a straight line or at uniform depth.
- You should read the Indicative Plans in conjunction with this notice and in particular, the notes below.
- You should note that, at the present time, the Indicative Plans are likely to be more accurate in showing location of fibre optics and telecommunications cables than power cables. There may be a variation between the line depicted on the Indicative Plans and the location of any power cables. As such, consistent with the notes below, particular care must be taken by you to make your own enquiries and investigations to precisely locate any power cables and manage the risk arising from such cables accordingly.
- The information contained in the Indicative Plan/s is valid for 28 days from the date of issue set out above. You are expected to make your own inquiries and perform your own investigations (including engaging appropriately qualified plant locators, e.g DBYD Certified Locators, at your cost to locate **nbn™**

Facilities during any activities you carry out on site).

We thank you for your enquiry and appreciate your continued use of the Dial Before You Dig Service. For any enquiries related to moving assets or Planning and Design activities, please visit the **nbn** [Commercial Works](#) website to complete the online application form. If you are planning to excavate and require further information, please email dbyd@nbnco.com.au or call 1800 626 329.

Notes:

1. You are now aware that there are **nbn**TM Facilities in the vicinity of the above property that could be damaged as a result activities carried out (or proposed to be carried out) by you in the vicinity of the Location.
2. You should have regard to section 474.6 and 474.7 of the *Criminal Code Act 1995* (CoA) which deals with the consequences of interfering or tampering with a telecommunications facility. Only persons authorised by **nbn** can interact with **nbn's** network facilities.
3. Any information provided is valid only for **28 days** from the date of issue set out above.

Referral Conditions

The following are conditions on which **nbn** provides you with the Indicative Plans. By accepting the plans, you are agreeing to these conditions. These conditions are in addition, and not in replacement of, any duties and obligations you have under applicable law.

1. **nbn** does not accept any responsibility for any inaccuracies of its plans including the Indicative Plans. You are expected to make your own inquiries and perform your own investigations (including engaging appropriately qualified plant locators, e.g DBYD Certified Locators, at your cost to locate **nbn**TM Facilities during any activities you carry out on site).
2. You acknowledge that **nbn** has specifically notified you above that the Indicative Plans are likely to be more accurate in showing location of fibre optics and telecommunications cables than power cables. There may be a variation between the line depicted on the Indicative Plans and the location of any power cables.
3. You should not assume that **nbn**TM Facilities follow straight lines or are installed at uniformed depths along their lengths, even if they are indicated on plans provided to you. Careful onsite investigations are essential to locate the exact position of cables.
4. In carrying out any works in the vicinity of **nbn**TM Facilities, you must maintain the following minimum clearances:
 - 300mm when laying assets inline, horizontally or vertically.
 - 500mm when operating vibrating equipment, for example: jackhammers or vibrating plates.
 - 1000mm when operating mechanical excavators.
 - Adherence to clearances as directed by other asset owner's instructions and take into account any uncertainty for power cables.
5. You are aware that there are inherent risks and dangers associated with carrying out work in the vicinity of underground facilities (such as **nbn**TM fibre optic, copper and coaxial cables, and power cable feed to **nbn**TM assets). Damage to underground electric cables may result in:
 - Injury from electric shock or severe burns, with the possibility of death.
 - Interruption of the electricity supply to wide areas of the city.
 - Damage to your excavating plant.
 - Responsibility for the cost of repairs.
6. You must take all reasonable precautions to avoid damaging **nbn**TM Facilities. These precautions may include but not limited to the following:
 - All excavation sites should be examined for underground cables by careful hand excavation. Cable cover slabs if present must not be disturbed. Hand excavation needs to be undertaken with extreme care to minimise the likelihood of damage to the cable, for example: the blades of hand equipment should be aligned parallel to the line of the cable rather than digging across the cable.
 - If any undisclosed underground cables are located, notify **nbn** immediately.

- All personnel must be properly briefed, particularly those associated with the use of earth-moving equipment, trenching, boring and pneumatic equipment.
 - The safety of the public and other workers must be ensured.
 - All excavations must be undertaken in accordance with all relevant legislation and regulations.
7. You will be responsible for all damage to **nbn**TM Facilities that are connected whether directly, or indirectly with work you carry out (or work that is carried out for you or on your behalf) at the Location. This will include, without limitation, all losses expenses incurred by **nbn** as a result of any such damage.
 8. You must immediately report any damage to the **nbn**TM network that you are/become aware of. Notification may be by telephone - 1800 626 329.
 9. Except to the extent that liability may not be capable of lawful exclusion, **nbn** and its servants and agents and the related bodies corporate of **nbn** and their servants and agents shall be under no liability whatsoever to any person for any loss or damage (including indirect or consequential loss or damage) however caused (including, without limitation, breach of contract negligence and/or breach of statute) which may be suffered or incurred from or in connection with this information sheet or any plans(including Indicative Plans) attached hereto. Except as expressly provided to the contrary in this information sheet or the attached plans(including Indicative Plans), all terms, conditions, warranties, undertakings or representations (whether expressed or implied) are excluded to the fullest extent permitted by law.

All works undertaken shall be in accordance with all relevant legislations, acts and regulations applicable to the particular state or territory of the Location. The following table lists all relevant documents that shall be considered and adhered to.

| State/Territory | Documents |
|-----------------|--|
| National | Work Health and Safety Act 2011 |
| | Work Health and Safety Regulations 2011 |
| | Safe Work Australia - Working in the Vicinity of Overhead and Underground Electric Lines (Draft) |
| | Occupational Health and Safety Act 1991 |
| NSW | Electricity Supply Act 1995 |
| | Work Cover NSW - Work Near Underground Assets Guide |
| | Work Cover NSW - Excavation Work: Code of Practice |
| VIC | Electricity Safety Act 1998 |
| | Electricity Safety (Network Asset) Regulations 1999 |
| QLD | Electrical Safety Act 2002 |
| | Code of Practice for Working Near Exposed Live Parts |
| SA | Electricity Act 1996 |
| TAS | Tasmanian Electricity Supply Industry Act 1995 |
| WA | Electricity Act 1945 |
| | Electricity Regulations 1947 |
| NT | Electricity Reform Act 2005 |
| | Electricity Reform (Safety and Technical) Regulations 2005 |
| ACT | Electricity Act 1971 |

Thank You,

nbn DBYD

Date: 19/04/2022

This document is provided for information purposes only. This document is subject to the information classification set out on this page. If no information classification has been included, this document must be treated as UNCLASSIFIED, SENSITIVE and must not be disclosed other than with the consent of nbn co. The recipient (including third parties) must make and rely on their own inquiries as to the currency, accuracy and completeness of the information contained herein and must not use this document other than with the consent of nbn co.

Copyright © 2021 nbn co Limited. All rights reserved.

To: Image Property
Phone: Not Supplied
Fax: Not Supplied
Email: sales.support@imageproperty.com.au

| | | |
|-----------------------------------|---|--|
| Dial before you dig Job #: | 31788892 |  DIAL BEFORE YOU DIG <small>www.1100.com.au</small> |
| Sequence # | 210452948 | |
| Issue Date: | 19/04/2022 | |
| Location: | 73 Nightingale Street , Mount Gravatt East , QLD , 4122 | |

Indicative Plans



LEGEND



| | |
|-------|--|
| | Parcel and the location |
| | Pit with size "5" |
| | Power Pit with size "2E". Valid PIT Size: e.g. 2E, 5E, 6E, 8E, 9E, E, null. |
| | Manhole |
| | Pillar |
| | Cable count of trench is 2. One "Other size" PVC conduit (PO) owned by Telstra (-T-), between pits of sizes, "5" and "9" are 25.0m apart. One 40mm PVC conduit (P40) owned by NBN, between pits of sizes, "5" and "9" are 20.0m apart. |
| | 2 Direct buried cables between pits of sizes, "5" and "9" are 10.0m apart. |
| | Trench containing any INSERVICE/CONSTRUCTED (Copper/RF/Fibre) cables. |
| | Trench containing only DESIGNED/PLANNED (Copper/RF/Fibre/Power) cables. |
| | Trench containing any INSERVICE/CONSTRUCTED (Power) cables. |
| | Road and the street name "Broadway ST" |
| Scale | 0 20 40 60 Meters 1:2000 1 cm equals 20 m |

Telstra account/invoice activation form



This form is to activate an account for invoicing for Telstra 'Dial Before You Dig' responses that have a data extraction fee. Requests that have a data extraction fee include -

(A) **Planning & Design, Tendering, Conveyancing, Sub-division**

(all the DBYD activity types listed above have a Telstra data extraction fee)

(B) **Large projects or other non standard responses**

(for example data use agreements or large areas that have to be manually extracted)

Please Note

- If you do not wish to be invoiced for Telstra DBYD responses that incur a Telstra data extraction fee (as listed in A and B above) then simply do not fill out and return this form.
- By not activating an account for invoicing then any Telstra DBYD request that has a data extraction fee will be automatically 'no actioned'.
- Details of applicable data extraction fees can be found in the document 'Data Extraction Fees' (should be included as attachment in email)
- If you are breaking ground (excavating for example) you will need to resubmit the DBYD request with the applicable ground breaking activity description. For example, 'mechanical excavation'.

Company Name (or Private Name) & address

ABN (if business)

Contact name for accounts (If different to your own name)

Account contact phone number

Email address for accounts

Authorised users of the account (use separate sheet if more required)

DBYD caller ID

User Name

Contact Number

Your Name

Contact Number

Date

Please forward completed form to - NI.Planservice@team.telstra.com

Post - Telstra Plan
Services Locked Bag
3820 Brisbane Qld 4001

Enquiries - NI.Planservice@team.telstra.com

or Anthony 07 3455 2365 (alternately 1800 653 935)

Important Information

Disclaimer

All Urban Utilities' records, data and information supplied via DBYD ("Data") is **indicative** only. You agree that any Data supplied to you has been or will be provided only for your convenience and has not been and will not be relied upon by you for any purpose.

You also agree that Urban Utilities does not assume any responsibility or duty of care in respect of, or warrant, guarantee or make any representation as to the Data (including its accuracy, reliability, currency or suitability).

Because the location of Urban Utilities' infrastructure shown on the Data is approximate only, you must first physically locate the infrastructure by utilising relevant site detection methodologies prior to performing any works or undertaking any activities near or adjacent to infrastructure. Possible site detection methodologies include hand digging, potholing, trenching and/or probing. You are solely responsible for the selection of appropriate site detection methodologies at all times.

To the fullest extent permitted by law, Urban Utilities will not be liable to you in contract, tort, equity, under statute or otherwise arising from or in connection with the provision of any Data to you via DBYD.

Compliance with laws

There may be both indicated and unmarked hazards, dangers or encumbrances, including underground asbestos pipes and abandoned mains within your nominated search area. You are solely responsible for ensuring that appropriate care is taken at all times and that you comply with all mandatory requirements relating to such matters, including in relation to workplace health and safety.

Damaged Infrastructure

Please note that it is an offence under Section 192 of the *Water Supply (Safety and Reliability) Act 2008* to interfere with our infrastructure without Urban Utilities' written consent.

You may be liable to Urban Utilities for any loss of or damage to our infrastructure, together with any consequential or indirect loss or damage (including without limitation, loss of use, loss of profits or loss of revenue) arising from or in connection with any interference with Urban Utilities' infrastructure by you or any other person for which you are legally responsible.

Any damage to Urban Utilities' Infrastructure must be reported immediately to the (24 Hours) Faults and Emergencies Team on 13 23 64.

Links

Technical Standards: <https://urbanutilities.com.au/development/help-and-advice/standards-and-guidelines>

Copyright

All Data is copyright.

Urban Utilities - Water, Recycled Water and Sewer Infrastructure

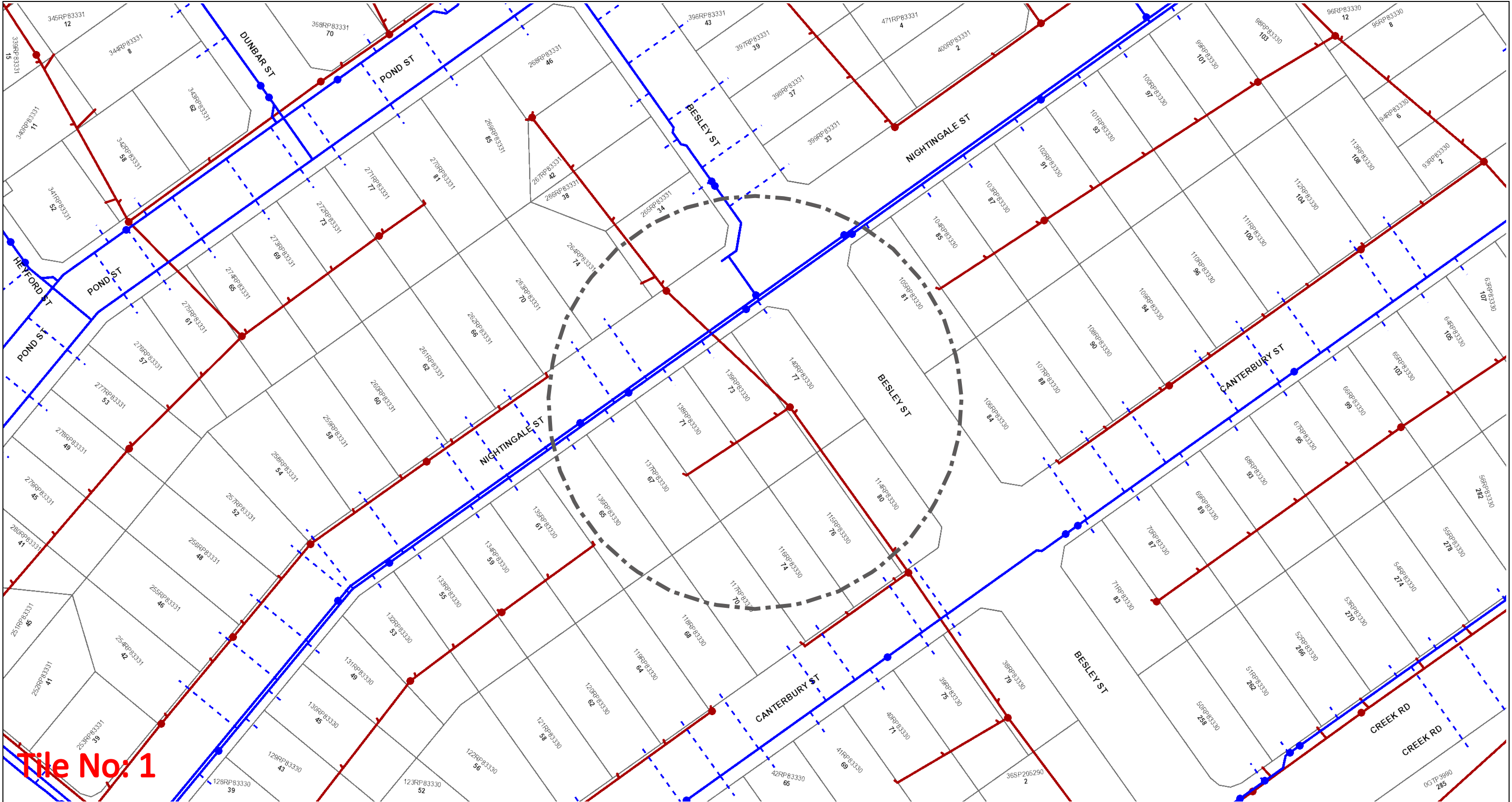

Dial Before You Dig - Urban Utilities Water, Recycled Water and Sewer Infrastructure

DBYD Reference No: 210452949

Date DBYD Ref Received: 19/04/2022

Date DBYD Job to Commence: 26/04/2022

Date DBYD Map Produced: 19/04/2022

This Map is valid for 30 days

Produced By: Urban Utilities

Sewer

- Infrastructure
- ◆ Major Infrastructure
- Network Pipelines
- ▨ Network Structures

Water

- Infrastructure
- ◆ Major Infrastructure
- Network Pipelines
- ▨ Network Structures
- - - Water Service (Indicative only)

N

Map Scale

1:1000

While reasonable measures have been taken to ensure the accuracy of the information contained in this plan response, neither Urban Utilities nor PelicanCorp shall have any liability whatsoever in relation to any loss, damage, cost or expense arising from the use of this plan response or the information contained in it or the completeness or accuracy of such information. Use of such information is subject to and constitutes acceptance of these terms.

The plans are indicative and approximate only and provided without warranties of any kind, express or implied including in relation to accuracy, completeness, correctness, currency or fitness for purpose.

Urban Utilities takes no responsibility and accepts no liability for any loss, damage, costs or liability that may be incurred by any person acting in reliance on the information provided on the plans.

This plan should be used as guide only. Any dimensions should be confirmed on site by the relevant authority.

Based on or contains data provided by the State of Queensland (Department of Natural Resources and Mines) [2020]. In consideration of the State permitting the use of this data you acknowledge and agree that the State gives no warranty in relation to the data (including accuracy, liability in negligence) for any loss, damage or costs (including consequential damage) relating to any use of the data. Data must not be used for direct marketing or be used in breach of the privacy laws. © State of Queensland Department of Natural Resources and Mines [2020]

For further information, please call Urban Utilities on 13 26 57 (8am-6pm weekdays). Faults and emergencies 13 23 64 (24/7).

www.urbanutilities.com.au

ABN 86 673 835 011