

All underground cables shall be treated as being energised. Where a cable is located that is not represented on the ENERGEX DBYD map, then ENERGEX shall be contacted immediately.

For Emergency Situations
please call 13 19 62



DBYD

Sequence: 219349606
Date: 14/12/2022
Scale: 1:500
Tile No: 1

For a full list of Map
Symbols, please
refer to the supplied
DBYD Symbology
Legend page

AS5488 Category “D” Plan

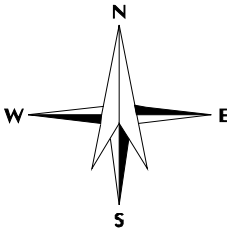

DISCLAIMER: While reasonable measures have been taken to ensure the accuracy of the information contained in this plan response, neither Energex nor PelicanCorp shall have any liability whatsoever in relation to any loss, damage, cost or expense arising from the use of this plan response or the information contained in it or the completeness or accuracy of such information. Use of such information is subject to and constitutes acceptance of these terms.

This output provides details of the ENERGEX electrical network. As variations map exist no responsibility is incurred by ENERGEX for the accuracy or completeness of the information provided. Exact positions of cables and electrical connectivity should be confirmed on site.



DBYD SYMBOLLOGY LEGEND

	Cross Bonding Link Box - Critical		Planned Cross Bonding Link Box - New/Updated
	Disconnect Box - Critical		Planned Cross Bonding Link Box - Remove
	Ring Main Unit		Planned Disconnect Box - New/Updated
	Distribution Pad Substation		Planned Disconnect Box - Remove
	Earth		Planned Distribution Pad Substation - New/Updated
	Remote Earth		Planned Distribution Pad Substation - Remove
	Cable Marker		Planned Distribution Ground Substation - New/Updated
	Handhole		Planned Distribution Ground Substation - Remove
	Manhole		Planned Ring Main Unit - New/Updated
	Commercial Industrial Pillar		Planned Ring Main Unit - Remove
	Distribution Cabinet		Planned Earth - New/Updated
	Link Pillar		Planned Earth - Remove
	Service Pillar		Planned Cable Marker - New/Updated
	Feeder Pillar		Planned Cable Marker - Remove
	Pole		Planned Remote Earth - New/Updated
	Streetlight Column		Planned Remote Earth - Remove
	Communication Junction Pillar		Planned Underground Warning Post - New/Updated
	Communication Pit		Planned Underground Warning Post - Remove
	Fibre Patch Panel		Planned Pilot Cubicle - New/Updated
	Pilot Cubicle		Planned Pilot Cubicle - Remove
	Underground Asset 33kV and above		Planned Fibre Patch Panel - New/Updated
	Underground Asset below 33kV		Planned Fibre Patch Panel - Remove
	Underground Conduit with or without cable		Planned Commercial Industrial Pillar - New/Updated
	Pit		Planned Commercial Industrial Pillar - Remove
	Communication Boundary		Planned Distribution Cabinet - New/Updated
	Reserve (RE)		Planned Distribution Cabinet - Remove
	Water Resource (WR)		Planned Link Pillar - New/Updated
	Cadastral Parcels		Planned Link Pillar - Remove
	Planned Jointing Pit - New/Updated		Planned Service Pillar - New/Updated
	Planned Jointing Pit - Remove		Planned Service Pillar - Remove
	Planned Communication Boundary - New/Updated		Planned Pole - New/Updated
	Planned Communication Boundary - Remove		Planned Pole - Remove
	Planned Tunnel/Trench/Bore - New/Updated		Planned Manhole - New/Updated
	Planned Tunnel/Trench/Bore - Remove		Planned Manhole - Remove
			Planned Streetlight Column - New/Updated
			Planned Streetlight Column - Remove
			Planned Handhole - New/Updated
			Planned Handhole - Remove
			Planned Communication Junction Pillar - New/Updated
			Planned Communication Junction Pillar - Remove

DBYD terms and conditions

Duty of care for everyone



Responsibilities – (When Working in the Vicinity of Energex Electrical Equipment)

Extreme care must be taken during non-mechanical or mechanical excavation as damage to Energex underground electrical equipment can lead to injury or death of workers or members of the public. Electrical equipment includes underground cables, conduits and other associated underground electrical equipment used for controlling, generating, supplying, transforming or transmitting electricity.

A person conducting a business or undertaking (PCBU) must ensure the person's business or undertaking is conducted in a way that is electrically safe. This includes:

- a) ensuring that all electrical equipment used in the conduct of the person's business or undertaking is electrically safe;
- b) if the person's business or undertaking includes the performance of electrical work, ensuring the electrical safety of all persons and property likely to be affected by the electrical work; and
- c) if the person's business or undertaking includes the performance of work, whether or not electrical work, involving contact with, or being near to, exposed parts, ensuring persons performing the work are electrically safe.

In addition, a PCBU at a workplace must ensure, so far as is reasonably practicable, that no person, plant or thing at the workplace comes within an unsafe distance of an underground electric line.

Workers and other persons must also take reasonable care for their own and other person's electrical safety. This includes complying, so far as is reasonably able, with any reasonable instructions given by Energex to ensure compliance with the [Electrical Safety Act 2002](#)

DBYD terms and conditions

Duty of care for everyone

The following matters must be considered when working near Energex electrical equipment:

The PCBU must ensure, so far as is reasonably practicable, that no person, plant or thing at the workplace comes within an unsafe distance of an underground electric line (see section 68 of the [Electrical Safety Regulation 2013](#))

1. It is the responsibility of the architect, consulting engineer, developer, and head contractor in the project planning stages to design for minimal impact and protection of Energex electrical equipment.
2. It is the constructor's responsibility to:
 - a) Anticipate and request plans of Energex electrical equipment for a location at a reasonable time before construction begins.
 - b) Visually locate Energex electrical equipment by hand or vacuum excavation where construction activities may damage or interfere with Energex electrical equipment.
 - c) To notify Energex if the information provided is found to be not accurate or assets are found on site that are not recorded on the Energex DBYD plans.
 - d) Read and understand all the information and disclaimers provided.

Note: A constructor may include but not limited to a PCBU, Designer, Project Manager, Installer, Contractor or a Civil Contractor

3. Comply with applicable work health and safety and electrical safety codes of practice including but not limited to:
 - a) Working near overhead and underground electric lines – [Electrical safety codes of practice 2020](#)
 - b) Managing electrical risk in the workplace – [Electrical safety code of practice 2013](#)
 - c) Managing the risks of plant in the workplace – [Electrical safety code of practice 2013](#)
 - d) Excavation work – [Electrical safety code of practice 2013](#)

IMPORTANT NOTES:

- As the alignment and boundaries of roadways with other properties (and roads within roadways) frequently change, the alignments and boundaries contained within Energex plans and maps will frequently differ from present alignments and boundaries “on the ground”. Accordingly, in every case where it appears that alignments and boundaries have shifted, or new roadways have been added, the constructor should obtain confirmation of the actual position of Energex cables and pipelines under the roadways. In no case should the constructor rely on statements of third parties in relation to the position of Energex cables and pipelines. It is the applicant's responsibility to accurately locate all services as part of the design and/or prior to excavation.
- Energex does not provide information on private underground installations, including consumers' mains that may run from Energex mains onto private property. Assets located on private property are the responsibility of the owner for identification and location.
- Energex plans are circuit diagrams or pipe indication diagrams only and indicate the presence of plant in the general vicinity of the geographical area shown. Exact ground cover and alignments cannot be given with any certainty; as such levels can change over time.
- All underground conduits are presumed to contain asbestos. Refer to “Code of Practice for the Management and Control of Asbestos in Workplaces [NOHSC: 2018 (2005)] - https://www.safeworkaustralia.gov.au/system/files/documents/1702/codeofpracticeformanagementcontrolofasbestosintheworkplace_nohsc2018-2005
- Plans provided by Energex do not show the presence of any Overhead Network
- In addition to underground cables marked on attached plan there maybe underground Earth Conductors in the vicinity of the nominated work area(s) that are not marked on the plans.
- There may also be other buried assets such as tanks for fluid filled cables that do not appear on GIS plots but are shown on detailed as constructed drawings.
- Being aware of your obligations in [s 304] Excavation work— underground essential services information under the [Work Health and Safety Regulation 2011](#) , Chapter 6 Construction work, Part 6.3 Duties of person conducting business or undertaking. This includes but is not limited to taking reasonable steps to obtain the current information & providing this information to persons engaged to carry out the excavation work. For further information please refer to: - <http://www.legislation.qld.gov.au/LEGISLTN/SLs/2011/11SL240.pdf>
- Energex plans are designed to be printed in colour and as an A4 Landscape orientation

DBYD terms and conditions

Duty of care for everyone

Conditions – (When Working in the Vicinity of Energex Electrical Equipment)

Records:

The first step before any excavation commences is to obtain records of Energex plant in the vicinity of the work. For new work, records should be obtained during the planning and design stage. The records provided by Energex must be made available to all construction groups on site. Where plant information is transferred to plans for the proposed work, care must be exercised to ensure that important detail is not lost in the process.

Plans and or details provided by Energex are current for four weeks from the date of dispatch and should be disposed of by shredding or any other secure disposal method after use. A new DBYD enquiry must be made for proposed works/activities to be undertaken outside of the four-week period.

Energex retains copyright of all plans and details provided in connection with your request. Energex plans or other details are provided for the use of the applicant, its servants, or agents, and shall not be used for any unauthorised purpose. On receipt of DBYD plans and before commencing excavation work or similar activities near Energex's plant, check to see that it relates to the area you have requested and carefully locate this plant first to avoid damage. If you are unclear about any information contained in the plan, please contact Energex on the General Enquiries number listed above for further advice.

Energex, its servants or agents shall not be liable for any loss or damage caused or occasioned by the use of plans and or details so supplied to the applicant, its servants and agents, and the applicant agrees to indemnify Energex against any claim or demand for any such loss or damage.

The constructor is responsible for all plant damages when works commence prior to obtaining Energex plans, or failure to follow agreed instructions, or failure to demonstrate all reasonable measures were taken to prevent the damage once plans were received from Energex. Energex reserves all rights to recover compensation for loss or damage caused by interference or damage, including consequential loss and damages to its cable network, or other property.

NOTE: Where your proposed work location contains Energex 33kV or greater Underground cables please access the [Energex Working Near Underground Cables 33kV or Higher web page](#) for more information.

Location of Cables:

Examining the records is not sufficient, as reference points may change from the time of installation. Records must also be physically proven when working in close proximity to them. The exact location of plant likely to be affected shall be confirmed by use of an electronic cable and pipe locator followed by **careful hand or vacuum excavation to the level of cable protection cover strips or conduits**. When conducting locations, please be aware that **no** unauthorised access is permitted to Energex Assets– including Pits, Low Voltage Disconnection Boxes, Low Voltage Pillars or High Voltage Link Boxes.

Hand or vacuum excavation must be used in advance of excavators. In any case, where any doubt exists with respect to interpretation of cable records, contact Energex on the General Enquires number listed above for further advice.

If the constructor is unable to locate Energex underground assets within 5 metres of nominal plan locations, they should contact the Energex General Enquires number listed above for further advice.

If unknown cables or conduits (i.e. not shown on issued DBYD plans) are located during excavation:

1. Call the ELECTRICITY EMERGENCIES number listed above
2. Treat cables as if alive, post a person to keep all others clear of the excavation until Energex crew attend to make safe.
3. All work in the vicinity of damaged plant should cease and the area should be vacated until a clearance to continue work has been obtained from an Energex officer.

Electrical Cable Installation Methods:

Energex cables are installed with a variety of protection devices including:

- | | |
|---------------------------------------------------------------------------------------------------|---------------------------------------|
| 1. Clay paving bricks or tiles marked "Electricity" or similar (also unmarked) | 2. Concrete or PVC cover slabs |
| 3. PVC, A/C or fibro conduit, fibre reinforced concrete, iron or steel pipe | 4. Concrete encased PVC or steel pipe |
| 5. Thin plastic marker tape | 6. Large pipes housing multiple ducts |
| 7. Multiple duct systems, including earthenware or concrete 2-, 4-, and 6-way ducts and shamrocks | |

Note: Some cables are known to be buried without covers and cables may change depth or alignment along the route.

Excavating Near Cables:

For all work within 2.5 m of nominal location, the constructor is required to hand or vacuum excavate (pothole) and expose the plant, hence proving its exact location before work can commence.

Cable protection cover strips shall not be disturbed. Excavation below these cover strips, or into the surrounding backfill material is not permitted.

DBYD terms and conditions

Duty of care for everyone

Excavating Parallel to Cables:

If construction work is parallel to Energex cables, then hand or vacuum excavation (potholing) at least every 4 m is required to establish the location of all cables, hence confirming nominal locations before work can commence. *Generally, there is no restriction to excavations parallel to Energex cables to a depth not exceeding that of the cable. **Note: Cable depths & alignment may change suddenly.***

Separation from Cables:

Any service(s) must be located at the minimum separation as per the tables below:

Table 1. Minimum Separation Requirements for Underground Services Running Parallel with Energex Assets

(Minimum Separation required in mm)							
Voltage Level	Gas	Communication or TV	Water		Sanitary drainage		Storm Water
			≤DN 200	>DN200	≤DN 200	>DN 200	
LV	250	100	500	*1000	500	1000	500
HV		300					
*Contact Energex/council to obtain specific separation distances							

Table 2. Minimum Separation Requirements for Underground Services Crossing Energex Assets

(Minimum Separation required in mm)					
Voltage Level	Gas	Communication or TV	Water	Sanitary drainage	Storm Water
LV & HV	100	100	300	300	100

Where the above table does not list a separation requirement for a particular underground service then 300mm shall be used.

Excavating Across Cables:

The standard clearance between services shall be maintained as set down in Table 2 above. If the width or depth of the excavation is such that the cables will be exposed or unsupported, then Energex shall be contacted to determine whether the cables should be taken out of service, or whether they need to be protected or supported. In no case shall a cable cover be removed without approval. A cable cover may only be removed under the supervision of an Energex authorised representative. Protective cover strips when removed must be replaced under Energex supervision. Under no circumstances shall they be omitted to allow separation between Energex cables and other services.

Heavy Machinery Operation Over Cables:

Where heavy "Crawler" or "Vibration" type machinery is operated over the top of cables, a minimum cover of 450 mm to the cable protective cover mains must be maintained using load bearing protection whilst the machinery is in operation. For sensitive cables (i.e. 33 and 110kV fluid and gas filled cables), there may be additional constraints placed on vibration and settlement by Energex.

Directional Boring Near Cables:

When boring parallel to cables, it is essential that trial holes are carefully hand or vacuum excavated at regular intervals to prove the actual location of the conduits/cables before using boring machinery. Where it is required to bore across the line of cables, the actual location of the cables shall first be proven by hand or vacuum excavation. A trench shall be excavated one metre from the side of the cables where the auger will approach to ensure a minimum clearance of 500mm above and below all LV, 11kV, 33kV & 110/132kV cables shall be maintained.

Explosives:

Explosives must not be used within 10 metres of cables, unless an engineering report is provided indicating that no damage will be sustained. Clearances should be obtained from Energex's Planning Engineer for use of explosives in the vicinity of Energex cables.

Damage Reporting:

All damage to cables, conduits and pipes must be reported no matter how insignificant the damage appears to be. Even very minor damage to cable protective coverings can lead to eventual failure of cables through corrosion of metal sheaths and moisture ingress.

If any Damaged conductor is found:

1. Call the ELECTRICITY EMERGENCIES number listed above
2. Treat cables as if alive, post a person to keep all others clear of the excavation until Energex crew attend to make safe.
3. All work in the vicinity of damaged plant should cease and the area should be vacated until a clearance to continue work has been obtained from an Energex officer.

DBYD terms and conditions

Duty of care for everyone

Plant Solutions and Assistance:

If plant location plans or visual location of Energex plant by hand or vacuum excavation reveals that the location of Energex plant is situated wholly or partly where the developer or constructor plans to work, then Energex shall be contacted to assist with your development of possible engineering solutions.

If Energex relocation or protection works are part of the agreed solution, then payment to Energex for the cost of this work shall be the responsibility of the principal developer or constructor. Energex will provide an estimated quotation for work on receipt of the developer's or constructor's order number before work proceeds.

It will be necessary for the developer or constructor to provide Energex with a written Work Method Statement for all works in the vicinity of or involving Energex plant. This Work Method Statement should form part of the tendering documentation and work instruction.

Vacuum Excavations (Hydro Vac)

When operating hydro vac equipment to excavate in vicinity of underground electrical assets (cables/conduits):

Fitted with:

- Nonconductive (neoprene rubber or equivalent) vacuum (suction) hose.
- Oscillating nozzle on pressure wand with water pressure adjusted to not exceeding 2000 psi.

Maintain a minimum distance of 200mm between end of pressure wand and underground electrical assets. DO NOT insert the pressure wand jet directly into subsoil.

Ensure pressure wand is not directly aimed at underground electrical assets (cables/conduits).

Safety Notices (Underground Work)

There is no exclusion zone applicable for underground electrical assets – conduits, cables (unless cable is damaged, or conductors or terminations have been exposed) therefore there is **no requirement for a written Safety Advice** to be obtained provided the work location does not contain overhead electric lines or other exposed live parts.

Further information on Working Safely around Energex assets:

https://www.energex.com.au/_data/assets/pdf_file/0010/211231/Working-near-OH-UG-lines-BS001405R107ver2.pdf

Thank you for your interest in maintaining a safe and secure Electricity Distribution network. Energex welcomes your feedback on this document via email to dbyd@energex.com.au.

General enquiries (7:00am - 5:30pm Mon to Fri)	13 12 53
DBYD enquiries (7:00am - 3:30pm Mon to Fri)	(07) 3664 5400
Life threatening emergencies only triple zero (000) or	13 19 62

E: custserve@energex.com.au
E: dbyd@energex.com.au

W: energex.com.au/lualmap
ABN: 40 078 849 055

To re-submit or change the nominated search area please visit **www.1100.com.au**



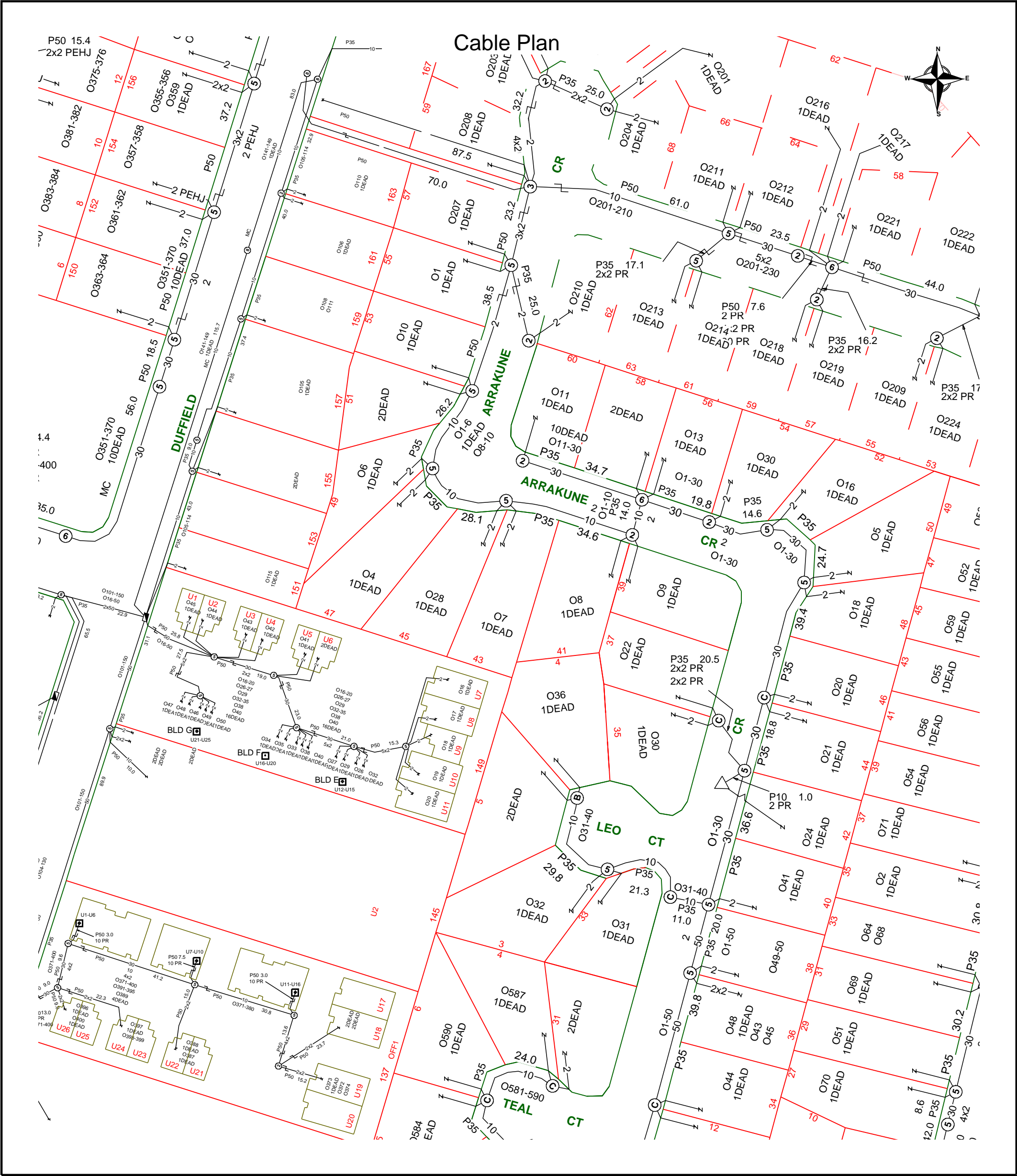

	<p>Report Damage: https://service.telstra.com.au/customer/general/forms/report-damage-to-telstra-equipment Ph - 13 22 03 Email - Telstra.Plans@team.telstra.com Planned Services - ph 1800 653 935 (AEST bus hrs only) General Enquiries</p> <p>TELSTRA CORPORATION LIMITED A.C.N. 051 775 556</p> <p>Generated On 14/12/2022 22:20:03</p>	<p>Sequence Number: 219349610</p> <p>CAUTION: Fibre optic and/ or major network present in plot area. Please read the Duty of Care and contact Telstra Plan Services should you require any assistance.</p>
------------------------------------------------------------------------------------	---------------------------------------------------------------------------------------------------------------------------------------------------------------------------------------------------------------------------------------------------------------------------------------------------------------------------------------------------------------------------------------------------------------------------------------------------------------	--------------------------------------------------------------------------------------------------------------------------------------------------------------------------------------------------------------------

The above plan must be viewed in conjunction with the Mains Cable Plan on the following page

WARNING
Telstra plans and location information conform to Quality Level "D" of the Australian Standard AS 5488-Classification of Subsurface Utility Information. As such, Telstra supplied location information is indicative only. Spatial accuracy is not applicable to Quality Level D. Refer to AS 5488 for further details. The exact position of Telstra assets can only be validated by physically exposing it. Telstra does not warrant or hold out that its plans are accurate and accepts no responsibility for any inaccuracy. Further on site investigation is required to validate the exact location of Telstra plant prior to commencing construction work. A Certified Locating Organisation is an essential part of the process to validate the exact location of Telstra assets and to ensure the asset is protected during construction works.

See the Steps- Telstra Duty of Care that was provided in the email response.

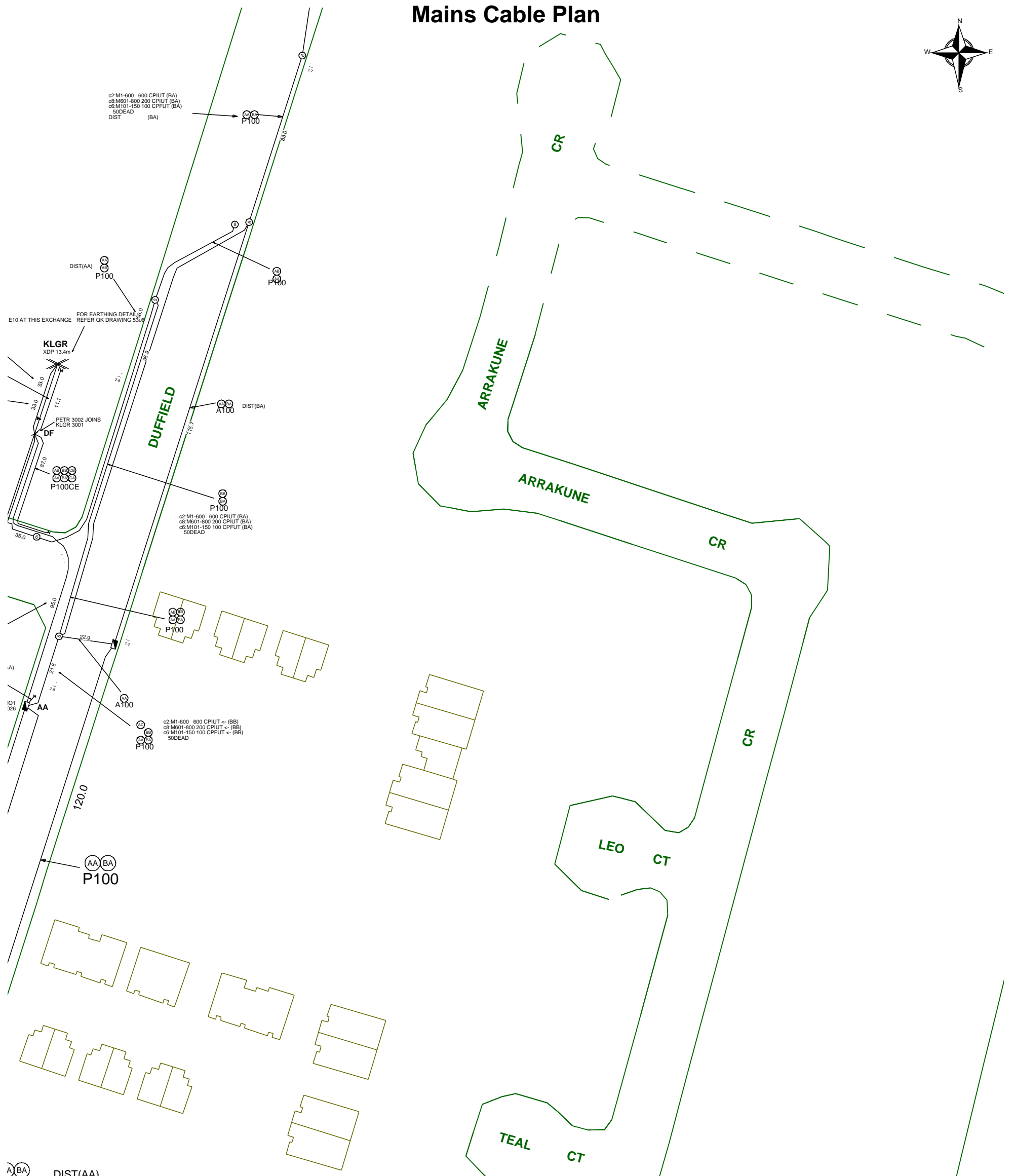

Sequence Number: 219349610

CAUTION: Fibre optic and/ or major network present in plot area. Please read the Duty of Care and contact Telstra Plan Services should you require any assistance.

Generated On 14/12/2022 22:20:05

See the Steps- Telstra Duty of Care that was provided in the email response.

Before You Dig Australia

Think before you dig

This document has been sent to you because you requested plans of the Telstra network through Before You Dig Australia (BYDA).

If you are working or excavating near telecommunications cables, or there is a chance that cables are located near your site, you are responsible to avoid causing damage to the Telstra network.

Please read this document carefully. Taking your time now and following the steps below can help you avoid damaging our network, interrupting services, and potentially incurring civil and criminal penalties.

Our network is complex and working near it requires expert knowledge. Do not attempt these activities if you are not qualified to do so.



1. Plan

Plan your work with the latest plans of our network.

Plans provided through the BYDA process are indicative only*.

This means the actual location of our asset may differ substantially from that shown on the plans.

Refer to steps 2 and 3 to determine actual location prior to proceeding with construction.



2. Prepare

Engage a DBYD Certified Locating Organisation (CLO) via dbydlocator.com to identify, validate and protect Telstra assets before you commence work.



3. Pothole

Validate underground assets by potholing by hand or using non-destructive vacuum extraction methods.

Electronic detection alone (step 2) is not deemed to validate underground assets and must not be used for construction purposes.

If you cannot validate the Telstra network, you must not proceed with construction.



4. Protect

Protect our network by maintaining the following distances from our assets:

- › 1.0m Mechanical Excavators, Farm Ploughing, Tree Removal
- › 500mm Vibrating Plate or Wacker Packer Compactor
- › 600mm Heavy Vehicle Traffic (over 3 tonnes) not to be driven across Telstra ducts or plant
- › 1.0m Jackhammers/Pneumatic Breakers
- › 2.0m Boring Equipment (in-line, horizontal and vertical)



5. Proceed

You can proceed with your work only once you have completed all the appropriate preparation, potholing and protection.

Report any damage immediately



<https://service.telstra.com.au/customer/general/forms/report-damage-to-telstra-equipment>



13 22 03

If you receive a message asking for an account or phone number say "I Don't have one" Then say "Report Damage" then press 1 to speak to an operator.

Relocating assets

If your project requires the relocation of a Telstra asset, please contact the Telstra Network Integrity Group:



[Request Asset Relocation Or Commercial Works \(telstra.com.au\)](https://telstra.com.au)



NetworkIntegrity@team.telstra.com



1800 810 443 (AEST business hours only)

Never try to move or alter our network infrastructure without authorisation. By law, only authorised people can work on our assets or enter a facility owned or operated by us. Any interference, including unauthorised entry or tampering, may result in legal action.

Further information

Plan enquiries



1800 653 935 (AEST business hours only)



Telstra.Plans@team.telstra.com

Information on how to find cables and request asset relocations:

<https://www.telstra.com.au/consumer-advice/digging-construction>

Asset Plan Readers

PDF [Adobe Acrobat Reader DC Install for all versions](#)

DWF [Download Design Review](#) | [DWF Viewer](#) | [Autodesk](#)

Disclaimer and legal details



*Telstra advises that the accuracy of the information provided by Telstra conforms to Quality Level D as defined in AS5488-2013.

It is a criminal offence under the Criminal Code Act 1995 (Cth) to tamper or interfere with telecommunications infrastructure.

Telstra will also take action to recover costs and damages from persons who damage assets or interfere with the operation of Telstra's networks.

By receiving this information including the indicative plans that are provided as part of this information package you confirm that you understand and accept the risks of working near Telstra's network and the importance of taking all of the necessary steps to confirm the presence, alignments and various depths of Telstra's network. This in addition to, and not in replacement of, any duties and obligations you have under applicable law.

When working in the vicinity of a telecommunications plant you have a "Duty of Care" that must be observed. Please read and understand all the information and disclaimers provided below.

The Telstra network is complex and requires expert knowledge to interpret information, to identify and locate components, to pothole underground assets for validation and to safely work around assets without causing damage. If you are not an expert and/or qualified in these areas, then you must not attempt these activities. Telstra will seek compensation for damages caused to its property and losses caused to Telstra and its customers. The 5 P's to prevent damage to Telstra assets are listed above. Construction activities and/or any activities that potentially may impact on Telstra's assets must not commence without first undertaking these steps. Construction activities can include anything that involves breaking ground, potentially affecting Telstra assets.

If you are designing a project, it is recommended that you also undertake these steps to validate underground assets prior to committing to your design.

This Notice has been provided as a guide only and may not provide you with all the information that is required for you to determine what assets are on or near your site of interest. You will also need to collate and understand all of the information received from other Utilities and understand that some Utilities are not a part of the BYDA program and make your own enquiries as appropriate. It is the responsibility of the entities undertaking the works to protect Telstra's network during excavation / construction works.

Telstra owns and retains the copyright in all plans and details provided in conjunction with the applicant's request. The applicant is authorised to use the plans and details only for the purpose indicated in the applicant's request. The applicant must not use the plans or details for any other purpose.

Telstra plans or other details are provided only for the use of the applicant, its servants, agents, or Certified Locating Organisation. The applicant must not give the plans or details to any parties other than these and must not generate profit from commercialising the plans or details.

Telstra, its servants or agents shall not be liable for any loss or damage caused or occasioned by the use of plans and or details so supplied to the applicant, its servants and agents, and the applicant agrees to indemnify Telstra against any claim or demand for any such loss or damage.

Please ensure Telstra plans and information provided always remains on-site throughout the inspection, location, and construction phase of any works.

Telstra plans are valid for 60 days after issue and must be replaced if required after the 60 days.

Data Extraction Fees

In some instances, a data extraction fee may be applicable for the supply of Telstra information. Typically, a data extraction fee may apply to large projects, planning and design requests or requests to be supplied in non-standard formats. For further details contact Telstra Planned Services.

Telstra does not accept any liability or responsibility for the performance of or advice given by a Certified Locating Organisation. Certification is an initiative taken by Telstra towards the establishment and maintenance of competency standards. However, performance and the advice given will always depend on the nature of the individual engagement.

Neither the Certified Locating Organisation nor any of its employees are an employee or agent for Telstra. Telstra is not liable for any damage or loss caused by the Certified Locating Organisation or its employees.

Once all work is completed, the excavation should be reinstated with the same type of excavated material unless specified by Telstra

The information contained within this pamphlet must be used in conjunction with other material supplied as part of this request for information to adequately control the risk of potential asset damage.

When using excavators and other machinery, also check the location of overhead power lines.

Workers and equipment must maintain safety exclusion zones around power lines

WARNING: Telstra plans and location information conform to Quality Level 'D' of the Australian Standard AS 5488 - Classification of Subsurface Utility Information. As such, Telstra supplied location information is indicative only. Spatial accuracy is not applicable to Quality Level D. Refer to AS 5488 for further details. Telstra does not warrant or hold out that its plans are accurate and accepts no responsibility for any inaccuracy shown on the plans. **FURTHER ON SITE INVESTIGATION IS REQUIRED TO VALIDATE THE EXACT LOCATION OF TELSTRA PLANT PRIOR TO COMMENCING CONSTRUCTION WORK.** A plant location service is an essential part of the process to validate the exact location of Telstra assets and to ensure the assets are protected during construction works. The exact position of Telstra assets can only be validated by physically exposing them. Telstra will seek compensation for damages caused to its property and losses caused to Telstra and its customers.

Privacy Note

Your information has been provided to Telstra by BYDA to enable Telstra to respond to your BYDA request. Telstra keeps your information in accordance with its privacy statement. You can obtain a copy at www.telstra.com.au/privacy or by calling us at 1800 039 059 (business hours only).



OPENING ELECTRONIC MAP ATTACHMENTS -

Telstra Cable Plans are generated automatically in either PDF or DWF file types dependant on the site address and the size of area selected. You may need to download and install free viewing software from the internet e.g.



PDF Map Files (max size A3)

Adobe Acrobat Reader (<http://get.adobe.com/reader/>),



DWF Map Files (all sizes over A3)

Autodesk A360 (<https://360.autodesk.com/viewer>) or

Autodesk Design Review (<http://usa.autodesk.com/design-review/>) for DWF files.
(Windows)



Telstra DBYD map related enquiries

email - Telstra.Plans@team.telstra.com

1800 653 935 (AEST Business Hours only)



REPORT ANY DAMAGE TO THE TELSTRA NETWORK IMMEDIATELY

Report online - <https://service.telstra.com.au/customer/general/forms/report-damage-to-telstra-equipment>

Ph: 13 22 03

If you receive a message asking for a phone or account number say:

"I don't have one" then say "Report Damage" then press 1 to speak to an operator.



Telstra New Connections / Disconnections

13 22 00

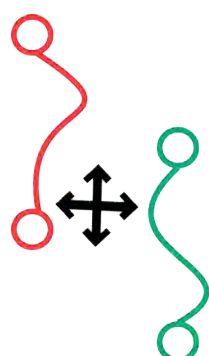

Telstra asset relocation enquiries: 1800 810 443 (AEST business hours only).

NetworkIntegrity@team.telstra.com

<https://www.telstra.com.au/consumer-advice/digging-construction>

Certified Locating Organisation (CLO)

<https://dbydlocator.com/certified-locating-organisation/>



DBYDCertification

Please refer to attached Accredited Plant Locator.pdf

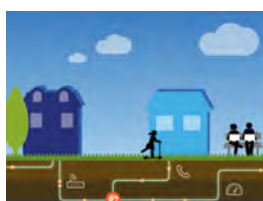

Telstra Smart Communities

Information for new developments (developers, builders, homeowners)

<https://www.telstra.com.au/smart-community>

LEGEND



For more info contact a [Certified Locating Organisation](#) or Telstra Plan Services 1800 653 935

	Exchange (Major Cable Present)		Cable Jointing Pit (number / Letter indicating Pit Type)
	Footway Access Chamber (can vary from 1-lid to 12-lid)		Elevated Joint (above ground joint on buried cable)
	Pillar / Cabinet (above ground / free standing)		Telstra Plant in shared Utility trench
	Above ground complex equipment housing (eg RIM) Please Note: This equipment is powered by 240V Electricity		Aerial Cable
	Other Carrier Telecommunications Cable/Asset		Aerial Cable (attached to joint Use Pole eg. Power)
	Distribution cables in Main Cable ducts		Direct Buried Cable
	Main Cable ducts on a Distribution plan Blocked or damaged duct.		Marker Post Installed
	Roadside / Front Boundary 2 pair lead-in to property from pit in street 1 pair working (pair ID 059) 1 pair dead (i.e. spare, not connected)		Buried Transponder
	Side / Rear Property Boundary Property Number		Marker Post, Transponder
	Single to multiple round conduit Configurations 1, 2, 4, 9 respectively (attached text denotes conduit type and size)		Optical Fibre cable direct buried
	Multiple square conduit Configurations 2, 4, 6 respectively (attached text denotes conduit type and size)	Some examples of conduit type and size: A - Asbestos cement, P - PVC / Plastic, C - Concrete, GI - Galanised iron, E - Earthenware Conduit sizes <i>nominally</i> range from 20mm to 100mm P50 50mm PVC conduit P100 100mm PVC conduit A100 100mm asbestos cement conduit	

Some Examples of how to read Telstra Plans

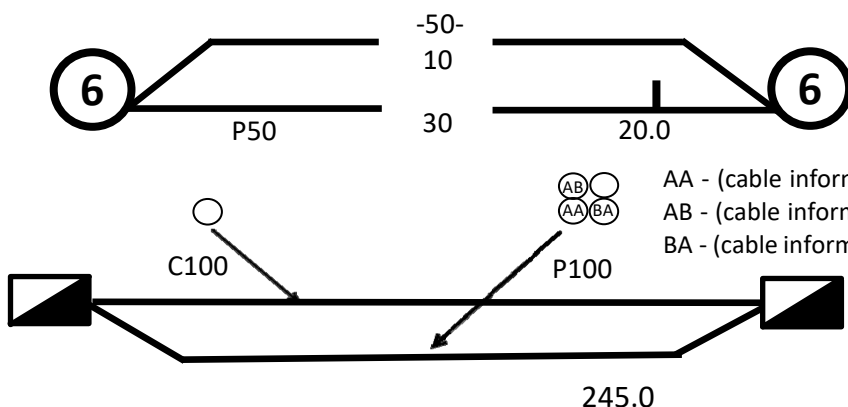

One 50mm PVC conduit (P50) containing a 50-pair and a 10-pair cable between two 6-pits. approximately 20.0m apart, with a direct buried 30-pair cable along the same route

Two separate conduit runs between two footway access chambers (manholes) approximately 245m apart A nest of four 100mm PVC conduits (P100) containing assorted cables in three ducts (one being empty) and one empty 100mm concrete duct (C100) along

WARNING: Telstra plans and location information conform to Quality Level 'D' of the Australian Standard AS 5488 - Classification of Subsurface Utility Information. As such, Telstra supplied location information is indicative only. Spatial accuracy is not applicable to Quality Level D. Refer to AS 5488 for further details. Telstra does not warrant or hold out that its plans are accurate and accepts no responsibility for any inaccuracy shown on the plans. FURTHER ON SITE INVESTIGATION IS REQUIRED TO VALIDATE THE EXACT LOCATION OF TELSTRA PLANT PRIOR TO COMMENCING CONSTRUCTION WORK. A plant location service is an essential part of the process to validate the exact location of Telstra assets and to ensure the assets are protected during construction works. The exact position of Telstra assets can only be validated by physically exposing them. Telstra will seek compensation for damages caused to its property and losses caused to Telstra and its customers.



Certified Locating Organisations (CLO)

Find the closest CLO to your worksite on: <https://dbydlocator.com/certified-locating-organisation/>

Read the disclaimer and click:

Accept and Search Now

A national map and an A-Z list of Certified Locating Organisations is displayed.

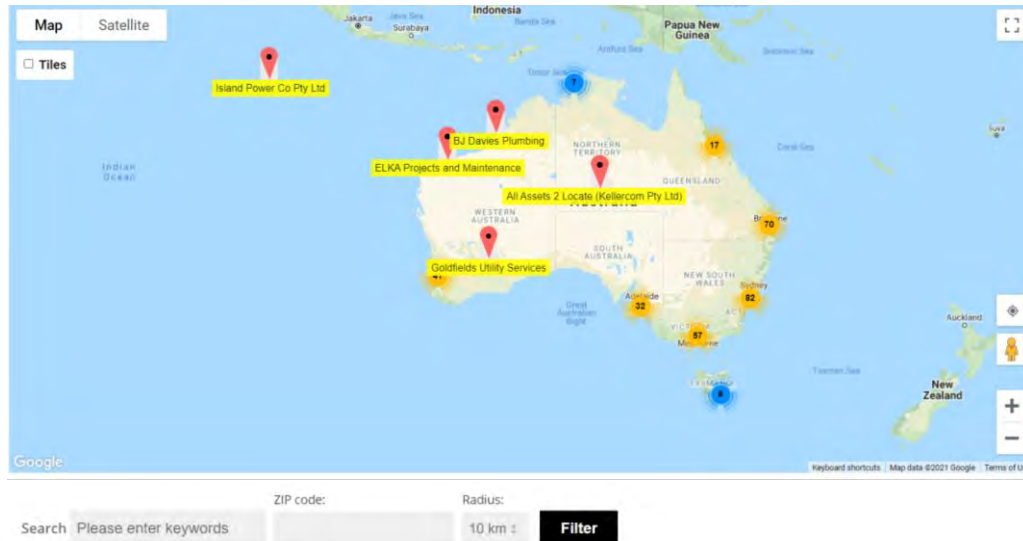

Use the map to zoom to your work area and choose the closest  Locator indicated.

OR search by entering the **postcode** of your work area.

1. Enter the post/zip code
2. Choose your search radius
3. Click filter (If there is no result, you may have to increase the search radius)
4. Click on the closest  for CLO details or view the results displayed below the map



Locator skills have been tested, and the Organisation has calibrated location and safety equipment.

Telstra is aware of each Certified Locating Organisation and their employee locators.

Only a DBYD Certified Locator registered with a Certified Locating Organisation is authorised to access Telstra network for locating purposes.

Each Certified Locator working for a CLO is issued with a photo ID Card, authorising them to access Telstra pits and manholes for the purpose of cable and plant locations.

Please ask to see your Locators' CLO ID Card.

UNITYWATER BYDA MAP

Sequence Number: 219349607

Job Number: 33301903

Printed On: 14/12/2022

Emergency Situations
Call Unitywater:
1300 086 489

This information on this plan is valid
for 30 days from "Printed On" date.

Legend

	Extent of Unitywater Area	Sewer Gravity Main
Water		Trunk Main
PS	Water Pump Station	Reticulation Main
M	Water Service	Overflow Main
*	Water Valve	Sewer Pipe (Abandoned)
—	Water Pipe (Abandoned)	Sewer Pressure Main
●	Water Hydrant	Pressure Sewer
F	Water Fitting	Rising Main
Water Main		Vacuum Main
—	Trunk Main	Pressure Sewer Service
—	Reticulation Main	Sewer Service
Sewer		Recycled Water
PS	Sewer Pump Station	PS
●	Sewer Manhole	*
*	Sewer Valve	●
F	Sewer Fitting	F
		—
		—

Map Tile: 1
Scale: 1:1000
(If printed at 100%
on A3 size paper)



Unitywater

Before You Dig Australia
Geospatial Information Systems
Ground Floor, 33 King St
Caboolture QLD 4510
Inquiries: 1300 0 Unity (1300 086 489)
Email: dbyd@unitywater.com

Disclaimer

These Maps are supplied under the following conditions:-

Mapping details are supplied from information contained in Unitywater's records which may have been furnished to Unitywater by other persons. Unitywater gives no warranty or guarantee of any kind, expressed, implied, or statutory, to the correctness or accuracy of the map details or the degree of compliance with any standards in this matter. Persons making decisions with financial or legal implications must not rely upon the map details shown on this plan for the purpose of determining whether any particular facts or circumstances exist and Unitywater (and its officers and agents) expressly disclaim responsibility for any loss or damage suffered as a result of placing reliance upon this information.

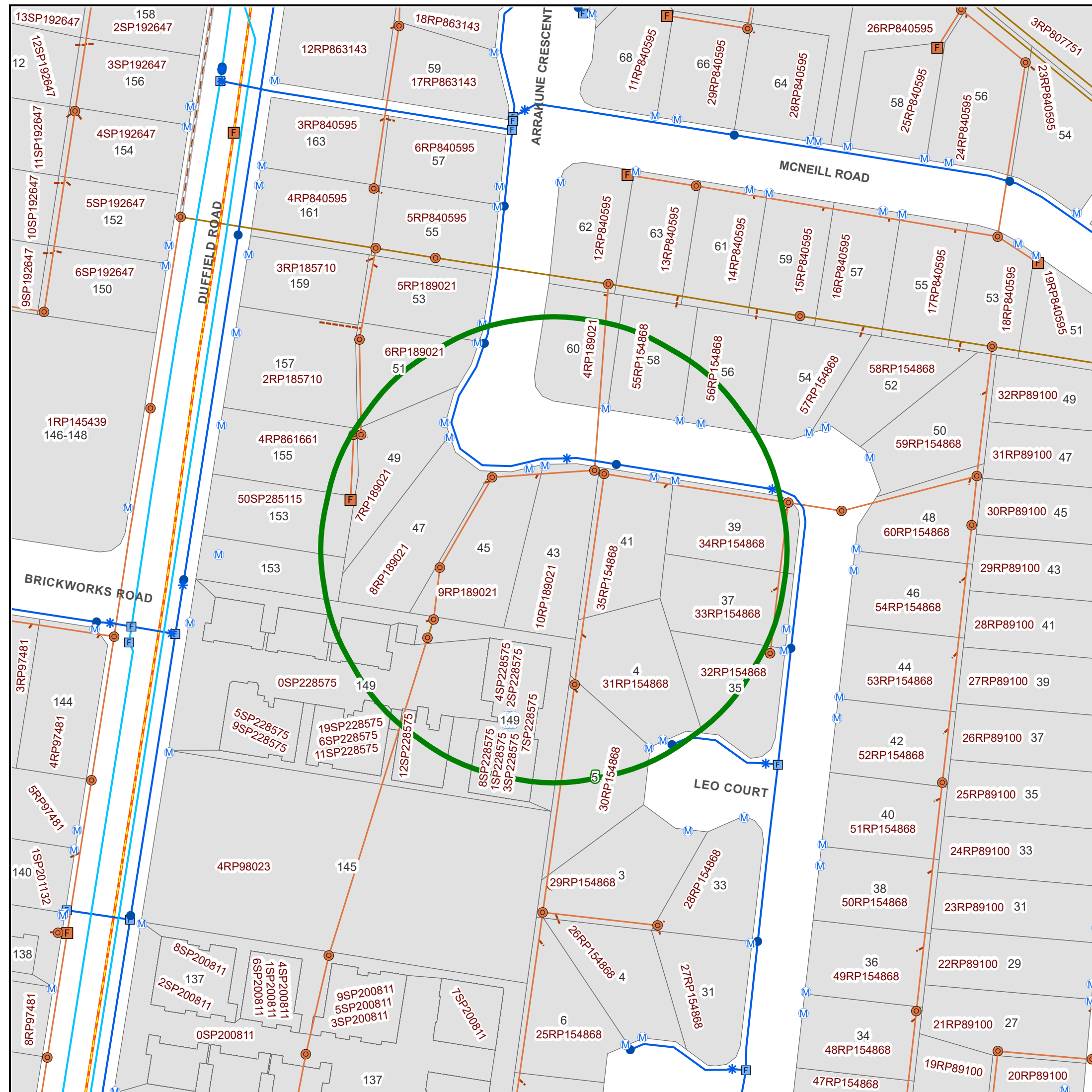
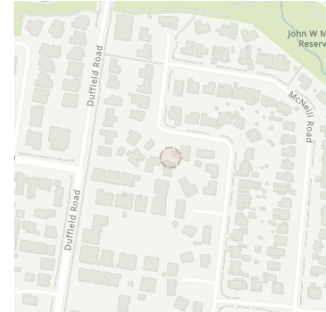

Image Property
Image property
57 Kirby Road
Aspley QLD 4034

14/12/2022



Dear Image Property

Response to your recent enquiry: Unitywater infrastructure is located on the property

Your recent Before You Dig (BYDA) enquiry about the location of water and sewerage assets on your property of interest has been sent to Unitywater.

Unitywater has located water and/or sewerage infrastructure on the property. Attached is a map locating the infrastructure and identifying the type of infrastructure that has been identified. The map and information contained on this map is valid for 30 days from Unitywater plan print date.

Also attached to this letter is additional information about your responsibilities in relation to our infrastructure.

Sequence No: 219349607

Job No: 33301903

Location: 43 Arrakune Crescent Kallangur

If you have further questions, please call the Customer Service Centre on 1300 0 UNITY (1300 086 489).

Yours sincerely

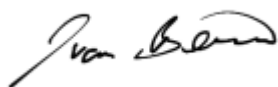

Ivan Beirne

Head of Asset Management



Important Information

Disclaimer

All Unitywater's records, data and information supplied via BYDA are indicative only. You agree that any plans supplied to you has been or will be provided only for your convenience and has not been and will not be relied upon by you for any purpose.

You also agree that Unitywater does not assume any responsibility or duty of care in respect of, or warrant, guarantee or make any representation as to the Data (including its accuracy, reliability, currency or suitability).

Unitywater's plans only indicates the general vicinity of infrastructure in a geographic area and does not state the depths at which infrastructure could be buried. You must first physically locate the infrastructure by utilising relevant site detection methodologies prior to performing any works or undertaking any activities near or adjacent to our infrastructure. You are solely responsible for the selection of appropriate site detection methodologies at all times.

To the fullest extent permitted by law, Unitywater will not be liable to you in contract, tort, equity, under statute or otherwise arising from or in connection with the provision of any plans to you via BYDA.

Compliance with laws

There may be both indicated and unmarked hazards, dangers or encumbrances, including underground asbestos pipes and abandoned mains within your nominated search area. You are solely responsible for ensuring that appropriate care is taken at all times and that you comply with all mandatory requirements relating to such matters, including in relation to workplace health and safety.

Damaged Infrastructure

Please note that it is an offence under Section 192 of the *Water Supply (Safety and Reliability) Act 2008* to interfere with our infrastructure without Unitywater's written consent.

You may be liable to Unitywater for any loss of or damage to our infrastructure, together with any consequential or indirect loss or damage (including without limitation, loss of use, loss of profits or loss of revenue) arising from or in connection with any interference with Unitywater's infrastructure by you or any other person for which you are legally responsible.

Any damage to Unitywater's Infrastructure must be reported immediately to the (24 Hours) Faults and Emergencies contact number on **1300 0 UNITY** (1300 086 489).

Copyright

All Data is copyright.

Notes

If you require further details on sewerage and water infrastructure, Detailed Infrastructure Plans are available for purchase. A request form is available through Unitywater's website <http://www.unitywater.com> or by contacting the Customer Service Centre on 1300 0 UNITY (1300 086 489).

Unitywater water and sewerage infrastructure is located across Moreton Bay, Sunshine Coast and Noosa local government areas. For information outside these areas you will need to contact the relevant authority.

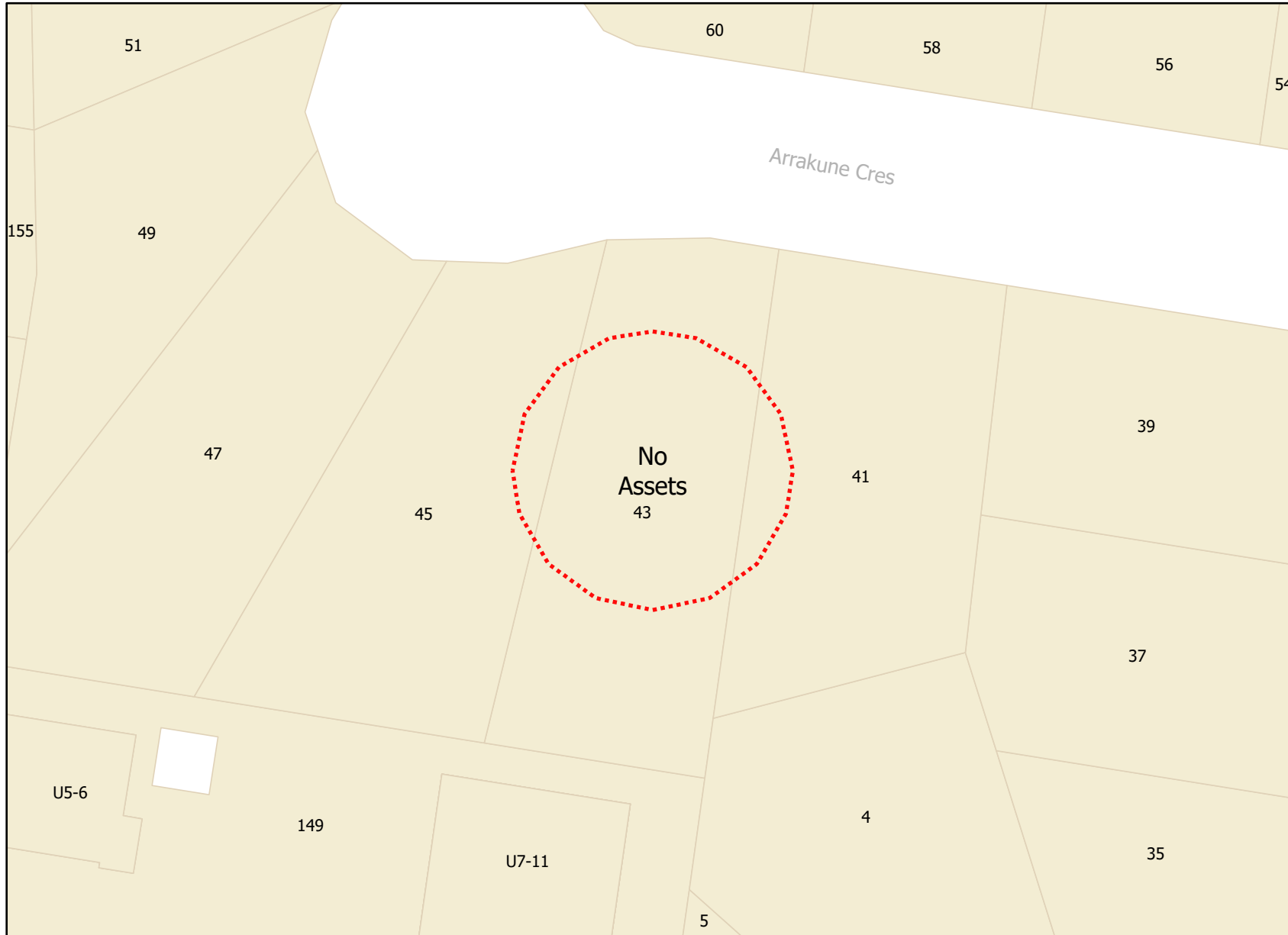

Legend

 BYDA Enquiry

Disclaimer: The Plan is provided in response to a Before You Dig request. While all reasonable care has been taken to ensure the accuracy of the information on this plan, its purpose is to provide a general indication of the location of Moreton Bay Regional Council infrastructure. The information provided may contain errors or omissions and the accuracy may not suit all users. A site inspection and investigation is recommended before commencement of any project based on this data.

In an emergency contact Moreton Bay Regional Council on 1300 477 161

[Index Sheet](#)

Plans generated by SmarterWX™ Automate

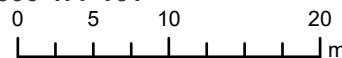

Scale 1:500

Caller Details

Contact: Image Property
Company: Image property
Address: 57 Kirby Road
Aspley QLD 4034

Caller Id: 3003158
Phone: (07) 3263 1811
Email: sales.support@imageproperty.com.au

Dig Site and Enquiry Details

WARNING: The map below only displays the location of the proposed dig site and does not display any asset owners' pipe or cables. The area highlighted has been used only to identify the participating asset owners, who will send information to you directly.

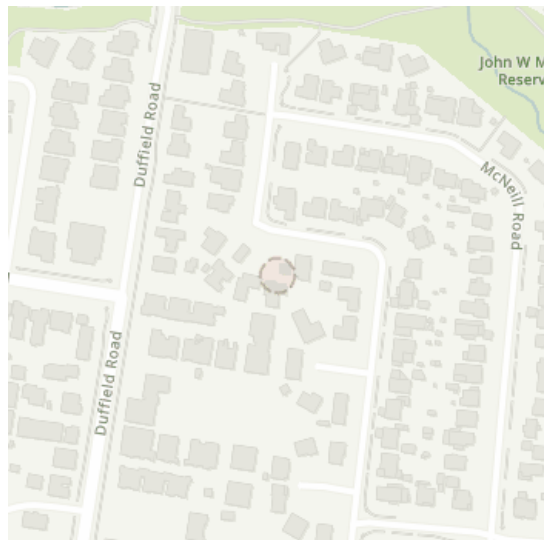

User Reference: 43 Arrakune
Working on Behalf of: Private
Enquiry Date: 14/12/2022
Start Date: 21/12/2022
End Date: 21/12/2022

Address:
43 Arrakune Crescent
Kallangur QLD 4503

Job Purpose:
Design

Onsite Activities:
Planning & Design

Location of Workplace:
Both

Location in Road:
Road, Nature Strip, Footpath

- Check that the location of the dig site is correct. If not you must submit a new enquiry.
- Should the scope of works change, or plan validity dates expire, you must submit a new enquiry.
- Do NOT dig without plans. Safe excavation is your responsibility. If you do not understand the plans or how to proceed safely, please contact the relevant asset owners.

Notes/Description of Works:
Not supplied

Your Responsibilities and Duty of Care

- The lodgement of an enquiry does not authorise the project to commence. You must obtain all necessary information from any and all likely impacted asset owners prior to excavation.
- If plans are not received within 2 working days, contact the asset owners directly & quote their Sequence No.
- ALWAYS perform an onsite inspection for the presence of assets. Should you require an onsite location, contact the asset owners directly. Please remember, plans do not detail the exact location of assets.
- Pothole to establish the exact location of all underground assets using a hand shovel, before using heavy machinery.
- Ensure you adhere to any State legislative requirements regarding Duty of Care and safe digging requirements.
- If you damage an underground asset you MUST advise the asset owner immediately.
- By using this service, you agree to Privacy Policy and the terms and disclaimers set out at www.1100.com.au
- For more information on safe excavation practices, visit www.1100.com.au

Asset Owner Details

The assets owners listed below have been requested to contact you with information about their asset locations within 2 working days. Additional time should be allowed for information issued by post. It is **your responsibility** to identify the presence of any underground assets in and around your proposed dig site. Please be aware, that not all asset owners are registered with the Before You Dig service, so it is **your responsibility** to identify and contact any asset owners not listed here directly.

** Asset owners highlighted by asterisks ** require that you visit their offices to collect plans.

Asset owners highlighted with a hash # require that you call them to discuss your enquiry or to obtain plans.

Seq. No.	Authority Name	Phone	Status
219349606	Energex QLD	13 12 53	NOTIFIED
219349609	Moreton Bay Regional Council	1300 477 161	NOTIFIED
219349608	NBN Co Qld	1800 687 626	NOTIFIED
219349610	Telstra QLD South East	1800 653 935	NOTIFIED
219349607	Unitywater South	1300 086 489	NOTIFIED

END OF UTILITIES LIST