



## CONGRATULATIONS ON THE PURCHASE OF YOUR NEW HOME

Dear Sir & Madam

**Property Address: Lot 704 / Street No. 17 Bush Tucker Drive**

The termite risk management installed to your home requires annual inspections to be carried out as part of a termite management measure (as per 3660.1). Our annual warranty program allows you to have peace of mind knowing your property will be inspected annually.

For an annual Termite Warranty to be effective the inspections must be continuous. With millions of dollars' worth of termite damage being caused annually, it is a risk that cannot be ignored. It is a greater risk to your home than fire, storms, floods and earthquakes - and insurance companies will not insure against termite attack.

The comprehensive Termicide warranty covers complete reinstatement of structural timber and ancillary timbers damaged by termites at your property, subject to the warranty terms and conditions included in this information package.

Once your inspection is completed you will receive a written report, this will advise you of any conducive conditions or areas of concern relating to foraging termite activity and general knowledge of the termite management measure used on your property along with maintenance tips to limit the risk of termite attack.

**To continue your Termicide Warranty, a warranty inspection must be carried out every 12 months and any necessary recommendations reported must be adhered to. The first inspection is due 12 months from the date of installation of the termite management system.**

Please complete the attached Termicide Authorisation Form to proceed with our Annual Inspection program and email to [admin@termicide.com.au](mailto:admin@termicide.com.au) or post to PO Box 949, Paradise Point QLD 4216.

If you have any questions, please do not hesitate to contact us on 07 5563 3003, or go to our website at [www.termicide.com.au](http://www.termicide.com.au).

We also provide a discounted service for our general pest control services including cockroaches and spiders if carried out at the time of inspection.

Kind regards

### **Termicide Pest Control**

Phone: 5563 3003  
Email: [admin@termicide.com.au](mailto:admin@termicide.com.au)

**Termicide Pest Control**  
BSA LIC: 1037693  
PC LIC: POC 012096  
ABN: 18 003 608 018  
PH: 07 5563 3003  
FAX: 07 5563 3004  
**PO Box 949**  
**Paradise Point Q 4216**





## ANNUAL WARRANTY INSPECTION RENEWAL FORM

Our Ref: 165880

Owner's Name:

Property Address: Lot 704 / Street No. 17 Bush Tucker Drive NARANGBA QLD 4504

Postal Address (if different to above): \_\_\_\_\_

Telephone & Mobile No: \_\_\_\_\_

Email Address: \_\_\_\_\_

**SERVICE:** Please tick which option that you require:

The annual warranty inspections are required to determine whether termite activity or damage is present and to ensure that the termite management system adheres to the Termicide Warranty Terms and Conditions.

- ☐ **Annual Warranty Inspection: Unit / Duplex \$165\* Standard Home \$185\***
- ☐ **Annual Warranty Inspection & Pest Control: Unit / Duplex \$277\* Standard Home \$311\***  
(30% discount on pest control for combined service).

### **ANNUAL AUTHORISATION:**

In signing below, I confirm that I have read and agree to provide Termicide the following authorisation:

- I authorise Termicide to organise and charge for the service chosen above on an annual basis. I understand that the appointment time will be organised as near as possible to the annual renewal date for the property.
- I agree to notify Termicide of changes to property ownership or change to managing agent details.

### **INVESTMENT PROPERTY:**

- I authorise Termicide to liaise directly with my current or any subsequent appointed real estate agent.
- I agree that should any future work order issued by a managing agent not include all services authorised on this form, the additional services will be completed at my authority.

Name: \_\_\_\_\_

Signature: \_\_\_\_\_ Date: \_\_\_\_/\_\_\_\_/\_\_\_\_

### **INVESTMENT PROPERTY: Current Managing Agent's details**

Company Name: \_\_\_\_\_

Address: \_\_\_\_\_

Best Contact (if known): \_\_\_\_\_

Your Tax Invoice to be sent to: Owner ☐ Agent ☐

Please return this form to [admin@termicide.com.au](mailto:admin@termicide.com.au)

\* Price current as October 2019  
Termicide Pest Control: Phone: 07 5563 3003 – Post: PO Box 949 Paradise Point Qld 4216  
QBCC LIC: 1037693 -PC LIC: POC 012096 - ABN: 18 003 608 018



## TERMITE MANAGEMENT SYSTEM ACKNOWLEDGEMENT FORM

Builders Name: Fortitude Homes ABN:

### NEW DWELLING

At (Site Address) LOT Lot 704 / Street No. 17 Bush Tucker Drive

I

Owner/s/Purchase/s of the above described property acknowledge that the licensed contractor has fully explained to Me/Us and I/We fully understand the termite risk management measures set out below:

- ❖ The Termicide Termite Management System
- ❖ The Termicide Termite Management System Warranty
- ❖ The concrete slab to AS 2870-2011
- ❖ The requirements for an ongoing in section program and maintenance responsibilities  
NB: 75mm Inspection zone.

#### And that:

- ❖ The agreed system of protection for this building work is:
  - ☐ TERMICIDE FRIZBEES – CONCRETE SLAB PENETRATIONS
  - ☐ TERMIGLASS PHYSICAL TERMITE MANAGEMENT SYSTEM
  - ☐ TERMICIDE TERMITE BARRIER – RETICULATION
  - ☐ TERMICIDE TERMITE BARRIER – BIOFILM
  - ☐ TERMICIDE TERMITE BARRIER – BIOFILM COLD JOINTS
  - ☐ TERMICIDE TERMITE BARRIER – TERMSEAL
- ❖ The above systems are deemed to satisfy as per the ABCB NCC 2019 Volumes One and Two Section 5.2 and AS 3660 Termite Management Series.
- ❖ I/We have received the Termicide Information Pack with respect to the above.

Signature/s Owner: \_\_\_\_\_ Date: \_\_\_\_/\_\_\_\_/\_\_\_\_

Signature/s Builder: \_\_\_\_\_ Date: \_\_\_\_/\_\_\_\_/\_\_\_\_

(Please send completed form to Fax: 07 5563 3004 or email: [admin@termicide.com.au](mailto:admin@termicide.com.au))



## **CHEMICAL TERMITE MANAGEMENT SYSTEM WARRANTY**

Australian Standard 3660.1:2014 states in it's foreword:-

***"The Chemical Termite Management System provided relies on a combination of partial measures to termite passage combined with perimeter inspection zones so that when termites attack, evidence of their workings is in the open where it may be detected more readily during regular inspections"***

### **THE CHEMICAL TERMITE MANAGEMENT SYSTEM**

- Termicide Chemical Management Systems are installed by trenching the soil areas around the perimeter of the home to the concrete footing or adjacent to concrete slab edge and approximately 150mm wide. The TermX Replenishment System is installed and encased in a sandy loam and treated with an approved termiticide.
- Termicide Chemical Management Systems must only be inspected by Termicide accredited inspectors.
- Termicide Chemical Management Systems must be replenished as required by Termicide Pest Control.
- Termicide Chemical Management Systems sole purpose is to deter and impede foraging termite activity into a building.

### **NOTES ON SPECIFIC WARRANTIES**

#### **Limitations**

Both the Product and Installer warranties described hereunder will be voided if the system is breached or contaminated by: -

- a) Repairs, alterations, renovations or other activities immediately adjoining the building.
- a) Land movement that affects the foundations of the building.
- b) Complete or partial penetration by tree roots or other vegetation.
- c) Garden mulch or similar being introduced to chemically treated areas.
- d) Any natural occurrence including but not limited to fire, flood or storm, which might violate the integrity of the barrier.
- e) Any works undertaken by third parties impeding the integrity of the Termicide Chemical Termite Management System as installed.
- f) Failure to act on Recommendations given by Termicide Pest Control.
- g) Failure to replenish the chemical component of the system as required by Termicide Pest Control.
- h) Warranty inspections NOT undertaken by a Termicide accredited inspector.
- i) The Owner/s failure to provide true and correct information to Termicide Pest Control, or any instance wherein the Owner participates in misleading, deceptive or fraudulent conduct in connection with this Warranty.

### **WARRANTY COVER**

#### **Chemical Management System**

1. The Termicide Chemical Management System covers complete reinstatement of structural timber members of the building, together with timber skirting boards, timber flooring, timber doors and windows, timber weatherboard cladding and materials removed to gain access to the damaged area.

1. The warranty only covers installations by accredited Termicide installers.

## **INSTALLATION**

The installer warrants to the owner that:-

1. Only approved products have been used in the system.
1. Installation has been carried out by Termicide Pest Control accredited installers.
2. Installation has been carried out in accordance with the Termicide Installation Manual Version 411/2016.
3. The complete installation work is to best industry practice.

If a claim is made under this warranty and termite damage is the result of the installer's workmanship, the products will be made good at the installer's cost.

## **CONDITIONS OF WARRANTY**

1. The Warrantor agrees and acknowledges that the Owner is entitled to all rights and remedies in respect of the products and services which the Owner has under the *Trade Practices Act* and similar State and Territory laws which cannot be lawfully excluded, restricted or modified. This warranty does not purport to and does not have the effect of excluding, restricting or modifying the exercise of any such right or remedy or the liability of the Warrantor in respect of any such right or remedy.
1. The Owner has no other rights or remedies in respect of products or services other than those rights or remedies expressed in this warranty document.
2. All other warranties, guarantees and conditions not referred to in this warranty document are excluded to the fullest extent permitted by law.
3. The Owner of the building must ensure that the warranty inspection is carried out by a licensed and accredited Termicide inspector not exceeding twelve month intervals. Termicide acknowledges the first year of the warranty from the date of installation.
4. The Owner acknowledges that the warranty is conditional upon a Termicide treatment certificate being issued by the installer to the Owner at time of installation.
5. The Owner agrees to inform Termicide immediately when damage or termite activity is discovered. Failure to contact Termicide immediately will result in the warranty becoming void.
6. The Owner agrees to inform future owners of the property of the existence of this warranty and its inclusions and conditions.
7. The Owner under the warranty is limited to any one of the following conditions as determined by the Warrantor at its sole discretion.

## **For Services Provided:-**

1. To supply the service again.
1. Payment to supply the service again.

## **OTHER EXCLUSIONS**

Together with all above occurrences that may void the warranty, the Termicide Chemical Termite Management System warranty does not cover:-

1. Damage to furniture, fittings, carpet and clothing.
1. Termite entry other than demonstrably through the Termicide Chemical Termite Management System.
2. Damage to the Termicide Chemical Termite Management System by third parties.
3. Cost of temporary accommodation.
4. Economic losses such as loss of rent etc.
5. Consequential loss or damage.
6. Failure by third parties to comply with warranty conditions.
7. Allowing rubbish, timber or mulch material to intervene with the termite barrier and visual inspection zone at ground level.

### **SUGGESTIONS FOR THE MAINTENANCE OF YOUR TERMICIDE CHEMICAL TERMITE MANAGEMENT SYSTEM**

1. Remove garden timbers away from home edge
1. Remove any stored timber away from home edge, if possible from property
2. Remove gardens & chip bark away from home edge, if possible from property
3. Repair any broken or leaky down pipes and/or gutters
4. Repair any excessive moisture issues, including drainage
5. Extend any overflows away from home edge, including hot water systems and air conditioner units
6. Cut overgrown grass to allow for visual inspections of the home edge
7. Move stored goods away from home edge
8. Cut back any timber gate posts in contact with the home edge and soil
9. Move any outdoor fixtures to allow for visual inspection of home edge (eg, BBQ, dog kennel, shed, outdoor furniture etc)
10. Ensure attachments to the building such as downpipes and service pipes have a nominal gap (25mm) to allow clear and uninterrupted visual inspection across the visual inspection zone.
11. Do not plant vigorous growing trees or shrubs close to your house.
12. Do not leave building materials or plant waste leaning against the building.

### **HOW TO CLAIM ON YOUR WARRANTY (Failure to adhere to the following points will result in the warranty becoming void)**

1. Contact Termicide directly on (07) 5563 3003, immediately when damage or termite activity is discovered. Failure to contact Termicide immediately will result in the warranty becoming void.
1. Do not remove termite tracks or nests.
2. Do not attempt to spray or make repairs yourself.

### **WARRANTY**

Subject to all qualifications and conditions stated above, Termicide Pest Control warrants to the Owner for the period of 12 years that the product will remain free from subterranean termite penetration that is a result of defective product.

When a valid claim is established under this warranty Termicide will re-establish the damaged area to a condition consistent to the remainder of the property.







Phone: (07) 5563 3003

# TREATMENT CERTIFICATE T165880

This is to certify that the new building work described below has an approved Termite Management System and/or Protective Measure applied as per the requirements of the Australian Standard 3660 Series and the NCC 2019.

Building Address: Lot 704 / Street No. Bush Tucker Drive NARANGBA

Builder/Owner: Fortitude Homes

Systems	Treatment	Area/Length/No.	Legend
Termiglass	Perimeter	l/m	-x- -x-
	Piers	No.	X
Erizbees / BioFilm collars	Penetrations	19	O mm (dia)
Termifilm	Cold joint / Perimeter	l/m	v-v-v-v
BioFilm	Cold joint / Perimeter	l/m	/--/--/--/
Sealants	Joints	l/m	====M=====
TERM-seal	Perimeter	l/m	-o- -o-
Reticulation	Perimeter	61	//////////
TERM-seal	Retaining Wall	m2	~~~~~
Other			

Date: 3/11/22 Installers Name & Signature Part "A" Jacob Williams

Date: 10-2-23 Installers Name & Signature Part "B" IAN SALTER

Durable Notice Supplied ☒ Yes ☐ No Licence Number (if applicable):

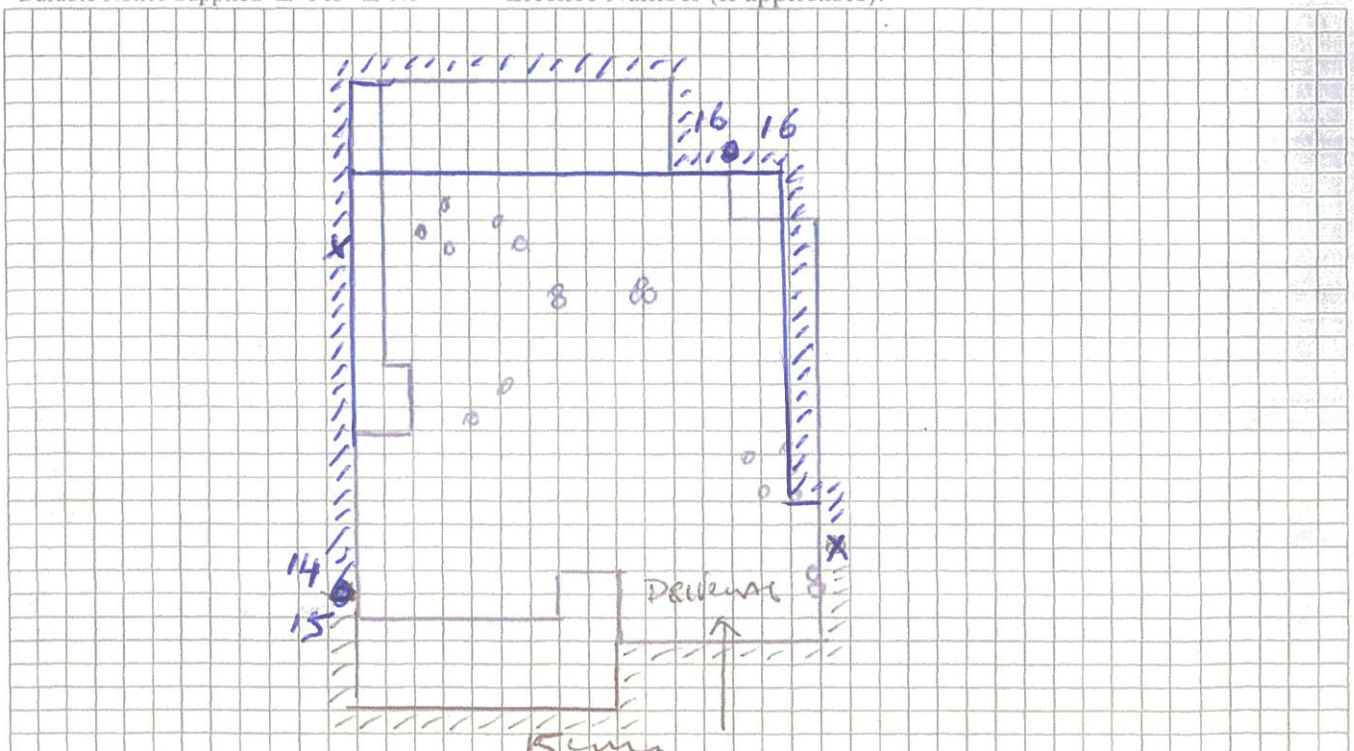

## WARNING

This Termite Protection system needs to be maintained on a regular basis. The Australian Standard for termite protection (AS3660.1) recommends regular, competent INSPECTION of the building for termite activity at least EVERY TWELVE MONTHS. This is needed to ensure that termites have not bridged or breached the system and entered the building. Failure to comply with these requirements will null and void all warranty obligations on behalf of Termicide.