

68 Zabels Road North

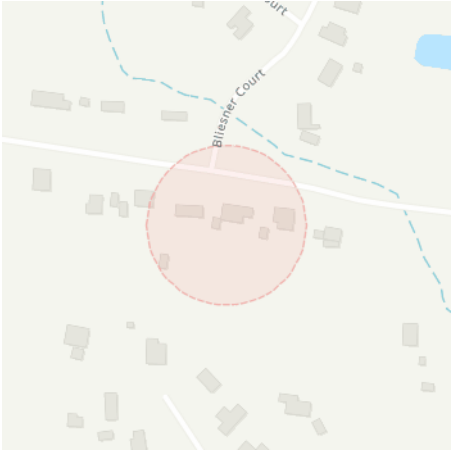

[Review responses online](#) ↗



Received 4 of 4 responses  
**All responses received**  
  
68 Zabels Road North, Minden QLD 4311  
  
Job dates  
10/07/2024 → 10/07/2024  
  
These plans expire on  
31 Jul 2024  
  
Lodged by  
Image Property

Authority	Status	Page
✉ BYDA Confirmation		2
🏠 Energex QLD	Received	4
🏠 NBN Co Qld	Received	19
🏠 Queensland Urban Utilities	Received	30
🏠 Telstra QLD FA	Received	35



Contact Details

Contact	Contact number	Company	Enquirer ID
Image Property	(07) 3263 1811	Image property	3003158
Email		Address	
sales.support@imageproperty.com.au		57 Kirby Road Aspley QLD 4034	

Job Site and Enquiry Details

**WARNING:** The map below only displays the location of the proposed job site and does not display any asset owners' pipe or cables. The area highlighted has been used only to identify the participating asset owners, who will send information to you directly.

Enquiry date	Start date	End date	On behalf of	Job purpose	Locations	Onsite activities
03/07/2024	10/07/2024	10/07/2024	Private	Design	Both Road, Nature Strip, Footpath	Planning & Design

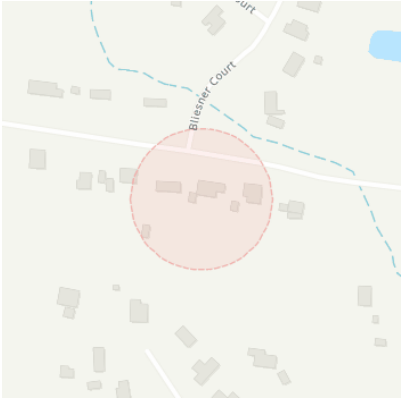

Check that the location of the job site is correct. If not, you must submit a new enquiry.

If the scope of works change or plan validity dates expire, you must submit a new enquiry.

Do NOT dig without plans. Safe excavation is your responsibility. If you don't understand the plans or how to proceed safely, please contact the relevant asset owners.

User Reference	Address	Notes/description
68 Zabels Road North	68 Zabels Road North Minden QLD 4311	-

Your Responsibility and Duty of Care

- Lodging an enquiry does not authorise project commencement.** Before starting work, you must obtain all necessary information from all affected asset owners.
- If you don't receive plans within 2 business days, contact the asset owner & quote their sequence number.
- Always follow the 5Ps of Safe Excavation (page 2), and locate assets before commencing work.
- Ensure you comply with State legislative requirements for Duty of Care and safe digging.
- If you damage an underground asset, you MUST advise the asset owner immediately.
- By using the BYDA service, you agree to the [Privacy Policy](#) and [Term of Use](#).
- For more information on safe digging practices, visit [www.byda.com.au](http://www.byda.com.au)

Asset Owner Details

Below is a list of asset owners with underground infrastructure in and around your job site. It is your responsibility to identify the presence of these assets. Plans issued by Members are indicative only unless specified otherwise. Note: not all asset owners are registered with BYDA. You must contact asset owners not listed here directly.

Referral ID (Seq. no)	Authority Name	Phone	Status
241414115	Energex QLD	13 12 53	NOTIFIED
241414113	NBN Co Qld	1800 687 626	NOTIFIED
241414116	Queensland Urban Utilities	13 26 57	NOTIFIED
241414114	Telstra QLD FA	1800 653 935	NOTIFIED

END OF UTILITIES LIST



### Plan

Plan your job. Use the BYDA service at least one day before your job is due to begin, and ensure you have the correct plans and information required to carry out a safe project.



### Prepare

Prepare by communicating with asset owners if you need assistance. Look for clues onsite. Engage a skilled Locator.



### Pothole

Potholing is physically sighting the asset by hand digging or hydro vacuum extraction.

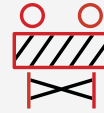

### Protect

Protecting and supporting the exposed infrastructure is the responsibility of the excavator. Always erect safety barriers in areas of risk and enforce exclusion zones.



### Proceed

Only proceed with your excavation work after planning, preparing, potholing (unless prohibited), and having protective measures in place.

## Engage a skilled Locator

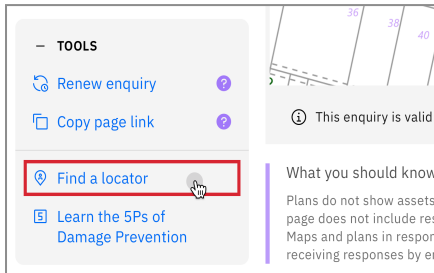

When you lodge an enquiry you will see skilled Locators to contact

Visit the Certified Locator website directly and search for a locator near you

[dbydlocator.com/certified-locating-organisation](https://dbydlocator.com/certified-locating-organisation)

## Book a FREE BYDA Session



BYDA offers two different sessions to suit you and your organisation's needs. The free sessions are offered in two different formats - online and face-to-face:

1. **Awareness Session:** Understand the role of BYDA, safe excavation practices, complying with asset-owner instructions, and the consequences of damages. Learn how to mitigate and avoid potential damage and harm and ensure a safe work environment.
2. **Plan Reading Session:** Develop the skills to interpret asset owners' plans, legends, and symbols effectively. Understand the complexities of plan interpretation to ensure smooth project execution.

To book a session, visit:

[byda.com.au/contact/education-awareness-enquiry-form/](https://byda.com.au/contact/education-awareness-enquiry-form/)

**BOOK NOW**

Referral  
241414115

Member Phone  
13 12 53

Responses from this member

Response received Wed 3 Jul 2024 8.43pm

File name	Page
Response Body	5
BYDA Symbolology Legend.pdf	8
241414115 - Energex Detailed Plan.pdf	9
Energex BYDA Terms and Conditions.pdf	14

# Assets found

## BYDA Request

Please **DO NOT SEND A REPLY** to this email as it has been automatically generated and replies are not monitored.

The attached Plan details ENERGEX infrastructure in relation to your nominated search area

Ensure you read and understand the important notes outlined below

**You:** **BYDA Enquiry No:**

Image Property 241414115

**Company:** **Date of Response:**

Image property 03 Jul 2024

**Search Location:** **Period of Plan  
Validity:**

68 Zabels Road North  
Minden,  
QLD 4311

4 Weeks

**External Comments (if any):**

**WARNING: When working in the vicinity of Energex's assets you have a legal Duty of Care that must be observed.**

**It is important that You note:**

1. Immediately report life threatening emergencies to Emergency Services on **000** or to ENERGEX on on **13 19 62**.
2. Please read and understand all the information and disclaimers provided - including the Terms and Conditions on the attached pages.
3. We have only searched the area which has been nominated in the request. If this nominated area is not what You require, please resubmit another enquiry with BYDA.
4. Plans provided by ENERGEX are only an indication of the presence of underground assets within the nominated area. Locations provided are approximate and the plans are not suitable for scaling purposes, as exact ground cover and alignments cannot be provided. You must confirm the exact location of underground electrical equipment by use of an electronic cable locator followed by careful, non-mechanical excavation (ie, potholing).
5. Plans provided by ENERGEX do not encompass Energex's overhead Network.
6. Energex, its servants or agents shall not be liable for any loss or damage caused or occasioned by the use of plans and details supplied pursuant to the BYDA Request and You agree to indemnify ENERGEX against any claim or demand for any such loss or damage to You, your servants or your agents.

7. You are responsible for any damage to underground electrical equipment caused by works pursuant to or in any way connected with this BYDA Request.
8. In addition to underground cables marked on attached plan, there could be underground earth conductors, underground substation earth conductors, M.E.N conductors, S.W.E.R Substation Earth Conductors, ABS Earth Mats or Consumer Mains in the vicinity or private underground cables (inc. consumers' mains that may run from ENERGEX mains onto private property) in the vicinity of the nominated work area(s) that are not marked on the plans.
9. Independent underground cable locators can be found via the [BYDA Certified Locator website](#)
10. The ENERGEX Before You Dig Australia information map(s) provide the vicinity of underground cable and will not be adequate for conveyancing purposes. A Request for Search (Property Search) can be arranged through ENERGEX.
11. The attached plans are only valid for a period of four weeks from receipt. If excavation does not commence within four weeks, a new plan should be obtained.
12. The Energex BYDA map (named maps.pdf) may contain shaded area(s), indicating the location of planned work(s). This polygon will note the planned work project number in the centre of the shaded area(s). This number will correspond with additional pdf attachments, if they have been included. Should you find a planned works plan not attached that You believe may affect your planned work(s), please contact the Energex BYDA team on the details listed below.
13. ENERGEX may contact You to discuss your proposed excavation in the vicinity of feeders identified on the attached plan(s).
14. Do not access or enter the exclusion zone of any underground electrical assets. For example, conduits, cables, pits, cabinets.
15. Your work will need to comply with the [Working near overhead and underground electric lines - Electrical safety code of practice 2020](#).

**NOTE:** Where your proposed work location contains Energex 33kV or greater Underground cables please access the Energex [Working Near Underground Cables 33kV or Higher web page](#) for more information.



General enquiries (7:00am - 5:30pm Mon to Fri) **13 12 53**

---

Life threatening emergencies only triple zero (000) or **13 19 62**

---

To re-submit or change the nominated search area please visit [smarterwx.BYDA.com.au](http://smarterwx.BYDA.com.au)

**E:** [custserve@energex.com.au](mailto:custserve@energex.com.au) **W:** [energex.com.au/lualmap](http://energex.com.au/lualmap)

**E:** [BYDA@energex.com.au](mailto:BYDA@energex.com.au) ABN: 40 078 849 055



**Disclaimer:** While reasonable measures have been taken to ensure the accuracy of the information contained in this plan response, neither Energex nor PelicanCorp shall have any liability whatsoever in relation to any loss, damage, cost or expense arising from the use of this plan response or the information contained in it or the completeness or accuracy of such information. Use of such information is subject to and constitutes acceptance of these terms.

If you are unable to launch any of the files for viewing and printing, you may need to download and install free viewing and printing software such as [Adobe Acrobat Reader \(for PDF files\)](#)





# BYDA SYMBOLOLOGY LEGEND

	Cross Bonding Link Box - <b>Critical</b>		Planned Cross Bonding Link Box - New/Updated
	Disconnect Box - <b>Critical</b>		Planned Cross Bonding Link Box - Remove
	Ring Main Unit		Planned Disconnect Box - New/Updated
	Distribution Pad Substation		Planned Disconnect Box - Remove
	Earth		Planned Distribution Pad Substation - New/Updated
	Remote Earth		Planned Distribution Pad Substation - Remove
	Cable Marker		Planned Distribution Ground Substation - New/Updated
	Handhole		Planned Distribution Ground Substation - Remove
	Manhole		Planned Ring Main Unit - New/Updated
	Commercial Industrial Pillar		Planned Ring Main Unit - Remove
	Distribution Cabinet		Planned Earth - New/Updated
	Link Pillar		Planned Earth - Remove
	Service Pillar		Planned Cable Marker - New/Updated
	Feeder Pillar		Planned Cable Marker - Remove
	Pole		Planned Remote Earth - New/Updated
	Streetlight Column		Planned Remote Earth - Remove
	Communication Junction Pillar		Planned Underground Warning Post - New/Updated
	Communication Pit		Planned Underground Warning Post - Remove
	Fibre Patch Panel		Planned Pilot Cubicle - New/Updated
	Pilot Cubicle		Planned Pilot Cubicle - Remove
	Underground Asset 33kV and above		Planned Fibre Patch Panel - New/Updated
	Underground Asset below 33kV		Planned Fibre Patch Panel - Remove
	Underground Conduit with or without cable		Planned Commercial Industrial Pillar - New/Updated
	Pit		Planned Commercial Industrial Pillar - Remove
	Communication Boundary		Planned Distribution Cabinet - New/Updated
	Reserve (RE)		Planned Distribution Cabinet - Remove
	Water Resource (WR)		Planned Link Pillar - New/Updated
	Cadastral Parcels		Planned Link Pillar - Remove
	Planned Jointing Pit - New/Updated		Planned Service Pillar - New/Updated
	Planned Jointing Pit - Remove		Planned Service Pillar - Remove
	Planned Communication Boundary - New/Updated		Planned Pole - New/Updated
	Planned Communication Boundary - Remove		Planned Pole - Remove
	Planned Tunnel/Trench/Bore - New/Updated		Planned Manhole - New/Updated
	Planned Tunnel/Trench/Bore - Remove		Planned Manhole - Remove
			Planned Streetlight Column - New/Updated
			Planned Streetlight Column - Remove
			Planned Handhole - New/Updated
			Planned Handhole - Remove
			Planned Communication Junction Pillar - New/Updated
			Planned Communication Junction Pillar - Remove



All underground cables shall be treated as being energised. Where a cable is located that is not represented on the ENERGEX BYDA map, then ENERGEX shall be contacted immediately.

For Emergency Situations  
please call 13 19 62



BYDA

Sequence: 241414115  
Date: 03/07/2024

Scale: 1:1025  
**OVERVIEW**

For a full list of Map  
Symbols, please  
refer to the supplied  
BYDA Symbology  
Legend page

AS5488 Category “D” Plan

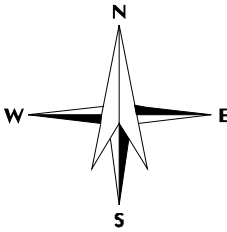

**DISCLAIMER:** While reasonable measures have been taken to ensure the accuracy of the information contained in this plan response, neither Energex nor PelicanCorp shall have any liability whatsoever in relation to any loss, damage, cost or expense arising from the use of this plan response or the information contained in it or the completeness or accuracy of such information. Use of such information is subject to and constitutes acceptance of these terms.

This output provides details of the ENERGEX electrical network. As variations map exist no responsibility is incurred by ENERGEX for the accuracy or completeness of the information provided. Exact positions of cables and electrical connectivity should be confirmed on site.

All underground cables shall be treated as being energised. Where a cable is located that is not represented on the ENERGEX BYDA map, then ENERGEX shall be contacted immediately.

For Emergency Situations  
please call 13 19 62



BYDA

Sequence: 241414115  
Date: 03/07/2024  
Scale: 1:500  
Tile No: 1

For a full list of Map  
Symbols, please  
refer to the supplied  
BYDA Symbology  
Legend page

AS5488 Category “D” Plan

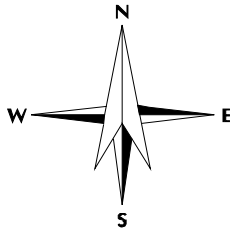

**DISCLAIMER:** While reasonable measures have been taken to ensure the accuracy of the information contained in this plan response, neither Energex nor PelicanCorp shall have any liability whatsoever in relation to any loss, damage, cost or expense arising from the use of this plan response or the information contained in it or the completeness or accuracy of such information. Use of such information is subject to and constitutes acceptance of these terms.

This output provides details of the ENERGEX electrical network. As variations map exist no responsibility is incurred by ENERGEX for the accuracy or completeness of the information provided. Exact positions of cables and electrical connectivity should be confirmed on site.

All underground cables shall be treated as being energised. Where a cable is located that is not represented on the ENERGEX BYDA map, then ENERGEX shall be contacted immediately.

For Emergency Situations  
please call 13 19 62



BYDA

Sequence: 241414115

Date: 03/07/2024

Scale: 1:500

Tile No: 2

For a full list of Map  
Symbols, please  
refer to the supplied  
BYDA Symbology  
Legend page

AS5488 Category “D” Plan

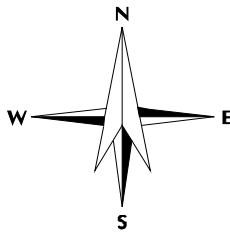

**DISCLAIMER:** While reasonable measures have been taken to ensure the accuracy of the information contained in this plan response, neither Energex nor PelicanCorp shall have any liability whatsoever in relation to any loss, damage, cost or expense arising from the use of this plan response or the information contained in it or the completeness or accuracy of such information. Use of such information is subject to and constitutes acceptance of these terms.

This output provides details of the ENERGEX electrical network. As variations map exist no responsibility is incurred by ENERGEX for the accuracy or completeness of the information provided. Exact positions of cables and electrical connectivity should be confirmed on site.

All underground cables shall be treated as being energised. Where a cable is located that is not represented on the ENERGEX BYDA map, then ENERGEX shall be contacted immediately.

For Emergency Situations  
please call 13 19 62



BYDA

Sequence: 241414115  
Date: 03/07/2024  
Scale: 1:500  
Tile No: 3

For a full list of Map  
Symbols, please  
refer to the supplied  
BYDA Symbology  
Legend page

AS5488 Category “D” Plan

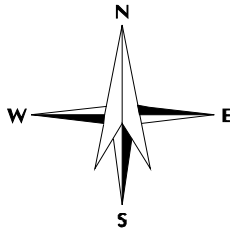

**DISCLAIMER:** While reasonable measures have been taken to ensure the accuracy of the information contained in this plan response, neither Energex nor PelicanCorp shall have any liability whatsoever in relation to any loss, damage, cost or expense arising from the use of this plan response or the information contained in it or the completeness or accuracy of such information. Use of such information is subject to and constitutes acceptance of these terms.

This output provides details of the ENERGEX electrical network. As variations map exist no responsibility is incurred by ENERGEX for the accuracy or completeness of the information provided. Exact positions of cables and electrical connectivity should be confirmed on site.

All underground cables shall be treated as being energised. Where a cable is located that is not represented on the ENERGEX BYDA map, then ENERGEX shall be contacted immediately.

For Emergency Situations  
please call 13 19 62



BYDA

Sequence: 241414115

Date: 03/07/2024

Scale: 1:500

Tile No: 4

For a full list of Map  
Symbols, please  
refer to the supplied  
BYDA Symbolology  
Legend page

AS5488 Category “D” Plan

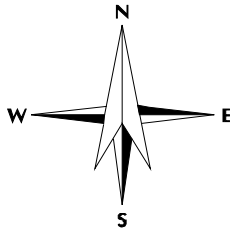

**DISCLAIMER:** While reasonable measures have been taken to ensure the accuracy of the information contained in this plan response, neither Energex nor PelicanCorp shall have any liability whatsoever in relation to any loss, damage, cost or expense arising from the use of this plan response or the information contained in it or the completeness or accuracy of such information. Use of such information is subject to and constitutes acceptance of these terms.

This output provides details of the ENERGEX electrical network. As variations map exist no responsibility is incurred by ENERGEX for the accuracy or completeness of the information provided. Exact positions of cables and electrical connectivity should be confirmed on site.

# BYDA terms and conditions

## Duty of care for everyone



### **Responsibilities – (When Working in the Vicinity of Energex Electrical Equipment)**

Extreme care must be taken during non-mechanical or mechanical excavation as damage to Energex underground electrical equipment can lead to injury or death of workers or members of the public. Electrical equipment includes underground cables, conduits and other associated underground electrical equipment used for controlling, generating, supplying, transforming or transmitting electricity.

A person conducting a business or undertaking (PCBU) must ensure the person's business or undertaking is conducted in a way that is electrically safe. This includes:

- a) ensuring that all electrical equipment used in the conduct of the person's business or undertaking is electrically safe;
- b) if the person's business or undertaking includes the performance of electrical work, ensuring the electrical safety of all persons and property likely to be affected by the electrical work; and
- c) if the person's business or undertaking includes the performance of work, whether or not electrical work, involving contact with, or being near to, exposed parts, ensuring persons performing the work are electrically safe.

In addition, a PCBU at a workplace must ensure, so far as is reasonably practicable, that no person, plant or thing at the workplace comes within an unsafe distance of an underground electric line.

Workers and other persons must also take reasonable care for their own and other person's electrical safety. This includes complying, so far as is reasonably able, with any reasonable instructions given by Energex to ensure compliance with the [Electrical Safety Act 2002](#)



# BYDA terms and conditions

## Duty of care for everyone

The following matters must be considered when working near Energex electrical equipment:

The PCBU must ensure, so far as is reasonably practicable, that no person, plant or thing at the workplace comes within an unsafe distance of an underground electric line (see section 68 of the [Electrical Safety Regulation 2013](#))

1. It is the responsibility of the architect, consulting engineer, developer, and head contractor in the project planning stages to design for minimal impact and protection of Energex electrical equipment.
2. It is the constructor's responsibility to:
  - a) Anticipate and request plans of Energex electrical equipment for a location at a reasonable time before construction begins.
  - b) Visually locate Energex electrical equipment by hand or vacuum excavation where construction activities may damage or interfere with Energex electrical equipment.
  - c) To notify Energex if the information provided is found to be not accurate or assets are found on site that are not recorded on the Energex BYDA plans.
  - d) Read and understand all the information and disclaimers provided.

**Note:** A constructor may include but not limited to a PCBU, Designer, Project Manager, Installer, Contractor or a Civil Contractor

3. Comply with applicable work health and safety and electrical safety codes of practice including but not limited to:
  - a) Working near overhead and underground electric lines – [Electrical safety codes of practice 2020](#)
  - b) Managing electrical risk in the workplace – [Electrical safety code of practice 2013](#)
  - c) Managing the risks of plant in the workplace – [Electrical safety code of practice 2013](#)
  - d) Excavation work – [Electrical safety code of practice 2013](#)

### IMPORTANT NOTES:

- As the alignment and boundaries of roadways with other properties (and roads within roadways) frequently change, the alignments and boundaries contained within Energex plans and maps will frequently differ from present alignments and boundaries "on the ground". Accordingly, in every case where it appears that alignments and boundaries have shifted, or new roadways have been added, the constructor should obtain confirmation of the actual position of Energex cables and pipelines under the roadways. In no case should the constructor rely on statements of third parties in relation to the position of Energex cables and pipelines. It is the applicant's responsibility to accurately locate all services as part of the design and/or prior to excavation.
- Energex does not provide information on private underground installations, including consumers' mains that may run from Energex mains onto private property. Assets located on private property are the responsibility of the owner for identification and location.
- Energex plans are circuit diagrams or pipe indication diagrams only and indicate the presence of plant in the general vicinity of the geographical area shown. Exact ground cover and alignments cannot be given with any certainty; as such levels can change over time.
- All underground conduits are presumed to contain asbestos. Refer to "Code of Practice for the Management and Control of Asbestos in Workplaces [NOHSC: 2018 (2005)] - [https://www.safeworkaustralia.gov.au/system/files/documents/1702/codeofpracticeformanagementcontrolofasbestosintheworkplace\\_nohsc2018-2005](https://www.safeworkaustralia.gov.au/system/files/documents/1702/codeofpracticeformanagementcontrolofasbestosintheworkplace_nohsc2018-2005)
- Plans provided by Energex do not show the presence of any Overhead Network
- In addition to underground cables marked on attached plan there may be underground Earth Conductors in the vicinity of the nominated work area(s) that are not marked on the plans.
- There may also be other buried assets such as tanks for fluid filled cables that do not appear on GIS plots but are shown on detailed as constructed drawings.
- Being aware of your obligations in [s 304] Excavation work— underground essential services information under the [Work Health and Safety Regulation 2011](#), Chapter 6 Construction work, Part 6.3 Duties of person conducting business or undertaking. This includes but is not limited to taking reasonable steps to obtain the current information & providing this information to persons engaged to carry out the excavation work. For further information please refer to: - <http://www.legislation.qld.gov.au/LEGISLTN/SLs/2011/11SL240.pdf>
- Energex plans are designed to be printed in colour and as an A4 Landscape orientation

# BYDA terms and conditions

## Duty of care for everyone

### Conditions – (When Working in the Vicinity of Energex Electrical Equipment)

#### **Records:**

The first step before any excavation commences is to obtain records of Energex plant in the vicinity of the work. For new work, records should be obtained during the planning and design stage. The records provided by Energex must be made available to all construction groups on site. Where plant information is transferred to plans for the proposed work, care must be exercised to ensure that important detail is not lost in the process.

**Plans and or details provided by Energex are current for four weeks from the date of dispatch** and should be disposed of by shredding or any other secure disposal method after use. A new BYDA enquiry must be made for proposed works/activities to be undertaken outside of the four-week period.

Energex retains copyright of all plans and details provided in connection with your request. Energex plans or other details are provided for the use of the applicant, its servants, or agents, and shall not be used for any unauthorised purpose. On receipt of BYDA plans and before commencing excavation work or similar activities near Energex's plant, check to see that it relates to the area you have requested and carefully locate this plant first to avoid damage. If you are unclear about any information contained in the plan, please contact Energex on the General Enquiries number listed above for further advice.

Energex, its servants or agents shall not be liable for any loss or damage caused or occasioned by the use of plans and or details so supplied to the applicant, its servants and agents, and the applicant agrees to indemnify Energex against any claim or demand for any such loss or damage.

The constructor is responsible for all plant damages when works commence prior to obtaining Energex plans, or failure to follow agreed instructions, or failure to demonstrate all reasonable measures were taken to prevent the damage once plans were received from Energex. Energex reserves all rights to recover compensation for loss or damage caused by interference or damage, including consequential loss and damages to its cable network, or other property.

**NOTE:** Where your proposed work location contains Energex 33kV or greater Underground cables please access the [Energex Working Near Underground Cables 33kV or Higher web page](#) for more information.

#### **Location of Cables:**

Examining the records is not sufficient, as reference points may change from the time of installation. Records must also be physically proven when working in close proximity to them. The exact location of plant likely to be affected shall be confirmed by use of an electronic cable and pipe locator followed by **careful hand or vacuum excavation to the level of cable protection cover strips or conduits**. When conducting locations, please be aware that **no** unauthorised access is permitted to Energex Assets– including Pits, Low Voltage Disconnection Boxes, Low Voltage Pillars or High Voltage Link Boxes.

**Hand or vacuum excavation must be used in advance of excavators.** In any case, where any doubt exists with respect to interpretation of cable records, contact Energex on the General Enquires number listed above for further advice.

If the constructor is unable to locate Energex underground assets within 5 metres of nominal plan locations, they should contact the Energex General Enquires number listed above for further advice.

If unknown cables or conduits (i.e. not shown on issued BYDA plans) are located during excavation:

1. Call the ELECTRICITY EMERGENCIES number listed above
2. Treat cables as if alive, post a person to keep all others clear of the excavation until Energex crew attend to make safe.
3. All work in the vicinity of damaged plant should cease and the area should be vacated until a clearance to continue work has been obtained from an Energex officer.

#### **Electrical Cable Installation Methods:**

Energex cables are installed with a variety of protection devices including:

- |   |                                       |
|---|---------------------------------------|
| 1. Clay paving bricks or tiles marked "Electricity" or similar (also unmarked)                    | 2. Concrete or PVC cover slabs        |
| 3. PVC, A/C or fibro conduit, fibre reinforced concrete, iron or steel pipe                       | 4. Concrete encased PVC or steel pipe |
| 5. Thin plastic marker tape   | 6. Large pipes housing multiple ducts |
| 7. Multiple duct systems, including earthenware or concrete 2-, 4-, and 6-way ducts and shamrocks |                                       |

*Note: Some cables are known to be buried without covers and cables may change depth or alignment along the route.*

#### **Excavating Near Cables:**

For all work within 2.5 m of nominal location, the constructor is required to hand or vacuum excavate (pothole) and expose the plant, hence proving its exact location before work can commence.

Cable protection cover strips shall not be disturbed. Excavation below these cover strips, or into the surrounding backfill material is not permitted.



# BYDA terms and conditions

## Duty of care for everyone

### Excavating Parallel to Cables:

If construction work is parallel to Energex cables, then hand or vacuum excavation (potholing) at least every 4 m is required to establish the location of all cables, hence confirming nominal locations before work can commence. *Generally, there is no restriction to excavations parallel to Energex cables to a depth not exceeding that of the cable. **Note: Cable depths & alignment may change suddenly.***

### Separation from Cables:

*Any service(s) must be located at the minimum separation as per the tables below:*

**Table 1. Minimum Separation Requirements for Underground Services Running Parallel with Energex Assets**

(Minimum Separation required in mm)							
Voltage Level	Gas	Communication or TV	Water		Sanitary drainage		Storm Water
			≤DN 200	>DN200	≤DN 200	>DN 200	
LV	250	100	500	*1000	500	1000	500
HV		300					
*Contact Energex/council to obtain specific separation distances							

**Table 2. Minimum Separation Requirements for Underground Services Crossing Energex Assets**

(Minimum Separation required in mm)					
Voltage Level	Gas	Communication or TV	Water	Sanitary drainage	Storm Water
LV & HV	100	100	300	300	100

Where the above table does not list a separation requirement for a particular underground service then 300mm shall be used.

### Excavating Across Cables:

The standard clearance between services shall be maintained as set down in Table 2 above. If the width or depth of the excavation is such that the cables will be exposed or unsupported, then Energex shall be contacted to determine whether the cables should be taken out of service, or whether they need to be protected or supported. In no case shall a cable cover be removed without approval. A cable cover may only be removed under the supervision of an Energex authorised representative. Protective cover strips when removed must be replaced under Energex supervision. Under no circumstances shall they be omitted to allow separation between Energex cables and other services.

### Heavy Machinery Operation Over Cables:

Where heavy "Crawler" or "Vibration" type machinery is operated over the top of cables, a minimum cover of 450 mm to the cable protective cover mains must be maintained using load bearing protection whilst the machinery is in operation. For sensitive cables (i.e. 33 and 110kV fluid and gas filled cables), there may be additional constraints placed on vibration and settlement by Energex.

### Directional Boring Near Cables:

When boring parallel to cables, it is essential that trial holes are carefully hand or vacuum excavated at regular intervals to prove the actual location of the conduits/cables before using boring machinery. Where it is required to bore across the line of cables, the actual location of the cables shall first be proven by hand or vacuum excavation. A trench shall be excavated one metre from the side of the cables where the auger will approach to ensure a minimum clearance of 500mm above and below all LV, 11kV, 33kV & 110/132kV cables shall be maintained.

### Explosives:

*Explosives must not be used within 10 metres of cables*, unless an engineering report is provided indicating that no damage will be sustained. Clearances should be obtained from Energex's Planning Engineer for use of explosives in the vicinity of Energex cables.

### Damage Reporting:

All damage to cables, conduits and pipes must be reported no matter how insignificant the damage appears to be. Even very minor damage to cable protective coverings can lead to eventual failure of cables through corrosion of metal sheaths and moisture ingress.

If any Damaged conductor is found:

1. Call the ELECTRICITY EMERGENCIES number listed above
2. Treat cables as if alive, post a person to keep all others clear of the excavation until Energex crew attend to make safe.
3. All work in the vicinity of damaged plant should cease and the area should be vacated until a clearance to continue work has been obtained from an Energex officer.

# BYDA terms and conditions

## Duty of care for everyone

### Plant Solutions and Assistance:

If plant location plans or visual location of Energex plant by hand or vacuum excavation reveals that the location of Energex plant is situated wholly or partly where the developer or constructor plans to work, then Energex shall be contacted to assist with your development of possible engineering solutions.

If Energex relocation or protection works are part of the agreed solution, then payment to Energex for the cost of this work shall be the responsibility of the principal developer or constructor. Energex will provide an estimated quotation for work on receipt of the developer's or constructor's order number before work proceeds.

It will be necessary for the developer or constructor to provide Energex with a written Work Method Statement for all works in the vicinity of or involving Energex plant. This Work Method Statement should form part of the tendering documentation and work instruction.

### Vacuum Excavations (Hydro Vac)

When operating hydro vac equipment to excavate in vicinity of underground electrical assets (cables/conduits):

Fitted with:

- Nonconductive (neoprene rubber or equivalent) vacuum (suction) hose.
- Oscillating nozzle on pressure wand with water pressure adjusted to not exceeding 2000 psi.

Maintain a minimum distance of 200mm between end of pressure wand and underground electrical assets. DO NOT insert the pressure wand jet directly into subsoil.

Ensure pressure wand is not directly aimed at underground electrical assets (cables/conduits).

### Safety Notices (Underground Work)

There is no exclusion zone applicable for underground electrical assets – conduits, cables (unless cable is damaged, or conductors or terminations have been exposed) therefore there is **no requirement for a written Safety Advice** to be obtained provided the work location does not contain overhead electric lines or other exposed live parts.

### Further information on Working Safely around Energex assets:

[https://www.energex.com.au/\\_data/assets/pdf\\_file/0010/211231/Working-near-OH-UG-lines-BS001405R107ver2.pdf](https://www.energex.com.au/_data/assets/pdf_file/0010/211231/Working-near-OH-UG-lines-BS001405R107ver2.pdf)

*Thank you for your interest in maintaining a safe and secure Electricity Distribution network. Energex welcomes your feedback on this document via email to [dbyd@energex.com.au](mailto:dbyd@energex.com.au).*

General enquiries (7am - 5pm Mon to Fri)

13 12 53

Life threatening emergencies only triple zero (000) or

13 19 62

E: [custserve@energex.com.au](mailto:custserve@energex.com.au)

W: [energex.com.au/lualmap](http://energex.com.au/lualmap)

E: [dbyd@energex.com.au](mailto:dbyd@energex.com.au)

ABN: 40 078 849 055

To re-submit or change the nominated search area please visit [www.BYDA.com.au](http://www.BYDA.com.au)



Referral  
241414113

Member Phone  
1800 687 626

Responses from this member

Response received Thu 4 Jul 2024 2.52pm

File name	Page
Response Body	20
241414113_20240704_045211836135_1.pdf	21
Disclaimer_241414113_20240704_045211836135.pdf	24
4678_NBN_Dial_Before_You_Dig_Poster_20170517.pdf	28

Hi Image Property,

Please find attached the response to your DBYD referral for the address mentioned in the subject line. The location shown in our DBYD response is assumed based off the information you have provided. If the location shown is different to the location of the excavation then this response will consequently be rendered invalid.

Take the time to read the response carefully and note that this information is only valid for 28 days after the date of issue.

If you have any further enquiries, please do not hesitate to contact us.

Regards,  
Network Services and Operations  
NBN Co Limited  
P: 1800626329  
E: [dbyd@nbnco.com.au](mailto:dbyd@nbnco.com.au)  
[www.nbnco.com.au](http://www.nbnco.com.au)

**Confidentiality and Privilege Notice**

This e-mail is intended only to be read or used by the addressee. It is confidential and may contain legally privileged information. If you are not the addressee indicated in this message (or responsible for delivery of the message to such person), you may not copy or deliver this message to anyone, and you should destroy this message and kindly notify the sender by reply e-mail. Confidentiality and legal privilege are not waived or lost by reason of mistaken delivery to you. Any views expressed in this message are those of the individual sender, except where the sender specifically states them to be the views of NBN Co Limited

Please Do Not Reply To This Mail

**To:** Image Property  
**Phone:** Not Supplied  
**Fax:** Not Supplied  
**Email:** sales.support@imageproperty.com.au

<b>Dial before you dig Job #:</b>	37048183	 <b>BEFORE YOU DIG</b> <small>www.byda.com.au</small> <b>Zero Damage - Zero Harm</b>
<b>Sequence #</b>	241414113	
<b>Issue Date:</b>	04/07/2024	
<b>Location:</b>	68 Zabels Road North , Minden , QLD , 4311	

Indicative Plans are tiled below to demonstrate how to layout and read nbn asset plans

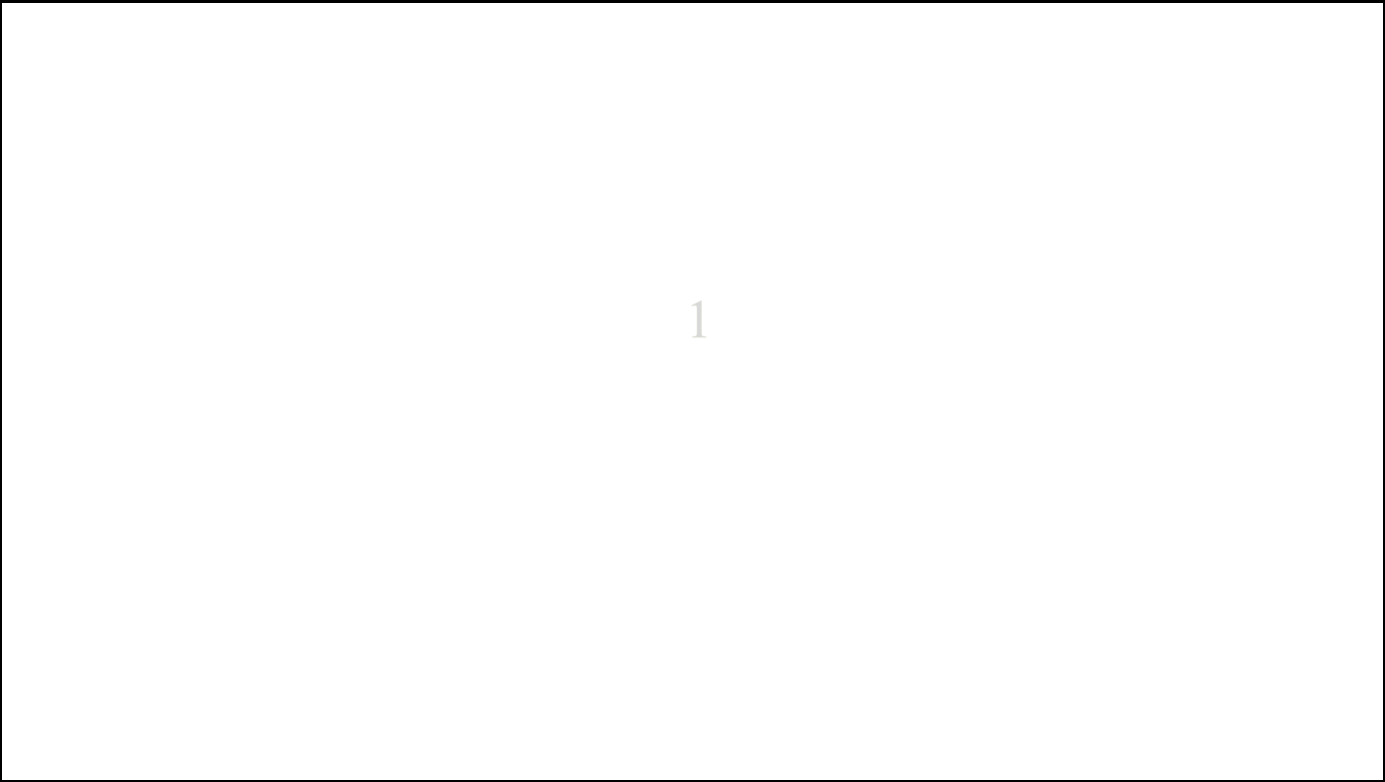



## LEGEND



	Parcel and the location
	Pit with size "5"
	Power Pit with size "2E". Valid PIT Size: e.g. 2E, 5E, 6E, 8E, 9E, E, null.
	Manhole
	Pillar
	Cable count of trench is 2. One "Other size" PVC conduit (PO) owned by Telstra (-T-), between pits of sizes, "5" and "9" are 25.0m apart. One 40mm PVC conduit (P40) owned by NBN, between pits of sizes, "5" and "9" are 20.0m apart.
	2 Direct buried cables between pits of sizes, "5" and "9" are 10.0m apart.
	Trench containing any <b>INSERVICE/CONSTRUCTED</b> (Copper/RF/Fibre) cables.
	Trench containing only <b>DESIGNED/PLANNED</b> (Copper/RF/Fibre/Power) cables.
	Trench containing any <b>INSERVICE/CONSTRUCTED</b> (Power) cables.
	Road and the street name "Broadway ST"
Scale	0 20 40 60 Meters 1:2000  1 cm equals 20 m

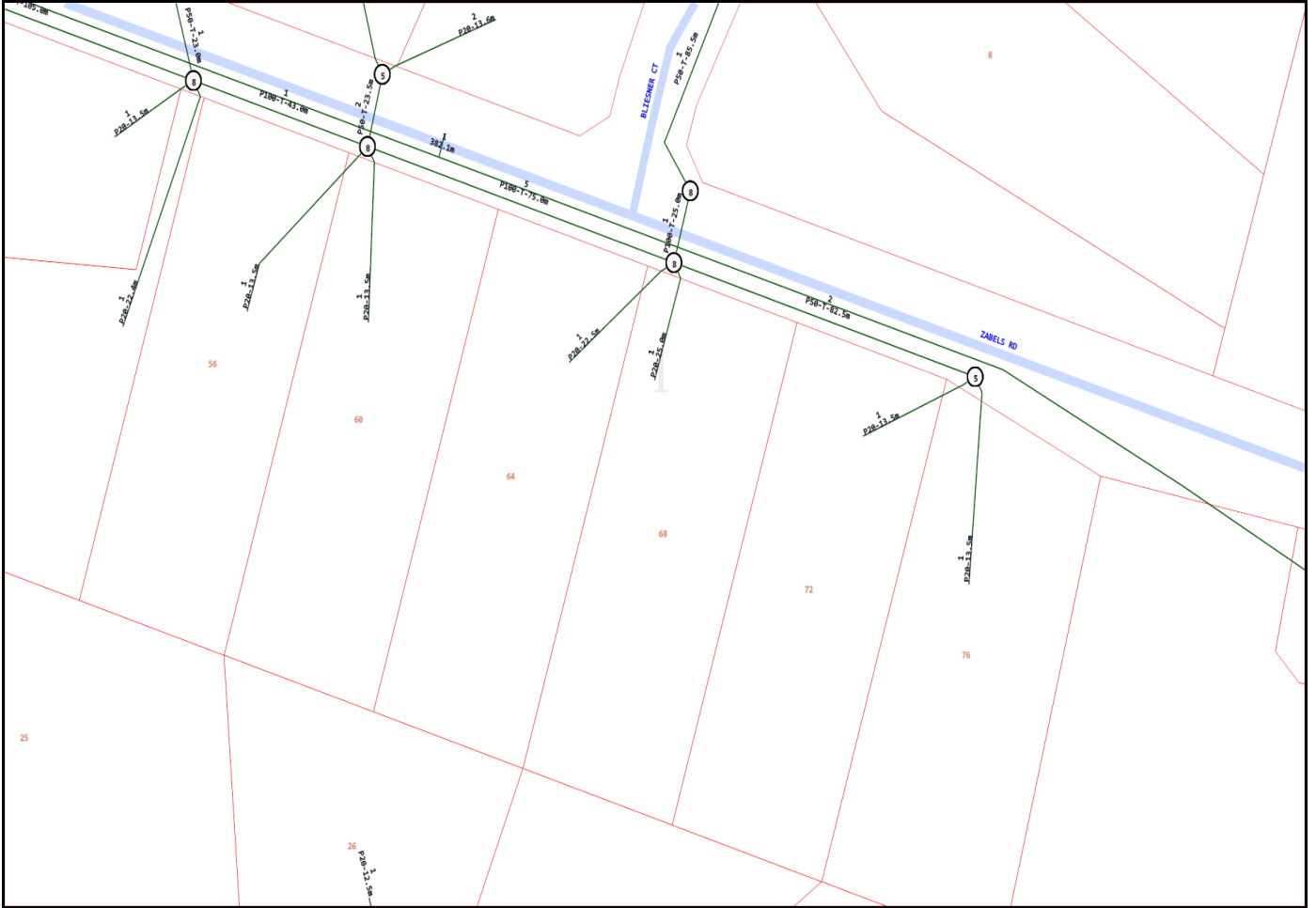

## Emergency Contacts

You must immediately report any damage to the **nbn™** network that you are/become aware of. Notification may be by telephone - 1800 626 329.

**To:** Image Property  
**Phone:** Not Supplied  
**Fax:** Not Supplied  
**Email:** sales.support@imageproperty.com.au

<b>Dial before you dig Job #:</b>	37048183	
<b>Sequence #</b>	241414113	
<b>Issue Date:</b>	04/07/2024	
<b>Location:</b>	68 Zabels Road North , Minden , QLD , 4311	

## Information

The area of interest requested by you contains one or more assets.

<b>nbn™ Assets</b>	<b>Search Results</b>
<b>Communications</b>	Asset identified
<b>Electricity</b>	No assets

In this notice **nbn™ Facilities** means *underground fibre optic, telecommunications and/or power facilities, including but not limited to cables, owned and controlled by nbn™*

## Location of nbn™ Underground Assets



We thank you for your enquiry. In relation to your enquiry at the above address:

- **nbn's** records indicate that there **ARE nbn™** Facilities in the vicinity of the location identified above ("Location").
- **nbn** indicative plan/s are attached with this notice ("Indicative Plans").
- The Indicative Plan/s show general depth and alignment information only and are not an exact, scale or accurate depiction of the location, depth and alignment of **nbn™** Facilities shown on the Plan/s.
- In particular, the fact that the Indicative Plans show that a facility is installed in a straight line, or at uniform depth along its length cannot be relied upon as evidence that the facility is, in fact, installed in a straight line or at uniform depth.
- You should read the Indicative Plans in conjunction with this notice and in particular, the notes below.
- You should note that, at the present time, the Indicative Plans are likely to be more accurate in showing location of fibre optics and telecommunications cables than power cables. There may be a variation between the line depicted on the Indicative Plans and the location of any power cables. As such, consistent with the notes below, particular care must be taken by you to make your own enquiries and investigations to precisely locate any power cables and manage the risk arising from such cables accordingly.
- The information contained in the Indicative Plan/s is valid for 28 days from the date of issue set out above. You are expected to make your own inquiries and perform your own investigations (including engaging appropriately qualified plant locators, e.g DBYD Certified Locators, at your cost to locate **nbn™** Facilities during any activities you carry out on site).

We thank you for your enquiry and appreciate your continued use of the Dial Before You Dig Service. For any enquiries related to moving assets or Planning and Design activities, please visit the **nbn Commercial Works** website to complete the online application form. If you are planning to excavate and require further information, please email [dbyd@nbnco.com.au](mailto:dbyd@nbnco.com.au) or call 1800 626 329.

#### Notes:

1. You are now aware that there are **nbn™** Facilities in the vicinity of the above property that could be damaged as a result activities carried out (or proposed to be carried out) by you in the vicinity of the Location.
2. You should have regard to section 474.6 and 474.7 of the *Criminal Code Act 1995* (CoA) which deals with the consequences of interfering or tampering with a telecommunications facility. Only persons authorised by **nbn** can interact with **nbn's** network facilities.
3. Any information provided is valid only for **28 days** from the date of issue set out above.

## Referral Conditions

The following are conditions on which **nbn** provides you with the Indicative Plans. By accepting the plans, you are agreeing to these conditions. These conditions are in addition, and not in replacement of, any duties and obligations you have under applicable law.

1. **nbn** does not accept any responsibility for any inaccuracies of its plans including the Indicative Plans. You are expected to make your own inquiries and perform your own investigations (including engaging appropriately qualified plant locators, e.g DBYD Certified Locators, at your cost to locate **nbn™** Facilities during any activities you carry out on site).
2. You acknowledge that **nbn** has specifically notified you above that the Indicative Plans are likely to be more accurate in showing location of fibre optics and telecommunications cables than power cables. There may be a variation between the line depicted on the Indicative Plans and the location of any power cables.
3. You should not assume that **nbn™** Facilities follow straight lines or are installed at uniform depths

along their lengths, even if they are indicated on plans provided to you. Careful onsite investigations are essential to locate the exact position of cables.

4. In carrying out any works in the vicinity of **nbn**™ Facilities, you must maintain the following minimum clearances:
  - 300mm when laying assets inline, horizontally or vertically.
  - 500mm when operating vibrating equipment, for example: jackhammers or vibrating plates.
  - 1000mm when operating mechanical excavators.
  - Adherence to clearances as directed by other asset owner's instructions and take into account any uncertainty for power cables.
5. You are aware that there are inherent risks and dangers associated with carrying out work in the vicinity of underground facilities (such as **nbn**™ fibre optic, copper and coaxial cables, and power cable feed to **nbn**™ assets). Damage to underground electric cables may result in:
  - Injury from electric shock or severe burns, with the possibility of death.
  - Interruption of the electricity supply to wide areas of the city.
  - Damage to your excavating plant.
  - Responsibility for the cost of repairs.
6. You must take all reasonable precautions to avoid damaging **nbn**™ Facilities. These precautions may include but not limited to the following:
  - All excavation sites should be examined for underground cables by careful hand excavation. Cable cover slabs if present must not be disturbed. Hand excavation needs to be undertaken with extreme care to minimise the likelihood of damage to the cable, for example: the blades of hand equipment should be aligned parallel to the line of the cable rather than digging across the cable.
  - If any undisclosed underground cables are located, notify **nbn** immediately.
  - All personnel must be properly briefed, particularly those associated with the use of earth-moving equipment, trenching, boring and pneumatic equipment.
  - The safety of the public and other workers must be ensured.
  - All excavations must be undertaken in accordance with all relevant legislation and regulations.
7. You will be responsible for all damage to **nbn**™ Facilities that are connected whether directly, or indirectly with work you carry out (or work that is carried out for you or on your behalf) at the Location. This will include, without limitation, all losses expenses incurred by **nbn** as a result of any such damage.
8. You must immediately report any damage to the **nbn**™ network that you are/become aware of. Notification may be by telephone - 1800 626 329.
9. Except to the extent that liability may not be capable of lawful exclusion, **nbn** and its servants and agents and the related bodies corporate of **nbn** and their servants and agents shall be under no liability whatsoever to any person for any loss or damage (including indirect or consequential loss or damage) however caused (including, without limitation, breach of contract negligence and/or breach of statute) which may be suffered or incurred from or in connection with this information sheet or any plans (including Indicative Plans) attached hereto. Except as expressly provided to the contrary in this information sheet or the attached plans (including Indicative Plans), all terms, conditions, warranties, undertakings or representations (whether expressed or implied) are excluded to the fullest extent permitted by law.

All works undertaken shall be in accordance with all relevant legislations, acts and regulations applicable to the particular state or territory of the Location. The following table lists all relevant documents that shall be considered and adhered to.

State/Territory	Documents
National	Work Health and Safety Act 2011
	Work Health and Safety Regulations 2011
	Safe Work Australia - Working in the Vicinity of Overhead and Underground Electric Lines (Draft)

	Occupational Health and Safety Act 1991
<b>NSW</b>	Electricity Supply Act 1995
	Work Cover NSW - Work Near Underground Assets Guide
	Work Cover NSW - Excavation Work: Code of Practice
<b>VIC</b>	Electricity Safety Act 1998
	Electricity Safety (Network Asset) Regulations 1999
<b>QLD</b>	Electrical Safety Act 2002
	Code of Practice for Working Near Exposed Live Parts
<b>SA</b>	Electricity Act 1996
<b>TAS</b>	Tasmanian Electricity Supply Industry Act 1995
<b>WA</b>	Electricity Act 1945
	Electricity Regulations 1947
<b>NT</b>	Electricity Reform Act 2005
	Electricity Reform (Safety and Technical) Regulations 2005
<b>ACT</b>	Electricity Act 1971

Thank You,

**nbn DBYD**

Date: 04/07/2024

This document is provided for information purposes only. This document is subject to the information classification set out on this page. If no information classification has been included, this document must be treated as UNCLASSIFIED, SENSITIVE and must not be disclosed other than with the consent of nbn co. The recipient (including third parties) must make and rely on their own inquiries as to the currency, accuracy and completeness of the information contained herein and must not use this document other than with the consent of nbn co.

Copyright © 2021 nbn co Limited. All rights reserved.



# Working near **nbn**<sup>TM</sup> cables

**nbn** has partnered with Dial Before You Dig to give you a single point of contact to get information about **nbn** underground services owned by **nbn** and other utility/service providers in your area including communications, electricity, gas and other services. Contact with underground power cables and gas services can result in serious injury to the worker, and damage and costly repairs. You must familiarise yourself with all of the Referral Conditions (meaning the referral conditions referred to in the DBYD Notice provided by **nbn**).

## Practice safe work habits

Once the DBYD plans are reviewed, the Five P's of Excavation should be adopted in conjunction with your safe work practices (which must be compliant with the relevant state Electrical Safety Act and Safe Work Australia "Excavation Work Code of Practice", as a minimum) to ensure the risk of any contact with underground **nbn** assets are minimised.



**Plan:** Plan your job by ensuring the plans received are current and apply to the work to be performed. Also check for any visual cues that may indicate the presence of services not covered in the DBYD plans.



**Prepare:** Prepare for your job by engaging a DBYD Certified Plant Locator to help interpret plans and identify on-site assets. Contact **nbn** should you require further assistance.

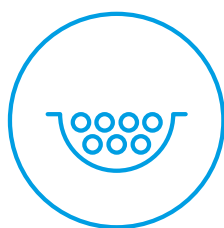

**Pothole:** Non-destructive potholing (i.e. hand digging or hydro excavation) should be used to positively locate **nbn** underground assets with minimal risk of contact and service damage.

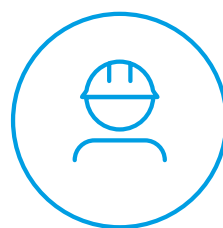

**Protect:** Protecting and supporting the exposed **nbn** underground asset is the responsibility of the worker. Exclusion zones for **nbn** assets are clearly stated in the plan and appropriate controls must be implemented to ensure that encroachment into the exclusion zone by machinery or activities with the potential to damage the asset is prevented.

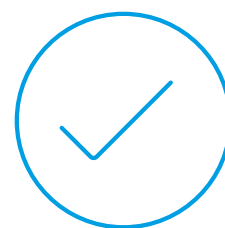

**Proceed:** Proceed only when the appropriate planning, preparation, potholing and protective measures are in place.



# Working near **nbn**<sup>TM</sup> cables



Identify all electrical hazards, assess the risks and establish control measures.



When using excavators and other machinery, also check the location of overhead power lines.



Workers and equipment must maintain safety exclusion zones around power lines.

Once all work is completed, the excavation should be re-instated with the same type of excavated material unless specified by **nbn**. Please note:

- Construction Partners of **nbn** may require additional controls to be in place when performing excavation activities.
- The information contained within this pamphlet must be used in conjunction with other material supplied as part of this request for information to adequately control the risk of potential asset damage.

## Contact

All **nbn**<sup>TM</sup> network facility damages must be reported online [here](#).  
For enquiries related to your DBYD request please call 1800 626 329.

### Disclaimer

This brochure is a guide only. It does not address all the matters you need to consider when working near our cables. You must familiarise yourself with other material provided (including the Referral Conditions) and make your own inquiries as appropriate.

**nbn** will not be liable or responsible for any loss, damage or costs incurred as a result of reliance on this brochure.

This document is provided for information purposes only. This document is subject to the information classification set out on this page. If no information classification has been included, this document must be treated as UNCLASSIFIED, SENSITIVE and must not be disclosed other than with the consent of nbn co. The recipient (including third parties) must make and rely on their own inquiries as to the currency, accuracy and completeness of the information contained herein and must not use this document other than with the consent of nbn co. Copyright © 2021 nbn co limited. All rights reserved.



Referral  
241414116

Member Phone  
13 26 57

Responses from this member

Response received Wed 3 Jul 2024 4.53pm

File name	Page
Response Body	31
241414116 - Urban Utilities Plan.pdf	33
Urban Utilities Important Information.pdf	34



GPO Box 2765  
Brisbane QLD 4001

Date: 03 Jul 2024

## Before You Dig Australia Response

---

**Please DO NOT SEND A REPLY to this email as it has been automatically generated and replies are not monitored.**

Dear Image Property

We appreciate your diligence in contacting the Before You Dig Australia service (**BYDA**) prior to engaging in work or activities which may affect the water and sewerage infrastructure of Urban Utilities.

<b>Job Number:</b>	37048183
<b>Sequence Number:</b>	241414116
<b>Enquiry Date:</b>	3/07/2024 4:50:00 PM
<b>Enquiry Location:</b>	68 Zabels Road North Minden QLD 4311

**WARNING: When working in the vicinity of Urban Utilities' assets you have a legal *Duty of Care* that must be observed.**

**Our records indicate the presence of infrastructure owned by Urban Utilities within your nominated search area, as shown on the attached plan.**

Please note that you may be liable for any loss or damage to our infrastructure which is caused by any works or activities which you undertake over or near such infrastructure. Additionally, your works or activities may conflict with other works scheduled in your nominated search area. To avoid any unnecessary impacts, before any undertaking you must obtain the following approvals:

- And/or a Urban Utilities Network Access Permit for self assessable works or activities that are within two metres of our infrastructure (refer to [Urban Utilities Network Access Permit Webpage](#))
- Either a Build Over Asset (BOA) Approval for assessable building works undertaken within specified distances of our infrastructure (refer to [DHPW BOA Factsheet](#))

We have provided additional information about your responsibilities in relation to our infrastructure in the Important Information sheet attached to this letter. By accessing BYDA to obtain our records about our infrastructure, you warrant that you have read the sheet and agree to the terms and conditions set out therein.

For further enquiries or assistance with interpretation of plans and search content please contact our BYDA Support Team by email [networkaccess@urbanutilities.com.au](mailto:networkaccess@urbanutilities.com.au). Alternatively, you can write to us at Urban Utilities, PO Box 2765, Brisbane QLD 4001.

Thank you for taking the time to consult the BYDA service.

Yours sincerely

Before You Dig Australia Support Team  
**Urban Utilities**  
[networkaccess@urbanutilities.com.au](mailto:networkaccess@urbanutilities.com.au)

---

To best manage the risk of damage and liability, we recommend that you engage the services of a [BYDA Certified Locator](#)

---

### Important Notice

This enquiry response, including any associated documentation, has been assessed and compiled from the information detailed within the BYDA enquiry outlined above. **Please ensure that the BYDA enquiry details and this response accurately reflect your proposed works.**

This response is intended for use only by the addressee. If you have received the enquiry response in error, please let us know by telephone and delete all copies; you are advised that copying, distributing, disclosing or otherwise acting in reliance on the response is expressly prohibited.

---

**Disclaimer:** While reasonable measures have been taken to ensure the accuracy of the information contained in this plan response, neither Urban Utilities nor PelicanCorp shall have any liability whatsoever in relation to any loss, damage, cost or expense arising from the use of this plan response or the information contained in it or the completeness or accuracy of such information. Use of such information is subject to and constitutes acceptance of these terms.

If you are unable to launch any of the files for viewing and printing, you may need to download and install free viewing and printing software such as [Adobe Acrobat Reader \(for PDF files\)](#).



# Urban Utilities - Water, Recycled Water and Sewer Infrastructure



## Before You Dig Australia - Urban Utilities Water, Recycled Water and Sewer Infrastructure

BYDA Reference No: **241414116**

Date BYDA Ref Received: 03/07/2024

Date BYDA Job to Commence: 10/07/2024

Date BYDA Map Produced: 03/07/2024

This Map is valid for 30 days

Produced By: Urban Utilities

### Sewer

- Infrastructure
- ◆ Major Infrastructure
- Network Pipelines
- ▨ Network Structures

### Water

- Infrastructure
- ◆ Major Infrastructure
- Network Pipelines
- ▨ Network Structures
- - - Water Service (Indicative only)



Map Scale  
1:2500

While reasonable measures have been taken to ensure the accuracy of the information contained in this plan response, neither Urban Utilities nor PelicanCorp shall have any liability whatsoever in relation to any loss, damage, cost or expense arising from the use of this plan response or the information contained in it or the completeness or accuracy of such information. Use of such information is subject to and constitutes acceptance of these terms.

The plans are indicative and approximate only and provided without warranties of any kind, express or implied including in relation to accuracy, completeness, correctness, currency or fitness for purpose.

Urban Utilities takes no responsibility and accepts no liability for any loss, damage, costs or liability that may be incurred by any person acting in reliance on the information provided on the plans.

This plan should be used as guide only. Any dimensions should be confirmed on site by the relevant authority.

Based on or contains data provided by the State of Queensland (Department of Natural Resources and Mines) [2020]. In consideration of the State permitting the use of this data you acknowledge and agree that the State gives no warranty in relation to the data (including accuracy, liability in negligence) for any loss, damage or costs (including consequential damage) relating to any use of the data. Data must not be used for direct marketing or be used in breach of the privacy laws. © State of Queensland Department of Natural Resources and Mines [2020]

For further information, please call Urban Utilities on 13 26 57 (8am-6pm weekdays). Faults and emergencies 13 23 64 (24/7).

[www.urbanutilities.com.au](http://www.urbanutilities.com.au)

ABN 86 673 835 011



## Important Information

### **Disclaimer**

All Urban Utilities' records, data and information supplied via BYDA ("**Data**") is **indicative** only. You agree that any Data supplied to you has been or will be provided only for your convenience and has not been and will not be relied upon by you for any purpose.

You also agree that Urban Utilities does not assume any responsibility or duty of care in respect of, or warrant, guarantee or make any representation as to the Data (including its accuracy, reliability, currency or suitability).

Because the location of Urban Utilities' infrastructure shown on the Data is approximate only, you must first physically locate the infrastructure by utilising relevant site detection methodologies prior to performing any works or undertaking any activities near or adjacent to infrastructure. Possible site detection methodologies include hand digging, potholing, trenching and/or probing. You are solely responsible for the selection of appropriate site detection methodologies at all times.

To the fullest extent permitted by law, Urban Utilities will not be liable to you in contract, tort, equity, under statute or otherwise arising from or in connection with the provision of any Data to you via BYDA.

### **Compliance with laws**

There may be both indicated and unmarked hazards, dangers or encumbrances, including underground asbestos pipes and abandoned mains within your nominated search area. You are solely responsible for ensuring that appropriate care is taken at all times and that you comply with all mandatory requirements relating to such matters, including in relation to workplace health and safety.

### **Damaged Infrastructure**

Please note that it is an offence under Section 192 of the *Water Supply (Safety and Reliability) Act 2008* to interfere with our infrastructure without Urban Utilities' written consent.

You may be liable to Urban Utilities for any loss of or damage to our infrastructure, together with any consequential or indirect loss or damage (including without limitation, loss of use, loss of profits or loss of revenue) arising from or in connection with any interference with Urban Utilities' infrastructure by you or any other person for which you are legally responsible.

Any damage to Urban Utilities' Infrastructure must be reported immediately to the (24 Hours) Faults and Emergencies Team on 13 23 64.

### **Links**

Technical Standards: <https://urbanutilities.com.au/development/help-and-advice/standards-and-guidelines>

### **Copyright**

All Data is copyright.

Referral

241414114

Member Phone

1800 653 935

Responses from this member

Response received Wed 3 Jul 2024 4.57pm

File name	Page
Response Body	36
Telstra Map Legend 4.0a.pdf	38
241414114.pdf	39
Telstra Duty of Care v32.0a.pdf	40
AccreditedPlantLocators 2024-06-21a.pdf	42

**Attention:** Image Property

**Site Location:** 68 Zabels Road North, Minden, QLD 4311

**Your Job Reference:** 68 Zabels Road North

**Please do not reply to this email, this is an automated message -**



Important - this site is within or in the vicinity of a **RED IMPORTED FIRE ANT RESTRICTED AREA**. Movement controls apply. Penalties of up to \$220,000 for individuals and \$1.1 million for corporations may apply. Call **13 25 23** or visit [www.daff.qld.gov.au/fireants](http://www.daff.qld.gov.au/fireants) for further information.

Thank you for requesting Telstra information via Before You Dig Australia (BYDA).

This response contains Telstra information relating to your recent BYDA request.

Information for opening Telstra Asset Plans as well as some other useful contact information is listed in the attached **Telstra Map Legend attached.**

**Please refer to all enclosed attachments for more information.**

**Please Report Damage to Telstra Equipment:** [Report damages to Telstra equipment - Telstra](#)

Please note:

When working in the vicinity of telecommunications plant you have a 'Duty of Care' that must be observed. Please ensure you read the 'Telstra Duty of Care' document (attached) - it contains important information including essential steps that must be undertaken prior to commencing construction activities.

**WARNING:** Telstra plans and location information conform to Quality Level 'D' of the Australian Standard AS 5488 - Classification of Subsurface Utility Information. As such, Telstra supplied location information is indicative only. Spatial accuracy is not applicable to Quality Level D. Refer to AS 5488 for further details. The exact position of Telstra assets can only be validated by physically exposing them. Telstra does not warrant or hold out that its plans are accurate and accepts no responsibility for any inaccuracy. Further on site investigation is required to validate the exact location of Telstra assets prior to commencing work. A Certified Locating Organisation is an essential part of the process to validate the exact location of Telstra assets and to ensure the assets are protected during construction works. See the [Steps - Working Near Telecommunications Assets \(attached Telstra Duty of Care\)](#).

Please note that:

- it is a criminal offence under the *Criminal Code Act 1995* (Cth) to tamper or interfere with telecommunications infrastructure.
- Telstra will take action to recover compensation for damage caused to property and assets, and for interference with the operation of Telstra's networks and customers' services.

Telstra's plans contain Telstra's confidential information and are provided on the basis that they are used solely for identifying the location or vicinity of Telstra's infrastructure to avoid damage to this infrastructure occurring as part of any digging or other excavation activity. You must not use Telstra's plans for any other purpose or in a way that will cause Telstra loss or damage and you must comply with any other terms of access to the data that have been provided to you by Telstra (including Conditions of Use or Access).

(See attached file: *Telstra Duty of Care v32.0a.pdf*)

(See attached file: *Telstra Map Legend 4.0a.pdf*)

*(See attached file: AccreditedPlantLocators 2024-06-21a.pdf)*

*(See attached file: 241414114.pdf)*

## LEGEND

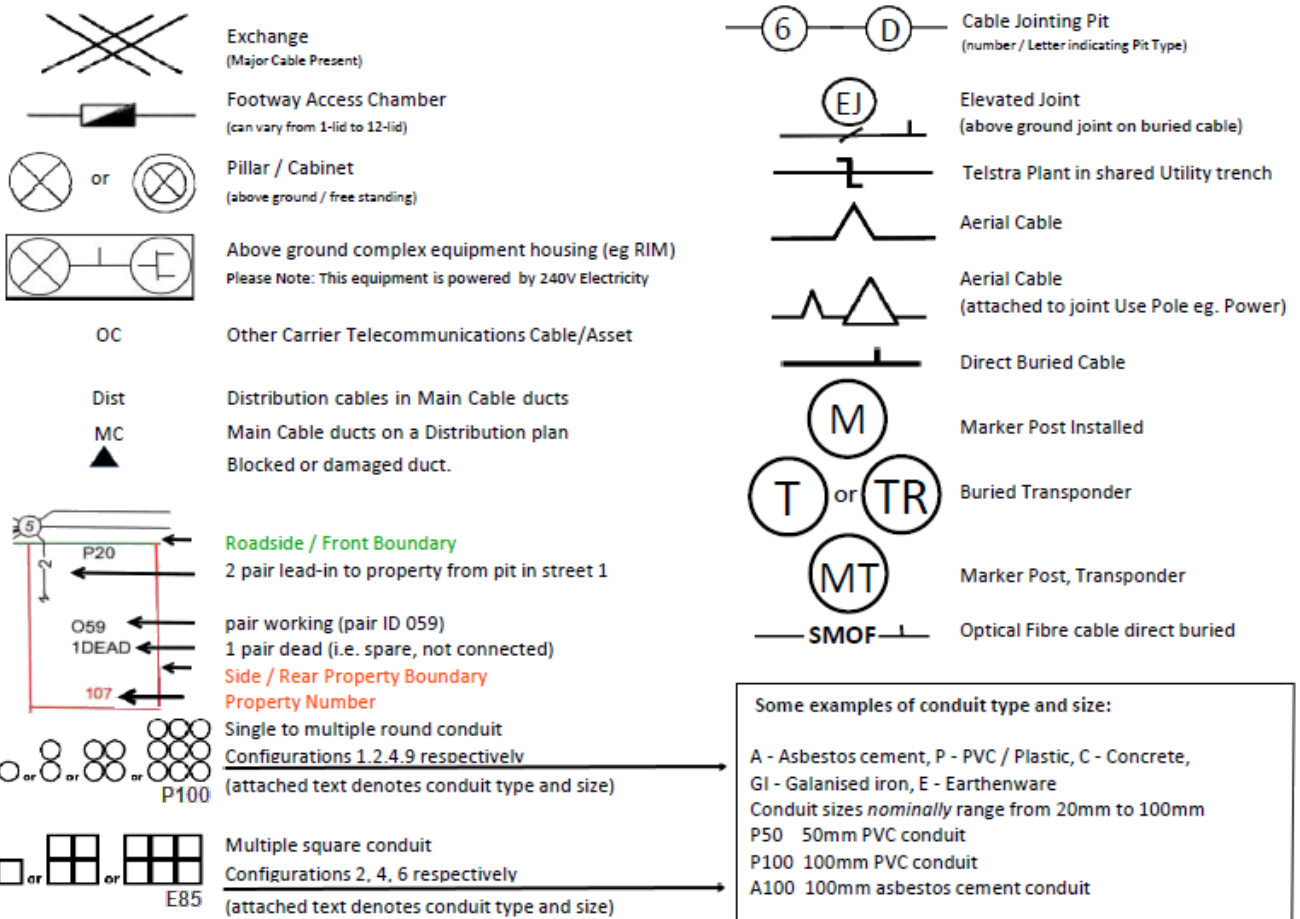

### Some Examples of how to read Telstra Plans

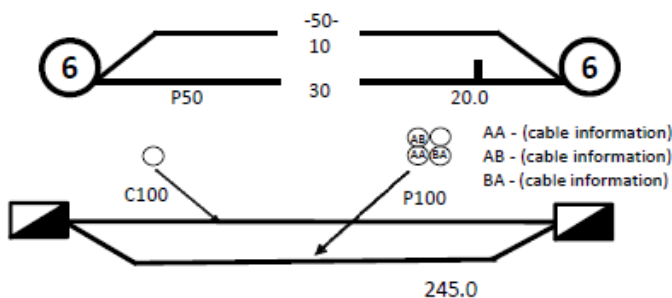

One 50mm PVC conduit (P50) containing a 50-pair and a 10-pair cable between two 6-pits, approximately 20.0m apart, with a direct buried 30-pair cable along the same route

Two separate conduit runs between two footway access chambers (manholes) approximately 245m apart A nest of four 100mm PVC conduits (P100) containing assorted cables in three ducts (one being empty) and one empty 100mm concrete duct (C100) along

## Protect our Network:

by maintaining the following distances from our assets:

- 1.0m Mechanical Excavators, Farm Ploughing, Tree Removal
- 500mm Vibrating Plate or Wacker Packer Compactor
- 600mm Heavy Vehicle Traffic (over 3 tonnes) not to be driven across Telstra ducts or plant.
- 1.0m Jackhammers/Pneumatic Breakers
- 2.0m Boring Equipment (in-line, horizontal and vertical)

For more info contact a [Certified Locating Organisation](#) or Telstra Plan Services 1800 653 935

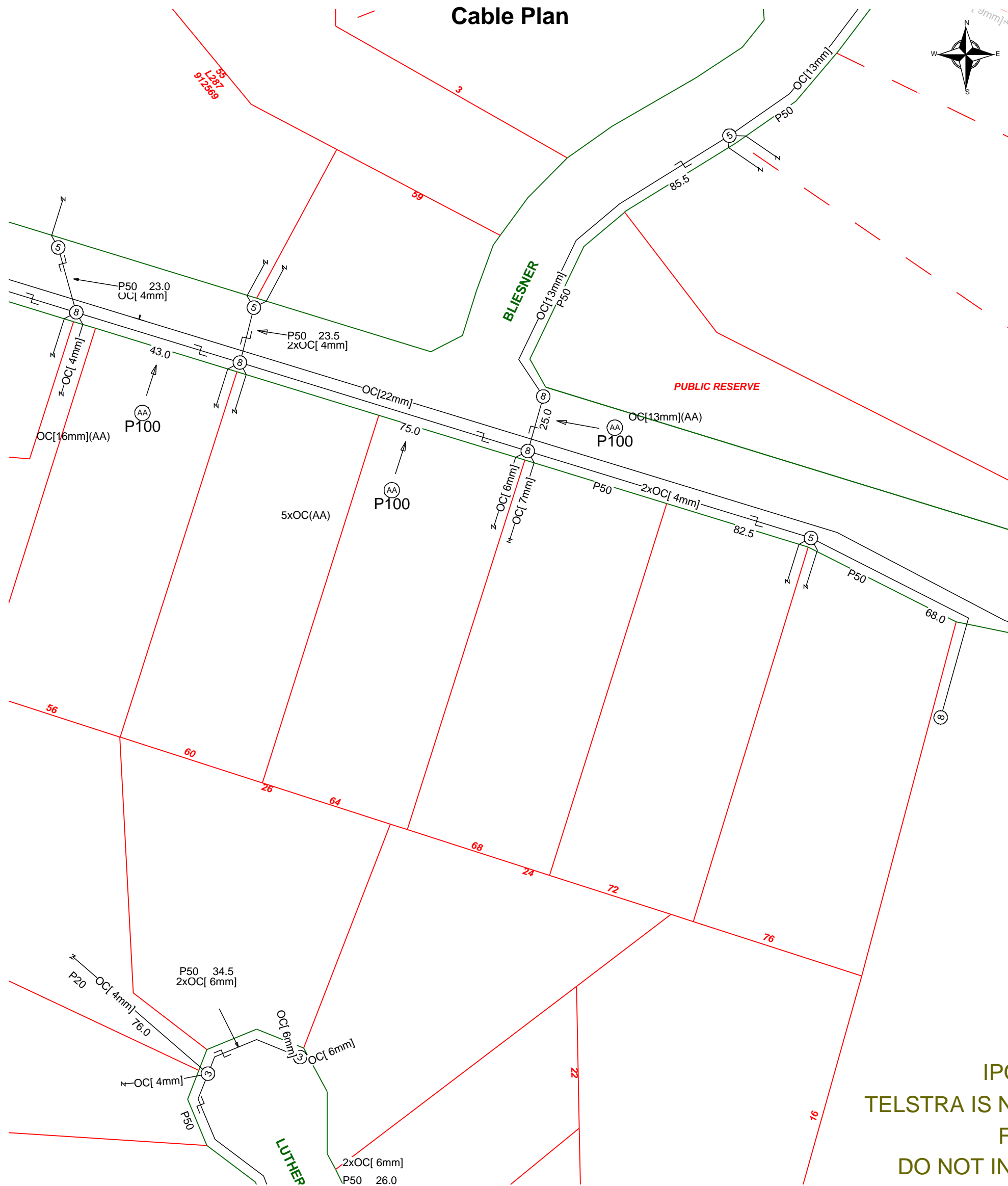

IPC  
TELSTRA IS N  
F  
DO NOT IN



Please read Duty of Care prior to any excavating

Generated On 03/07/2024 16:56:27

## Page 1 of 1



# Before You Dig Australia

## Think before you dig

This document has been sent to you because you requested plans of the Telstra network through Before You Dig Australia (BYDA).

**If you are working or excavating near telecommunications cables, or there is a chance that cables are located near your site, you are responsible to avoid causing damage to the Telstra network.**

Please read this document carefully. Taking your time now and following the steps below can help you avoid damaging our network, interrupting services, and potentially incurring civil and criminal penalties.

Our network is complex and working near it requires expert knowledge. Do not attempt these activities if you are not qualified to do so.



# Disclaimer and legal details



\*Telstra advises that the accuracy of the information provided by Telstra conforms to Quality Level D as defined in AS5488-2013.

It is a criminal offence under the Criminal Code Act 1995 (Cth) to tamper or interfere with telecommunications infrastructure.

Telstra will also take action to recover costs and damages from persons who damage assets or interfere with the operation of Telstra's networks.

By receiving this information including the indicative plans that are provided as part of this information package you confirm that you understand and accept the risks of working near Telstra's network and the importance of taking all the necessary steps to confirm the presence, alignments and various depths of Telstra's network. This in addition to, and not in replacement of, any duties and obligations you have under applicable law.

When working in the vicinity of a telecommunications plant you have a "Duty of Care" that must be observed. Please read and understand all the information and disclaimers provided below.

The Telstra network is complex and requires expert knowledge to interpret information, to identify and locate components, to pothole underground assets for validation and to safely work around assets without causing damage. If you are not an expert and/or qualified in these areas, then you must not attempt these activities. Telstra will seek compensation for damages caused to its property and losses caused to Telstra and its customers. Construction activities and/or any activities that potentially may impact on Telstra's assets must not commence without first undertaking these steps. Construction activities can include anything that involves breaking ground, potentially affecting Telstra assets.

If you are designing a project, it is recommended that you also undertake these steps to validate underground assets prior to committing to your design.

This Notice has been provided as a guide only and may not provide you with all the information that is required for you to determine what assets are on or near your site of interest. You will also need to collate and understand all of the information received from other Utilities and understand that some Utilities are not a part of the BYDA program and make your own enquiries as appropriate. It is the responsibility of the entities undertaking the works to protect Telstra's network during excavation / construction works.

Telstra owns and retains the copyright in all plans and details provided in conjunction with the applicant's request. The applicant is authorised to use the plans and details only for the purpose indicated in the applicant's request. The applicant must not use the plans or details for any other purpose.

Telstra plans or other details are provided only for the use of the applicant, its servants, agents, or Certified Locating Organisation. The applicant must not give the plans or details to any parties other than these and must not generate profit from commercialising the plans or details.

Telstra, its servants or agents shall not be liable for any loss or damage caused or occasioned by the use of plans and or details so supplied to the applicant, its servants and agents, and the applicant agrees to indemnify Telstra against any claim or demand for any such loss or damage.

Please ensure Telstra plans and information provided always remains on-site throughout the inspection, location, and construction phase of any works.

Telstra plans are valid for 60 days after issue and must be replaced if required after the 60 days.

## Data Extraction Fees

In some instances, a data extraction fee may be applicable for the supply of Telstra information. Typically, a data extraction fee may apply to large projects, planning and design requests or requests to be supplied in non-standard formats. For further details contact Telstra Planned Services.

Telstra does not accept any liability or responsibility for the performance of or advice given by a Certified Locating Organisation. Certification is an initiative taken by Telstra towards the establishment and maintenance of competency standards. However, performance and the advice given will always depend on the nature of the individual engagement.

Neither the Certified Locating Organisation nor any of its employees are an employee or agent for Telstra. Telstra is not liable for any damage or loss caused by the Certified Locating Organisation or its employees.

Once all work is completed, the excavation should be reinstated with the same type of excavated material unless specified by Telstra

The information contained within this pamphlet must be used in conjunction with other material supplied as part of this request for information to adequately control the risk of potential asset damage.

When using excavators and other machinery, also check the location of overhead power lines.

Workers and equipment must maintain safety exclusion zones around power lines

**WARNING:** Telstra plans and location information conform to Quality Level 'D' of the Australian Standard AS 5488 - Classification of Subsurface Utility Information. As such, Telstra supplied location information is indicative only. Spatial accuracy is not applicable to Quality Level D. Refer to AS 5488 for further details. Telstra does not warrant or hold out that its plans are accurate and accepts no responsibility for any inaccuracy shown on the plans. **FURTHER ON SITE INVESTIGATION IS REQUIRED TO VALIDATE THE EXACT LOCATION OF TELSTRA PLANT PRIOR TO COMMENCING CONSTRUCTION WORK.** A plant location service is an essential part of the process to validate the exact location of Telstra assets and to ensure the assets are protected during construction works. The exact position of Telstra assets can only be validated by physically exposing them. Telstra will seek compensation for damages caused to its property and losses caused to Telstra and its customers.

## Privacy Note

Your information has been provided to Telstra by BYDA to enable Telstra to respond to your BYDA request. Telstra keeps your information in accordance with its privacy statement. You can obtain a copy at [www.telstra.com.au/privacy](http://www.telstra.com.au/privacy) or by calling us at 1800 039 059 (business hours only).

## OPENING ELECTRONIC MAP ATTACHMENTS –

Telstra Cable Plans are generated automatically in either PDF or DWF file types.  
Dependent on the site address and the size of area selected.  
You may need to download and install free viewing software from the internet e.g.



DWF Map Files (all sizes over A3)  
Autodesk Viewer (Internet Browser) <https://viewer.autodesk.com/> or  
Autodesk Design Review <http://usa.autodesk.com/design-review/> for  
DWF files. (Windows PC)



PDF Map Files (max size A3)  
Adobe Acrobat Reader <http://get.adobe.com/reader/>



Telstra BYDA map related enquiries email  
[Telstra.Plans@team.telstra.com](mailto:Telstra.Plans@team.telstra.com)  
1800 653 935 (AEST Business Hours only)



REPORT ANY DAMAGE TO THE TELSTRA NETWORK IMMEDIATELY  
Report online - <https://www.telstra.com.au/forms/report-damage-to-telstra-equipment>  
Ph: 13 22 03  
If you receive a message asking for a phone or account number say:  
“I don’t have one” then say “Report Damage” then press 1 to speak  
to an operator.



Telstra New Connections / Disconnections  
13 22 00

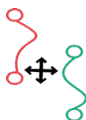

Telstra asset relocation enquiries: 1800 810 443 (AEST business  
hours only).  
[NetworkIntegrity@team.telstra.com](mailto:NetworkIntegrity@team.telstra.com)  
<https://www.telstra.com.au/consumer-advice/digging-construction/>



Telstra Aerial Assets Group (overhead network)  
1800 047 909



Certified Locating Organisation (CLO)  
<https://dbydlocator.com/certified-locating-organisation/>



## End of document

**i** This document may exclude some files (eg. DWF or ZIP files)

This document was automatically generated at a point-in-time. Be aware that the source information from which this document was created may have changed since it was produced. This document may contain incomplete or out-of-date information. Always check your enquiry details in the BYDA Referral Service for the most recent information. For copyright information refer to individual responses.