

WESTERN



AUSTRALIA

TITLE NUMBER

Volume

2229

Folio

9

RECORD OF CERTIFICATE OF TITLE  
UNDER THE TRANSFER OF LAND ACT 1893

The person described in the first schedule is the registered proprietor of an estate in fee simple in the land described below subject to the reservations, conditions and depth limit contained in the original grant (if a grant issued) and to the limitations, interests, encumbrances and notifications shown in the second schedule.

BGRoberts  
REGISTRAR OF TITLES



LAND DESCRIPTION:

LOT 28 ON DEPOSITED PLAN 38180

REGISTERED PROPRIETOR:  
(FIRST SCHEDULE)

(T N732683 ) REGISTERED 3/10/2017

LIMITATIONS, INTERESTS, ENCUMBRANCES AND NOTIFICATIONS:  
(SECOND SCHEDULE)

1. EASEMENT BURDEN CREATED UNDER SECTION 27A OF T. P. & D. ACT - SEE DEPOSITED PLAN 38180.
2. O960106 MORTGAGE TO WESTPAC BANKING CORPORATION REGISTERED 30/11/2021.

Warning: A current search of the sketch of the land should be obtained where detail of position, dimensions or area of the lot is required.  
Lot as described in the land description may be a lot or location.

-----END OF CERTIFICATE OF TITLE-----

STATEMENTS:

The statements set out below are not intended to be nor should they be relied on as substitutes for inspection of the land and the relevant documents or for local government, legal, surveying or other professional advice.

SKETCH OF LAND: DP38180  
PREVIOUS TITLE: 2229-7  
PROPERTY STREET ADDRESS: 17A FRASER ST, EAST FREMANTLE.  
LOCAL GOVERNMENT AUTHORITY: TOWN OF EAST FREMANTLE



DP 38180



TYPE	FREEHOLD
PURPOSE	SUBDIVISION
PLAN OF	LOTS 27 & 28 & EASEMENT
DOLA FILE	
DISTRICT	SWAN
TOWNSITE	TOWN OF EAST FREMANTLE
LOCAL AUTHORITY	EAST FREMANTLE
LOCALITY	ON
FORMER TENURE	ON
LOT 181 ON P 1794 (1)	INDEX BG 34(2) 08.15
SP 6563	PUBLIC
2729-7	FIELD BOOK
90257	
SCALE:	0 5' 10' 15' 20' 25'
ALL DISTANCE ARE IN METRES	1:250
SURVEYOR'S CERTIFICATE - Reg 54	
I, Kim Mc Gowan hereby certify that this plan is a correct representation of the survey and / or calculations from measurements recorded in the field book lodged for the purposes of this plan and that it complies with the relevant written laws in relation to which it is lodged.	
SURVEYOR'S CERTIFICATE - Completed	
I, KIM MC GOWAN hereby certify that this completed plan is a correct and accurate representation of the survey(s) of the subject land and (b) is in accordance with the relevant law in relation to which it is lodged.	
SURVEY FIRM	
Kim Mc Gowan, Licensed Land Surveyor	
P.O. Box 700 COTTESLOE WA. 6911	
Mob 0418 944922 Fax 9385 2123	
APPROVED BY	
WESTERN AUSTRALIAN PLANNING COMMISSION	
FILE 122741	
DELEGATED UNDER 520 WATER ACT 1985	
DATE 16-12-03	
DOLA	
Department of LAND ADMINISTRATION	
DEPOSITED PLAN	
38180	
SHEET 1 OF 1	
EDITION 1 VERSION 1	
APPROVED	
INSPECTOR OF PLANS & SURVEYS	
DATE 19.8.2004	
AUTHORIZED LAND OFFICER	

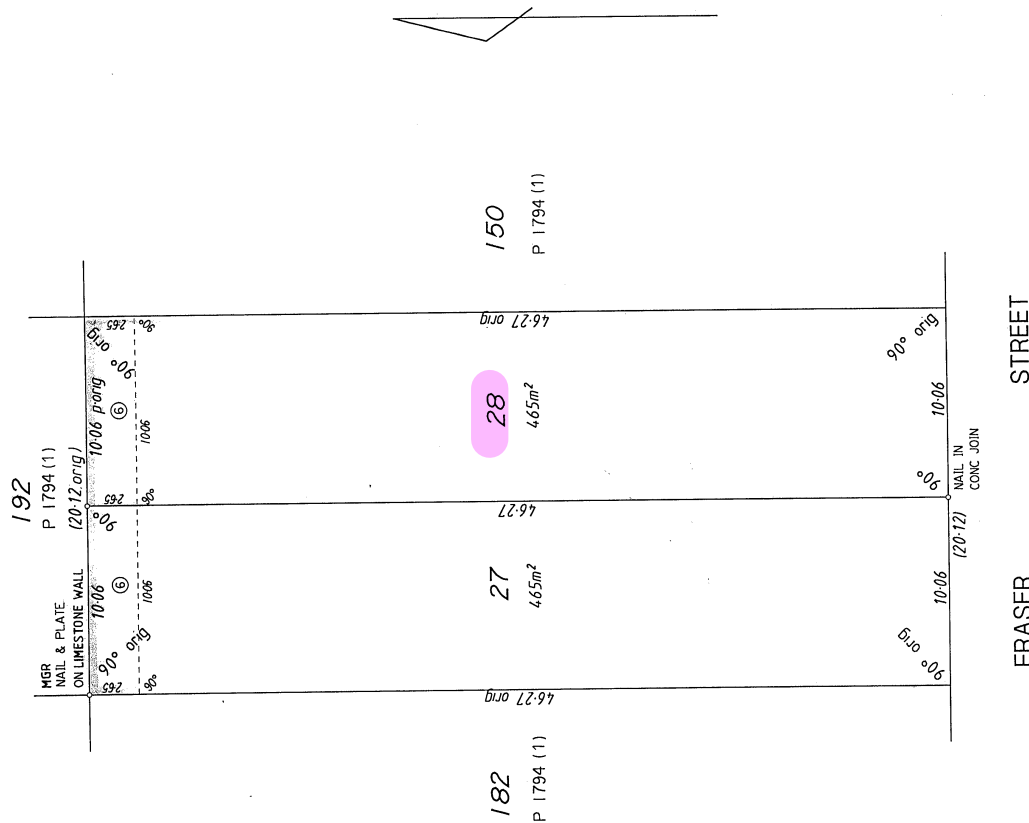

## INTERESTS AND NOTIFICATIONS

SUBJECT	PURPOSE	STATUTORY REFERENCE	ORIGIN	BURDENED LAND	BENEFIT TO	COMMENTS
6	EASEMENT (SEWERAGE)	SEC 27A TP&D ACT	THIS PLAN	LOTS 27&28	WATER CORPORATION	

REF: DWG1006A

## Deposited Plan 38180

Lot	Certificate of Title	Lot Status	Part Lot
27	2229/8	Registered	
28	2229/9	Registered	