

Vendor Statement

The vendor makes this statement in respect of the land in accordance with section 32 of the *Sale of Land Act* 1962.

This statement must be signed by the vendor and given to the purchaser before the purchaser signs the contract.

The vendor may sign by electronic signature.

The purchaser acknowledges being given this statement signed by the vendor with the attached documents before the purchaser signed any contract.

Land	55 Pioneer Road, Boolarra VIC 3870
-------------	------------------------------------

Vendor's name	Darren John Watson	Date
Vendor's signature		/ /

Purchaser's name	Date
	/ /
Purchaser's signature	
Purchaser's name	Date
	/ /
Purchaser's signature	



LAWYERS

Wakefield Lawyers

5 Bank Place (PO Box 242) Drouin VIC 3818
54 Albert Street (PO Box 329) Warragul VIC 3820

Ph: 03 5623 5166

Email: brynley@wakefieldlawyers.com.au

Ref: BRG:63043

1. FINANCIAL MATTERS

1.1 Particulars of any Rates, Taxes, Charges or Other Similar Outgoings (and any interest on them)

(a) ☒ Their total does not exceed: \$3,500.00

1.2 Particulars of any Charge (whether registered or not) imposed by or under any Act to secure an amount due under that Act, including the amount owing under the charge

Not Applicable

1.3 Terms Contract

This section 1.3 only applies if this vendor statement is in respect of a terms contract where the purchaser is obliged to make 2 or more payments (other than a deposit or final payment) to the vendor after the execution of the contract and before the purchaser is entitled to a conveyance or transfer of the land.

Not Applicable

1.4 Sale Subject to Mortgage

This section 1.4 only applies if this vendor statement is in respect of a contract which provides that any mortgage (whether registered or unregistered), is NOT to be discharged before the purchaser becomes entitled to possession or receipts of rents and profits.

Not Applicable

1.5 Commercial and Industrial Property Tax Reform Act 2024 (Vic) (CIPT Act)

(a) The Australian Valuation Property Classification Code (within the meaning of the CIPT Act) most recently allocated to the land is set out in the attached Municipal rates notice or property clearance certificate or is as follows	AVPC No. 117
(b) Is the land tax reform scheme land within the meaning of the CIPT Act?	<input type="checkbox"/> YES <input checked="" type="checkbox"/> NO
(c) If the land is tax reform scheme land within the meaning of the CIPT Act, the entry date within the meaning of the CIPT Act is set out in the attached Municipal rates notice or property clearance certificate or is as follows	Date: OR <input checked="" type="checkbox"/> Not applicable

2. INSURANCE

2.1 Damage and Destruction

This section 2.1 only applies if this vendor statement is in respect of a contract which does NOT provide for the land to remain at the risk of the vendor until the purchaser becomes entitled to possession or receipt of rents and profits.

Not Applicable

2.2 Owner Builder

This section 2.2 only applies where there is a residence on the land that was constructed by an owner-builder within the preceding 6 years and section 137B of the Building Act 1993 applies to the residence.

Not Applicable

3. LAND USE

3.1 Easements, Covenants or Other Similar Restrictions

(a) A description of any easement, covenant or other similar restriction affecting the land (whether registered or unregistered):

☒ Is in the attached copies of title document/s

(b) Particulars of any existing failure to comply with that easement, covenant or other similar restriction are:

Not Applicable

3.2 Road Access

There is NO access to the property by road if the square box is marked with an 'X'

☐

3.3 Designated Bushfire Prone Area

The land is in a designated bushfire prone area within the meaning of section 192A of the *Building Act* 1993 if the square box is marked with an 'X'

☒

3.4 Planning Scheme

☒ Attached is a certificate with the required specified information.

4. NOTICES

4.1 Notice, Order, Declaration, Report or Recommendation

Particulars of any notice, order, declaration, report or recommendation of a public authority or government department or approved proposal directly and currently affecting the land, being a notice, order, declaration, report, recommendation or approved proposal of which the vendor might reasonably be expected to have knowledge:

Not Applicable

4.2 Agricultural Chemicals

There are NO notices, property management plans, reports or orders in respect of the land issued by a government department or public authority in relation to livestock disease or contamination by agricultural chemicals affecting the ongoing use of the land for agricultural purposes. However, if this is not the case, the details of any such notices, property management plans, reports or orders, are as follows:

NIL

4.3 Compulsory Acquisition

The particulars of any notices of intention to acquire that have been served under section 6 of the *Land Acquisition and Compensation Act* 1986 are as follows:

NIL

5. BUILDING PERMITS

Particulars of any building permit issued under the *Building Act* 1993 in the preceding 7 years (required only where there is a residence on the land):

Not Applicable

6. OWNERS CORPORATION

This section 6 only applies if the land is affected by an owners corporation within the meaning of the *Owners Corporations Act* 2006.

Not Applicable

7. GROWTH AREAS INFRASTRUCTURE CONTRIBUTION ("GAIC")

Words and expressions in this section 7 have the same meaning as in Part 9B of the *Planning and Environment Act* 1987.

Not Applicable

8. SERVICES

The services which are marked with an 'X' in the accompanying square box are NOT connected to the land:

Electricity supply <input type="checkbox"/>	Gas supply <input checked="" type="checkbox"/>	Water supply <input checked="" type="checkbox"/>	Sewerage <input checked="" type="checkbox"/>	Telephone services <input type="checkbox"/>
---	--	--	--	---

9. TITLE

Attached are copies of the following documents:

9.1 ☒ (a) Registered Title

A Register Search Statement and the document, or part of a document, referred to as the 'diagram location' in that statement which identifies the land and its location.

10. SUBDIVISION

10.1 Unregistered Subdivision

This section 10.1 only applies if the land is subject to a subdivision which is not registered.

Not Applicable

10.2 Staged Subdivision

This section 10.2 only applies if the land is part of a staged subdivision within the meaning of section 37 of the *Subdivision Act 1988*.

- (a) Attached is a copy of the plan for the first stage if the land is in the second or subsequent stage.
- (b) The requirements in a statement of compliance relating to the stage in which the land is included that have Not been complied With are As follows:

NIL

- (c) The proposals relating to subsequent stages that are known to the vendor are as follows:

NIL

- (d) The contents of any permit under the Planning and Environment Act 1987 authorising the staged subdivision are:

NIL

10.3 Further Plan of Subdivision

This section 10.3 only applies if the land is subject to a subdivision in respect of which a further plan within the meaning of the *Subdivision Act 1988* is proposed.

Not Applicable

11. DISCLOSURE OF ENERGY INFORMATION

(Disclosure of this information is not required under section 32 of the Sale of Land Act 1962 but may be included in this vendor statement for convenience.)

Details of any energy efficiency information required to be disclosed regarding a disclosure affected building or disclosure area affected area of a building as defined by the *Building Energy Efficiency Disclosure Act 2010* (Cth)

- (a) to be a building or part of a building used or capable of being used as an office for administrative, clerical, professional or similar based activities including any support facilities; and
- (b) which has a net lettable area of at least 1000m²; (but does not include a building under a strata title system or if an occupancy permit was issued less than 2 years before the relevant date):

Not Applicable

12. DUE DILIGENCE CHECKLIST

(The Sale of Land Act 1962 provides that the vendor or the vendor's licensed estate agent must make a prescribed due diligence checklist available to purchasers before offering land for sale that is vacant residential land or land on which there is a residence. The due diligence checklist is NOT required to be provided with, or attached to, this vendor statement but the checklist may be attached as a matter of convenience.)

Is attached

13. VENDOR/SUPPLIER GST WITHHOLDING NOTICE

Pursuant to section 14–255 Schedule 1 *Taxation Administration Act 1953* (Cth)

The Purchaser/Recipient is not required to make a payment under section 14–250 of Schedule 1 of the Taxation Administration Act 1953 (Cth) in relation to the supply of the above property.

14. OTHER INFORMATION

Not applicable.

15. ATTACHMENTS

(Any certificates, documents and other attachments may be annexed to this section 13)

(Additional information may be added to this section 13 where there is insufficient space in any of the earlier sections)
(Attached is an "Additional Vendor Statement" if section 1.3 (Terms Contract) or section 1.4 (Sale Subject to Mortgage) applies)

- | | |
|-------|--|
| 15(a) | Due Diligence Checklist |
| 15(b) | Register Search Statement Volume 08274 Folio 842 |
| 15(c) | Copy of Plan – TP273053P |
| 15(d) | Planning Property Report |
| 15(e) | Property Report |
| 15(f) | DELWP Agricultural Licence Search |
| 15(g) | Rates & Valuation Notice |

Due diligence checklist

What you need to know before buying a residential property

Before you buy a home, you should be aware of a range of issues that may affect that property and impose restrictions or obligations on you, if you buy it. This checklist aims to help you identify whether any of these issues will affect you. The questions are a starting point only and you may need to seek professional advice to answer some of them. You can find links to organisations and web pages that can help you learn more, by visiting the [Due diligence checklist page on the Consumer Affairs Victoria website](http://consumer.vic.gov.au/duediligencechecklist) (consumer.vic.gov.au/duediligencechecklist).

Urban living

Moving to the inner city?

High density areas are attractive for their entertainment and service areas, but these activities create increased traffic as well as noise and odours from businesses and people. Familiarising yourself with the character of the area will give you a balanced understanding of what to expect.

Is the property subject to an owners corporation?

If the property is part of a subdivision with common property such as driveways or grounds, it may be subject to an owners corporation. You may be required to pay fees and follow rules that restrict what you can do on your property, such as a ban on pet ownership.

Growth areas

Are you moving to a growth area?

You should investigate whether you will be required to pay a growth areas infrastructure contribution.

Flood and fire risk

Does this property experience flooding or bushfire?

Properties are sometimes subject to the risk of fire and flooding due to their location. You should properly investigate these risks and consider their implications for land management, buildings and insurance premiums.

Rural properties

Moving to the country?

If you are looking at property in a rural zone, consider:

- Is the surrounding land use compatible with your lifestyle expectations? Farming can create noise or odour that may be at odds with your expectations of a rural lifestyle.
- Are you considering removing native vegetation? There are regulations which affect your ability to remove native vegetation on private property.
- Do you understand your obligations to manage weeds and pest animals?

Can you build new dwellings?

Does the property adjoin crown land, have a water frontage, contain a disused government road, or are there any crown licences associated with the land?

Is there any earth resource activity such as mining in the area?

You may wish to find out more about exploration, mining and quarrying activity on or near the property and consider the issue of petroleum, geothermal and greenhouse gas sequestration permits, leases and licences, extractive industry authorisations and mineral licences.

Soil and groundwater contamination

Has previous land use affected the soil or groundwater?

You should consider whether past activities, including the use of adjacent land, may have caused contamination at the site and whether this may prevent you from doing certain things to or on the land in the future.

(04/10/2016)

Land boundaries

Do you know the exact boundary of the property?

You should compare the measurements shown on the title document with actual fences and buildings on the property, to make sure the boundaries match. If you have concerns about this, you can speak to your lawyer or conveyancer, or commission a site survey to establish property boundaries.

Planning controls

Can you change how the property is used, or the buildings on it?

All land is subject to a planning scheme, run by the local council. How the property is zoned and any overlays that may apply, will determine how the land can be used. This may restrict such things as whether you can build on vacant land or how you can alter or develop the land and its buildings over time.

The local council can give you advice about the planning scheme, as well as details of any other restrictions that may apply, such as design guidelines or bushfire safety design. There may also be restrictions – known as encumbrances – on the property's title, which prevent you from developing the property. You can find out about encumbrances by looking at the section 32 statement.

Are there any proposed or granted planning permits?

The local council can advise you if there are any proposed or issued planning permits for any properties close by. Significant developments in your area may change the local 'character' (predominant style of the area) and may increase noise or traffic near the property.

Safety

Is the building safe to live in?

Building laws are in place to ensure building safety. Professional building inspections can help you assess the property for electrical safety, possible illegal building work, adequate pool or spa fencing and the presence of asbestos, termites, or other potential hazards.

Building permits

Have any buildings or retaining walls on the property been altered, or do you plan to alter them?

There are laws and regulations about how buildings and retaining walls are constructed, which you may wish to investigate to ensure any completed or proposed building work is approved. The local council may be able to give you information about any building permits issued for recent building works done to the property, and what you must do to plan new work. You can also commission a private building surveyor's assessment.

Are any recent building or renovation works covered by insurance?

Ask the vendor if there is any owner-builder insurance or builder's warranty to cover defects in the work done to the property.

Utilities and essential services

Does the property have working connections for water, sewerage, electricity, gas, telephone and internet?

Unconnected services may not be available, or may incur a fee to connect. You may also need to choose from a range of suppliers for these services. This may be particularly important in rural areas where some services are not available.

Buyers' rights

Do you know your rights when buying a property?

The contract of sale and section 32 statement contain important information about the property, so you should request to see these and read them thoroughly. Many people engage a lawyer or conveyancer to help them understand the contracts and ensure the sale goes through correctly. If you intend to hire a professional, you should consider speaking to them before you commit to the sale. There are also important rules about the way private sales and auctions are conducted. These may include a cooling-off period and specific rights associated with 'off the plan' sales. The important thing to remember is that, as the buyer, you have rights.

Copyright State of Victoria. No part of this publication may be reproduced except as permitted by the Copyright Act 1968 (Cth), to comply with a statutory requirement or pursuant to a written agreement. The information is only valid at the time and in the form obtained from the LANDATA REGD TM System. None of the State of Victoria, its agents or contractors, accepts responsibility for any subsequent publication or reproduction of the information.

The Victorian Government acknowledges the Traditional Owners of Victoria and pays respects to their ongoing connection to their Country, History and Culture. The Victorian Government extends this respect to their Elders, past, present and emerging.

REGISTER SEARCH STATEMENT (Title Search) Transfer of Land Act 1958

VOLUME 08274 FOLIO 842

Security no : 124125839403T

Produced 02/07/2025 09:40 AM

CROWN GRANT

LAND DESCRIPTION

Crown Allotment 14J Section A Parish of Budgeriee.

REGISTERED PROPRIETOR

Estate Fee Simple

Sole Proprietor

DARREN JOHN WATSON of 55 PIONEER ROAD BOOLARRA VIC 3870
AR867206X 24/01/2019

ENCUMBRANCES, CAVEATS AND NOTICES

MORTGAGE AV545628G 20/04/2022

NATIONAL AUSTRALIA BANK LTD

Any crown grant reservations exceptions conditions limitations and powers noted on the plan or imaged folio set out under DIAGRAM LOCATION below.
For details of any other encumbrances see the plan or imaged folio set out under DIAGRAM LOCATION below.

DIAGRAM LOCATION

SEE TP273053P FOR FURTHER DETAILS AND BOUNDARIES

ACTIVITY IN THE LAST 125 DAYS

NIL

-----END OF REGISTER SEARCH STATEMENT-----

Additional information: (not part of the Register Search Statement)

Street Address: 55 PIONEER ROAD BOOLARRA VIC 3870

ADMINISTRATIVE NOTICES

NIL

eCT Control 16089P NATIONAL AUSTRALIA BANK LTD
Effective from 20/04/2022

DOCUMENT END

Delivered from the LANDATA® System by InfoTrack Pty Ltd.

The information supplied by InfoTrack (Smokeball) has been obtained from InfoTrack Pty Limited by agreement between them. The information supplied has been obtained by InfoTrack Pty Limited who is licensed by the State of Victoria to provide this information via LANDATA® System.

TITLE PLAN		EDITION 1	TP 273053P
Location of Land Parish: BUDGEREE Township: Section: A Crown Allotment: 14J Crown Portion: Last Plan Reference: Derived From: VOL 8274 FOL 842 Depth Limitation: 50 FEET		Notations SUBJECT TO THE RESERVATIONS EXCEPTIONS CONDITIONS AND POWERS CONTAINED IN CROWN GRANT VOL. 8274 FOL. 842 AND NOTED ON SHEET 2 OF THIS PLAN ANY REFERENCE TO MAP IN THE TEXT MEANS THE DIAGRAM SHOWN ON THIS TITLE PLAN	
Description of Land / Easement Information		THIS PLAN HAS BEEN PREPARED FOR THE LAND REGISTRY, LAND VICTORIA, FOR TITLE DIAGRAM PURPOSES AS PART OF THE LAND TITLES AUTOMATION PROJECT COMPILED: 14/01/2000 VERIFIED: GB	
<div><div>COLOUR CODE Y = YELLOW</div><div></div></div>			
LENGTHS ARE IN LINKS		Metres = 0.3048 x Feet Metres = 0.201168 x Links	Sheet 1 of 2 sheets

TITLE PLAN		TP 273053P	
LAND DESCRIPTION INCLUDING RESERVATIONS EXCEPTIONS CONDITIONS AND POWERS SHOWN ON THE CROWN GRANT			
<p>All that piece of land in the said State containing five acres one rood and twenty-eight perches more or less being Allotment fourteen^d of Section A in the Parish of Budgerie County of Buln Buln</p> <p>delineated and colored yellow in the map in the margin hereof TOGETHER with the right to sink wells for water and to the use for all purposes of any wells and springs now or hereafter upon the said land as though this Grant had been made without any limitation as to depth PROVIDED that this Grant is made subject to—</p> <p>(a) the reservation to Us Our heirs and successors of—</p> <p>(i) all gold silver uranium thorium and minerals within the meaning of the <i>Mines Act</i> 1958 and petroleum within the meaning of the <i>Petroleum Act</i> 1958 (hereinafter called "the reserved minerals");</p> <p>(ii) rights of access for the purpose of searching for and obtaining the reserved minerals in any part of the said land;</p> <p>(iii) rights for access and for pipe-lines works and other purposes necessary for obtaining and conveying on and from the said land any of the reserved minerals which is obtained in any part of the said land;</p> <p>(b) the right to resume the said land for mining purposes pursuant to section 205 of the <i>Land Act</i> 1958;</p> <p>(c) the right of any person being the holder of a miner's right or of a mining lease or mineral lease under the <i>Mines Act</i> 1958 or any corresponding previous enactment to enter on the said land and to mine for gold or minerals within the meaning of that Act and to erect and occupy mining plant or machinery thereon in the same manner and under the same conditions and provisions as those under which such a person has now the right to mine for gold and silver in and upon Crown lands provided that compensation as prescribed by Part II. of that Act is paid for surface damage to be done to the said land by reason of mining thereon.</p>			
LENGTHS ARE IN LINKS		Metres = 0.3048 x Feet Metres = 0.201168 x Links	Sheet 2 of 2 sheets

From www.land.vic.gov.au at 02 July 2025 09:41 AM

PROPERTY DETAILS

Address: **55 PIONEER ROAD BOOLARRA 3870**
Crown Description: **Allot. 14J Sec. A PARISH OF BUDGEREE**
Standard Parcel Identifier (SPI): **14J~A\PP2250**
Local Government Area (Council): **LATROBE**
Council Property Number: **21697**
Directory Reference: **Vicroads 97 F8**

www.latrobe.vic.gov.au

SITE DIMENSIONS

All dimensions and areas are approximate. They may not agree with those shown on a title or plan.

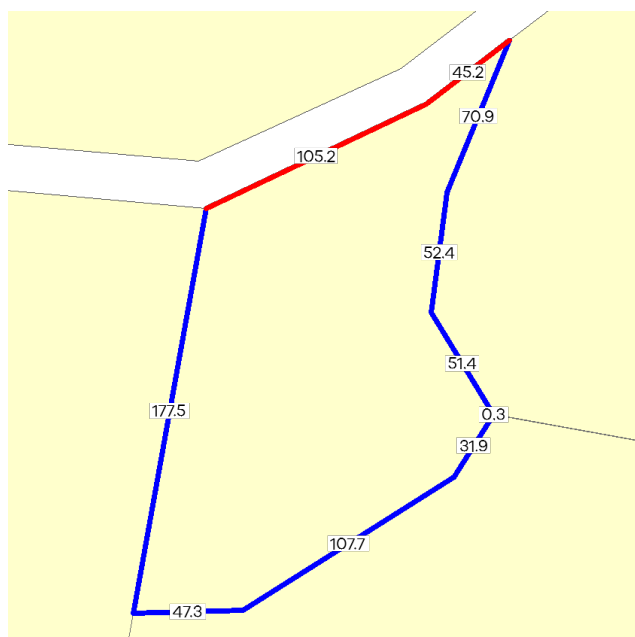

Area: 21925 sq. m (2.19 ha)

Perimeter: 690 m

For this property:

— Site boundaries

— Road frontages

Dimensions for individual parcels require a separate search, but dimensions for individual units are generally not available.

Calculating the area from the dimensions shown may give a different value to the area shown above

For more accurate dimensions get copy of plan at [Title and Property Certificates](#)

UTILITIES

Rural Water Corporation: **Southern Rural Water**
Urban Water Corporation: **South Gippsland Water**
Melbourne Water: **Outside drainage boundary**
Power Distributor: **AUSNET**

STATE ELECTORATES

Legislative Council: **EASTERN VICTORIA**
Legislative Assembly: **GIPPSLAND SOUTH**

PLANNING INFORMATION

Property Planning details have been removed from the Property Reports to avoid duplication with the Planning Property Reports from the Department of Transport and Planning which are the authoritative source for all Property Planning information.

The Planning Property Report for this property can found here - [Planning Property Report](#)

Planning Property Reports can be found via these two links

Vicplan <https://mapshare.vic.gov.au/vicplan/>

Property and parcel search <https://www.land.vic.gov.au/property-and-parcel-search>

Area Map

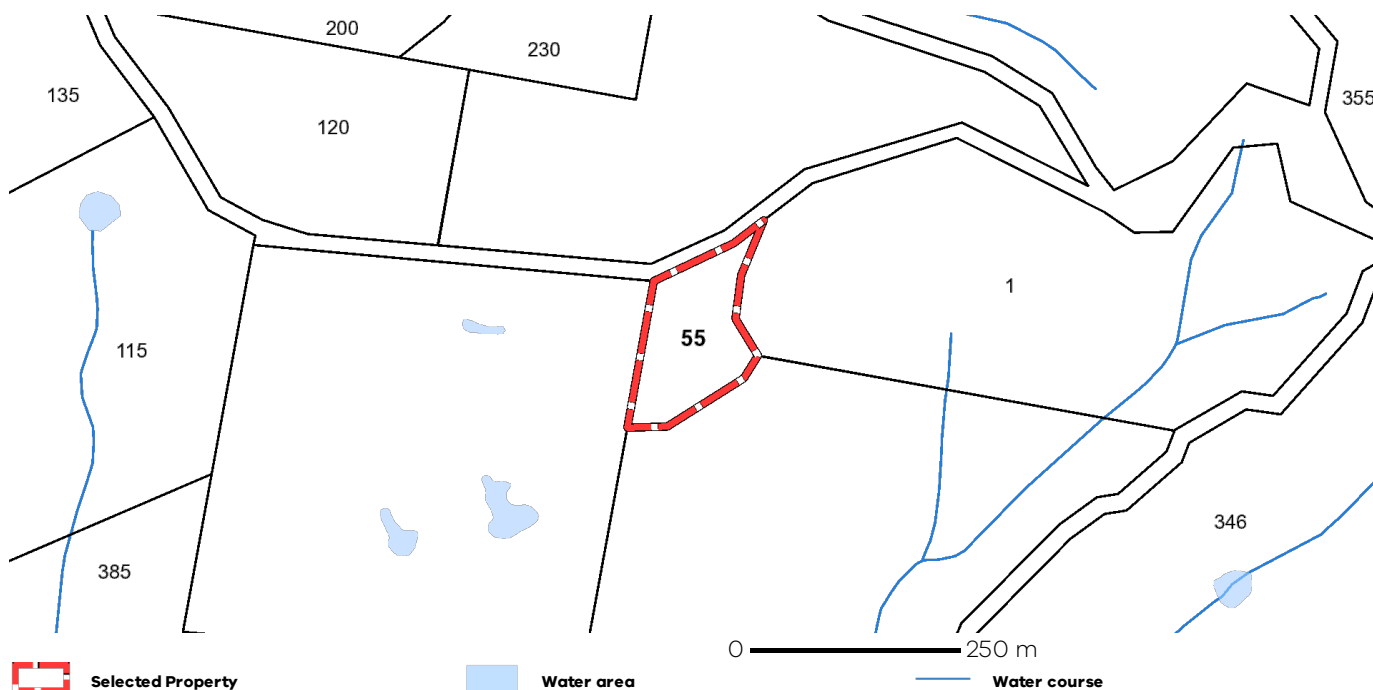

From www.planning.vic.gov.au at 02 July 2025 09:41 AM

PROPERTY DETAILS

Address: 55 PIONEER ROAD BOOLARRA 3870

Crown Description: Allot. 14J Sec. A PARISH OF BUDGEREE

Standard Parcel Identifier (SPI): 14J~A\PP2250

Local Government Area (Council): LATROBE

Council Property Number: 21697

Planning Scheme: Latrobe

Directory Reference: Vicroads 97 F8

www.latrobe.vic.gov.au

[Planning Scheme - Latrobe](#)

UTILITIES

Rural Water Corporation: Southern Rural Water

Urban Water Corporation: South Gippsland Water

Melbourne Water: Outside drainage boundary

Power Distributor: AUSNET

STATE ELECTORATES

Legislative Council: EASTERN VICTORIA

Legislative Assembly: GIPPSLAND SOUTH

OTHER

Registered Aboriginal Party: Gunaikurnai Land and Waters
Aboriginal Corporation

[View location in VicPlan](#)

Planning Zones

[FARMING ZONE \(FZ\)](#)
[FARMING ZONE - SCHEDULE 1 \(FZ1\)](#)

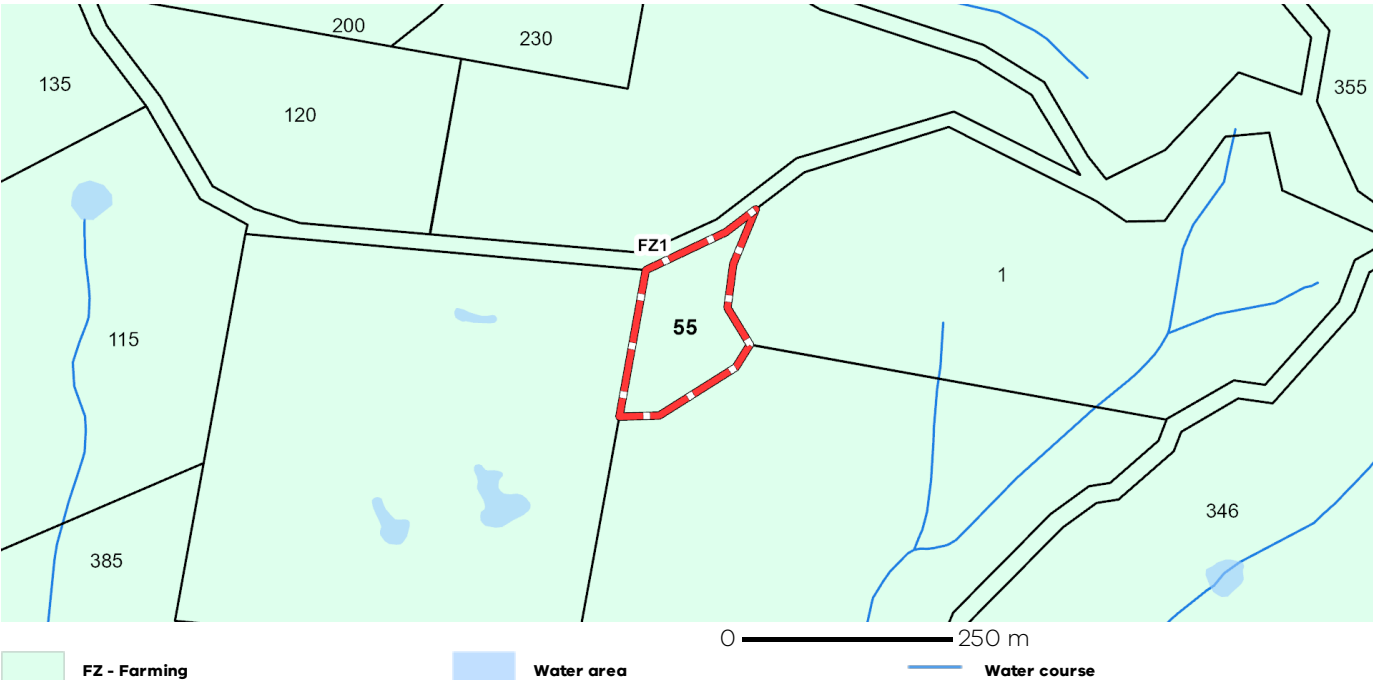

Note: labels for zones may appear outside the actual zone - please compare the labels with the legend.

Planning Overlay

BUSHFIRE MANAGEMENT OVERLAY (BMO)

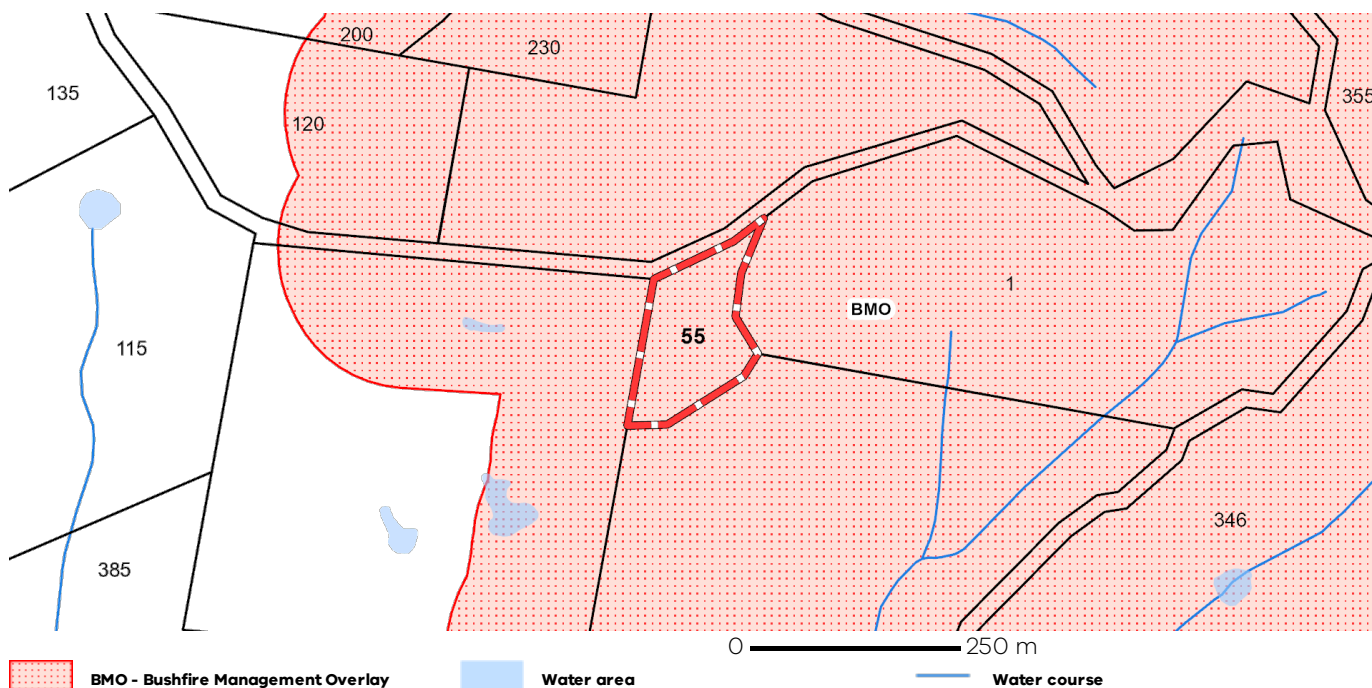

Note: due to overlaps, some overlays may not be visible, and some colours may not match those in the legend

Further Planning Information

Planning scheme data last updated on 30 June 2025.

A **planning scheme** sets out policies and requirements for the use, development and protection of land. This report provides information about the zone and overlay provisions that apply to the selected land. Information about the State and local policy, particular, general and operational provisions of the local planning scheme that may affect the use of this land can be obtained by contacting the local council or by visiting <https://www.planning.vic.gov.au>

This report is NOT a **Planning Certificate** issued pursuant to Section 199 of the **Planning and Environment Act 1987**. It does not include information about exhibited planning scheme amendments, or zonings that may affect the land. To obtain a Planning Certificate go to Titles and Property Certificates at Landata - <https://www.landata.vic.gov.au>

For details of surrounding properties, use this service to get the Reports for properties of interest.

To view planning zones, overlay and heritage information in an interactive format visit <https://mapshare.maps.vic.gov.au/vicplan>

For other information about planning in Victoria visit <https://www.planning.vic.gov.au>

Designated Bushfire Prone Areas

This property is in a designated bushfire prone area. Special bushfire construction requirements apply to the part of the property mapped as a designated bushfire prone area (BPA). Planning provisions may apply.

Where part of the property is mapped as BPA, if no part of the building envelope or footprint falls within the BPA area, the BPA construction requirements do not apply.

Note: the relevant building surveyor determines the need for compliance with the bushfire construction requirements.

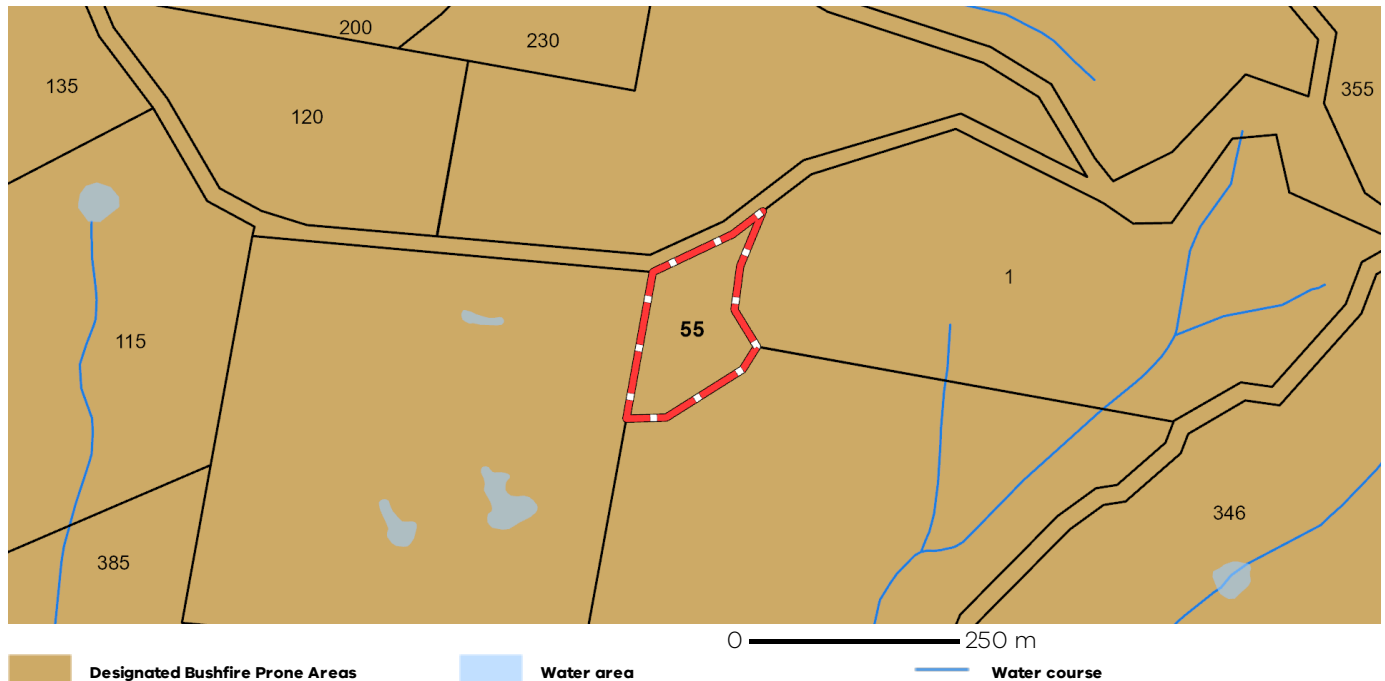

Designated BPA are determined by the Minister for Planning following a detailed review process. The Building Regulations 2018, through adoption of the Building Code of Australia, apply bushfire protection standards for building works in designated BPA.

Designated BPA maps can be viewed on VicPlan at <https://mapshare.vic.gov.au/vicplan/> or at the relevant local council.

Create a BPA definition plan in [VicPlan](#) to measure the BPA.

Information for lot owners building in the BPA is available at <https://www.planning.vic.gov.au>.

Further information about the building control system and building in bushfire prone areas can be found on the Victorian Building Authority website <https://www.vba.vic.gov.au>. Copies of the Building Act and Building Regulations are available from <http://www.legislation.vic.gov.au>. For Planning Scheme Provisions in bushfire areas visit <https://www.planning.vic.gov.au>.

Native Vegetation

Native plants that are indigenous to the region and important for biodiversity might be present on this property. This could include trees, shrubs, herbs, grasses or aquatic plants. There are a range of regulations that may apply including need to obtain a planning permit under Clause 52.17 of the local planning scheme. For more information see [Native Vegetation \(Clause 52.17\)](#) with local variations in [Native Vegetation \(Clause 52.17\) Schedule](#)

To help identify native vegetation on this property and the application of Clause 52.17 please visit the Native Vegetation Information Management system <https://nvim.delwp.vic.gov.au/> and [Native vegetation \(environment.vic.gov.au\)](#) or please contact your relevant council.

You can find out more about the natural values on your property through NatureKit [NatureKit \(environment.vic.gov.au\)](#)

Extractive Industry Work Authorities (WA)

All or parts of this property are within 500 metres of Extractive Industry Work Authorities (current).

On 22 March 2022, Amendment VC219 introduced changes to all planning schemes in Victoria to support the ongoing operation of extractive industry across Victoria and increase amenity protection for nearby accommodation in rural zones.

The amendment made changes to the Rural Living Zone, Green Wedge Zone, Green Wedge Zone A, Rural Activity Zone, Farming Zone and Rural Conservation Zone, introducing a permit requirement for accommodation and building and works associated with accommodation that is located within 500 metres from the nearest title boundary of land on which a work authority has been applied for or granted under the Mineral Resources (Sustainable Development) Act 1990 (MRSD Act).

The Amendment also introduced new referral and notice requirements, and decision guidelines.

VicPlan mapping shows property information, including whether a work authority application has been made or approved under the MRSD Act.

Guidance on accessing work authority maps is detailed at the DELWP [Extractive Resources \(planning.vic.gov.au\)](https://www.delwp.vic.gov.au/extractive-resources) webpage.

Further information on extractive and mining activities in Victoria can be found on the [GeoVic - Earth Resources](https://www.geovic.vic.gov.au/earth-resources) website which is maintained by the Resources Branch within the Department of Jobs, Precincts and Regions. Limited information is available for unregistered users (anonymous user).

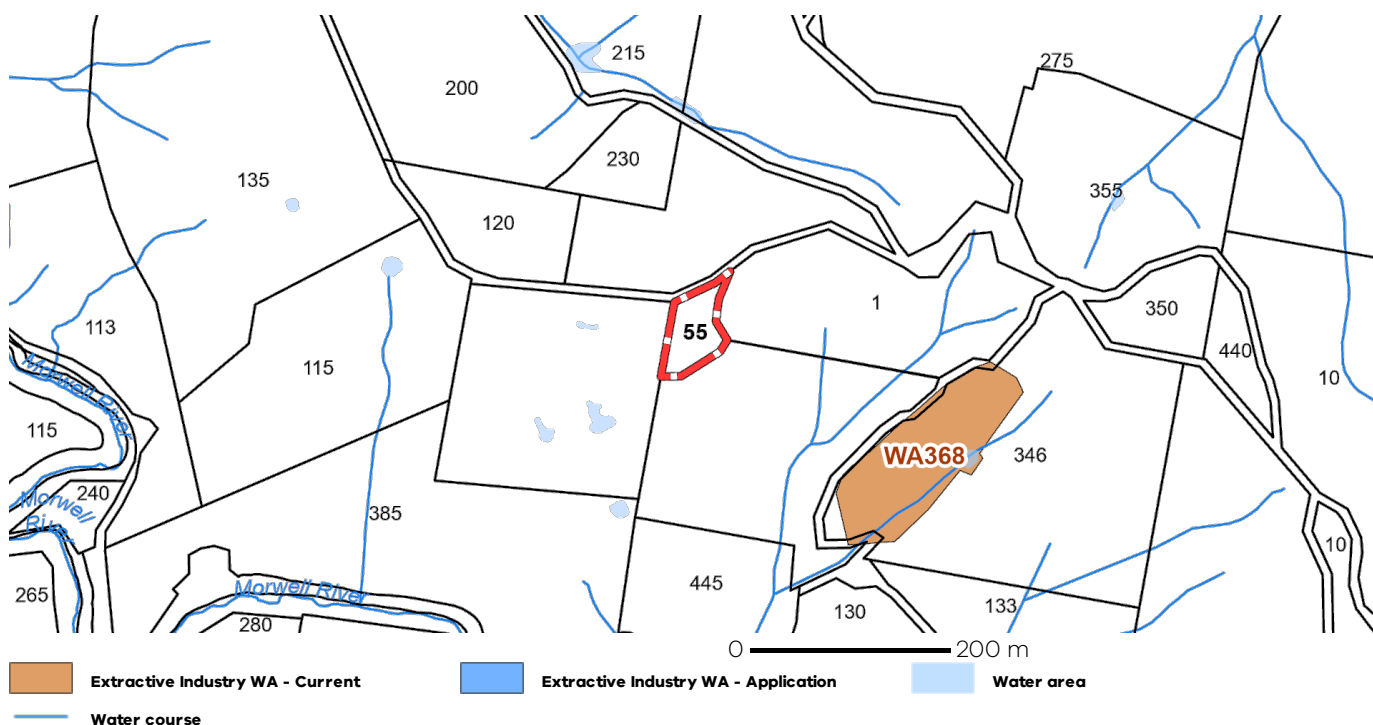



Department of Environment, Land, Water & Planning

C/O LANDATA® Online Services
Telephone: (03) 9102 0402

Your Ref:1831
Our Ref:77289133-029-9

02 Jul 2025

Wakefield Lawyers C/- InfoTrack (Smokeball)
135 King Street
SYDNEY 2000

Dear Sir / Madam

RE: PROPERTY ENQUIRY - 55 PIONEER ROAD, BOOLARRA 3870

I refer to your property enquiry dated 02 Jul 2025, and advise that there are no licences associated with this property.

Should you have any queries regarding this matter please contact
transactioncentre@delwp.vic.gov.au

LANDATA® Property Certificates Service

Privacy Statement

Any personal information about you or a third party in your correspondence will be protected under the provisions of the Privacy and Data Protection Act 2014. It will only be used or disclosed to appropriate Ministerial, Statutory Authority, or departmental staff in regard to the purpose for which it was provided, unless required or authorised by law. Enquiries about access to information about you held by the Department should be directed to the Privacy Coordinator, Department of Environment, Land, Water and Planning, PO Box 500, East Melbourne, Victoria 8002



Valuation and Rates Notice

For the period 1 July 2024 to 30 June 2025

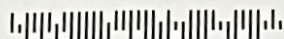

034 27382

Mr D J Watson
55 Pioneer Rd
BOOLARRA VIC 3870

To be eligible for the instalment program and receive reminder notices, you must pay the first instalment in full by 30 September 2024.

Assessment number: 216978
Issue date: 16/08/2024

Your payment options:

Pay by instalment

Instalment 1 \$644.90
Due: 30 Sept 2024

Instalment 2 \$599.55
Due: 30 Nov 2024

Instalment 3 \$599.55
Due: 28 Feb 2025

Instalment 4 \$599.55
Due: 31 May 2025

OR

Full payment

Due date: \$2,443.55
15 February 2025

Payment Plan or Difficulty paying on time?

Contact us to apply for an alternative payment plan. Phone 1300 367 700 or email rates@latrobe.vic.gov.au

005049-027382-001-002-083974-90419

Property: 55 Pioneer Road, BOOLARRA VIC 3870

Description: CA 14J Sect A
AVPCC: 117 - Residential Rural/Rural Lifestyle
(see reverse)

Capital Improved Value (CIV): \$690,000

Valuation date: 01/01/2024

Effective as at: 01/07/2024

Arrears, immediate charges and payments

Arrears \$45.25

Council rates and charges

General Rates Residential (0.00297572 x CIV) \$2,053.25
Municipal Charge \$153.00

State government charges

Fire Service Property Levy - Residential (0.000087 x CIV) \$60.05
Fire Services Property Levy Fixed Charge \$132.00

Total amount payable \$2,443.55

Paid in full.

Payments made on or after 05 August 2024 may not be included

- ☐ Full payment: \$2,443.55
☐ Instalment: \$644.90

Assessment number: 216978
Property: 55 Pioneer Road, BOOLARRA VIC 3870



Online
Payment

Ref: 216978

Online: www.latrobe.vic.gov.au/pay



Billers Code: 6072
Ref: 216978

Pay 24 hours a day by phone or internet,
direct from your bank account or via BPAY View.



Post
Billpay

Billers Code: 0359
Ref: 216978

Pay 24 hours a day by credit card:

Online: www.auspost.com.au/postbillpay

Phone: 13 18 16

Direct debit

To arrange regular deductions, including weekly, fortnightly, monthly, quarterly or in full annually, from your bank account. Visit www.latrobe.vic.gov.au/directdebit or call 1300 367 700 to obtain a direct debit form.

In person

At any Latrobe City Service Centre or Library, (location on reverse) or Australia Post outlet.

Please retain this notice for your records as a fee of \$22.00 may be charged for replacement copies. Or, see page three for instructions on how to register for electronic notices in order to obtain a replacement copy free of charge.

Mail

Detach this slip and send with payment to: Latrobe City Council
PO BOX 264, Morwell VIC 3840.

Centrepay

To arrange regular deductions from your Centrelink payment, please use your Centrelink online account, Express Plus Centrelink mobile app or you can contact Centrelink in person or by phone and quote reference number (CRN): 555 070 553H.

Council Use Only

More
information
overpage



*359 216978

