

**Survey of Lease Areas for Units 29 & 30, 20 Tucks Road, Seven Hills, NSW**

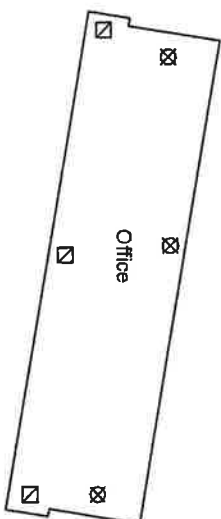
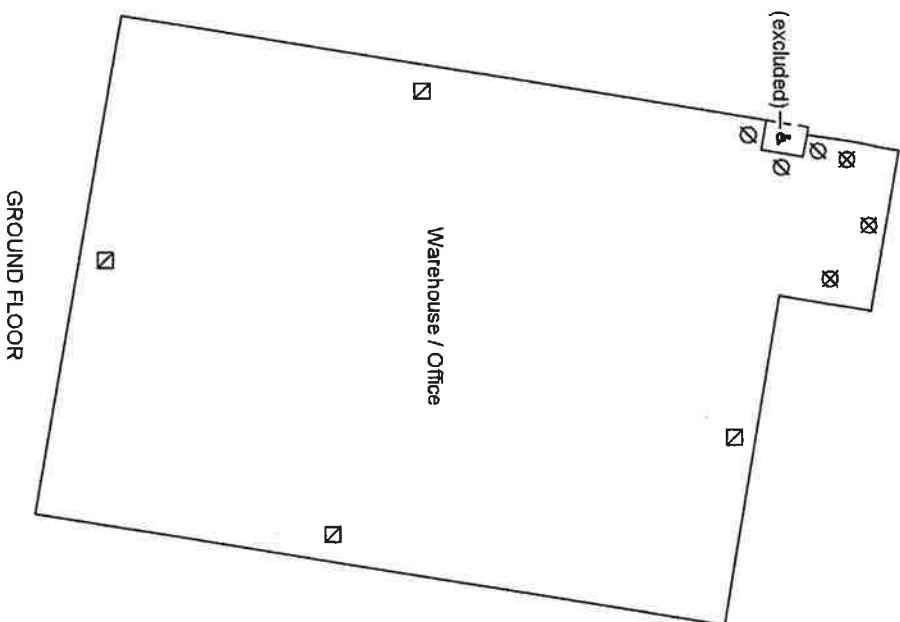

**FIRST FLOOR**

<b>Schedule of Areas</b>	
Warehouse	2,308.6 m <sup>2</sup>
First Floor Amenities	421.8 m <sup>2</sup>
<b>Total</b>	<b>2,730.4 m<sup>2</sup></b>

### Symbols Key

- ☐ Area to Internal Face of Wall
- ☐ Area to External Face of Wall
- ☐ Area to Centreline of Wall
- ☒ Area to Face of Glass

<b>SURVEY PREPARED FOR</b>	<b>METHOD OF MEASUREMENT</b>	<b>REALSERVE PTY LTD</b>	 <b>Real Estate Plans &amp; Surveys</b> Phone: 02 9460 4744 Fax: 02 9475 5050 <a href="mailto:Info@realserve.com.au">Info@realserve.com.au</a> <a href="http://www.realserve.com.au">www.realserve.com.au</a>	<b>Job Ref.</b> 32681
<b>Client:</b> Bawdens Industrial	Airspace have been calculated in accordance with our interpretation of the Property Cancellation of Australia (PCA) Method of Measurement for Lettable Area (March 1987)	<b>Level 1, 3 Victoria Road</b>		<b>Date:</b> 12/11/2007
<b>Property Address:</b> Units 29 & 30, 20 Tuicks Road	<b>GUIDELINES USED</b>	<b>Paramatta NSW 2150</b>		<b>Scale:</b> 1 : 400 at A3
<b>Property Type:</b> Industrial	<b>GROSS LETTABLE AREA</b>	<b>PO Box 2166</b>		<b>CAD File:</b> 32681
		<b>North Paramatta NSW 2151</b>		<b>Pages:</b> 1 of 1